

Lydsto Window Cleaning Robot Instruction Manual

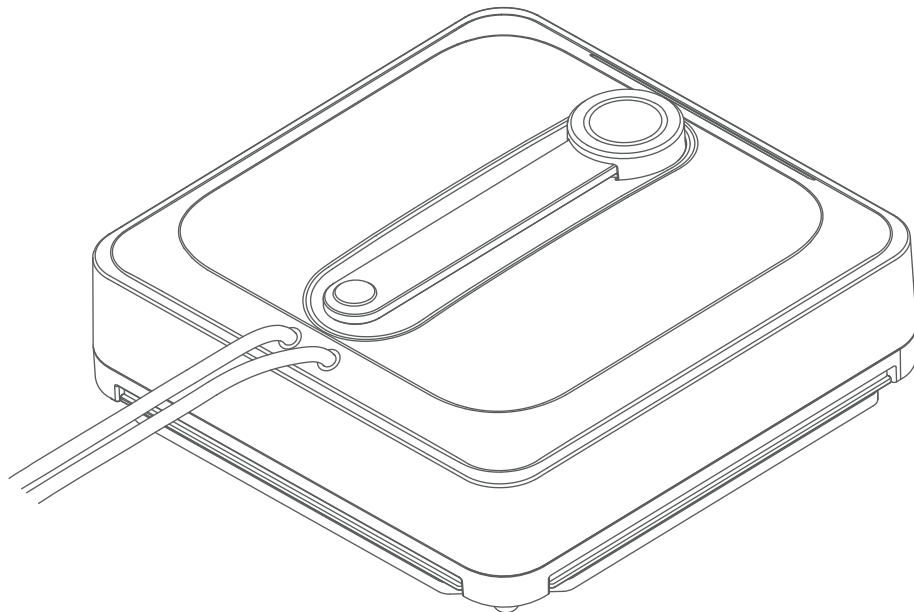

Please read this manual carefully before use and keep it properly

CONTENTS

Important hint -----	04
Component name -----	05
Accessories list -----	06
Remote Control Instructions -----	07
Operation method -----	08
Instructions -----	09
power cut-off -----	14
maintenance -----	16
Lighting effect tips -----	19
Product parameters -----	19
Troubleshooting -----	20

Warn

Before using this product, please read all contents of this manual carefully and install the machine according to the steps of this manual. Take care of this manual. If you pass the product to a third party, please accompany this manual with the machine. Any operation that does not conform to the instructions in the manual may result in product damage or serious personal injury. This product is only suitable for operation and use in a conventional domestic environment, not for industrial or outdoor use.

- The product is not intended for use by persons with physical, sensory or intellectual disabilities, or persons lacking experience and common sense (including children), unless supervised or instructed to ensure their safe use.
- Do not touch the plug or any live part of the product with wet hands to avoid the risk of electric shock.
- If the charger or plug is damaged, please stop using it. Please call our company's professional maintenance personnel for replacement to avoid hazards.
- When using, if you find the leakage of electricity or the motor temperature is too high and abnormal sound, such as the body overheating, abnormal sound, smell, etc., you should stop using it and call the company's professional maintenance personnel.
- When charging, please use the charger specially designed for you by our company; other types of chargers may cause battery failure or extreme thermal effects.
- If you do not use this product for a long time, you should turn off the power and unplug the charging base.
- After using the machine, please store it in a dry place. A damp place will affect the insulation and service life of the electrical appliance.
- When the machine fails, do not repair it by yourself, please call our company's after-sales department for help.
- All technologies and other data reflected in this product manual are obtained by our company or a designated third-party testing company, and the final interpretation right belongs to our company.
- Cannot be cleaned on wet glass, it will cause the machine not to work properly.
- Can not be used on glass with seam, the machine may leak and fall after directly crossing the seam.

About Cleaning Solutions

- If a large amount of cleaning solution is added, more foam will be generated during use, which may penetrate into the motor and cause danger.
- Proportion cleaning according to the instructions for use. It is recommended to use the cleaning agent produced by our company and the manufacturer approved by our company, and shall not contain acid, alkali solution or environmentally harmful substances.
- Cleaning agents should be kept out of the reach of children. If cleaning solution accidentally gets into eyes, rinse thoroughly with clean water. In case of accidental ingestion, seek medical attention immediately.
- When disposing of sewage and cleaning solutions, local environmental regulations should be followed.

front of main unit

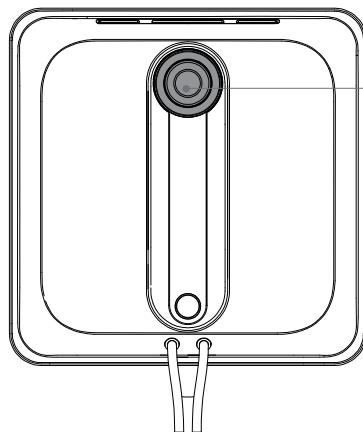

Status LED/Start/Pause key

Back of the main unit

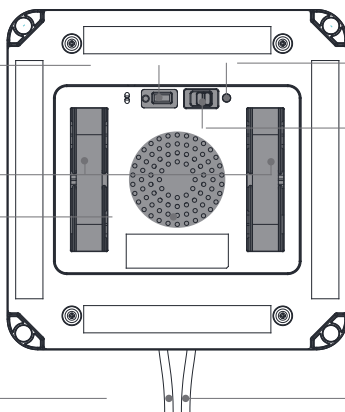

Software burning access location

Indicator light

Drive track

Bottom power switch

Host fan

Fixed rope

Power cable

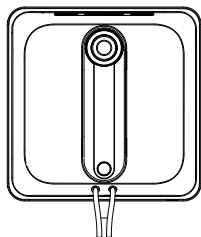

Host (with safety rope and components and power cord)

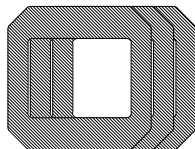

Rag



Remote control

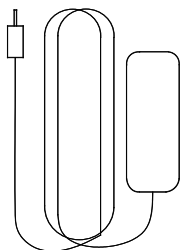

Adapter

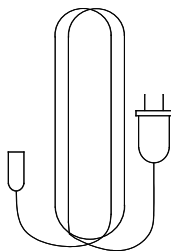

Plug

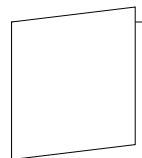

Instruction Manual



Measuring flask

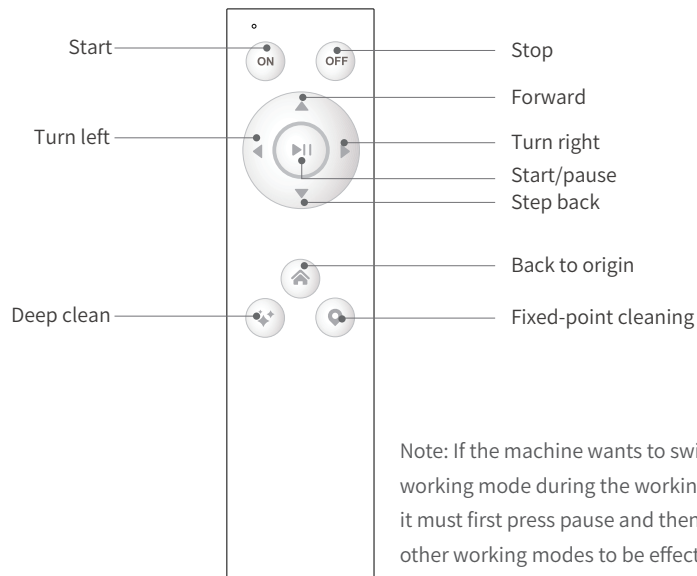

Button	
ON	Start automatic cleaning mode (N-shape cleaning)
OFF	Stop working
Home	When the automatic cleaning mode and deep cleaning mode are not completed, press the button to directly return to the origin
Play/Pause	Start automatic cleaning mode/pause work/continue work
Up	Go up to the end of the glass, go back 3 cm and then stop working
Right	Go right to the end of the glass, go back 3 cm and stop working
Down	Go down to the end of the glass, first retreat 3 cm and then stop working
Left	Go left to the end of the glass, go back 3 cm and then stop working
Z-shaped	Deep cleaning mode: first z-shaped cleaning once and then n-shaped cleaning once
Wipe	After pressing, wipe back and forth at the current position (25 cm distance) five times

Serial number	Operation method	Specific operation method
01	Cleaning mode	<p>Automatic cleaning: Press the button to automatically clean the entire glass in an "N" shape, and return to the origin after cleaning.</p> <p>Deep cleaning: After pressing the button, first clean one side of the glass in a "Z" shape, and then clean the other side of the glass in an "N" shape, and return after cleaning back to the start.</p> <p>Fixed-point cleaning: Press the button and then wipe the current position back and forth (25 cm distance) for 5 times.</p>
02	track wheels cleaning method	<p>Please use the track wheel cleaning function.</p> <p>Hold the machine in your hand, press and hold the circular button and keep your hand, the track wheels will move slowly, wipe off the dirt on the track wheels with a wet tissue, avoid track wheel marks when wet rubbing later.</p> <p>Do not use a rag or dry paper towel to clean the track wheels.</p>
03	Machine storage method	<p>After using the machine, replace the used rag with a clean rag, or save it without sticking the rag.</p>
04	There is a lot of large particles while cleaning dirty glass	<p>When the machine is cleaned, there is a risk of scratches, so it is recommended to wipe it manually first. If manual wiping is not possible, it is recommended to wipe the machine twice to reduce scratches.</p>
05	Front and rear area cleaning method of track wheels	<p>Use dry toilet paper to absorb the moisture in the rag area before and after the track wheels to ensure that the rags in the front and rear areas of the two track wheels are dry.</p>

Before use, please make sure that the safety lock assembly has been installed on the host to avoid danger.

* The safety lock assembly is pre-installed at the factory, please do not remove it at will.

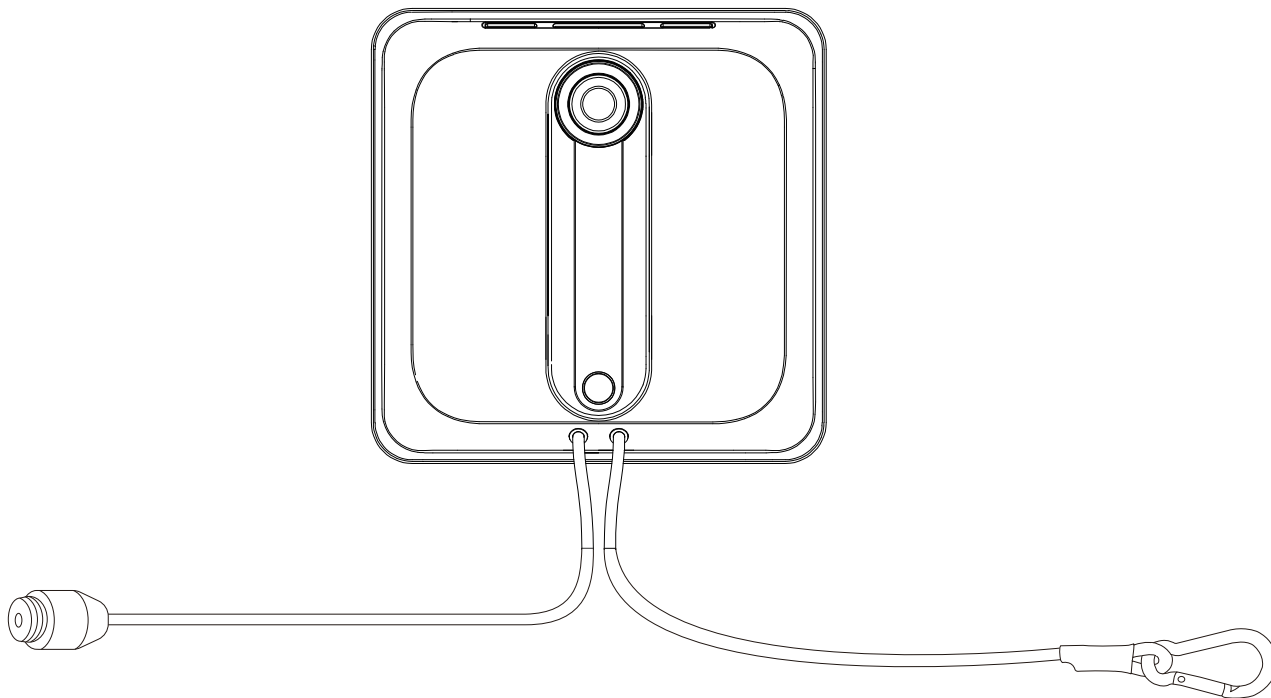

1 App connection

This product has been connected to Lydsto, can be controlled through the Lydsto APP, and interconnected with other products.

Scan the QR code, download and install the Lydsto APP, users who have installed the Lydsto APP will directly enter the device connection page. Open the Lydsto APP homepage, on the upper right of the page Click "+" in the corner to add devices according to the APP prompts.

Tip: Due to the upgrade and update of the Lydsto APP, the actual operation may be slightly different from the above description, please follow the instructions in the current Lydsto APP.



Reset Wi-Fi

When the machine is turned on and there is no adsorption and no bottom up, press and hold the button for 5 seconds, hear the buzzer "beep", the WI-Fi reset is successful, and the host enters the network configuration mode.

2 Connect the main unit power cord, adapter and plug

* Do not disconnect the power supply when the main unit is running; if you disconnect the power supply, there is a risk of falling.

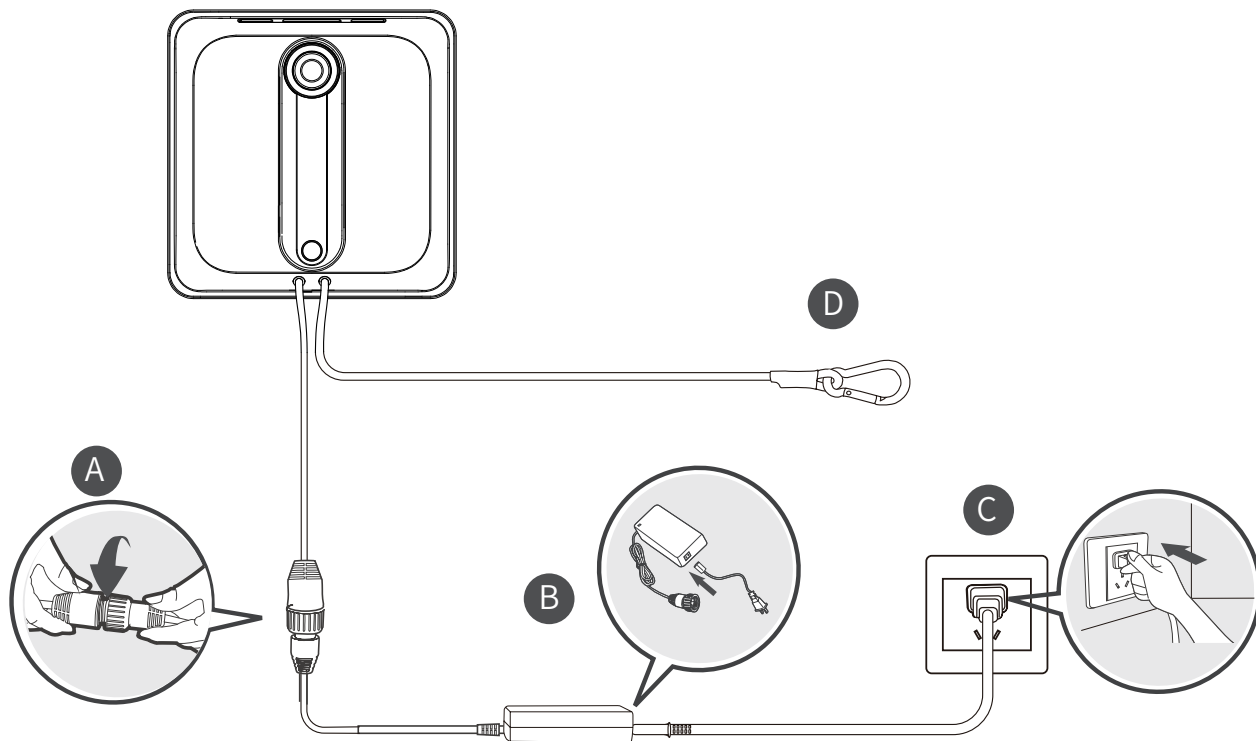

3 Preparation before use

Secure the safety lock: To ensure safe use, be sure to secure the safety lock before use.

* It is recommended to attach the safety catch to a strong metal rod.

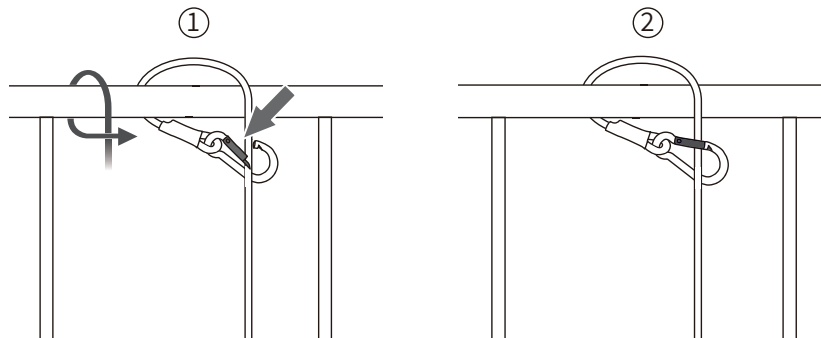

Spray cleaning fluid

1. It is recommended to spray about 2 times evenly on the wide side of the cleaning pad. Avoid spraying on the drive wheel tracks and make sure the tracks are dry to avoid slipping. Do not spray cleaning fluid directly on the glass.
2. After spraying, use a dry cloth to wipe off the excess cleaning fluid on the chassis to avoid slippage when the machine is working.
3. Please use the cleaning solution specially formulated by our company. The use of non-specialized cleaning solution may result in poor cleaning effect or product damage.

Clean the area to be adsorbed

Before you start, if there is too much dust on the glass surface, wipe out a clean area the size of the console for the console to absorb.

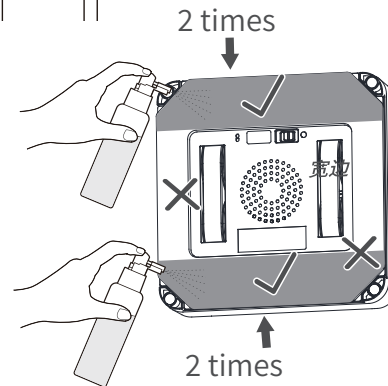

4 Start cleaning

Make sure the bottom of the console is powered on. Press the four ball heads at the bottom of the main unit on the glass, and the main unit will adsorb itself start planning the cleaning with a bow-shaped path.

- * When cleaning frameless glass, the suction position should not be too close to the edge, it is recommended to be more than 10cm away from the edge.
- * The main unit can only clean flat surfaces. Please make sure the glass thickness is not less than 3mm.
- * Do not put the fan close to small objects such as hair after turning it on, so as not to block the fan.

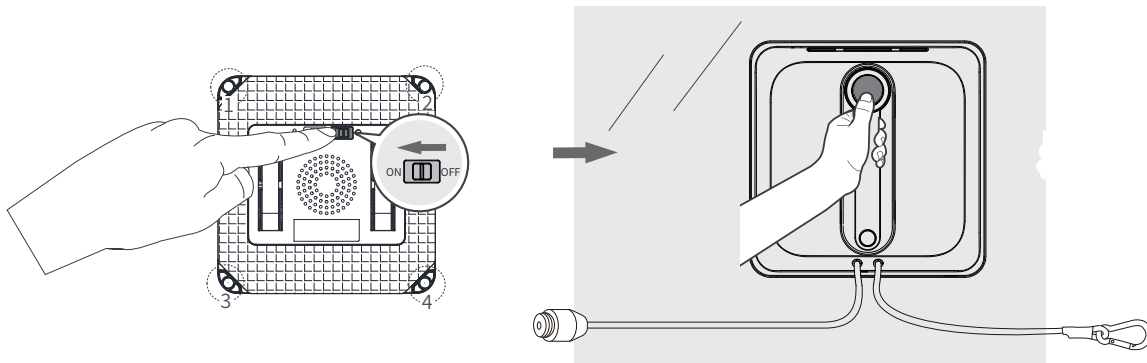

5 Pause

During the working process, you can short press the host key (⏻) to suspend the host work.

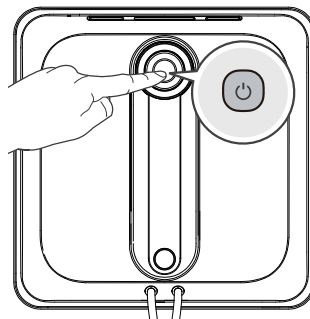

1、 Remove the main unit: After the cleaning is completed, the main unit will return to the vicinity of the starting position and sound a beep. Please hold the handle tightly, press  for about 3 seconds, the suction of the fan will decrease, and then remove the main unit.

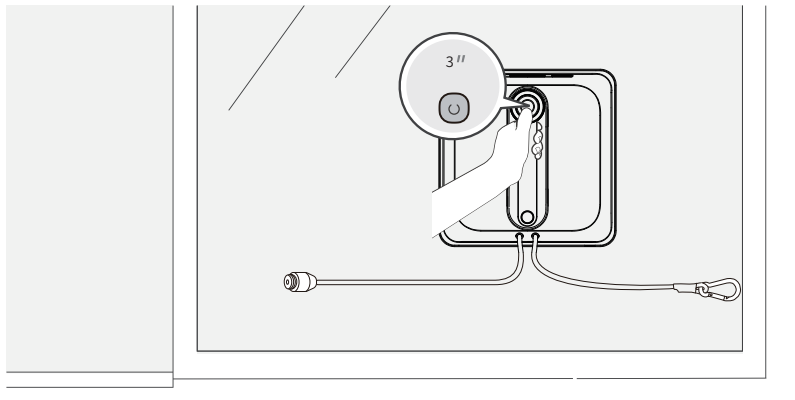

2、 Power off: Turn the bottom power switch to the "OFF" end.

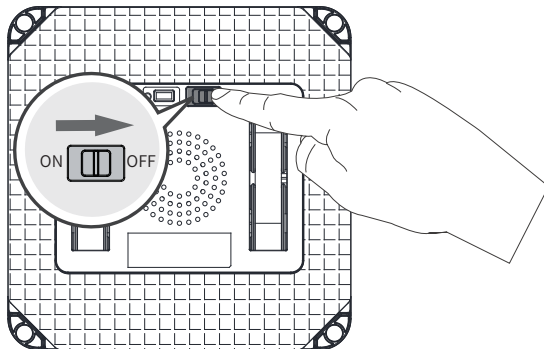

3、 Remove the safety lock

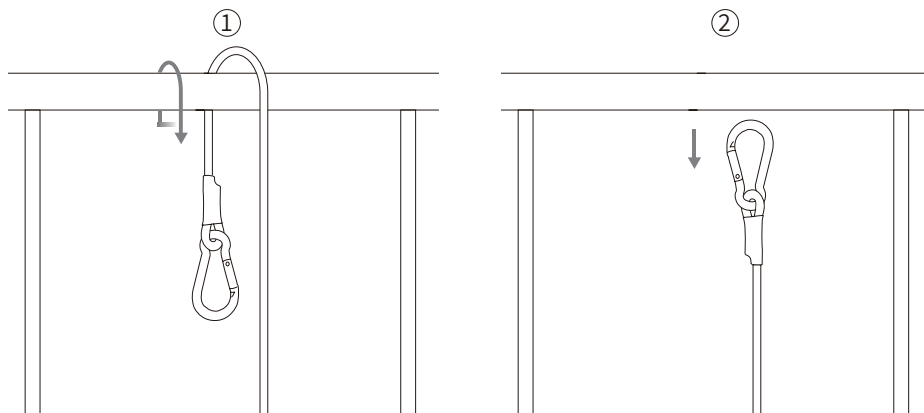

4、 Disconnect the power

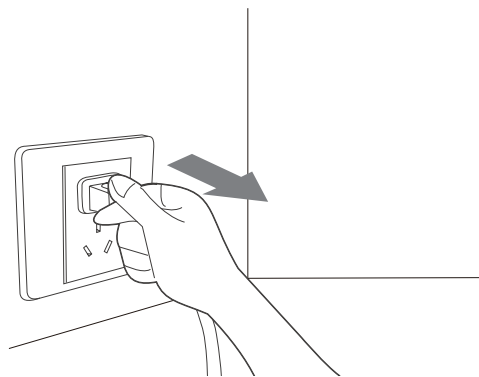

A. Change the rag

Remove the dirty rag, and stick the new rag (dark side up) flatly inside the cleaning bracket at the bottom of the main unit. Please note that the width of the cleaning rag corresponds to the width of the rag holder.

Be careful not to stick the cleaning pad outside the rag holder, so as not to affect the normal operation of the host.

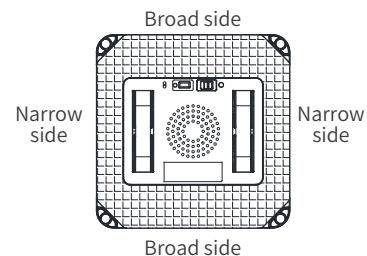
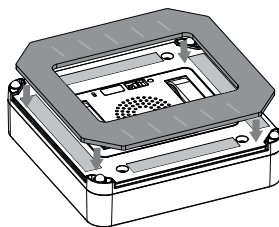
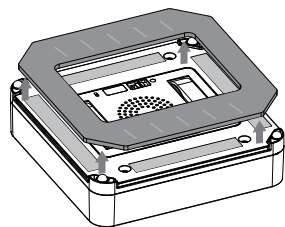

B. Cleaning the rag

Remove the rag, soak it in water at about 20°C for 2 minutes, then brush it with a soft brush, do not rub or wring it dry, let it dry naturally before use.

Do not use the cleaned rag directly to avoid the host from slipping during the working process.

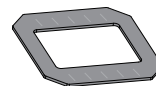

*When the cleaning pad becomes thin and damaged, and cannot stick closely to the magic, please replace it in time to achieve the best cleaning effect.

If you want to buy accessories, please buy them from official channels.

Clean the drive wheel tracks

17

1、 Before cleaning, please make sure that the power switch at the bottom of the main unit has been turned to "ON" and the fan is on.

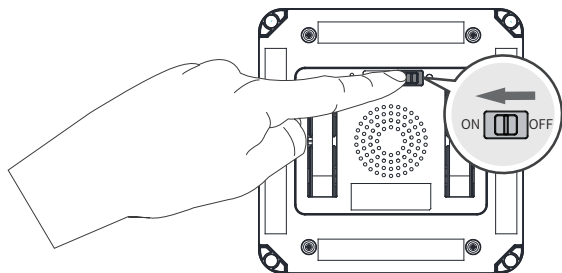

2、 Remote control the host through the App or long press the front start/stop button to check the drive wheel track. If you find dirt, please pause first, spray the cleaning solution twice on a clean dust-removing rag, and wipe the track clean.

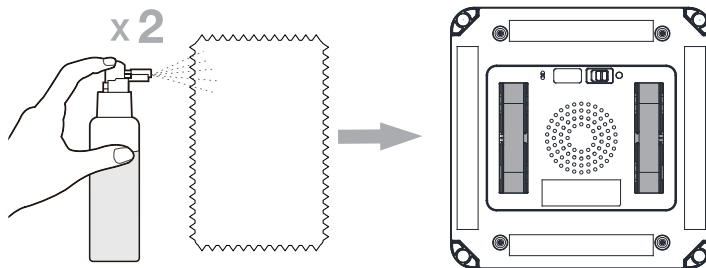

3、 After cleaning, you can install the cleaning pad to continue working, or turn the power switch at the bottom of the host to "OFF" to stop working.

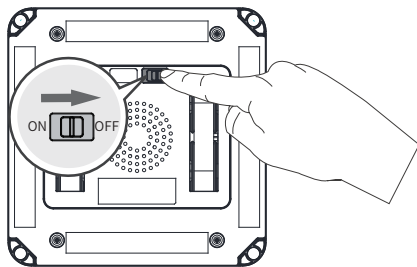

4、 Fan: wipe it with a dry rag to avoid damage to the suction of the host.

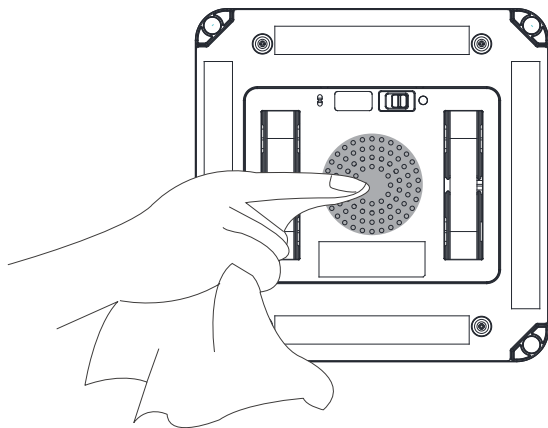

5、 Floating head: wipe it with a dry rag to prevent the machine from getting stuck during the wiping process.

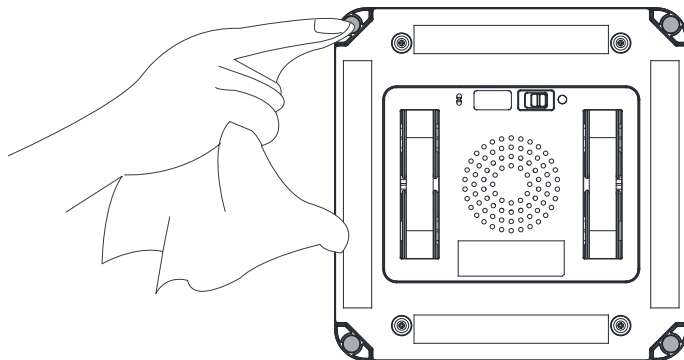

Lighting effect	State
Blue light on	The host is fully charged.
	The host has successfully adsorbed the glass and can start cleaning.
	Host suspended.
Blue light on and dark interchange	The machine is working.
Steady red light	Host is charging.
Flashing red light	If the host alarms, please refer to the [Common Troubleshooting] chapter to solve it.
Blue light flashes quickly	Each time the power switch is turned on, it will be attached to the glass for the first time and the gyroscope will be calibrated for 3 seconds. At this time, the blue light flashes rapidly, and the work cannot be started during calibration
Red and blue lights flash alternately	If the host alarms, please refer to the [Common Troubleshooting] chapter to solve it.

Product Parameters

Product name	Window Cleaning Robot	Product model	XD-CCJQR03
Working voltage	24V ===	Working current	3A
Rated power	72W		

* Due to the need for continuous improvement of the product, the product in this information is subject to the actual product, and our company reserves the right to update the product.

Serial number	Failure situation	Possible Causes	Solution
1	Red light flashes, buzzer beeps	Adapter not connected	Connection adapter
		Abnormal pressure	Stop cleaning, remove machine and restart work
2	The red light is on first, and then the blue light for the number of responses flashes according to the serial number corresponding to each sensor. The buzzer sounds with the number of flashes of the light.	Sensor abnormality	Please contact after-sales service
3	The red and blue lights flash alternately, and the buzzer beeps	The wheels are stuck	After adjusting the machine, short press the start/stop button to stop the alarm and start the work
4	The red light is always on and the buzzer is beeping	Low battery	Connect the adapter and wait until the red light turns to blue light before starting to work
5	The drive wheel of the machine is idling, and the walking path is abnormal	Glass surface is too dirty	a.Wipe the drive wheel b.Replace the cleaning cloth
6	Remote control not working	The remote control is not paired with the product or the pairing fails	Please contact after-sales service
7	Difficulty walking the machine	The glass surface is wet	Stop cleaning and wait for the glass surface to dry before cleaning
		Mop too wet	Change the cleaning cloth

Manufacturer : Guangdong Xiaoda Technology Co.,LTD.
Address : Room 701, No. 5, Songhu Zhigu R&D Center, No. 1,Renju
Road, Liaobu Town, Dongguan City, Guangdong Province
Service number : +86 400-077-6967

Certificate of Conformity
Checked already

FCC Statement

This device complies with Part 15 of the FCC Rules. Operation is subject to the following two conditions:

(1) This device may not cause harmful interference.

(2) This device must accept any interference received, including interference that may cause undesired operation.

2. Changes or modifications not expressly approved by the party responsible for compliance could void the user's authority to operate the equipment.

Note: This equipment has been tested and found to comply with the limits for a class B digital device, pursuant to Part 15 of the FCC Rules. These limits are designed to provide reasonable protection against harmful interference in a residential installation.

This equipment generates uses and can radiate radio frequency energy and, if not installed and used in accordance with the instructions, may cause harmful interference to radio communications. However, there is no guarantee that interference will not occur in a particular installation. If this equipment does cause harmful interference to radio or television reception, which can be determined by turning the equipment off and on, the user is encouraged to try to correct the interference by one or more of the following measures:

- Reorient or relocate the receiving antenna.
- Increase the separation between the equipment and receiver.
- Connect the equipment into an outlet on a circuit different from that to which the receiver is connected.
- Consult the dealer or an experienced radio/TV technician for help.