

Diagram showing the handle strap being attached to the bottom of the device.

Diagram illustrating the correct placement of the suction cup on the back of the smartphone. The suction cup is placed on the camera window, not on the screen or back cover.





Diagram illustrating the handle strap attachment point on the device.



- (1) Prepare several pieces of napkin
- (2) Place the napkin into the case
- (3) Close the case, make sure it is completely locked
- (4) Immerse the case in the water for 60 minutes, make the depth is no more than 15 meters
- (5) Take out the case, wipe the surface with fibre cloth
- (6) Open the case and take out the napkin
- (7) Carefully check the napkin, only if the napkin is dry could the case be used, otherwise stop using and ask the customer service for a new one.

(Lower left button: Press once to enter the camera function when the phone is unlocked and the screen is on)
Note: The **IOS** system needs to be turned on "Settings" - "Accessibility" - "Turn on zoom"(Double-tap three fingers to restore to original size after turn on zoom)



Zoom

Zoom magnifies the entire screen:

- Double-tap three fingers to zoom
- Drag three fingers to move round the screen
- Double-tap three fingers and drag to change zoom

1.The touch function of the mobile phone will be invalid after the case is installed. The user must adjust the mobile phone to photo or video mode before installing the case.

3.If the mobile phone is set with the rest screen function, the rest screen function needs to be turned off before diving in order to take pictures/ photography functions underwater at any time.

5. Note: The iOS system needs to be turned on "Settings" - "Accessibility" - "Turn on zoom" (Double-tap three fingers to restore to original size after turn on zoom)

Before using your case, read all instructions on this manual. Complete the WATER TEST before using this case with your phone.



A line drawing of the back of the camera. It shows the LCD screen, the viewfinder, and various controls. Numbered callouts point to the following parts: 1. Top of the camera body. 2. Top of the LCD screen. 3. Viewfinder. 4. Top of the LCD screen. 5. Bottom of the LCD screen. 6. Bottom of the camera body. 7. Bottom of the LCD screen. 8. Bottom of the camera body.

1	Bluetooth camera controller	2	Screw
3	Non-slip handle	4	Lanyard hole
5	Bracket mounting hole	6	Camera window

2) Attention

Operation and maintenance

- Make sure the case is well-locked and the sealing joint gap is adequately lined up before diving.
- Stop using this case if the sealing ring is damaged or deformed.
- Maximum diving depth is 15meters, over 15 meters is not guaranteed.
- Test the camera shutter button after every-time installation, make sure it is able to rebound after pressing.
- If the camera window is fogged up, keep the desiccant inside the case at least for 10 minutes before putting the case into the water.
- After every-time using, immerse the completely locked case in fresh water for 30 minutes, then wipe the case with soft fibre cloth and keep in a dry place.

- Do not use the case in sulfur-bearing hot spring.

- Do not take the case apart or outfit, privately, otherwise the waterproof function may be descended.

- it is not suggested you rent or lend this case to others in case of any disputes.

Keep away from Children.

- This product is not a toy, adults must have custody of the children.

- Only the self-contained or manufacturer approved accessories could be used, other accessories may violate the local rules and possible safety issue may occur. Please contact customer service if you need approved accessories.

- Do not dump this product and its accessories as daily trash.
- Please follow your local rules to handle and recycle.

- New upgraded design, compatible with more mobile phone models. Such as iPhone, Samsung etc which not exceeding 6.9 inches.

Installation premise

- Please do waterproof test to this case before installing your phone.

- Tear off any protective tempered glass or film from the phone screen and wipe the phone screen with fibre cloth, make sure the screen is clean before installing the phone into the case.

1. Long press around 3 seconds to open the Bluetooth of controller before using, open the Bluetooth of phone test whether the controller function is in normal use.

- Press the middle button for 3 seconds to turn on the device and the blue light will continue to flash
- Select SHELL BOX-BT-PRO to pair your phone and then can be used normally.

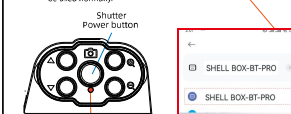

BLUETOOTH CONTROLLER BUTTON FUNCTION

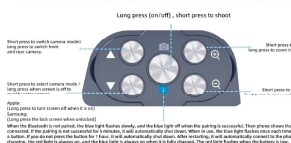

NOTICE

Accessibility **Zoom**

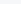
Zoom 

Zoom magnifies the entire screen.
Double-tap three fingers to zoom.
Drag three fingers to move around the screen.
Drag three fingers and drag to zoom.

For iOS: Apple system needs to open **Settings** → **Accessibility** → **Turn on Zoom** to use 3D touch devices normally.
Note: For iPhoneX, 3D S X IS/ XS MAX, long press when the screen is off can only turn on screen first and then short press to enter the camera.

Samsung: After the screen turns off on NOTE10+ / A1115, long pressing this button does not allow you to quickly enter the camera; on NOTE10, you cannot return when select to More, on the camera mode, long press the button to enter the password input interface. The screen will turn off after a few seconds. At this time, long press the button to quickly enter the camera.

A line drawing of the back of the device. A blue arrow points to the 'Airtight cap' on the right edge. Another blue arrow points to a 'Screw' on the bottom right corner, with a dashed line indicating its removal.

- Charging time: Standard charging approx 2 hours
- Battery capacity: 110mAh
- Signal distance: Signal propagation range on land 18m

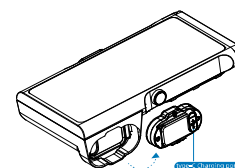

Bluetooth remote control has limited signal underwater; cannot be used separately from the diving housing.

FCC Warning

This device complies with part 15 of the FCC Rules. Operation is subject to the following two conditions: (1) This device may not cause harmful interference, and (2) this device must accept any interference received, including interference that may cause undesired operation.

Any Changes or modifications not expressly approved by the party responsible for compliance could void the user's authority to operate the equipment.

Note: This equipment has been tested and found to comply with the limits for a Class B digital device, pursuant to part 15 of the FCC Rules. These limits are designed to provide reasonable protection against harmful interference in a residential installation. This equipment generates uses and can radiate radio frequency energy and, if not installed and used in accordance with the instructions, may cause harmful interference to radio communications. However, there is no guarantee that interference will not occur in a particular installation. If this equipment does cause harmful interference to radio or television reception, which can be determined by turning the equipment off and on, the user is encouraged to try to correct the interference by one or more of the following measures:

- Reorient or relocate the receiving antenna.
- Increase the separation between the equipment and receiver.
- Connect the equipment into an outlet on a circuit different from that to which the receiver is connected.
- Consult the dealer or an experienced radio/TV technician for help.

The device has been evaluated to meet general RF exposure requirement. The device can be used in portable exposure condition without restriction.