

hovercam®

USER MANUAL

Pilot X/s

Wireless Digital Teaching Station



Pilot X/s

Intel® Core™ i5
Intel® Core™ i7

By **Pathway/**

In a Hurry?

Watch the **Pilot X/S Quick Start Video**
Go to www.hovercam.com/support/training-videos

or

Scan this QR code with your phone's camera:



Pilot X/S Quick Start Video

Intel® Core™ i5 | Intel® Core™ i7

Powered by



Qualcomm and the Qualcomm logo are trademarks of Qualcomm Technologies, Inc and/or its or its affiliated companies.
Intel and the Intel logo are trademarks of Intel Corporation or its subsidiaries.

© Copyright 2023 Hovercam®. All rights reserved. Hovercam® is a trademark Pathway Innovations, Inc. This user guide is subject to change without notice.
Depicted product appearance, features and specifications may vary in the final product(s). Hovercam® shall not be liable for technical or editorial errors or omissions contained herein. Hovercam® disclaims all responsibility and liability for the distribution of and/or reliance on this datasheet. The following granted or pending patents have been filed by pathway Innovations, Inc. (D.B.A. Hovercam) with the United States Patent and Trademark Office (USPTO):
<https://www.hovercam.com/patents>. Rev. 220308



Table of Contents 2

Welcome	3
Main Features What's in the Box	3
Podium Diagram	4
Tablet Diagram	5
Assembling the Podium	6-7
Moving and Adjusting the Podium	8
Charging the Podium	9
Charging the Tablet	10-12
Charging the Tablet Dock	10
Charging the Tablet Storage Bay Changing the Combination	11
Removing the Tablet Charging with the Tablet Power Adapter	12
Operating the Tablet	13-16
Powering-On Operating the Touchscreen Using the Active Stylus	13
Internal PC Windows 10 Imaging / Formatting	14
Tablet Mode Thumb Strap	15
Using the Pop-Out Keyboard & Digital Keyboard Using Third Party Accessories ...	16
Document Camera	17-18
Deploying Positioning.....	17
Software Operating	18
Connecting to a Display: HoverCast	19-22
HoverCast Wireless HDMI How Does HoverCast Work?.....	19-20
HoverCast Set-Up	21
HoverCast FAQ'S Troubleshooting	22
HoverCast Positioning Guide	23-25
Connecting to a Display: Wired	26
Audio Output	27-29
Built-in Speakers Output Display's Speakers HDMI Audio De-Embedder	27
Tablet / Podium Audio Line In/Out (wired) Bluetooth.....	28
Built-In Microphone Auxillary Microphone USB Microphone Bluetooth.....	29
Technical Specifications	30
Service and Support	31
Warranty	32-33
Safety Warnings	34-36
Notices	37
Legal	38

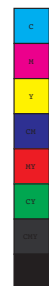

3 Welcome

Congratulations! With **Pilot X/S**, you've taken a major step in revolutionizing your classroom. Designed by educational technology professionals in California, the **Pilot X/S** brings every essential educational technology component to your fingertips: a tablet computer, document camera, and wireless podium. Say goodbye to messy cables, because with **Pilot X/S**, you can wirelessly control your classroom display from anywhere in the room.

Main Features

- Microsoft® Windows® 10 tablet computer (license not included), powered by Intel® (Pilot X)
- 13.3" Multitouch display, with #2 pencil stylus capability
- Wireless, lag-free HD casting via HoverCast
- Wirelessly control and cast bi-directional annotations from USB-touch enabled displays
- Fold-out 4K document camera
- Mobile podium charging station for up to 6 hours of wireless use
- Tablet dock with built-in keyboard
- Lockable tablet bay for overnight security and charging

What's in the Box



Tablet
Computer

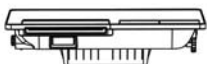

Podium
Surface

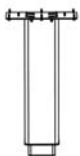

Podium
Pedestal



Podium Wheel
Base



HoverCast Receiver

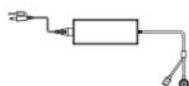

Podium Power
Adapter - 10ft.



Tablet Power
Adapter - 10ft.



HoverCast
Power Adapter
- 10ft.



Mini-HDMI to
HDMI 2.0 Cable
- 5ft.



HDMI Cable
- 5ft.



Type A USB 2.0
Cable - 5ft.



Type B USB 2.0
Cable - 5ft.



Magnetic
Document
Bumpers



Active Stylus
with USB charging
cable



Tablet Thumb Strap
with 2x 10mm
screws



x12

Hardware and
Assembly Tools

Podium Diagram 4

- | | | | |
|---|-------------------------------|----|------------------------------|
| 1 | Magnetic Tablet Dock | 7 | Podium Audio Line In/Out |
| 2 | Pop-Out Keyboard | 8 | Magnetic Power Port |
| 3 | Tablet Bay Charging Actuator | 9 | Tilt Adjustment Dial |
| 4 | x2 Magnetic Anti-Slip Bumpers | 10 | 4x Lockable Wheels |
| 5 | Tablet Storage Bay | 11 | Height Adjustment Foot Pedal |
| 6 | Tablet Bay Key Lock | | |

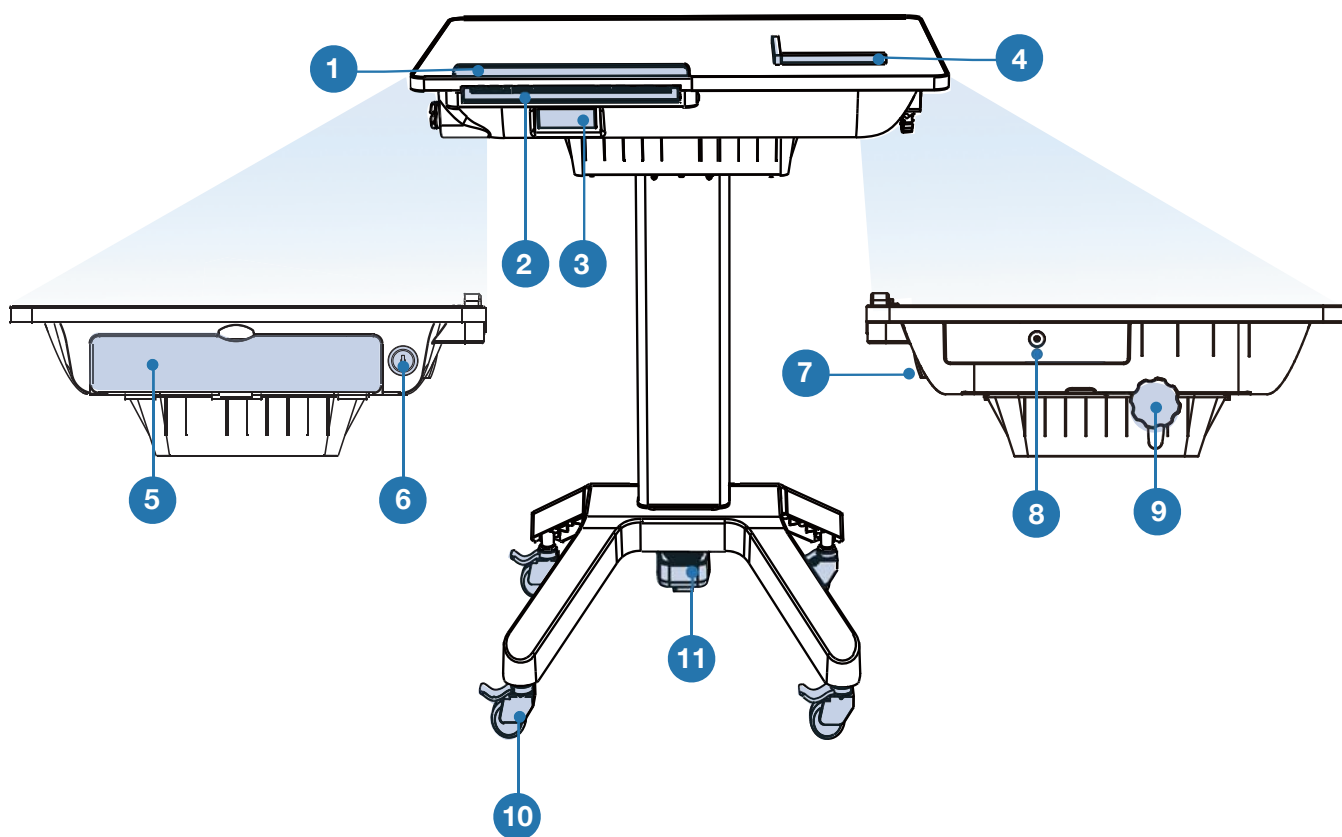

5 Tablet Diagram

Tablet Features

- 1 Fold-Out Document Camera
- 2 HoverCast Wireless Antenna
- 3 HoverCast Antenna On/Off
- 4 1 Watt Tablet Speaker (2x)
- 5 Tablet Charging Indicator*
- 6 Kensington Lock
- 7 HoverCast Reset
- 8 13.3" Multi-Touch Display
- 9 Fingerprint Scanner / Menu*
- 10 Tablet Sleep/Wake Button

Camera Controls

- 11 Zoom-In
- 12 AutoFocus On
- 13 Image Flip
- 14 Zoom-Out
- 15 Camera Reset
- 16 AutoFocus Lock
- 17 Freeze

Connectivity

- 18 USB 3.0 Type A (2x) - Pilot X
USB 3.0 Type A (2x) - Pilot S
- 19 USB 3.0 Type C (2x) - Pilot X
USB 3.0 Type C (1x) - Pilot S
- 20 TF Card Slot (1x) - Pilot S**
- 21 Audio Line In/Out (x1) - Pilot X/S
- 22 Magnetic Docking Connector

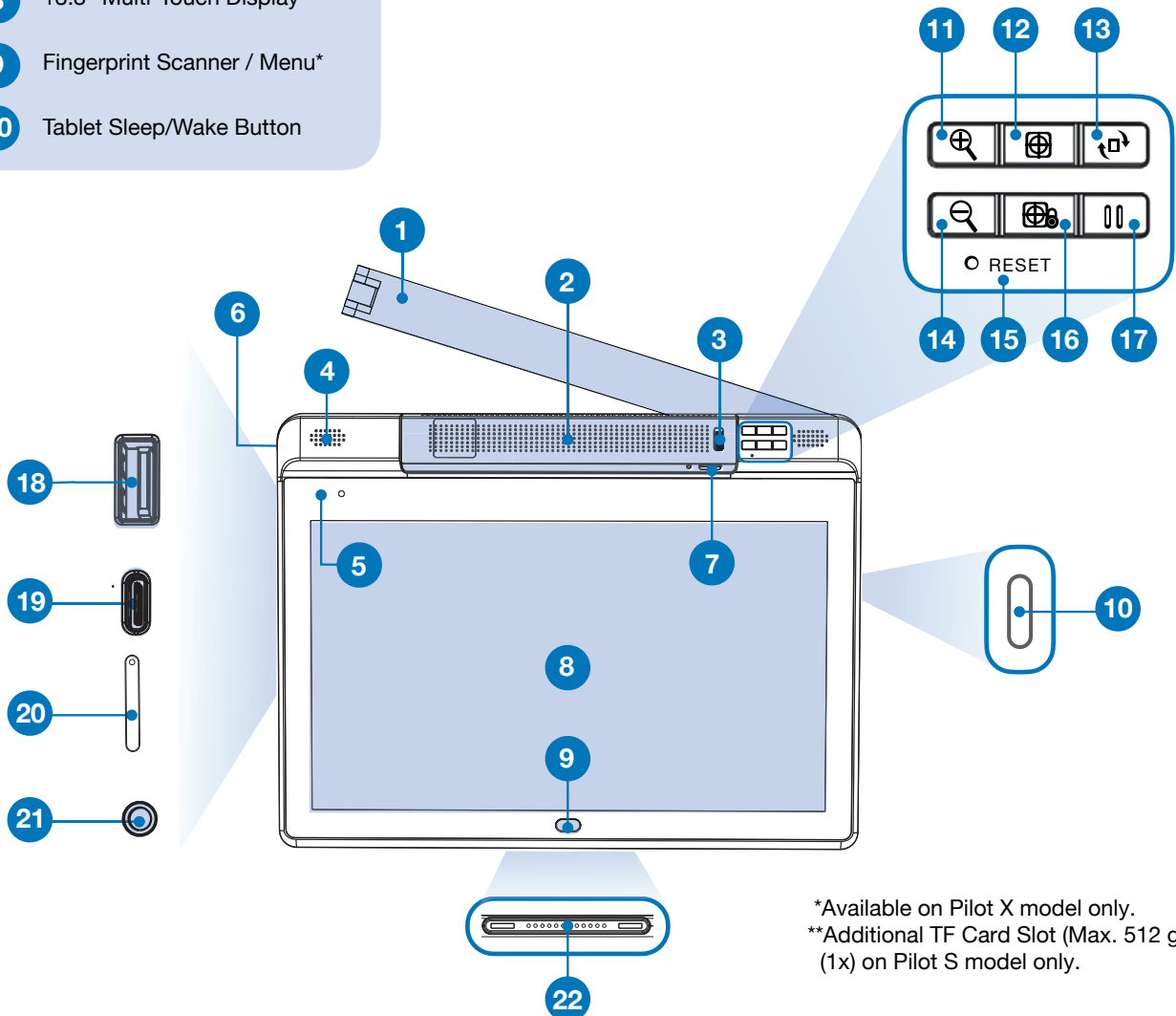

*Available on Pilot X model only.

**Additional TF Card Slot (Max. 512 gb)
(1x) on Pilot S model only.

Assembling the Podium 6

Notice: Two people are required to safely assemble Pilot X/S



Step 1

Carefully unpack the Pilot X/S **Podium Surface**, **Podium Pedestal**, **Podium Wheel Base**, **Hardware** and **Assembly Tools**. Stage the components on the included foam packaging, or use a padded surface.

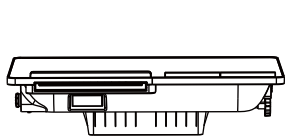

Podium Surface

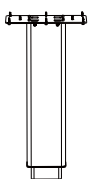

Podium Pedestal

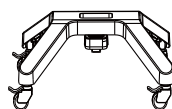

Podium Wheel Base



Hardware and Assembly Tools

Step 2

Place the **Podium Surface** upside down on a padded surface, making sure the **Tilt Adjustment Dial** is in the locked position by rotating it clockwise to the furthest position.

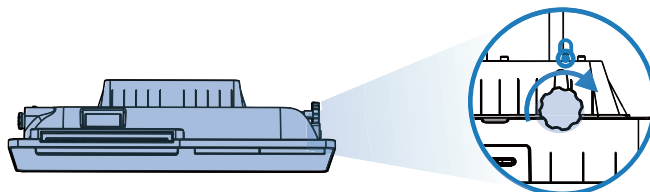

Step 3

Carefully place the **Podium Pedestal** onto the **Podium Surface**, making sure the 8x 4mm bolt holes line up properly. Next use the included **hex driver** to secure **8x 4mm Bolts** as pictured below, being careful not to strip the threads.

Optionally, a thread-locking compound may be used to prevent loosening of the bolts over time (not included). Loctite® Threadlocker Blue 242® is a recommended compound.



8x 4mm Bolts



4mm Hex Driver



Optional Thread-Locking Compound (Not Included)

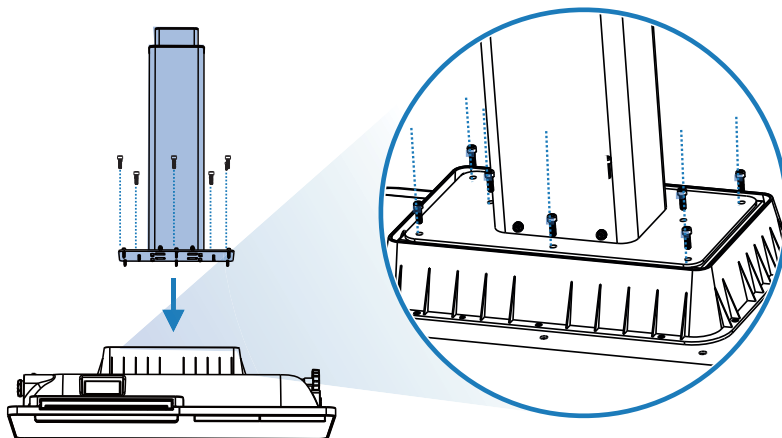

7 Assembling the Podium

Step 4

Insert the **Podium Wheel Base** onto the **Podium Pedestal**, making sure the **Height Adjustment Foot Pedal** is on the same side as the **Pop-Out Keyboard**. Use the included **Hex Driver** to secure **4x 4mm bolts** as pictured below, being careful not to strip the threads.

Optionally, a thread-locking compound may be used to prevent loosening of the bolts over time (not included). Loctite® Threadlocker Blue 242® is a recommended compound.

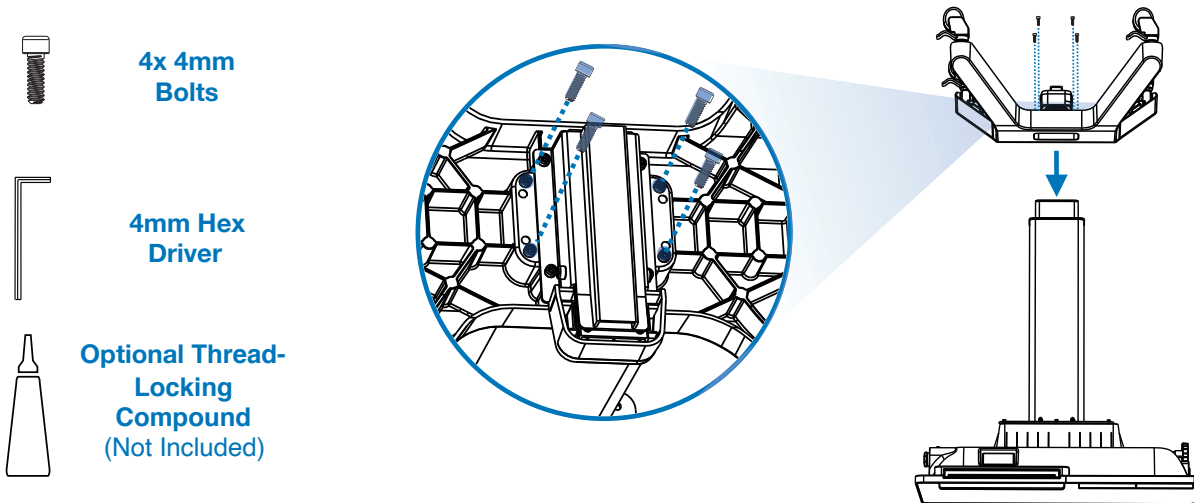

Step 5

Ensure that the 4x **Podium Wheels**' levers are in the locked position by pulling up on the locking levers.

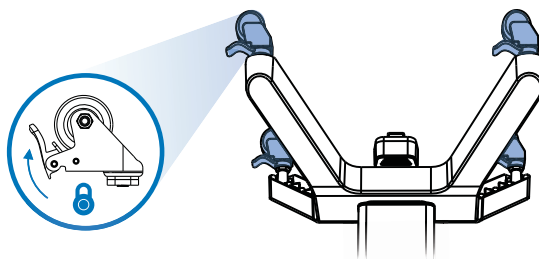

Step 6

With the help of another person, carefully stand the podium onto a level surface.

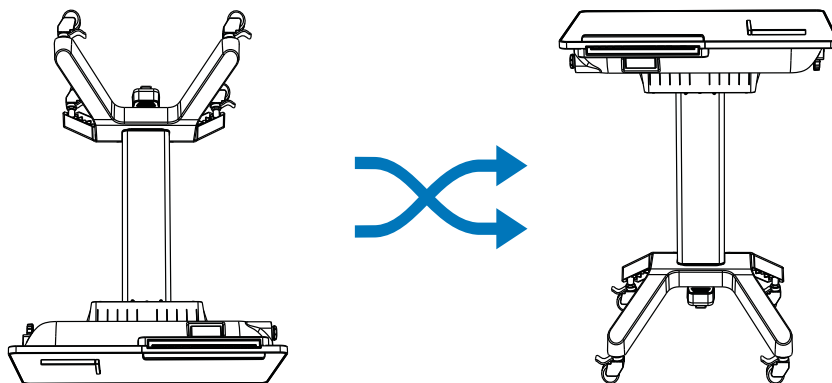

Moving and Adjusting the Podium 8

The Pilot X/S Podium is adjustable for a variety of usage models. It can be used as a desk, a presentation lectern, a mobile teaching station, and more.

Moving the Podium

To move the podium, unlock the 4 wheels on the **Podium Wheel Base** by pulling up on the levers with the top of your foot. Use two hands to slowly and carefully push the podium to the desired location, and re-lock the 4 wheels once in position.

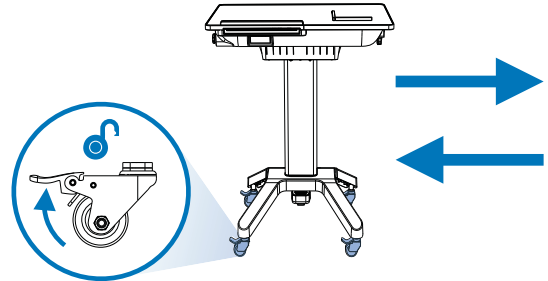

Adjusting Height

The podium uses an internal pneumatic cylinder system to make height adjustments easy. Height can range between 32 - 46 inches. To adjust the height, simply press the **Height Adjustment Foot Pedal** and push down or pull up on the **Podium Surface** with two hands. Release the foot pedal when the desired height is reached.

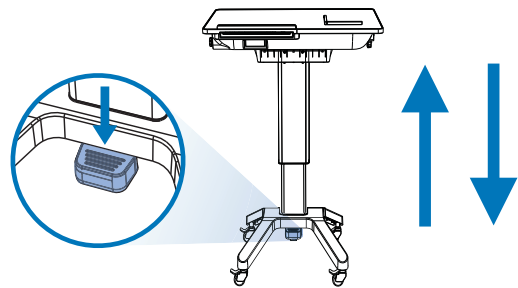

Adjusting Tilt Angle

You can easily adjust the **Podium Surface's** tilt angle to three settings: 0° (flat), 10°, and 20°. To adjust the tilt, first unlock the **Tilt Adjustment Dial** by turning it counterclockwise. With the wheel unlocked, use two hands to carefully tilt **Podium Surface** to the desired tilt angle. When you are done adjusting the tilt angle, it's important to re-lock the **Tilt Adjustment Dial** by turning it clockwise until the lock engages.

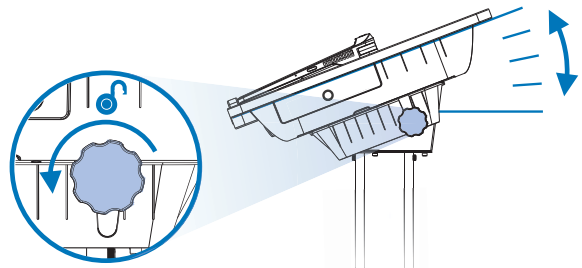

Magnetic Anti-Slip Bumpers

When using the podium in the tilted position, the included **Magnetic Anti-Slip Bumpers** can be used to keep papers and other objects from sliding off the podium. Because the **Podium Surface** is ferromagnetic, the bumpers can affix anywhere on the glass surface.

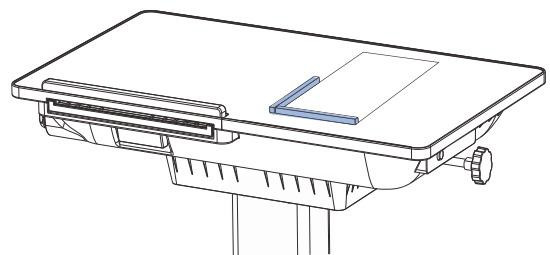

9 Charging the Podium

The **Pilot X/S Podium** features an internal battery that can charge the tablet while docked or stored in the tablet bay. This dual-charging feature extends the tablet battery life, allowing for up to 6 hours of use (depending on the usage model). The podium should be charged overnight for sufficient battery life throughout the day. When used alone, the tablet can achieve up to 3 hours of use under standard operating conditions. To conserve battery life, make sure the document camera is folded away when not in use (Page 17).

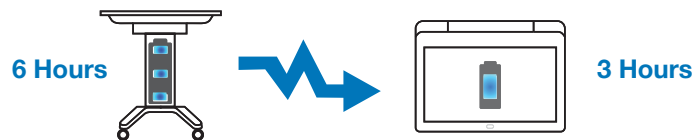

To charge the Podium, plug the **Podium Power Adapter** into an available A/C Power Outlet. Next, connect the charging connector to the **Podium Charging Port** on the right side of the podium.

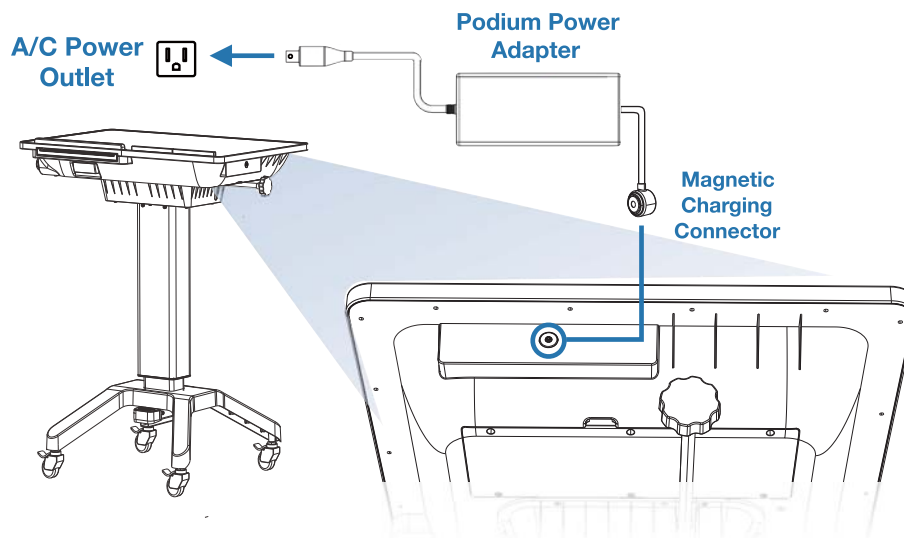

The **Podium Charging Indicator** is located on the upper left corner of the **Podium Surface**. When the podium is receiving a charge, the three blue lights on the “Pilot Internal Battery” charging indicator will flash in succession. If the indicator is not lighting up, ensure the **Podium Power Adapter** is connected properly.

When the podium is disconnected from the **Podium Power Adapter**, the **Podium Charging Indicator** will show the current battery level. Three solid blue lights mean that the podium battery is at 75%-100% of its capacity; Two solid blue lights mean that the podium battery is between 50%-74% of its capacity; One solid blue light means that the podium is between 25%-49% of its capacity; One flashing blue light means that the podium is less than 25% of its capacity, and should be charged soon.

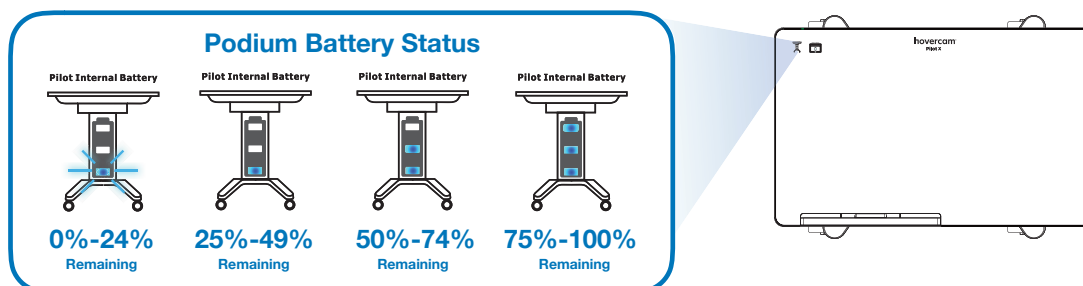

Charging the Tablet 10

The Pilot X/S Tablet has an internal battery for wireless operation. The tablet can achieve around 3 hours of standalone use under normal operating conditions. When docked on the podium, the tablet can achieve around 6 hours of use under normal operating conditions. To conserve battery life, make sure the document camera is folded away when not in use (Page 17).

There are three methods to charge the Pilot X/S Tablet:

1 Charging on the Tablet Dock

The simplest and most common way to charge the tablet is via the **Magnetic Tablet Dock**, located on the lower left corner of the **Podium Surface**. The dock also connects the tablet to the podium's **Retractable Keyboard** and the **Podium Audio Line In/Out**.

To charge the tablet on the **Magnetic Tablet Dock**, first make sure the podium battery has a charge, otherwise the podium will need to be plugged into an A/C outlet via the **Podium Power Adapter** (page 9). Place the tablet on the podium surface above the tablet dock, being sure to align the **Magnetic Docking Connectors**. With the connectors aligned, simply slide the tablet down along the podium surface until the magnets pull the tablet into position.

The **Tablet Charging Indicator** is located on the upper left corner of the **Podium Surface** next to the **Podium Charging Indicator**, and will flash when the tablet is receiving a charge. To see the tablet's current charge level, check the battery status on the Windows® 10 Taskbar.

There is a secondary **Tablet Charging Indicator** located on the upper left corner of the tablet face. When the tablet is receiving a charge, the **Charging Indicator Light** will flash amber. When the tablet has been fully charged, the indicator light will be solid amber.

When the tablet is docked and the podium is plugged-in, the podium's dual charging system uses passthrough charging. This means that the tablet's battery will be charged before the podium's battery. Once the tablet is fully charged, the podium's battery will start receiving a charge.

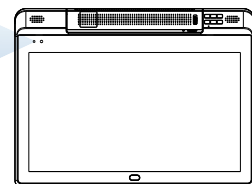
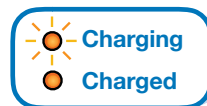
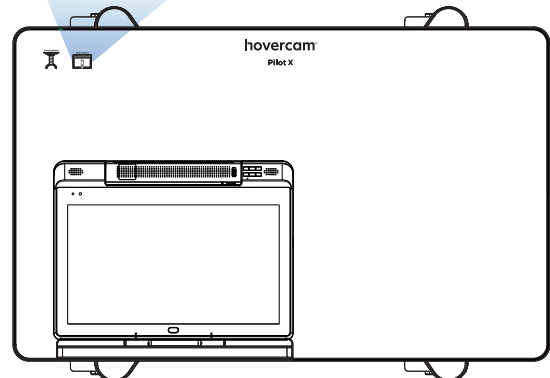
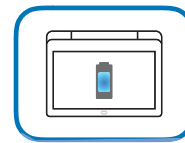
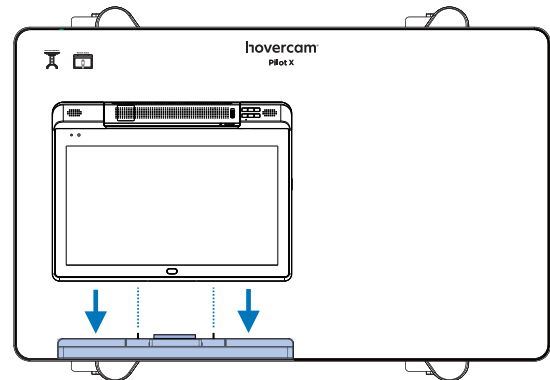

11 Charging the Tablet

2 Charging in the Tablet Storage Bay

The **Tablet Storage Bay** is a convenient and secure place to store and charge the Pilot X tablet overnight. The bay is located on the left side of the podium, and features a dropdown door that is secured by a key lock.

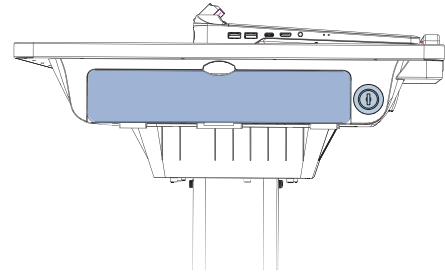

Follow these steps when using the **Tablet Storage Bay**:

1 Unlock the Door

The **Tablet Storage Bay Key Lock** is located on the left side of the **Podium Surface**, adjacent to the **Tablet Storage Bay**. Insert the key and rotate to disengage the lock, allowing for the bay door to be opened.

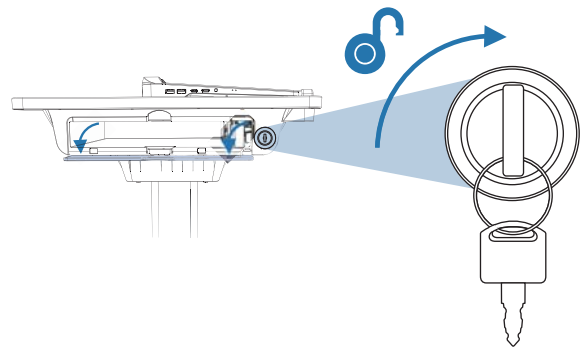

IMPORTANT!

Please make sure you make a duplicate copy of the Pilot X/S key for backup.

2 Insert the tablet

Before inserting the tablet, make sure the **Document Camera** is folded away (Page 17) and the **HoverCast Wireless Antenna** is folded down (Page 20). Orient the tablet so that the **Touchscreen** is facing upwards and the **Magnetic Docking Connector** is directly adjacent to the **Charging Actuator**, then carefully insert the tablet. When the tablet is inserted properly, you will feel the tablet click and lock into position.

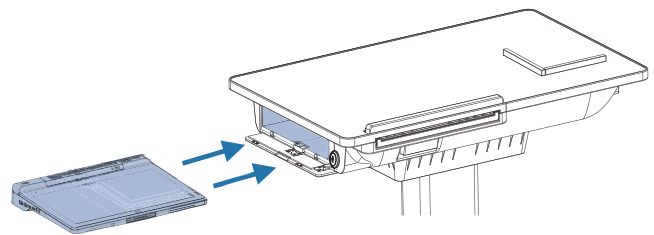

3 Lock the Tablet Storage Bay

With the tablet properly inserted into the **Tablet Storage Bay**, close the bay door, insert the key and rotate to lock the bay.

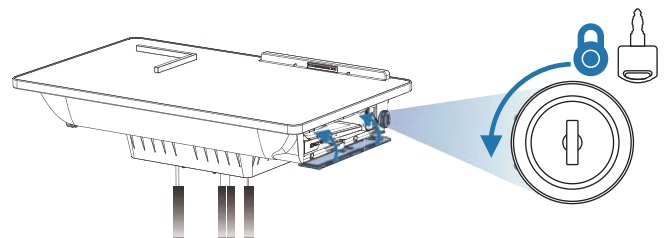

Charging the Tablet 12

4 Activate Charging

Finally, use the **Tablet Storage Bay Charging Actuator** to enable charging by pushing-in on the lever. The charging actuator is located on the underside of the podium surface, just below the Pullout Keyboard.

The **Tablet Charging Indicator** is located on the upper left corner of the **Podium Surface** next to the **Podium Charging Indicator**, and will flash when the tablet is receiving a charge. The tablet's current battery level percentage will not be displayed on the **Tablet Charging Indicator**, and must be checked on the Windows® 10 Taskbar.

Plug the power adapter into a power outlet. Connect the power adapter cord to the Pilot X/S magnetic power port. When the power cord is plugged in, the podium's dual charging system will use passthrough charging. To charge the tablet computer, insert the tablet into the tablet bay. Once the tablet is fully charged, it will be ready for use. (We recommend charging the tablet immediately after each use.)

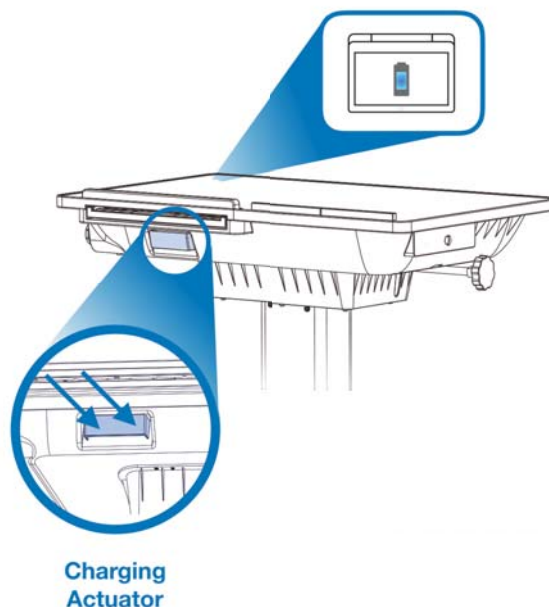

Removing the Tablet

To remove the tablet from the **Tablet Storage Bay**, you must first disengage the **Charging Actuator** by gently pulling outwards on the lever.

Finally, unlock the **Tablet Storage Bay** (see **Step 1**) and remove the tablet by pressing in on the tablet until it clicks inwards. The tablet will then release and can be gently removed from the **Tablet Storage Bay**.

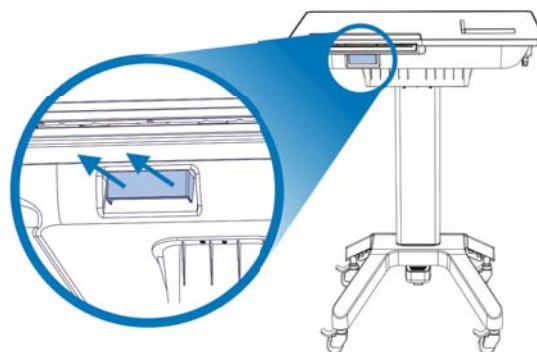

3 Charging with the Tablet Power Adapter*

The tablet can also be charged independently of the podium using the included **Tablet Power Adapter**. Simply plug the power adapter into an available A/C wall outlet, and then into the tablet's USB-C port.

When the tablet is receiving a charge, the **Charging Indicator Light** will flash amber. When the tablet has been fully charged, the indicator light will remain solid amber.

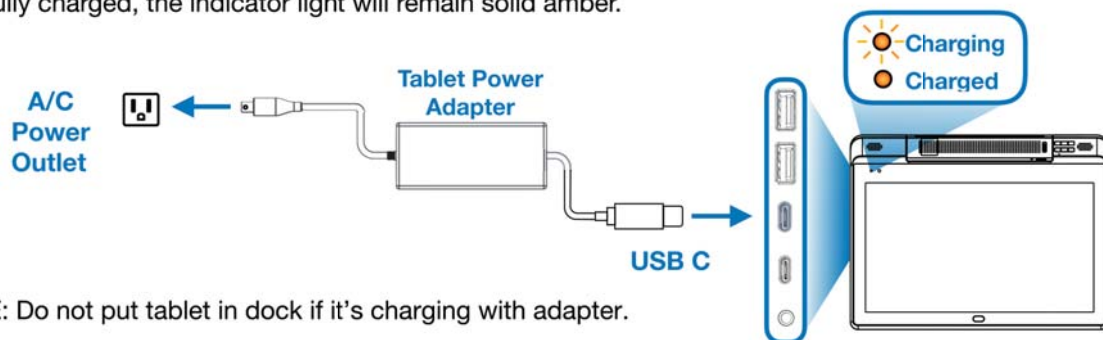

*NOTE: Do not put tablet in dock if it's charging with adapter.

13 Operating the Tablet

Powering-On

To power-on the Pilot X/S Tablet, press and hold the **Sleep/Wake Button** for approximately 3 seconds, and the HoverCam Pilot X/S boot-up screen will appear. If the tablet does not power-on, ensure that the battery is charged or receiving a charge.

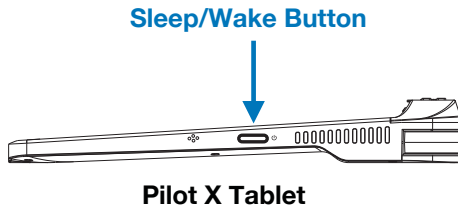

Operating the Touchscreen

The Pilot X/S tablet is equipped with a 13.3 inch capacitive multitouch screen. The capacitive technology responds to inputs from electrically charged objects, such as fingertips and active styluses, and is not pressure sensitive. **Because of this, avoid pressing too firmly on the touchscreen, as this could cause damage.**

The touchscreen is multitouch-enabled, allowing the user to scroll, zoom, swipe and more by using two or more fingers. For more information about touch gestures, visit the Windows® 10 Support page at www.support.microsoft.com/windows.

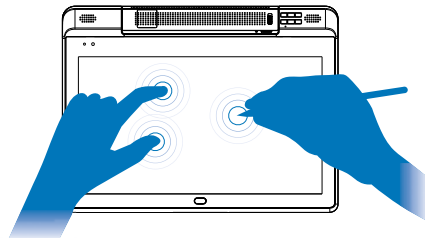

Using the Active Stylus

Pilot X/S also includes an active stylus. The active stylus must be charged through its rear charging port via the included USB mini cable. Charging the stylus takes approximately 1 hour. The usage time is approximately 8-10 hours. The active technology can be switched on and on/off button show below:

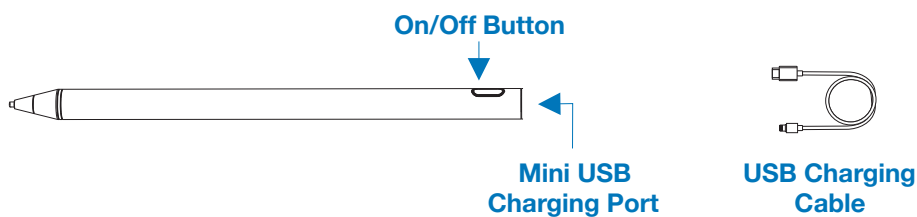

Internal PC

Pilot X/S comes fully-integrated with an internal PC. No additional computing device is required to operate Pilot X/S. See the below table for a list of key internal components and their specifications.

INTERNAL PC

	PILOTX/S	
Part Number	PilotX/S : HCPX-I5	PilotX/S : HCPX-I7
Processor	10th Gen. Intel® Core™ i5-1020Y Processor	10th Gen. Intel® Core™ i7-1020Y Processor
Operating System	Microsoft Windows 10 64-bit (license not included)	
Storage	256GB SSD	512GB SSD
Memory	8GB DDR RAM	16 GB DDR RAM
Display Adapter	Intel® UHD Graphics	

CONNECTIVITY

Wireless HDMI	4K@30fps - 60 ft range (line of sight)
Ports	USB 3.0 Type-A (x2), USB 3.0 Type-C (1x), USB Touch (x1), USB 3.0 Type-C (charge only) (1x), HDMI out (x1), Power in (1x), Audio/Headphone/Line out/Mic in (1x, 3.5mm)
Bluetooth	5.2
WiFi	Intel® WiFi 5 ac/a/b/g/n

Windows® 10

Once powered-on, Pilot X/S will operate the latest non-licensed version of Windows® 10. Essential functions, settings, operations and commands are comparable to that of a new Windows® operating desktop including interface and system presets. A Windows® license is not included, so a license key will be needed to unlock Windows® 10's full capabilities. You do not have to activate Windows® 10 for standard operations, but the system will be subject to the following limitations:

- An Activate Windows® watermark on the lower right-hand corner of the display.
- Personalization options will be inaccessible (wallpaper, accent colors, lock screen, themes, etc).

For more information on how to use your Windows® 10 operating system, see the full manual at www.support.microsoft.com/windows



Windows 10

Imaging / Formatting

Due to the complexity of installed drivers, HoverCam offers a free imaging service. HoverCam is not responsible for damages caused by unauthorized reformatting. For more information on the free imaging service, please contact HoverCam Technical Support: support@thehovercam.com

An ethernet cable can be connected via a dongle (not included) to one of Pilot X/S's **USB ports** (Type-A or Type-C) to facilitate imaging and wired networking. Note: When reformatting Pilot X/S, the reinstallation of specific drivers may be required. For convenience, the Pilot's required drivers are also preloaded on the included **USB Drive** and can be reinstalled after imaging.

15 Operating the Tablet

Tablet Mode

For users who want a more touch-friendly experience, Pilot X/S can be configured to activate tablet mode when removed from the **Magnetic Tablet Dock**. While in tablet mode, apps will open in full screen, the start menu will replace the desktop, icon sizes will increase, etc. Tablet mode can also be manually switched on or off within the action center on the taskbar. For more information on tablet mode, visit the Windows® 10 Support Page at www.support.microsoft.com/windows.

Desktop Mode

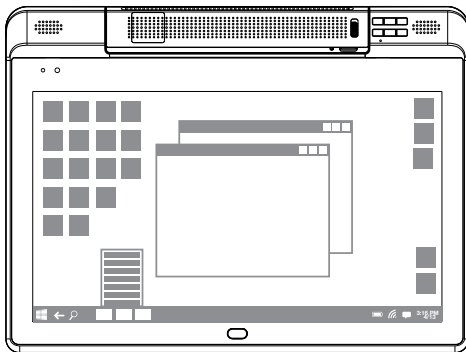

Tablet Mode

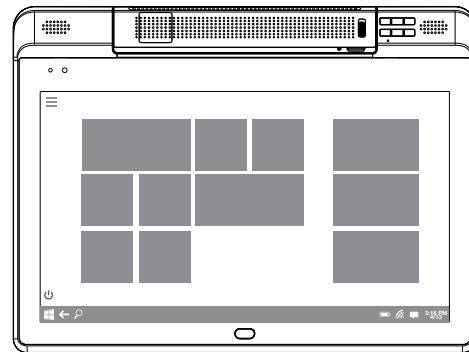

Thumb Strap

For added safety, an optional **Thumb Strap** is included with every Pilot X/S Tablet. The thumb strap allows the user to maintain a better grip on the tablet while using it independent of the podium.

WARNING: The thumb strap is *not* designed to support the full weight of the Pilot X/S tablet. Always keep two hands on the tablet, and never carry it by the thumb strap alone. Damages caused by negligent use of the thumb strap will not be covered by the factory warranty.

To install the thumb strap, first remove the adhesive film and position the strap horizontally below the underside lip as pictured below, making sure to align the 2x 10mm screw holes on the back of the tablet casing. Then use a small Phillips screw driver (not included) to secure the 2x included 10mm screws into position.

Thumb Strap Positioning

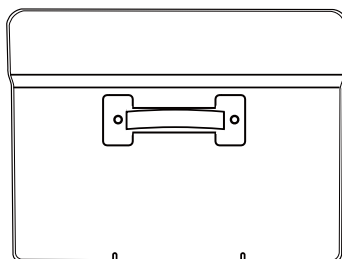

Proper Use of Thumb Strap

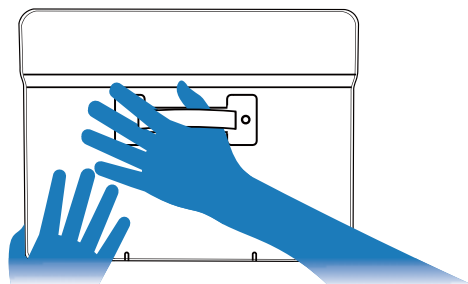

Using the Pop-Out Keyboard

The Pilot X/S tablet will connect to the podium's **Pop-Out Keyboard** when docked on the **Magnetic Tablet Dock**. To deploy the keyboard, simply push-in on its front edge and it will automatically extend. To retract, gently push it back into the unit until it locks into place.

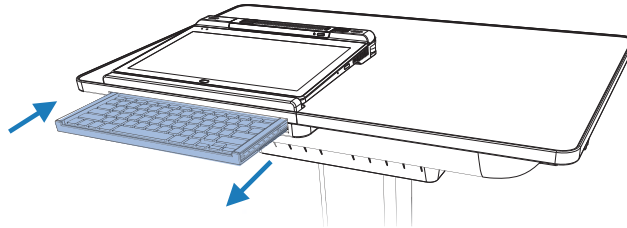

Using the Digital Keyboard

When using the tablet independent of the **Magnetic Tablet Dock**, the digital keyboard must be used for any typing input. To access the digital keyboard, simply click on the digital keyboard icon on the right side of the Windows® taskbar. If the icon is missing, you'll need to access typing settings to enable it (Windows® Settings → Devices → Typing). For more information on the digital keyboard, visit the Windows® 10 Support page at www.support.microsoft.com/windows.

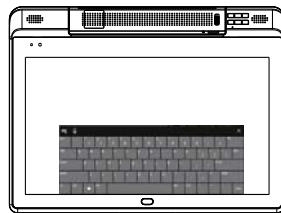

Using Third Party Accessories

Most USB third party accessories that work with standard PC's will work with the Pilot X/S. This includes mice, keyboards, flash-drives, etc. Plug the accessory into one of the two **USB 3.0 Type-A** ports located on the left side of the **Pilot X/S Tablet**. Bluetooth devices, such as a bluetooth mouse, can also be connected to the Pilot X/S. For help connecting **bluetooth** enabled devices, visit the Windows® 10 Support Page at www.support.microsoft.com/windows.

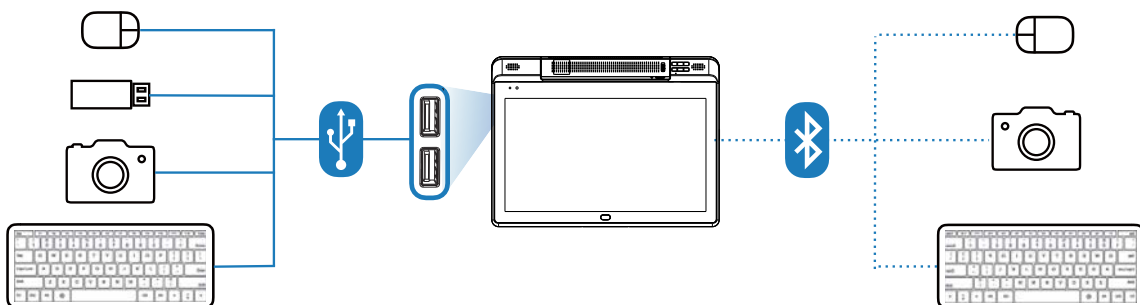

17 Document Camera

The Pilot X/S tablet comes equipped with a **Fold-Out Document Camera**. The document camera can be used as a lesson recorder, scanner, webcam, live annotation tool, microscope, show-and-tell device, audio recorder, video logger, and much more. For optimal functionality, use the included Flex 11 software (page 18) to operate the document camera. Camera specifications are as follows:

Camera Sensor	13.0 MegaPixel BSI CMOS	Zoom	480x (6x ASR, 8x Digital, 10x Mechanical)
Video Resolution	4K@30FPS, 1080p @60FPS, 720p @120FPS	Audio	Built-in High-Fidelity Microphone
Image Resolution	4224x3156 (13 MP)	Focus	AutoFocus, Selective Focus, Focus Lock
Scan Size	US Letter & US Legal	Lighting	Integrated LED

Deploying

To deploy the document camera, push-down on the **Document Camera Release Button** (a silver circular hinge found on top of the tablet), and the camera arm should release with a “click”. The camera arm can now be rotated out of its recess. Once deployed, the system will detect that the camera is in use, and it will be discoverable as a USB device. The camera arm has three moving sections: the **Post**, **Head** and **Base**.

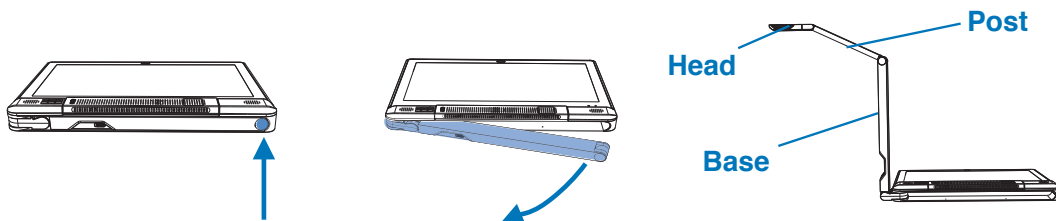

To close the document camera, simply fold the head and post back into the base, and rotate the base back into the recess until it “clicks” into place. The system will know that the camera has been folded away, and disconnect it to conserve battery.

Positioning

Once deployed, the base can pivot outwards 180°, and can tilt up or down 180°. The post folds out of the base, and adds an additional 180° range of upward/downward tilt. The head also tilts up or down 180°, and can pivot 270°. When on a flat surface, the camera’s viewable area can easily show full letter and legal sized pages when the camera arm is positioned properly.

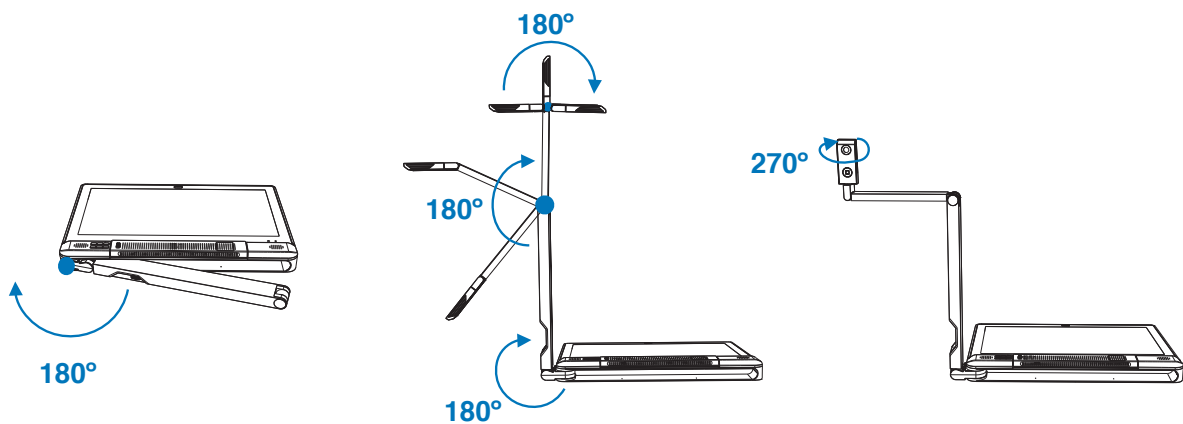

Software

The tablet comes with two document software programs preinstalled: **Flex 11**.

Questions? Contact HoverCam Technical support for more information at <http://www.hovercam.com/support>.



Flex 11 is a dedicated document camera software for live lesson presentation and annotation, video recording, still image capture, document scanning, digital whiteboarding and much more. Note: Flex Whiteboard may be installed as a separate program.

For the full software downloads, updates and training visit:

<https://www.hovercam.com/flex11>

Operating

Operating the document camera is easy with the onboard **Document Camera Controls**, found on the top right corner of the **Pilot X/S Tablet**:

- **Zoom-In**: Zooms in on the camera's view area.
- **Zoom-Out**: Zooms-out of the camera's view area.
- **Autofocus**: Enables automatic focusing on the dominate object in the camera's view area. Periodically readjusts focal point to keep the dominate object in focus.
- **Autofocus Lock**: Fixes the focal point on the most dominate object in the camera's view area, and retains that focal point until deactivated.
- **Camera Reset**: Resets the camera's main board when an error occurs. Use a small object, such as the tip of a paper clip.
- **Rotate**: Rotates the camera's image 180°.
- **Freeze**: Freezes/unfreezes the camera's image.

Please note that the **Document Camera Controls** may not be compatible with 3rd party softwares, and are designed to work best with the included **Flex 11** software program.

The document camera also features an **LED Light** for added illumination in darker areas. Toggle the **Illumination Switch** found on the **Camera Head** to activate or deactivate the LED Light.

