



StarryHub[™] | WritePad

Thank you for choosing this product. StarryHub Handwriting Tablet WritePad is an innovative new product in the industry. Please read the Getting Started Guide before use to get started quickly.

Product diagram

Whiteboard Annotations Pen slot Handwriting pen



Charging icon



power switch

Charging port Type-C

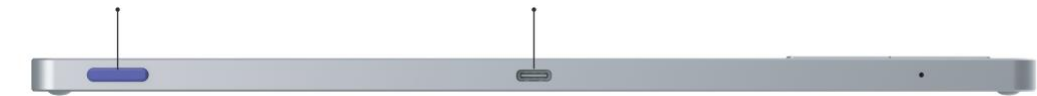

1. Equipment startup

- **Power on**

Press and hold the power switch for 2 seconds to turn on the device.

- **Shutdown**

In the power on state, long press the power switch for 2 seconds to pop up the shutdown screen, and click the "shutdown" button to shut down.

- **Standby**

When turned on, short press the power switch or put the stylus back into the pen slot to enter standby mode.

- **Three ways to wake up the device in standby mode**

Short press the power switch to automatically wake up the device;

Pick up the stylus from the pen slot and the device will automatically wake up;

Short press the "Whiteboard" or "Annotate" button to automatically wake up the device.

2. Equipment functions

The operating system of this product, WritePadOS (based on Android system), is mainly used in conference rooms and needs to be used in conjunction with StarryHub Meeting Star. It includes wireless connection, multi screen synchronization, online upgrade functions, as well as mouse, whiteboard, and annotation mode functions.

- **Pairing**

1、 Press and hold the whiteboard and annotation keys simultaneously for 3 seconds to enter pairing mode.



2、 On StarryHub Meeting Star, use the touchpad to open the handwriting whiteboard settings and add a handwriting board for pairing.



3、 Select the WritePad handwriting whiteboard for pairing and wait for about 10

seconds to complete the pairing. After successful pairing, it will automatically enter
and the whiteboard and annotation indicator lights will light up.

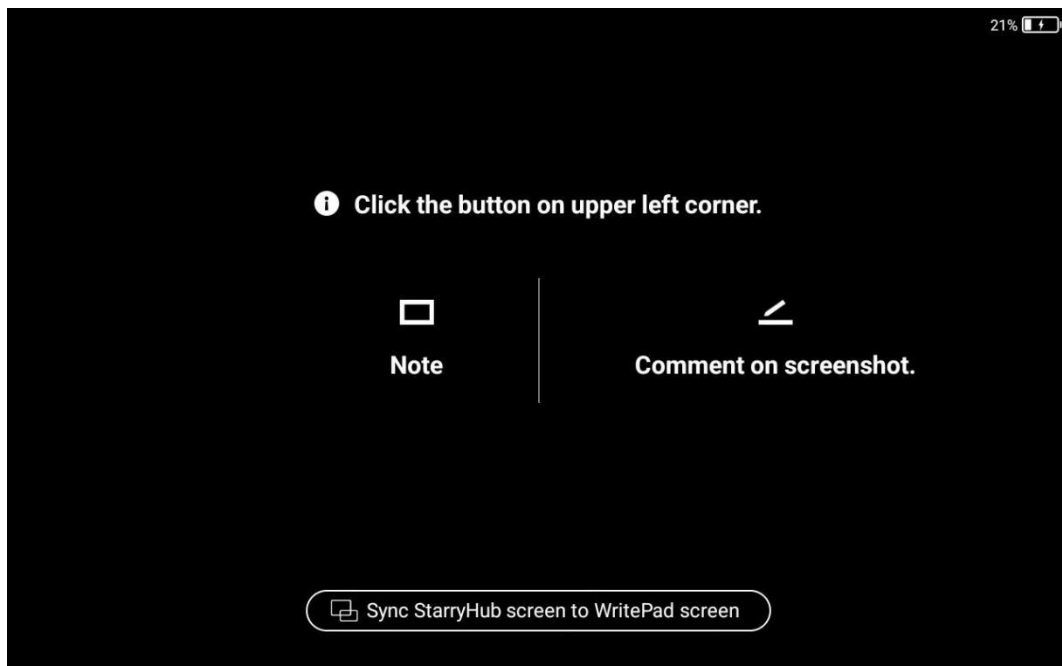

- **Mouse mode**

Click the simultaneous interpreting control button with the stylus to enter the
mouse mode, and the content of the conference star screen will be simultaneous
interpreting to the tablet.



- **Whiteboard mode**

1、 Short press the whiteboard button to enter whiteboard mode. The whiteboard light remains on and automatically opens the Meeting Star handwriting whiteboard application. Handwritten handwriting will be synchronously mapped to Meeting Star.

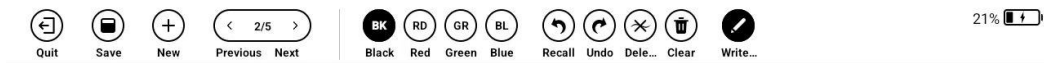

2、 The pen head comes with an "eraser" function, which can easily erase handwriting.

3、 Click the "Exit" button with the stylus to exit whiteboard mode.

- **Annotation mode**

① Short press the annotation button to enter annotation mode. The annotation light remains on and will transfer a screenshot of the current display screen of Meeting Star to the handwritten whiteboard. Handwritten handwriting will be synchronously mapped to Meeting Star.



2、Click "Exit" with a stylus to exit annotation mode.

3. Device charging

*Please do not use a voltage exceeding 5% of the standard voltage to power the product, in order to avoid abnormal operation or damage.

4、 Replacing the refill

When the pen core is worn out, it will affect the writing experience. It is recommended to use a pen core clip to replace the pen core in a timely manner.

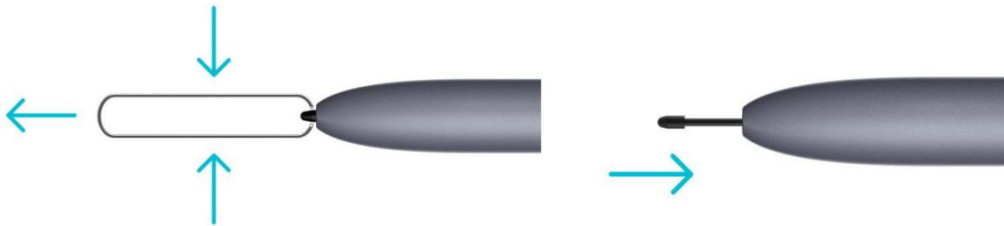

5、 Online upgrade

In the StarryHub handwriting whiteboard application settings, follow the upgrade prompts to upgrade online.

6、 Warranty Statement

Basic information

Any malfunction caused by quality issues of the product under normal use is guaranteed to be returned within 7 days, replaced within 3 months, and covered by a one-year warranty.

Exceptional clauses (the following situations are not covered by the warranty) ·

Product code for those who have not achieved success

·Non successful components or user replaced accessories, and the accessories were not purchased from the successful or designated seller of the successful consumer materials (such as natural consumption, wear and aging of the casing and plug-in

components)

- Malfunctions or damages caused by incorrect installation, operation, or in non product specified working environments (such as high or low temperature, excessive humidity and dryness, high altitude, unstable voltage or current, excessive zero to ground voltage, etc.)
- Damage caused by accidents, misuse (including exceeding work load), and misuse
- Malfunctions or damages caused by unauthorized disassembly, repair, unauthorized modification, or abuse
- Damage caused by repairs carried out by unauthorized repair centers

7、 matters needing attention

- Do not use cleaning agents to clean the equipment to avoid corrosion.
- Please keep the equipment and accessories out of reach of children.
- Please ensure to use in a dry and ventilated environment.
- Do not store the device in an excessively hot or cold place, as high (low) temperatures can shorten the lifespan of electronic components.
- Do not put the device into any heating device (such as a dryer, microwave, etc.) for drying.

8、 Contact information

Reach CZUR team via one of the following ways for support or share your comments.

Company Name: CZUR TECH CO., LIMITED

Website: www.czur.com

Sales Office: RM722, Block B, Podium of Building No. 12, Shenzhen Bay

Eco-Technology Park, No. 10 Gaoxin South RD., Nanshan District, Shenzhen, 518063, China.

Office line: 0086-755-23974826

E-mail address: support@czur.com

Software Center: Room1001,10th Floor, Block A, No.32A Huoju Road, High-tech

Industrial Zone, Dalian City, Liaoning Province, China

Factory Address: 6th Floor, Building E, Huihong Industrial Park, No. 170

Jinxiaotanghuancun Road, Fenggang Town, Dongguang city, Guangdong province, 523690, China.

FCC STATEMENT

This device complies with part 15 of the FCC Rules. Operation is subject to the following two conditions: (1) This device may not cause harmful interference, and (2) this device must accept any interference received, including interference that may cause undesired operation. Any Changes or modifications not expressly approved by the party responsible for compliance could void the user's authority to operate the equipment. Note: This equipment has been tested and found to comply with the limits for a Class B digital device, pursuant to part 15 of the FCC Rules. These limits are designed to provide reasonable protection against harmful interference in a residential installation. This equipment generates uses and can radiate radio frequency energy and, if not installed and used in accordance with the instructions, may cause harmful interference to radio communications. However, there is no guarantee that interference will not occur in a particular installation. If this equipment does cause harmful interference to radio or television reception, which can be determined by turning the equipment off and on, the user is encouraged to try to correct the interference by one or more of the following measures: -Reorient or relocate the receiving antenna. -Increase the separation between the equipment and receiver. -Connect the equipment into an outlet on a circuit different from that to which the receiver is connected. -Consult the dealer or an experienced radio/TV technician for help. *RF warning for Portable device:

The device has been evaluated to meet general RF exposure requirement. The device can be used in portable exposure condition without restriction.

FCC Caution.

This device complies with part 15 of the FCC Rules. Operation is subject to the following two conditions: (1) This device may not cause harmful interference, and (2) this device must accept any interference received, including interference that may cause undesired operation.

Any Changes or modifications not expressly approved by the party responsible for compliance could void the user's authority to operate the equipment.

Note: This equipment has been tested and found to comply with the limits for a Class B digital device, pursuant to part 15 of the FCC Rules. These limits are designed to provide reasonable protection against harmful interference in a residential installation. This equipment generates uses and can radiate radio frequency energy and, if not installed and used in accordance with the instructions, may cause harmful interference to radio communications. However, there is no guarantee that interference will not occur in a particular installation. If this equipment does cause harmful interference to radio or television reception, which can be determined by turning the equipment off and on, the user is encouraged to try to correct the interference by one or more of the following measures:

- Reorient or relocate the receiving antenna.
- Increase the separation between the equipment and receiver.
- Connect the equipment into an outlet on a circuit different from that to which the receiver is connected.
- Consult the dealer or an experienced radio/TV technician for help.

Specific Absorption Rate (SAR) information:

This device meets the government's requirements for exposure to radio waves. The guidelines are based on standards that were developed by independent scientific organizations through periodic and thorough evaluation of scientific studies. The standards include a substantial safety margin designed to assure the safety of all persons regardless of age or health. FCC RF Exposure Information and Statement the SAR limit of USA (FCC) is 1.6 W/kg averaged over one gram of tissue. Device types: WritePad(FCC ID: 2AYK3-WRITEPAD) has also been tested against this SAR limit. This device was tested for typical body-worn operations with the back of the device kept 0mm from the body. To maintain compliance with FCC RF exposure requirements, use accessories that maintain a 0mm separation distance between the user's body and the back of the WritePad . The use of belt clips, holsters and similar accessories should not contain metallic components in its assembly. The use of accessories that do not satisfy these requirements may not comply with FCC RF exposure requirements, and should be avoided.

Regarding this product manual (hereinafter referred to as the "Manual")

Thank you for purchasing products from Shenzhen Chengzhe Chuangxiang Technology Co., Ltd. (hereinafter referred to as "Chengzhe Company" or "Chengzhe"). For your safety and interests, please read the instructions carefully before use. If you fail to follow the instructions or precautions and cause losses or injuries, the company will not be responsible.

The copyright of the instruction manual belongs to the company that completed it; If the content of the manual is inconsistent with the actual product, the actual product shall prevail. If you have any objections to the content or terms of the manual, please submit a written objection to the company within seven days after purchase. Otherwise, it will be deemed that you have agreed to understand all the contents of the manual.

Winners reserve the right to interpret and modify the instructions