

SGS PRO Smart Electric Engraving & Polishing Pen (Bluetooth version 4.2)

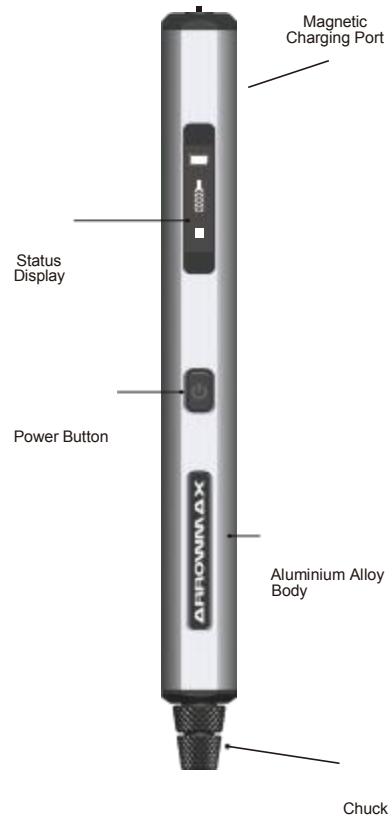

Thank you for choosing SGS PRO (Smart Electric Engraving & Polishing Pen). Please read the instructions manual carefully.

Product description:

SGS PRO Smart Electric Engraving & Polishing Pen equipped with the best 32-bit microprocessor, 3-axis gyroscope and has a HD OLED interface.

SGS PRO enters the automatic working mode of gear A, and intelligently senses the rotation of human hand. The speed and torque can be adjusted according to the rotate range, so as to realize true infinitely variable speed, from the speed of 10000-20000r/min can be adjusted arbitrarily.

SGS PRO also comes with 4 customizable modes, available through the ARROWMAX mobile app for Android and IOS. Adjusting speed by every 500RPM and rotation direction for each mode. You may save your personal setting to the mode you want. To personalize your SGS PRO easily.

SGS PRO is designed with a power button to operate easier. During the working process, the OLED screen animation shows the working status, it also shows the current remaining power, and animation of charging status.

The SGS PRO handle is square shape. With magnetic charging design. The specially formulated high-capacity LiPo battery makes more efficient use of the internal space of the product, and the LiPo battery capacity reaches 500mAh. With magnetic charging design, it can be used for 2 hours when fully charged in 80 minutes. The standby time can be up to 90 days, and the LiPo battery we use has passed the US TUV certification.

The SGS RPO is the most advanced and professional version of its predecessor. It will be able to connect using mobile applications via Bluetooth to adjust and finetune the torsional force and speed to meet the needs of each individual.

SGS PRO comes with aluminum alloy storage box, which is convenient for storage and management of all accessories. Containing 12 polishing bits and 30 engraving bits. The parts are CNC precision machined, so that every work can be precise and agile!

Operation method:

Gear setting: Press the power button three times to enter the gear setting interface, press the power button to select the working mode. After finished selection, let go and wait for two seconds. It automatically return to the standby interface.

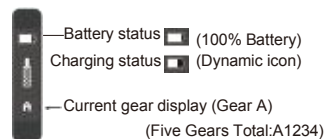

The charging interface

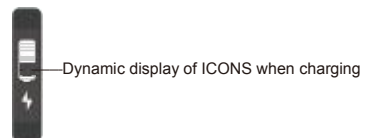

Gear Setting Interface (Five Gears Torque)

- A) Auto sensing mode, the rotation speed is controlled according to the angle of the hand rotation
- 1) 12500RPM Small speed
 - 2) 15000RPM Medium speed
 - 3) 17500RPM High speed
 - 4) 20000RPM Maximum speed



- ① - Inner Box
- ② - SGS PRO Smart Mini Electric Engraving & Polishing Pen
- ③ - Polishing bit
- ④ - Storage Box
- ⑤ - Engraving bit



⑤ -Engraving bit

Storage Instructions:

- ✎ Press the top of the storage box, the inner box of the storage box pops out to open.
- ✎ Press the top of the inner box once more to close the storage box.

SGS PRO storage:

- ✎ The SGS PRO is fixed to the inner box of the storage box in the form of a buckle.
- ✎ After use, place the SGS PRO back into inner box.
- ✎ Polishing bits & engraving bits are fixed in the inner box.
- ✎ After use, place the polishing bits & engraving bits back into position.

Installation of bits:

- ✎ Take out the bit from the inner box of the storage box. There are two parts of chuck. 1: Hold the bottom part of chuck, then loose the chuck. 2 Place the bit. 3 Hold the bottom part of chuck, Tight it up.

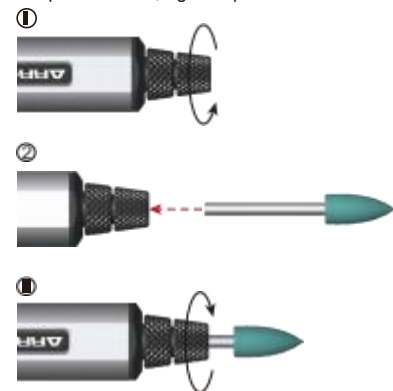

Working Status:

In Bluetooth mode:

Press and hold the power button, and turn the engraving & polishing pen clockwise with the gesture to the right, the polishing bits turns right, the polishing bit symbol on the OLED screen moves down, and the arrow symbol dynamically displays to the right; Press again to stop.

Press and hold the power button, turn the engraving & polishing pen anti-clockwise to the left, the gesture moves to the left, the polishing bits turns left, the polishing bit symbol on the OLED screen moves up, and the arrow symbol dynamically displays to the left; Press again to stop.

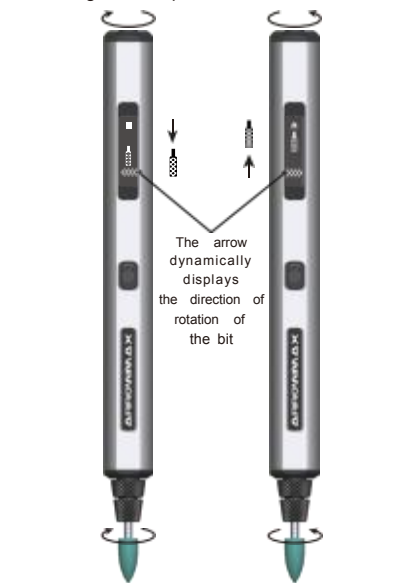

In the 1/2/3/4 gear mode:

Press the power button, the drill bit turns right, the polishing head symbol on the OLED screen moves down, and the arrow symbol dynamically displays to the right; Press again to stop.

Product parameters:

Product model: AM-199213
Battery voltage: 3.7V
Size: 15 x 15 x 142 mm
LiPo battery: 500 mAh
Weight: 55g
No-load speed: 20000r/min
Charging time: 80 minutes

Product list:

- (1) SGS PRO Smart Electric Engraving & Polishing Pen
- (1) Aluminum alloy storage box
- (1) Type-C USB magnetic cable
- (12) Polishing bits
- (30) Engraving bits

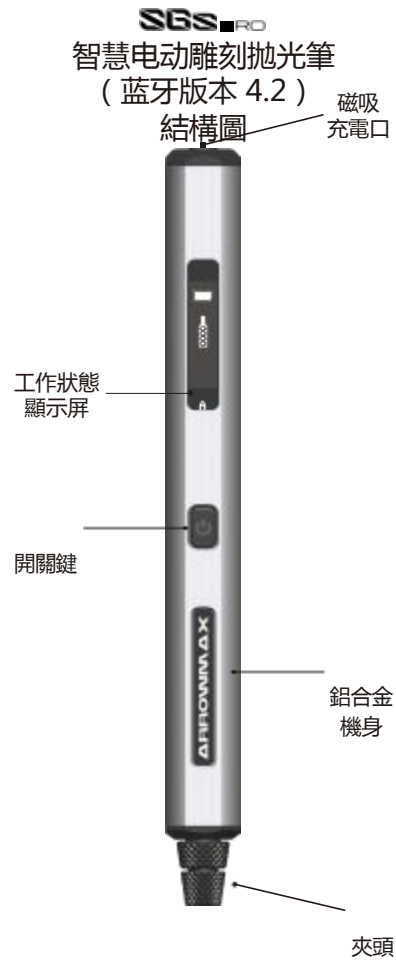

感谢您使用本公司的智慧电动雕刻抛光笔。为了让您更好的体验产品，请仔细阅读说明书。

產品描述

SGS PRO 配備了32位微計算芯片，三軸陀螺儀和 OLED 高清數字動態顯示屏，通過複雜而精確的算法，能夠智能感應而進行工作，從而實現一鍵啟動所有，達到行業內的最高配置。

SGS PRO 進入A檔自動工作模式，智能感應人手的轉動幅度而進行轉動方向和轉速快慢的調節，實現真正的無級變速，從10000-20000r/min的速度任意調節。

SGS PRO另外配置有4種自定義模式，可以通過於Android和IOS的 ARROWMAX 專屬手機應用程序以500rpm自定義轉速和每個模式的轉動方向，儲存個人設定，輕鬆個人化你的SGS PRO。

SGS PRO 設計只有一個開關鍵，讓工作更簡便，無論是進行雕刻/拋光工作，或選擇進入任何一個工作模式，只需要按同一個開關鍵完成。工作過程中，OLED 屏動畫顯示拋光頭/雕刻頭的工作狀態，OLED 屏長期提示當前所剩電量，並動畫顯示充電狀態。

SGS PRO 在更換拋光頭和雕刻頭時的操作也相當簡單，不需要使用其它工具，只要扭開夾頭即可輕鬆取出、置入拋光頭/雕刻頭，接著鎖緊夾頭即可立即操作。

SGS PRO 手柄採用了方形帶圓弧面的形狀，使得工作期間更好控制雕刻拋光筆，握感更舒適。特殊配製的高容量鋰電池，更有效地利用了產品的內部空間，鋰電池容量達到500mAh，使得SGS PRO的工作時間比其他產品更長。採用磁吸充電設計，只要充電80分鐘即可使用2小時，待機更可長達90天，所用鋰電池更通過了美國TUV認證。

SGS PRO 採用了鋁合金收納盒，方便所有配件的存放和管理，收納了12支拋光頭和30支雕刻頭，從裡到外的零件均採用CNC精密加工，在電腦程式準確控制之下確保一致的高品質，讓每次工作都能精準利落！

操作方法

檔位設置：連續按三次開關鍵，進入檔位設置界面，單按開關鍵進行選擇雕刻拋光筆的工作檔位，選擇完成後，鬆手等待兩秒，數據保存後自動返回待機界面。

待機界面：

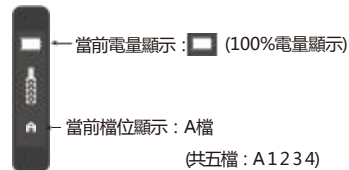

充電界面：



檔位設置界面：(五檔自由調節)

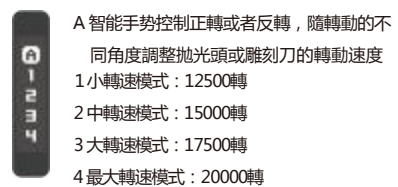

- ① - 收納盒內盒
② - 智慧迷你雕刻拋光筆
③ - 拋光頭
④ - 收納盒外殼



- ⑤ - 雕刻頭

收納盒開合

按壓收納盒頂部，收納盒內盒彈出開啓。

再次按壓收納盒內盒頂部，收納盒閉合。

注意：按壓收納盒內盒後，內盒彈出，此時內盒容易滑落。

雕刻拋光筆收納

雕刻拋光筆以卡扣形式固定於收納盒內盒。

使用完畢後，將雕刻拋光筆按壓歸位內盒中。

拋光頭/雕刻刀收納

拋光頭/雕刻刀以卡扣形式固定於內盒中。

使用完畢後，將拋光頭/雕刻頭按壓歸位內盒中。

拋光頭/雕刻刀安裝
從收納盒內盒中取出拋光頭/雕刻頭，①向右邊扭開夾頭，②置入拋光頭/雕刻頭，③接着向左邊鎖緊夾頭即可立即操作。

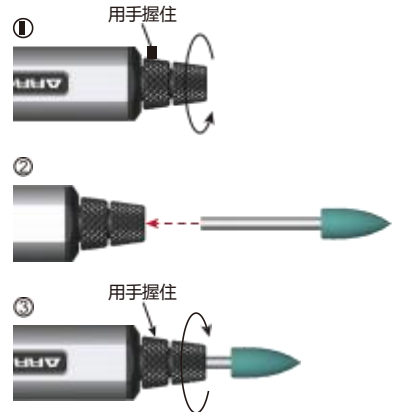

工作狀態

藍牙模式下

按住開關鍵，手勢向右順時針轉動雕刻拋光筆，即拋光頭/雕刻頭右轉，OLED屏的拋光頭標誌圖往下移動，同時箭頭標誌動態顯示向右；再按停止。

按住開關鍵，手勢向左逆時針轉動雕刻拋光筆，即拋光頭/雕刻頭左轉，OLED屏的拋光頭標誌圖往上移動，同時箭頭標誌動態顯示向左；再按停止。

1/2/3/4檔模式下

按住開關鍵，雕刻拋光筆右轉，即拋光頭/雕刻刀右轉，OLED屏的磨頭標誌圖往下移動，同時箭頭標誌動態顯示向右；再按停止。



產品參數

產品型號：AM-199213	電池電壓：3.7V
尺寸：15x15x142mm	鋰電池：500mAh
重量：55g	空載轉速：20000r/min
充電時長：80分鐘	

產品清單

- 智慧电动雕刻拋光筆x1
- 鋁合金收納盒x1
- 磁吸充電線x1
- 拋光頭x12
- 雕刻頭x30

This device complies with part 15 of the FCC Rules. Operation is subject to the following two conditions: (1) This device may not cause harmful interference, and (2) this device must accept any interference received, including interference that may cause undesired operation.

Any Changes or modifications not expressly approved by the party responsible for compliance could void the user's authority to operate the equipment.

Note: This equipment has been tested and found to comply with the limits for a Class B digital device, pursuant to part 15 of the FCC Rules. These limits are designed to provide reasonable protection against harmful interference in a residential installation. This equipment generates uses and can radiate radio frequency energy and, if not installed and used in accordance with the instructions, may cause harmful interference to radio communications. However, there is no guarantee that interference will not occur in a particular installation. If this equipment does cause harmful interference to radio or television reception, which can be determined by turning the equipment off and on, the user is encouraged to try to correct the interference by one or more of the following measures:

- Reorient or relocate the receiving antenna.
- Increase the separation between the equipment and receiver.
- Connect the equipment into an outlet on a circuit different from that to which the receiver is connected.
- Consult the dealer or an experienced radio/TV technician for help.