

D I V E

4-WAY BEAUTY DEVICE MANUAL

RF Lifting Care (Recommended to perform twice a week)

- Thermal energy of radio frequency reaches deep into the skin, which helps improve skin elasticity.
- Use of a metal material proven for medical use

[How to Use]

1. Thoroughly wash your face before using this device.
2. After connecting the RF LIFTING CARE head to the body, apply a massage gel or cream to the skin.
(※Be sure to apply a sufficient layer to the skin in order to experience the full effect of the product without irritation.)
3. Press the power button to turn it on.
4. Hold the device with one hand and gently massage the skin.
5. During operation, the device will vibrate at regular intervals at beep at 30 seconds intervals. The device will turn off automatically after 5 minutes of use.
6. After you finish massaging your face, please wash your face with warm water.

7. After using the device, remove the head and clean it with a soft dry cloth.
8. Press the power button briefly to change the mode.

[Massage Steps]

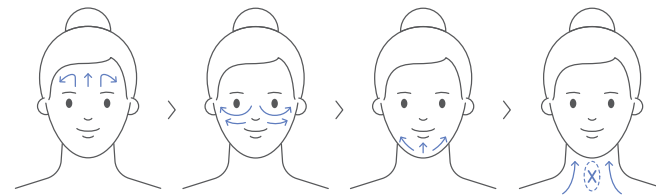

※ Avoid using it on the throat area where the thyroid is located.

Ionsono Booster

- GALVANIC : Galvanic current with negative ions helps active ingredients such as vitamin C found in your skincare product to be absorbed into your skin.
- ULTRASONIC WAVE : The ultrasonic micro-vibration infiltrates the dermis and helps the active ingredients penetrate deep into the skin.
- Use of a metal material proven for medical use.

[How to Use]

1. Thoroughly wash your face before using this device.
2. After connecting the IONSONO BOOSTER head to the body, apply a sufficient amount of your chosen skin care product for you skin type.
(※Please note that skincare products containing sunscreen ingredients or denatured alcohol may reduce the effect.)
3. Turn on the device.
4. Make sure your hand touches the metal area on the back of the device and gently massage the skin.
(※ Vibration is activated when your hand and the metal area on the back of the device come in contact, and if not, the effect may be reduced.)

5. During operation, the alarm every 30 seconds, and after 5 minutes, the device will turn off automatically.
6. After using the device, remove the head and clean it with a soft dry cloth.
7. Press the power button briefly to change the mode.

[Massage Steps]

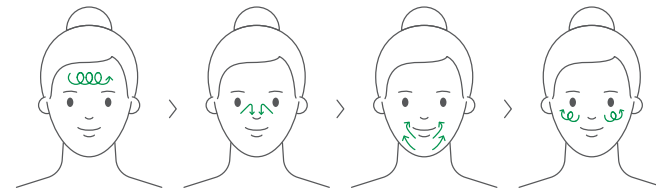

LED

- The red 650nm LED and IR 850nm LED penetrate the deep skin layers, helping to improve skin elasticity and brighten your complexion.

[How to Use]

1. Thoroughly wash your face before using this device.
2. Connect the LED head to the body and apply the skincare product for you skin type.
(※Please note that skincare products containing sunscreen ingredients, denatured alcohol or retinol may reduce the effect.)
3. Press the power button to turn it on.
(※Avoid staring directly into the LED light during operation.)
4. Do not hold the head when turning on the power. Device may not operate normally.
5. During operation, the alarm every 30 seconds, and after 5 minutes, the device will turn off automatically.
6. After using the device, remove the head and clean it with a soft dry cloth.
7. Press the power button briefly to change the mode.

[Massage Steps]

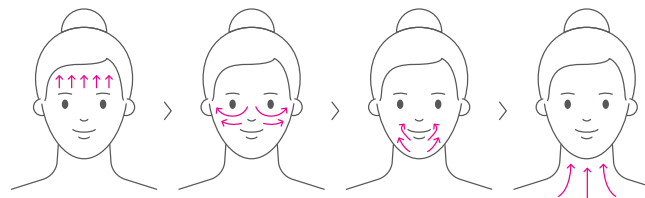

TIP : It is more comfortable to use if you pass the cable behind your ear.

Galvanic Mask Connector

- GALVANIC : Galvanic current with negative ions helps active ingredients such as vitamin C found in your skincare product to be absorbed into your skin.
- Recommended for use with DIVE Vitamin Care Mask (Purchase separately)

[How to Use]

1. Thoroughly wash your face before using this device.
2. Connecting the GALVANIC MASK CONNETTOR head to the body and apply the Dive vitamin care mask (Can be purchased separately) evenly onto your face in order.
3. Use the tongs to connect the mask to the device, and then press the power button to turn it on.
4. Make sure your hand touches the metal area on the back of the device.
(※If your hand does not touch the metal area on the back of the device, the effect may be reduced.)
5. During operation, the alarm every 30 seconds, and after 5 minutes, the device will turn off automatically.
6. Remove the tongs from the mask sheet, and remove the mask from the face after 10-20 minutes.

7. Gently pat any remaining formula into skin.
8. After using the device, remove the head and clean it with a soft dry cloth.

[Massage Steps]

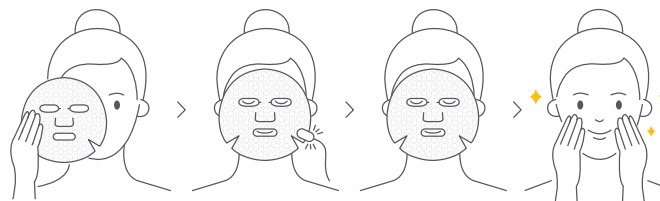

Skin Care Routine

I. RF LIFTING CARE (USE TWICE A WEEK)

Apply gel or cream on your face and use RF Lifting Care head to take care of your skin.

II. IONSONO BOOSTER (USE ONCE A DAY)

Apply a basic skincare product that suits your skin type, then use Ionsono Booster head for intensive moisturizing care.

III. LED (USE ONCE A DAY)

Apply the skincare product for your skin type and use LED head for light therapy.

IV. GALVANIC MASK CONNETOR (USE TWICE A WEEK)

Apply DIVE VITAMIN CARE MASK (Can be purchased separately) evenly onto your face in order. Connect Galvanic Mask Connector head to the mask to infiltrate the skin with vitamin C for your skin.

This device is a skin care device, not a medical device; its function helps you get better skin but does not provide any medical effect.

△Precautions

- Do not continuously use the device over the same area of skin, keep moving the device to other areas.
 - If you press too hard when using the device, the head may disconnect, so to avoid this please massage gently.
 - After 5 minutes of use the device will automatically turn off. If you use more than the recommended number of times, problems such as skin irritation may occur.
 - After using the device, remove the head and clean it with a soft, dry cloth wiping away and excess cream or gel.
- (※Do not use alkaline cleaners or alcohol, thinner or acetone to clean the product.)

Description

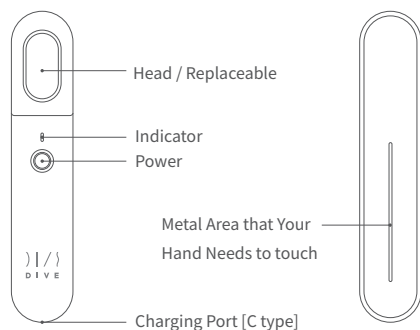

[ON]

Connect the head to the device and hold the power button for 2 seconds to turn it on.

[OFF]

After 5 minutes, the device will automatically turn off.

Press power button for 2 seconds to turn off the device; it will also turn off when the head is disconnected.

Components

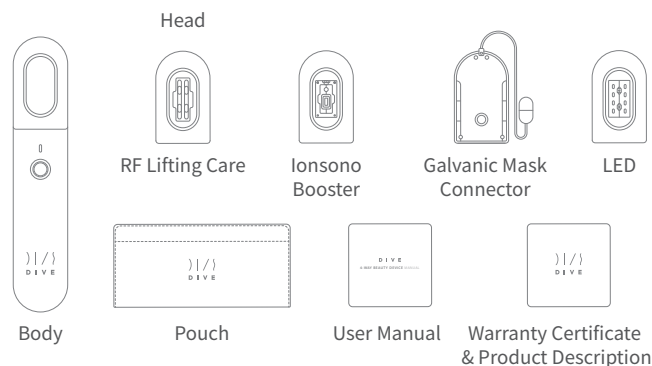

Bluetooth

[How to pairing]

STEP 1. Use the official app 'DIVE' to use bluetooth service that DIVE provides.

(version that contains bluetooth)

STEP 2. Download the official DIVE application on app store or play store.

STEP 3. Approve using a bluetooth on your phone in the app.

STEP 4. Go to tap Settings > Bluetooth > turn on the Bluetooth to activate bluetooth on your phone.

STEP 5. Combine the head with body and press the power button.

STEP 6. Tap the 'DIVE 4-WAY' on a Bluetooth search list to pair a bluetooth in the app.

STEP 7. Bluetooth will be connected automatically.

Note for Charging

- Since this device has a built-in battery, it needs to be fully charged before its first use.
 - The device does not work while charging, please unplug the charger before use.
 - Battery capacity : 2000mAh
- (※The battery is a consumable item, so the battery life will gradually decrease over time.)







[How to Charge]

- ① Connect the Type C cable to the charging adapter. (Not supplied)
- ② Connect the cable to the charging port on the bottom of the device.
- ③ Connect the charging adapter to a power outlet.
- ④ A green light will appear on the device to indicate that it is fully charged.

△ NOTE

- Charge it with a voltage: DC 5V 1A (USB Type-C) adapter.
- Do not charge it by connecting it to any other power supply or circuit, such as a laptop or desktop. This may damage the battery or cause a fire.
- This device does not have PD type (fast charging) charging function.
- Use a designated service center to remove or replace the battery.
If not replaced correctly, there is a risk of explosion.
- If the battery is discharged and not used for a long time, the battery life may be reduced.
- Battery removal and replacement require additional costs.

[Indicator]

Blue	Blue light flashing	Green	Green light flashing	Red	Red light flashing
					
During using No.1 mode	During using No.2 mode	Charged fully	while charging	When charging needed on using No.1 mode	When charging needed on using No.2 mode

- Blue light is displayed when the device is operating on No.1 mode.
- A flashing blue light is displayed when the device is operating on No.2 mode.
- Green light is displayed once fully charged.
- A flashing green light is displayed during charging.
- Red light during use indicates that the battery is low on using No.1 mode.
- A flashing red light during use indicates that the battery is low on using No.2 mode.
- When charging is complete, the red light will change to green to indicate its fully charged.

Precautions

Please read the safety precautions carefully before using the device. We are not responsible for any damage caused by carelessness.

[For Safety Use]

- Please consult a specialist before use if you :
are recovering skin from skin-related procedures, such as plastic surgery, and hair replacement procedures. / have cardiovascular disease / have endocrine disorder / have disorders of the nervous system / have an eye disease or went undergone

- ophthalmic surgery lately / have an infectious disease / have thyroid disease / have symptom of epilepsy / taking medication to treat hormonal imbalance / have skin allergies or acne prone skin / have a wound, skin disease or skin irritation / wearing medical electronics devices or a metal prosthesis. / have other diseases or illnesses
- We recommend that you test your skin care products with the device on the inside of your arm before using it on your face.
- If skin dries, use the device less and use cream for moisturizing immediately after use.
- When using this device on the neck, avoid using the thyroid-necked area.
- Avoid direct contact with the oral cavity and eyes and ears.
- Do not point the LED light directly into your eyes.
- Do not wear precious metal while using the product, and do not allow other metal to come into contact with the device.
- Do not continue to use the head of the device on only one part of the skin, but instead move it according to the manual instructions (Except galvanic mask connector).
- Do not use this device immediately after shaving.
- Regardless of whether the device is used or not, if the skin becomes sensitive due to internal or external factors, use it after the skin returns to normal or consult a specialist.
- There may be various types of skin irritation depending on the individuals skin condition when using this device. If there are skin irritations, reduce the number of uses. If the same irritation persists, discontinue use and consult a specialist.
- It is not recommended for woman during menstruation, pregnant or lactating women since the hormone balance is unstable and the skin trouble may temporarily get worse.
- Keep out of reach of infants.

△ Precautions

- Do not use the device for purposes other than those described in this manual.
- Do not use if your hands have cleansing foam or cleaning agents on them.
- Do not disassemble, repair or modify this unit yourself or anyone other than our company's repair team.
- Be careful not to let water enter and prevent the device from falling off.
- Do not use high voltage appliances near this unit. Electric shock may occur, and this unit may malfunction.
- Do not puncture the device with any sharp metal objects.
- Do not place volatile liquids nearby.
- Do not expose to direct sunlight and avoid contact with hot water.
- Connect to a certified power adapter and charge the plug with 100-240V.
- Do not use this device while driving or walking.
- The device can do basic waterproofing, but please do not use it while washing or bathing; This may cause electric shock or fire.

- If the product emits smoke or smells strange, turn it off immediately. If the product is being charged, unplug the adapter and contact our Customer Center.
- If the device is cracked or damaged, do not use it and contact the customer center.

How to Store

- After use, please wipe the head and body with a soft dry cloth.
- When not using the product, keep it in the shade where the humidity is low and well ventilated.
- Do not let plastic or rubber-like substances come into contact with the product for a long amount of time.
- Do not store in places where it may be exposed to external shock or prone to falling off.
- Do not put it in a dishwasher, oven or washing machine.
- Do not leave it in an unsafe place. Do not drop or hit the product.
- Do not use or store near fire or flammable materials.
- Do not use or store in high temperatures (over 40°C) or low temperatures (0°C) or places with a humid environment.
- Do not cause the device any form of shock such as dropping or hitting or leave it in a closed place such as a car for a long time. It may cause an explosion or fire.
- If left unused for long periods of time, battery life may be shortened, so regular charging is recommended.

Specification

Product Name DIVE 4-WAY BEAUTY DEVICE

Model B4W, B4WR, B4WI, B4WG, B4WL

Size 39(W) x 194(H)mm

Weight 300g

Battery Rechargeable Battery - 3.7V 2000mAh Li-Polymer

Manufactured by ACT International Co.,Ltd.

Date of Manufacture Notation separately

DIVE 4-WAY BEAUTY DEVICE

www.diveintoskin.com

Copyright © 2020 ACT INTERNATIONAL Inc. All rights reserved

MADE IN KOREA

a. Rule Part 15.19(a)(3): This device complies with part 15 of the FCC Rules. Operation is subject to the following two conditions: (1) This device may not cause harmful interference, and (2) this device must accept any interference received, including interference that may cause undesired operation.

b. Rule Part 15.21: The users manual or instruction manual for an intentional or unintentional radiator shall caution the user that changes or modifications not expressly approved by the party responsible for compliance could void the user's authority to operate the equipment.

Note: This equipment has been tested and found to comply with the limits for a Class B digital

NOTE: This equipment has been tested and found to comply with the limits for a Class B digital device, pursuant to part 15 of the FCC Rules. These limits are designed to provide reasonable protection against harmful interference in a residential installation. This equipment generates, uses and can radiate radio frequency energy and, if not installed and used in accordance with the instructions, may cause harmful interference to radio communications. However, there is no guarantee that interference will not occur in a particular installation. If this equipment does cause harmful interference to radio or television reception, which can be determined by turning the equipment off and on, the user is encouraged to try to correct the interference by one or more of the following measures:

- Reorient or relocate the receiving antenna.
- Increase the separation between the equipment and receiver.
- Connect the equipment into an outlet on a circuit different from that to which the receiver is connected.
- Consult the dealer or an experienced radio/TV technician for help