

1. Product parameters

Product mode:

Usage: head wear type

Transmission radius: barrier free 10m

Bluetooth version: V5.0

Standby time :300 hours

Working hours: About 4 hours

Music playing time: 5H

Charge time: 2-3 hours

Battery capacity: 200mAh rechargeable lithium battery

2. Product function

Voice prompt: support

Card function: support

Audio line input: support

Applicable products: Apple, Samsung, Huawei and other mobile phone with Bluetooth, iPad and other Bluetooth enabled laptops and desktop computers

Note: Computers without Bluetooth function need to be used with a Bluetooth adapter

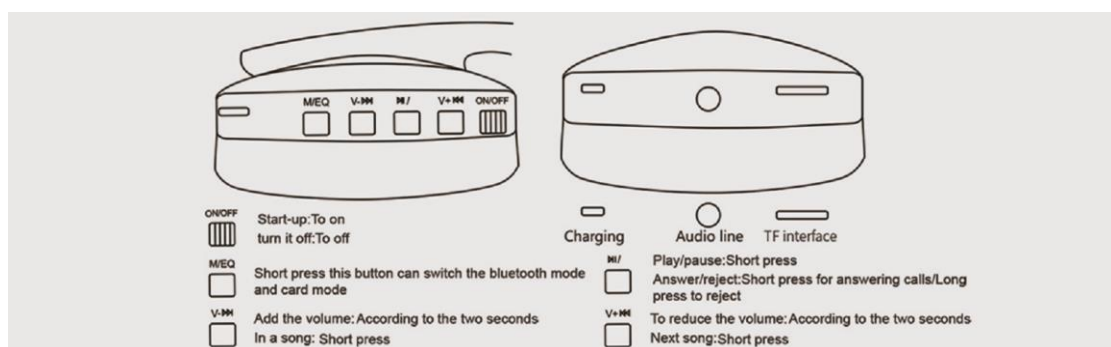

3. Operation instructions

Boot: open the key to the ON.

Shutdown: open the key to the OFF.

Bluetooth search: boot default into the Bluetooth mode, the device displays the blue/red light flashes, can search for matching. The device name is T-WIRELESS.

Next song: long press VOL+ button 2 seconds.

Up volume: short press VOL+ button to increase the volume.

Reduce volume: short press VOL- button to reduce the volume.

Pause/phone: Long press the play pause button to reject the call. To call back, double-click the play-pause button.

Mode switch: short press M/QE key switch Bluetooth mode and card mode.

Card mode: Insert TF card into the card mode directly (When no card is inserted, the card mode will be turned off by default). After inserting the card, you can short press the M/QE button to switch.

Audio input mode: When the power is off, insert the audio cable to enter the audio input mode.

4. Charge

Before charging, turn off the power of the Bluetooth headset, connect the charging cable to the USB/5V charger of the computer, the red light of the Bluetooth headset is always on, the USB connection is successfully charged, and the red light is off, the charging is complete.

(The headset system has built-in battery capacity detection and overload protection, so there is no need to worry about the impact of long charging time on the battery)

Reminder: Turn off the battery when charging, do not use it while charging, the display status will not turn off after fully charged

6. Notice

A. This product is not waterproof, please pay attention to waterproof and moisture-proof to ensure that the device can be used normally.

B. Support computer USB interface charging, please do not use counterfeit power supply to charge, so as not to damage the machine and battery.

C. The built-in polymer lithium battery of the headset cannot be placed for a long time, please charge and discharge it once a week to prolong the battery life.

D. For the service life of your earphones, please use 5V/1A or computer USB port for charging, do not use fast charging charger for charging.

E. The plug-in mode must be used in the power-off state. The use of the plug-in mode in the power-on state is prone to noise, and requires power consumption.

6. Precautions for use

A. Keep in the receiving range of Bluetooth and use with sufficient power

B. Try to avoid continuous use of high volume for a long time, so as not to damage your hearing. To protect your hearing, try not to use it for more than 1 hour, and it is beneficial to listen at intervals.

C. Do not use headphones while driving or cycling, which will affect safe driving

D. Store the product to avoid long-term sunlight exposure, high temperature, dusty, and humid environments. These conditions will damage the product wire and headphone accessories and affect normal use. Instructions

FCC Caution: This device complies with part 15 of the FCC Rules. Operation is subject to the following two conditions: (1) This device may not cause harmful interference, and (2) this device must accept any interference received, including interference that may cause undesired operation.

Any Changes or modifications not expressly approved by the party responsible for compliance could void the user's authority to operate the equipment.

Note: This equipment has been tested and found to comply with the limits for a Class B digital device, pursuant to part 15 of the FCC Rules. These limits are designed to provide reasonable protection against harmful interference in a residential installation. This equipment generates uses and can radiate radio frequency energy and, if not installed and used in accordance with the instructions, may cause harmful interference to radio communications. However, there is no guarantee that interference will not occur in a particular installation. If this equipment does cause harmful interference to radio or television reception, which can be determined by turning the equipment off and on, the user is encouraged to try to correct the interference by one or more of the following measures:

- Reorient or relocate the receiving antenna.
- Increase the separation between the equipment and receiver.
- Connect the equipment into an outlet on a circuit different from that to which the receiver is connected.
- Consult the dealer or an experienced radio/TV technician for help.

The device has been evaluated to meet general RF exposure requirement. The device can be used in portable exposure condition without restriction.