

MT2 RGB TUBE LIGHT

Inspire Your Lighting Potensial

User Manual



Foreward

Thanks for purchasing FEELWORLD MT2 RGB Tube Light. Please read this manual carefully before using the unit. Have a great experience!

⚠ WARNING

- ⚠ This product is built-in with magnet, do not attach the light on any metal with temperature of over 60°C, which will decay the light' s magnetism; use with caution in people with metal implants or those who are allergic to magnetic!
- ⚠ Do not place the product in any place with corrosive chemicals in case of the product being corroded.
- ⚠ Please keep the product away from flames, over-heat(>50°C) or ultra-low(<0°C) environment, dust, heavy vibrations or other undesirable environments.
- ⚠ This is a precise instrument, any dropping, crashing or heavy impact should be avoided.
- ⚠ This product is designed with precision structure, warranty will be void if there were any unauthorized disassembly.
- ⚠ Warranty void for improper use, extra repair cost will be charged.

Key Features

- 20cm length, tiny and portable
- OLED display, view operation details
- Multiple lighting effect modes, expanding your creative possibility
- Flexible Button or Bluetooth APP control
- USB-C charging port, easy to charge
- Built-in 3000mAh battery, fully charged can be used for more than 2 hours
- 1/4 screw hole installation or magnet mounting , make you lighting in anywhere

Product Overview

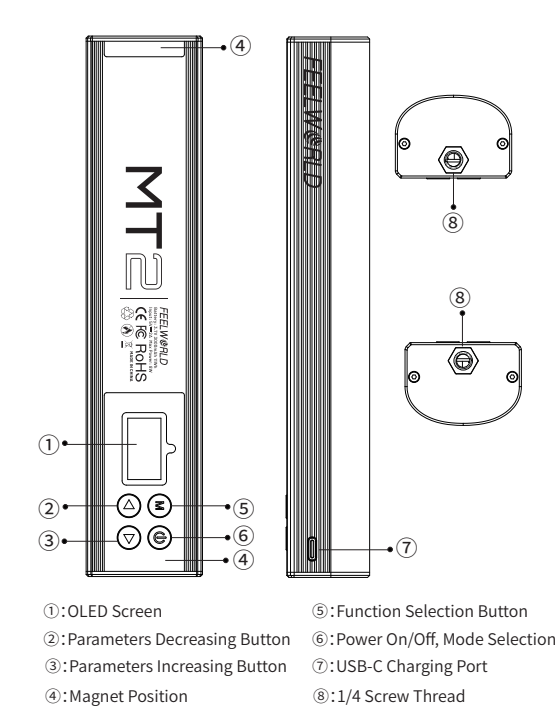

Product Instructions

Type-C Charging

- MT2 supports USB-C charging, Maximum input 5V/2A;
 - During charging, the screen will display battery icon and indicates charging status actively ; when it' s full charged, battery icon stays still with full grids of power;
 - When battery icon keeps flashing for insufficient power, please shutdown the light & recharge in time.
- Remark:**Shutdown the device before charging is highly recommended

Power ON/OFF

Press button about 2 seconds to turn On/Off MT2

Select Lighting Mode

- Short press button to select lighting control mode
- **Lighting Modes List:** CCT, HSI, FX, BGM, LIFE ASSISTANT

CCT Mode

Press button to select DIM or CCT, press < or > button to set parameter

Parameter Range:
DIM: 0% ~100%
CCT: 2600K~6000K

HSI Mode

Press button to select DIM/HSI/SAT, press < or > button to set parameter

Parameter Range:
DIM: 0% ~ 100%
HSI: 0°~ 359°
SAT: 0%~ 100%

Product Instructions

FX Mode

Press < or > button to select FX, press button to select DIM/SPEED, then press < or > button to set parameter

Parameter Range:

DIM: 0%~100%
SPEED: 1~20 (smaller number, faster speed)

FX List:

1. Bad Bulb
2. Explosion
3. TV
4. STORM
5. Paparazzi
6. Candle
7. WW Chase
8. CW Chase
9. Red Chase
10. Blue Chase
11. Green Chase
12. PE Chase
13. Cop Car
14. Cop Car-EU
15. Rainbow
16. Bi Chase
17. Party
18. Fireworks
19. Flame/fire
20. SOS

BGM Mode

Press < or > button to select BGM lighting mode, press button to select DIM, then press < or > button to set parameter

Parameter Range:

DIM: 0%~100%
BGM Lighting Mode List: Wave, Color Flash, L-R, R-L

Life Assistant Mode

Press < or > button to select **Eye Care** or **Sleep Aid** lighting mode, press button to select DIM or FX, then press < or > button to set DIM(0%~100%) or select FX

FX List:

Eye Care: Gaming, Working, Reading
Sleep Aid: RGB, Blue, Orange, Red, Green

Setting

Press button to select language or Bluetooth status, press < or > button to set language or Bluetooth status

Language: 中文, English
Bluetooth: Open, Close

APP Instructions

APP Download

Download on the App Store iOS user search “feelworld light” in App Store to get

Android APP on Google Play Android user search “ feelworld light” in Google Play to get

APP Operation

Turn on Bluetooth for both MT2 and phone. Click MT2 on APP List and enter “My Device”

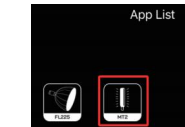

Click the light which connected and would like to control



APP Instructions

Click HSI to adjust DIM/HSI/SAT



Click FX to select the effect and adjust the brightness or speed

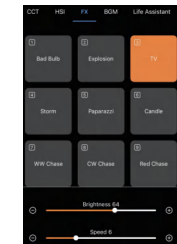

Click BGM to select the effect and adjust the brightness

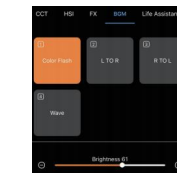

Click Life Assistant to select the effect of Eye Care or Sleep Aid mode, and adjust the brightness

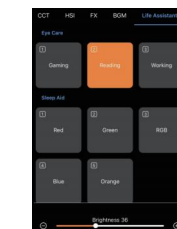

APP Instructions

Click “Group” to enter “My Group”, click “+” then input group name, click “Sure” finally to add group. Can be added 6 groups mostly

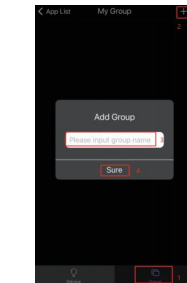

Click "Add the light" will pop up all connected lights. Click on the box to select the light you want to add, and then click "Sure"

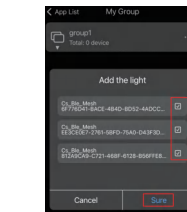

Click “...”, you can Rename the group name, add the light or delete the group



After adding the lights, you can click on any light to simultaneously control all added lights

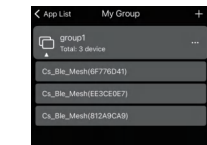

Specifications

Model No.	MT2
LED Type	RGBWW
CCT	2600K - 6000K
CRI	96+
TLCI	97+
Illuminance (3200K)	500Lux(0.5m), 160Lux(1.0m)
Illuminance (5600K)	600Lux(0.5m), 200Lux(1.0m)
Pixels	24
Lighting Mode	CCT, HSI, FX, BGM, LIFE ASSISTANT
Control Mode	Button/Bluetooth APP
Mounting	1/4"Screw + Magnetic
Power Mode	Built-in Battery
Battery Type	Lithium-polymer battery
Battery Parameters	3.7V 3000mAh
Max. Output Power	8W
Operating Temperature	0°C - 45°C
Operating Battery Life	2H (Max Brightness)
Battery Recharge Time	2.5H (USB quick charge)
Package Dimensions	209* 49* 32mm(L*W*H)
Item Net Weight	213G

Warning:
Changes or modifications to this unit not expressly approved by the party responsible for compliance could void the user’ s authority to operate the equipment.
FCC Statement:
This equipment has been tested and found to comply with the limits for a Class B digital device, pursuant to part 15 of the FCC Rules. These limits are designed to provide reasonable protection against harmful interference in a residential installation. This equipment generates, uses and can radiate radio frequency energy and, if not installed and used in accordance with the instructions, may cause harmful interference to radio communications. However, there is no guarantee that interference will not occur in a particular installation. If this e quipment does cause harmful interference to radio or television reception, which can be determined by turning the e quipment off and on, the user is encouraged to try to correct the interference by one or more of the following measures:
—Reorient or relocate the receiving antenna.
—Increase the separation between the equipment and receiver.
—Connect the equipment into an outlet on a circuit different from that to which the receiver is connected.
—Consult the dealer or an experienced radio/TV technician for help.
RF exposure compliance statement:
This device has been evaluated to meet the general RF exposure requirement