

**Charger module  
Model Number - 74T0**

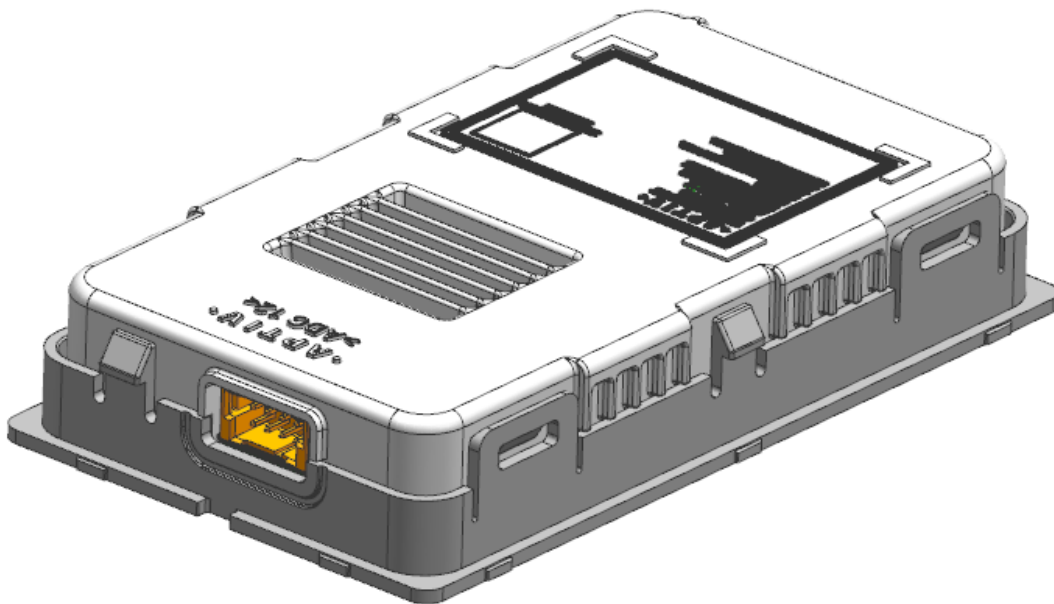

## Charger module with Garnish, Antiskid Mat & Mounting clips

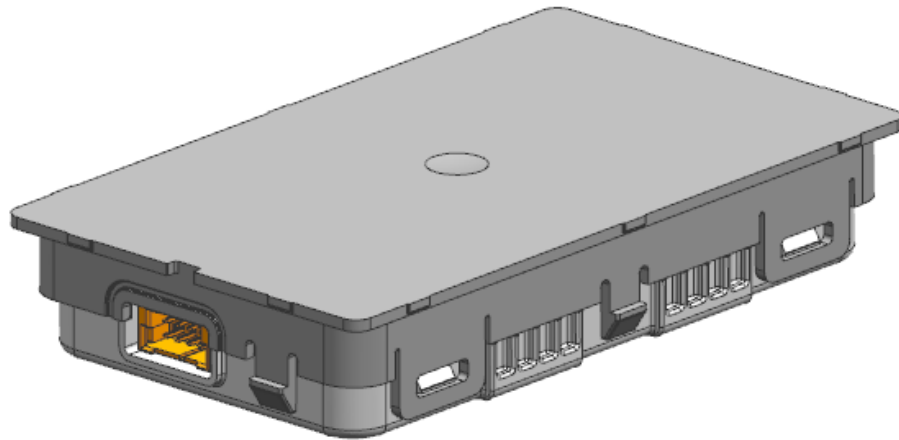
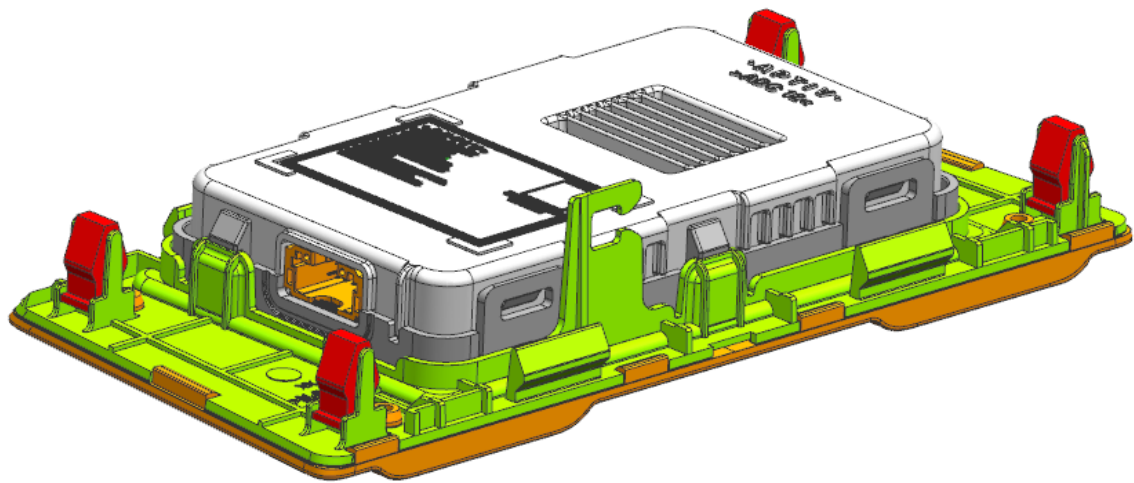
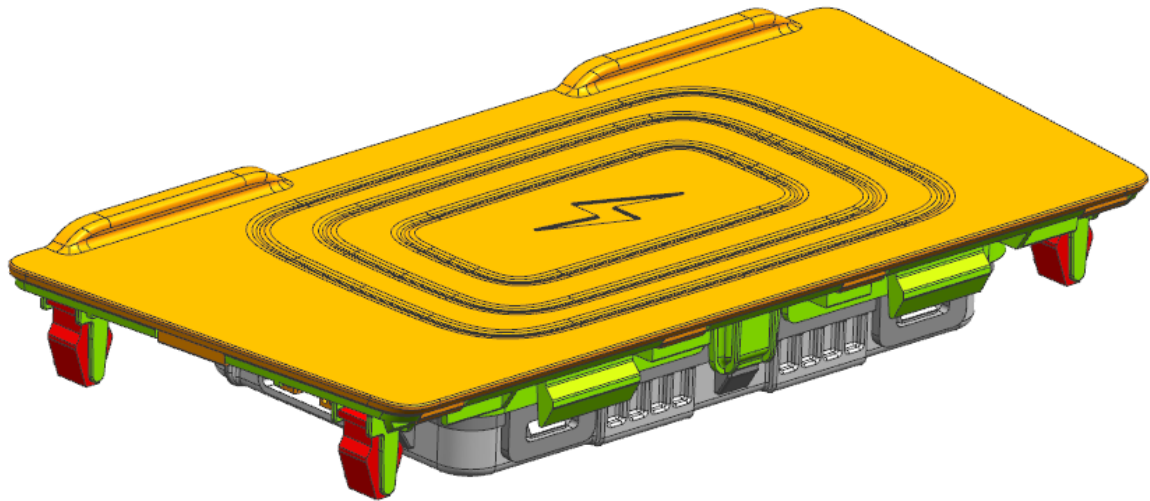

Note: Please read this manual for proper operation and keep it for future reference.

Section	Title	Page
1.0	warning	4
2.0	Product Description	5
3.0	Connector Detail	7
4.0	User Instruction	10
5.0	Precaution	11
6.0	Notice	12
7.0	FCC Rule	13



Observe the following precautions. Failure to do so may result in the possibility of equipment failure or damage, or burns due to heat.

1. While charging, do not put any metallic object between the charging area and the
  - i. mobile phone.(Coin, ATM card, clip etc...)
2. Do not attach metallic objects, such as aluminum stickers, to the mobile phones
3. Do not cover the wireless charger with a cloth or other object while charging.
4. Do not attempt to charge mobile phones which are not compatible with the
  - i. Qi wireless charging standard.
5. Do not disassemble, modify or remove the wireless charger.
6. Do not apply force or impact to the wireless charger.

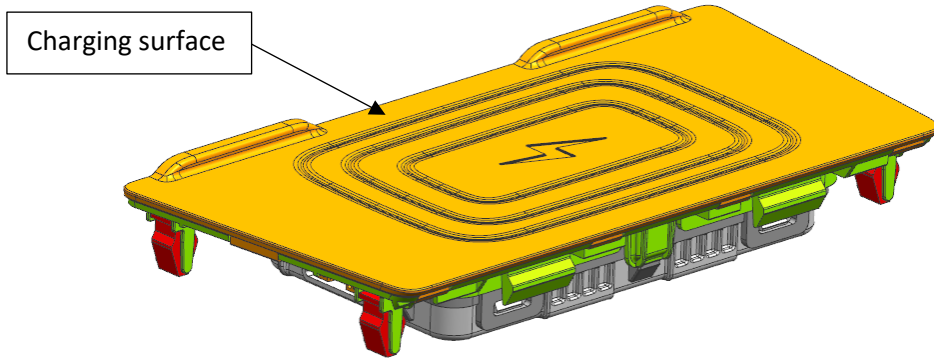

Mobile phones can be charged by just placing them on the charging area, if the Mobile phone is compatible with the Qi wireless charging standard created by the Wireless Power Consortium.

#### ELECTRICAL CHARACTERISTIC

Item	Specification
OPERATING VOLTAGE RANGE	6V ~ 16V Operation
OUTPUT POWER (AT RECEIVER DEVICE)	5W AT 6V -9V 15W AT 9V - 16V
STANDBY CURRENT	~50mA
TYPICAL CURRENT (@12V)	~1.9A
MAX CURRENT CONSUMPTION (@9V)	~2.6A
DARK CURRENT	LESS THAN 1mA
INRUSH CURRENT	4.5A FOR 5ms
OPERATING FREQUENCY (PEAK)	127.7 ± 10 KHz
CHARGING EFFICIENCY (AS PER Qi)	MIN 70%
ACC CURRENT	100mA(MAX)
Qi VERSION	1.2.4

#### TEMPERATURE CHARACTERISTIC

Item	Specification
RANGE OF STORAGE TEMP	-40 ~ 85(°C)
RANGE OF OPERATING TEMP	-40 ~ 80(°C)

#### GENERAL CHARACTERISTIC

Item	Specification
INGRESS PROTECTION (MODULE TOP SURFACE)	IP 65
TOTAL WEIGHT	350g (MAX)
COMPATIBLE DEVICES	Qi COMPLIANT RECEIVER DEVICES

MAIN CONNECTOR  
CZT CONNECTOR: 11110208A001

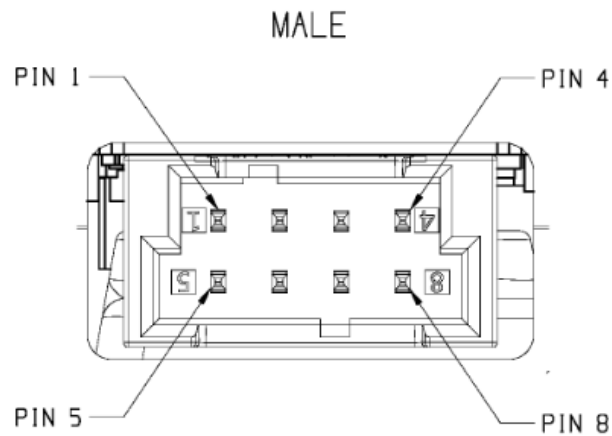

PIN #	Terminal Name	Connection
1	+B	Power source
2	ACC	ACC Input
3	CAN H	CAN HIGH
4	CAN L	CAN LOW
5	NC	Not connected
6	NC	Not connected
7	KLVC	LF Search Signal
8	GND	Power Ground

DEVICE CONNECTOR  
IRISO 12 WAY CONNECTOR: 13065B-2-12A-TR

MALE

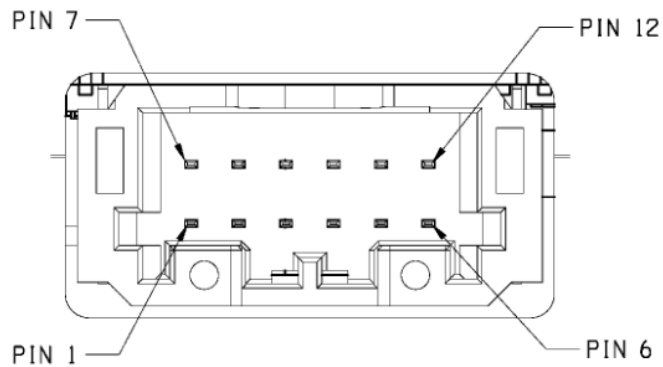

PIN #	Connections
1	5V
2	NC
3	NC
4	ON/OFF SWITCH
5	GND
6	LED_R
7	LED_G
8	LED_B
9	DEBUG_5V
10	CLK
11	DATA
12	GND

Note : PIN # 9 to 12 is meant for Debug



IND-UNIT DEVICE CONNECTOR  
MOLEX CONNECTOR: 5055750671

MALE

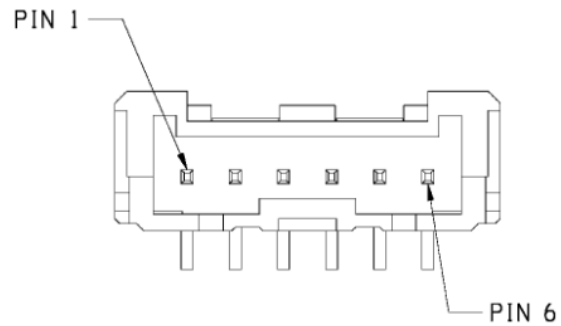

PIN#	Connections
1	LED_R
2	LED_G
3	LED_B
4	ON/OFF SWITCH (Reserved)
5	GND
6	NC

## SECTION 4.0

### User Instructions

- 1) The Wireless Charger will automatically turn ON after 4 seconds when the car ignition is on and all the doors are closed. The LED charging indicator will turn Amber during Standby mode.
- 2) Place the mobile phone into the wireless charger charging area and make sure it is aligned properly to the center of the charging area.
- 3) The LED Charging indicator light will change from Amber to blue once the charging begins. After the charging is complete, the Blue light will change to Green.

#### Recharging function

- If a certain amount of time has elapsed since charging completed and the mobile has not been moved, the wireless charger will restart charging.
- If the portable device is moved within the charging area, charging will stop temporarily and then restart.

LED Charging indicator		Status
Pattern	Color	
No light up	-	<ul style="list-style-type: none"> <li>Wireless charger is Off / sleep state</li> </ul>
Light up	Amber	<ul style="list-style-type: none"> <li>Wireless charger is On (Standby Mode – waiting for receiver to charge)</li> </ul>
Light up	Blue	<ul style="list-style-type: none"> <li>Charging in progress</li> </ul>
Light up	Green	<ul style="list-style-type: none"> <li>Charging completed</li> </ul>
Blinks (20 times)	Red	<ul style="list-style-type: none"> <li>Detect foreign object</li> <li>Charging error</li> <li>Overheat condition</li> </ul>
Light up	Red	<ul style="list-style-type: none"> <li>Permanent failure error</li> </ul>

\*note: No inbuilt charging indication LED available in the wireless charger.

1. Always remove foreign objects from the charging area before charging the portable
  - i. device.
2. Be sure the surface of the charging area is clear of dust and other debris before
  - i. charging.
3. Do not spill liquids (i. e. water, drinks, etc.) on the Wireless charger.
4. Do not use oil, grease, alcohol, benzine or thinner to clean the anti-slip sheet.
5. Do not try to peel off the anti-slip sheet from the wireless charger.
6. While charging, do not cover the Wireless charger with a towel, cloth, or other objects.
7. Avoid spraying aerosols which may come in contact with the charge pad surface.
8. Depending on the type of cover and/or accessory attached, it may not be possible to charge the mobile phones. If the mobile phone is placed in the charging area and does not charge, remove the cover and/or accessories.
9. While charging, the wireless charger and the portable device will become warm.
  - i. This is not a malfunction. If a portable device becomes warm while charging and
  - ii. charging stops due to its protection function, wait until it cools down and charge it again.

1. Charging will be suspended temporarily when any door is opened.
  - a. Charging will resume after the door is closed.
2. Mobile phones compatible with the Qi wireless charging standard can be charged
  - a. by the wireless charger. However, compatibility with all devices which meet the
  - b. Qi wireless charging standard is not guaranteed.

In the following situations, the wireless charger may not operate correctly:

- When the mobile phone is fully charged.
- When the mobile phone becomes hot while charging.
- When the ambient temperature is high.
- When the mobile phone is not centered on the charging area.
- When there is a foreign object between the charging area and the mobile phone.
  - I. Cards (ATM, ID, RFID & SIM etc..)
  - II. Gum wrapper(aluminium foil)
  - III. Hair Clip
  - IV. Coins
  - V. Metal Washers
  - VI. Metal Bracelet
  - VII. Paper clip
  - VIII. Earrings
  - IX. Small screws
  - X. Key, keyring, smart key etc....

**Manufactured by: APTIV Connection Systems India Pvt Ltd.**

7/60-A & 60-B

ARAKUNNAM PULICKAMALY RD

ARAKUNNAM, MULANTHURTHY-KOCHI 682313

KERALA, INDIA

This device complies with Part 15 of the FCC Rules.

Operation is subject to the following two conditions:

- 1) this device may not cause harmful interference and
- 2) this device must accept any interference received, including interference that may cause undesired operation.

Federal Communications Commission (FCC) Statement 15.105(b):

This equipment has been tested and found to comply with the limits for a Class B digital device, pursuant to part 15 of the FCC rules. These limits are designed to provide reasonable protection against harmful interference in a residential installation.

This equipment generates, uses and can radiate radio frequency energy and, if not installed and used in accordance with the instructions, may cause harmful interference to radio communications. However, there is no guarantee that interference will not occur in a particular installation. If this equipment does cause harmful interference to radio or television reception, which can be determined by turning the equipment off and on, the user is encouraged to try to correct the interference by one or more of the following measures:

- Reorient or relocate the receiving antenna.
- Increase the separation between the equipment and receiver.
- Connect the equipment into an outlet on a circuit different from that to which the receiver is connected.
- Consult the dealer or an experienced radio/TV technician for help.

Compliance statement 15.21:

You are cautioned that changes or modifications not expressly approved by the party responsible for compliance could void the user's authority to operate the equipment.

FCC RF Radiation Exposure Statement:

1. This Transmitter must not be co-located or operating in conjunction with any other antenna or transmitter.
2. The Transmitter shall always be installed ensuring a minimum separation distance of 20cm between the antenna and the user.