

Y12 Pro Quick instruction manuals

Product Overview

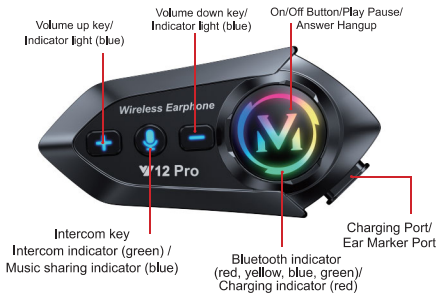

Important Reminder:

Before installing the headset, please connect your cell phone according to the quick manual guide to test the sound effect and volume.

If there is a big difference in sound effect and volume after installing into the helmet, please adjust the position of the speaker inside the helmet.

Telephone function

Double-tap to toggle manual/automatic answer (when Bluetooth is not connected)

Automatic (Ⓢ after 15 seconds)

answer the phone

Manual answer "short press"

answer the phone

In talkback mode: double click the "talkback button". Switch to music sharing mode

Press and hold for 2 seconds

decline to answer the phone

"Short press" during a call

end a call

double-click

final code redial

short press

(on de-energization)

Cancel call

Music function

short press

(music pauses)

playable

(music playing)

Volume-Key

(music playing)

Intercom not connected

Short press on a song

Long press volume down

Volume + key

(music playing)

Intercom not connected

Short press on the next song

Long press volume up

Coexistence of pairing/music sharing and intercom modes

(Three modes: intercom, mixing, music sharing)

In talkback mode: double click the "talkback button". Switch to music sharing mode

Music Share pairing status: Blue light blinking fast

Music Share pairing status: Blue indicator light is on for a long time

In music sharing mode: long press the volume up/down key to increase/decrease the volume of music sharing and Bluetooth music at the same time. After the two devices are turned on, the two machines are connected to the intercom successfully, one device is connected to the cell phone to play music, double-click the intercom key to switch to realize the coexistence of the music sharing mode and intercom mode; when the intercom is paired up, you can also switch to a separate music sharing mode by double-clicking the intercom key (three modes: intercom mode; coexistence of the music sharing and intercom (mixing) mode; and a separate music sharing mode)

Intercom reset

Introduction to Bluetooth intercom connection operation (intercom and music sharing are turned off by default every time you turn on the computer)

I. Intercom back to connect

After the connected machines are turned on, press the microphone button to enter the intercom mode, and press the corresponding pairing button on the host to connect back to other corresponding machines.

Phone answer: the two machines are successfully connected to the intercom, Bluetooth is also connected to the cell phone, when there is a phone call, it will automatically switch to the phone to answer the call, and after hanging up, the intercom will be restored.

II. Clear the pairing and restore the factory settings.

1. Clear Bluetooth pairing information: when the machine is turned on without connecting Bluetooth and intercom, press and hold the volume down and volume up keys at the same time for 5S to clear the Bluetooth pairing information, and the indicator light will flash.

2. Long press 10S at the same time to clear all the intercom pairing records, when operating to clear the intercom pairing records, you need to clear all the machines for intercom pairing otherwise it will affect the intercom connection.

III. Coexistence of music sharing and intercom mode (two persons)

After the two devices are powered on, the two machines are connected to the intercom successfully, one device is connected to the cell phone to play music, double-click the intercom key to switch to realize the coexistence of the music sharing mode and the intercom mode; when the intercom is paired up, you can also switch to a separate music sharing mode by double-clicking the intercom key (three modes: the intercom mode; the coexistence of the music sharing and the intercom (the mixing mode); and the separate music sharing mode).

IV. Friendly mode (connecting third party)

Short press the volume up and down keys at the same time to enter the dating mode, then long press at the same time to exit.

V. Lights Off Mode

Short press the intercom key and volume up key at the same time to turn off all lights off, then short press at the same time to turn on (default on)

Power on/off

Double-tap to toggle voice announcement (Disconnect Bluetooth)

Press and hold for 3 seconds to turn on/off

On/Off Beep

LED flash

Bluetooth connection

Bluetooth waiting for pairing: LED light blinks fast

Bluetooth mode tone

Bluetooth pairing is successful: LED light flashes slowly

Intercom pairing

intercom button

Intercom pairing status: Green light blinking fast

paired cue

Intercom pairing is successful: Green light is on.

After the machine is turned on, the two devices short press the intercom button enter the intercom mode, the green LED light flashes, and accompanied by a prompt tone "intercom pairing", after successful pairing, there will be a tone prompting successful pairing "intercom has been connected", at this time you can two people intercom call. In the mode of successful intercom connection: long press the volume up/down key to adjust the intercom volume up/down.

Charging function

(Pkg in the charger to charge the machine while it is on and the machine will automatically shut down)

Charging red light is always on

Full red light off

Dating Mode Matchmaking

Dating mode waiting for pairing: LED lights flash super fast

Dating mode pairing is successful: LED light is on for a long time

Dating mode (connecting third party): short press volume up and down keys at the same time to enter dating mode, then long press at the same time to exit

Mixing function

Intercom and Bluetooth are paired successfully.

Intercom connection successful.

Intercom and Bluetooth can work independently of each other, do not affect each other, when the intercom and Bluetooth are connected, the two sounds can be mixed out to the speaker end, you can hear the sound of the two modes at the same time.

When the intercom is successfully connected, the volume up and down operation is as follows: ① Short press volume up and down to adjust the volume level of Bluetooth music; ② Long press volume up and down to adjust the volume of the intercom; ③ Double-click volume up and down to switch the next and previous songs of Bluetooth music.

Mixing mode: green and blue indicator light flashes; Mixing connection success: green and blue indicator light is on.

Voice assistant

(under successful Bluetooth pairing)

Press and hold the "voice button" to wake up the voice assistant.

Long press again to exit the voice assistant

Product List

Y12 Pro main unit\*1

Speaker Microphone\*1

Clip-on base\*1

Velcro installation kit\*1

Type-C charging cable\*1

Instruction manual\*1

Caveat

1. Please do not put the product into the open fire to avoid explosion;

2. Please do not disassemble the product to avoid damage to the product's electronic devices;

3. Please do not close to sharp objects to cause damage to the product;

4. Long time not used, please place in a dry place;

5. Before using the Bluetooth device, please fully charge it first;

6. If the red light does not come on when charging, it may be the voltage is too low;

7. In order to extend the service life of the built-in polymer battery, please charge the device at least once a month.

Warning

NOTE: This equipment has been tested and found to comply with the limits for a Class B digital device, pursuant to part 15 of the FCC Rules. These limits are designed to provide reasonable protection against harmful interference in a residential installation. This equipment generates uses and can radiate radio frequency energy and, if not installed and used in accordance with the instructions may cause harmful interference to radio communications. However, there is no guarantee that interference will not occur in a particular installation. This equipment does cause harmful interference to radio or television reception, which can be determined by turning the equipment off and on, the user is encouraged to try to correct the interference by one or more of the following measures.

- Reorient or relocate the receiving antenna.
- Increase the separation between the equipment and receiver.
- Connect the equipment into an outlet on a circuit different from that to which the receiver is connected.
- Consult the dealer or an experienced radio/TV technician for help.

Changes or modifications not expressly approved by the party responsible for compliance could void the user's authority to operate the equipment. This device complies with Part 15 of the FCC Rules. Operation is subject to the following two conditions:

(1) This device may not cause harmful interference, and

(2) This device must accept any interference received, including interference that may cause undesired operation.

FCC Radiation Exposure Statement

This device complies with FCC RF radiation exposure limits set forth for an uncontrolled environment. The device can be used in portable exposure condition without restriction.