

# Introducing Soundbody GRIP

The grip training and hand movement device which can measure the grip strength, HRV, and formulate grip strength training plan.

We provide hardware (grip training device) and software (fun and engaging training games).



바이오헬스코어  
BIO HEALTH CORE



# How to Use Soundbody Grip

- Easy to set up and use

- Fun games and Exercises

# Easy to set up and use

The grip training and hand movement device connects seamlessly via Bluetooth to your existing mobile.

The device itself is light and fits in one hand and features an easy to grip design, even for users with low hand dexterity.



# Fun games and Exercises

Once connected, the user is able to access games and exercises through the BioHealthCore software platform. The games are designed to be fun and engaging while also training the user's upper body strength and endurance.

The user can also do a series of tests, such as the grip strength test, to evaluate their current fitness level.



## Soundbody Grip+

## Mobile & Tap(Android)

1. Download 'Soundbody' APP
2. Connects via Bluetooth
3. Measures grip strength and HR
4. Training with fun games
5. Monitoring and Saving results

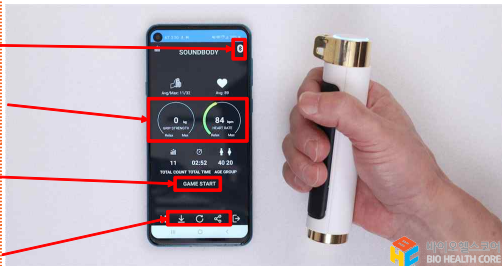

# Specifications

POWER	5v
BATTERY	Lithium-Polymer 3.7V 1,200mAh
BLE 1M	2 402MHz~2 480MHz
CAHRGING TIME	4Hours
BATTERY LIFE	8Hours
CHARGING CABLE	USB Type - C
INPUT	AC220V 60Hz
SIZE	150mm x 35m / 200g

This product should only be supplied with less than 15W of power.



바이오헬스코어  
BIO HEALTH CORE

# What experts are saying

“Good way to motivate patients when they see the progression with a grip strength.”

Oona Kivistö, Doctor

“Game is a good way for patients to do practices, they need ways to be motivated for a long time”

“Born fracture in the hand area - it could be a nice way to rehab.”

Jenni Hämäläinen, Doctor



바이오헬스케어  
BIO HEALTH CORE

**FCC Compliance Statement**

This device complies with part 15 of the FCC rules. Operation is subject to the following two conditions: (1) This device may not cause harmful interference, and (2) this device must accept any interference received, including interference that may cause undesired operation.

**FCC Interference Statement**

This equipment has been tested and found to comply with the limits for a Class B digital device, pursuant to part 15 of the FCC Rules. These limits are designed to provide reasonable protection against harmful interference in a residential installation. This equipment generates, uses and can radiate radio frequency energy and, if not installed and used in accordance with the instructions, may cause harmful interference to radio communications. However, there is no guarantee that interference will not occur in a particular installation. If this equipment does cause harmful interference to radio or television reception, which can be determined by turning the equipment off and on, the user is encouraged to correct the interference by one of the following measures:

- Reorient or relocate the receiving antenna.
- Increase the separation between the equipment and receiver.
- Connect the equipment into an outlet on a circuit different from which the receiver is connected.
- Consult the dealer or an experienced radio/TV technician for help.

**FCC Caution**

Any changes or modifications not expressly approved by the party responsible for compliance could void the user's authority to operate this equipment. This transmitter must not be co-located or operating in conjunction with any other antenna or transmitter.

**RF Exposure**

This equipment complies with the FCC RF radiation exposure limits set forth for an uncontrolled environment. This equipment must not be co-located or operating in conjunction with any other antenna or transmitter.