

Spray Bark Stopper (Remote control)

Advanced, reliable, safe and effective
Operating instruction





Welcome to choose: Spray bark stopper (dual mode). In order to ensure that the intelligent spray bark stopper can maintain long-term and satisfactory performance, please be sure to read the user manual carefully before using the product and keep it properly after reading.

(This product is suitable for all kinds of large, medium and small dogs)



—. Matters needing attention

 Pay attention to	<ol style="list-style-type: none"> 1. This product is suitable for large, medium and small dogs 2. This product cannot be used directly on human beings, otherwise it will violate local laws 3. Turn off or take off the bark stopper before playing with the dog 4. Please do not wear the bark stop device on the dog for a long time
---	--

 wa rning	<ol style="list-style-type: none"> 1. It is strictly prohibited to be used as toys by children 3. It is strictly forbidden to put the bark stopper and gas tank near the stove or at high temperature 4. It is strictly forbidden to open the shell of the product, which will cause the disconnect of lithium battery and cause fire 4. The manufacturing company shall not be liable for any direct or indirect damages caused by any misuse
--	--

Ii. Product components



Three, accurate use and wear guidance

The main machine of spray bark stopper uses lithium battery as power supply, and is equipped with USB charging cable, which can be recharged. Remove the worry of changing the battery.

The remote control of the spray bark stopper is powered by the button battery and can stand for about 30 days.

Indicator display mode:

1. When starting up, the green light flashes every 3 seconds, indicating that it is in automatic spray mode;
2. When starting up, the red light flashes every 3 seconds, indicating that it is in remote control mode;
3. If the traffic light blinks continuously, it indicates that the power is insufficient and needs to be charged.

Startup mode:



1. After holding down the on key, the red light flashes once to start the remote control mode. (Red light flashing every 3 seconds, normal working condition)
2. Press the on key again and the green light flashes once, then switch to automatic spray mode (the green light flashes once every 3 seconds, normal working state)



Off mode:

After holding down the on key for 3 seconds, the traffic light blinks at the same time, and the host mode is normally closed.



Remote control mode:

Hold down the remote control spray button, the main machine will trigger the spray, hold down the remote control switch, the main machine will stop the remote control function.



Charging mode:

When charging, please turn off the machine and connect the mobile phone charger and desktop computer with UBS data cable.

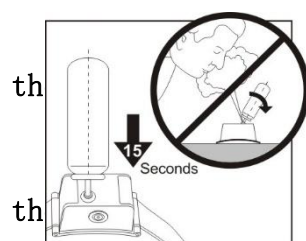

Replenishment of air and body fluid volume:
The machine must be shut down before replenishing

Gas, and then start the main engine.

Aeration point: before aeration, put air into

the machine

Drain (with a small screwdriver to the pressure twice)

The filling tank is fixed vertically with the bark stopper

Press into the air vent and hold for 10 seconds

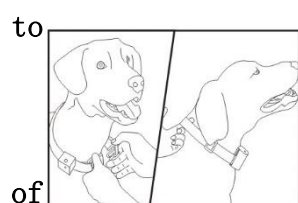

Put a bark stopper on your dog:

Adjust the collar strap according to the size

Excision of the remainder.

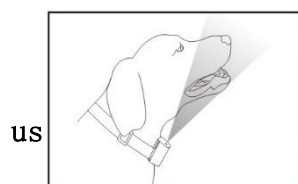

Proper wear is the prerequisite for effective bark stopper on

Attach it to the dog's neck and point the spray nozzle vertically at the pet's nose,

The size of the collar allows a hand to fit between the collar and the dog's neck

Fingers as the standard. This will accurately identify the frequency of barking.

Installation is very important, too loose bark stop will cause the action is not

Coordinate and affect the normal operation of products.

For dogs with long hair, trim the coat on the

spray path

Send, ensure the fog can spray to the effective range.

Iv. Product functions and effects

1. Low power consumption, lithium battery can be recharged repeatedly, without replacing the battery, reduce environmental pollution.
2. The remote control mode can manually stop the barking according to the state of the pet, and the effective remote control distance is 1-80 meters.
3. Spray bark stopper can effectively stop pets from barking. The vibration frequency generated when dogs bark will
The inductive reception system in the bark stopper is triggered and an air mist is emitted to warn the dog to stop barking.
4. Citronella spray, which is made of Citronella essential oil and does not contain CFC, belongs to ring
The product is safe and harmless to humans and dogs. (110g/bottle, 3 OZ)
5. The spray bark stopper can be worn on the dog in a short time, without long training.
6. The bark stopper has small volume and large air capacity. It can be sprayed 20 times after filling with gas.
8. When the dog barks, the spray stop will warn the dog. After being warned, the dog will distract its attention and stop barking to achieve its purpose, and the owner needs to praise and encourage the dog. After a short period of adaptation, the dog will remember the warning of the spray stop when barking.

5. Important tips

1. This product is suitable for large, medium and small dogs and shall not be used for any other dogs not described in this manual
The purpose of;
2. If the bark stopper is worn on the dog for a long time, it will cause a condition similar to mattress scar, that is, oppression
To reduce the possibility of skin necrosis, please refer to the following methods:

3. Check your dog's neck frequently for any rash or sore spots;
4. Supervise your dog for the first day or two after putting on a bark stopper;
5. Check the device in real time to prevent excessive pressure. It can be tolerated when the bark stopper is worn between the dog's neck and the next finger;
6. Scrub the area around the dog's neck and the bark stopper sensor on a weekly basis.
7. Do not attempt to remove or repair any parts of the product, as doing so will void the warranty;
8. If your dog shows extreme resistance to wearing a bark stopper or acts in a dangerous manner, the dog should be removed from the boot. If the boot is invalid, please stop using the product immediately.
9. We recommend this product for dogs 6 months of age weighing 8 pounds or more.
10. Bark stopper should not be used continuously for 12 hours within 24 hours.

6. Fault comparison table

Spray bark stopper not working	When the traffic light blinks continuously, it indicates insufficient power and needs to be charged.
	If the sprayer still cannot be sprayed, contact your local distributor
The dog did not respond to the spray	Reinforce the bark stopper and ensure that the sensor system is close to the dog's neck skin
	Check and make sure the spray nozzle is pointed at the dog's nose
	Make sure the dog hair doesn't interfere with the spray

Seven, technical parameters

1. Receiver

Input current 0.024 (A)

Input voltage 3.7 (V)

Power 0.09W (W)

Frequency 433.92 (MHz)

2. Remote control

Input current 0.011 (A)

Input voltage 3.0 (V)

Power 0.01W (W)

Frequency 433.92 (MHz)

FCC Warning Statement:

Changes or modifications to this unit not expressly approved by the party responsible for compliance could void the user's authority to operate the equipment. This equipment has been tested and found to comply with the limits for a Class B digital device, pursuant to Part 15 of the FCC Rules. These limits are designed to provide reasonable protection against harmful interference in a residential installation. This equipment generates, uses and can radiate radio frequency energy and, if not installed and used in accordance with the instructions, may cause harmful interference to radio communications.

However, there is no guarantee that interference will not occur in a particular installation. If this equipment does cause harmful interference to radio or television reception, which can be determined by turning the equipment off and on, the user is encouraged to try to correct the interference by one or more of the following measures:

- Reorient or relocate the receiving antenna.
- Increase the separation between the equipment and receiver.
- Connect the equipment into an outlet on a circuit different from that to which the receiver is connected.
- Consult the dealer or an experienced radio/TV technician for help.

This device complies with Part 15 of the FCC Rules. Operation is subject to the following two conditions: (1) this device may not cause harmful interference, and (2) this device must accept any interference received, including interference that may cause undesired operation.

FCC Radiation Exposure Statement

The device has been evaluated to meet general RF exposure requirement. The device can be used in portable exposure condition without restriction.