

1. Product Introduction

This wireless product adopts UHF frequency band transmission, which has the characteristics of long transmission distance, strong anti-interference ability, low delay and crystal-clear sound. The visible working status makes operation easy.

Note: Please read and obey all warnings carefully before use, and keep this manual for future use.

2. Product Description

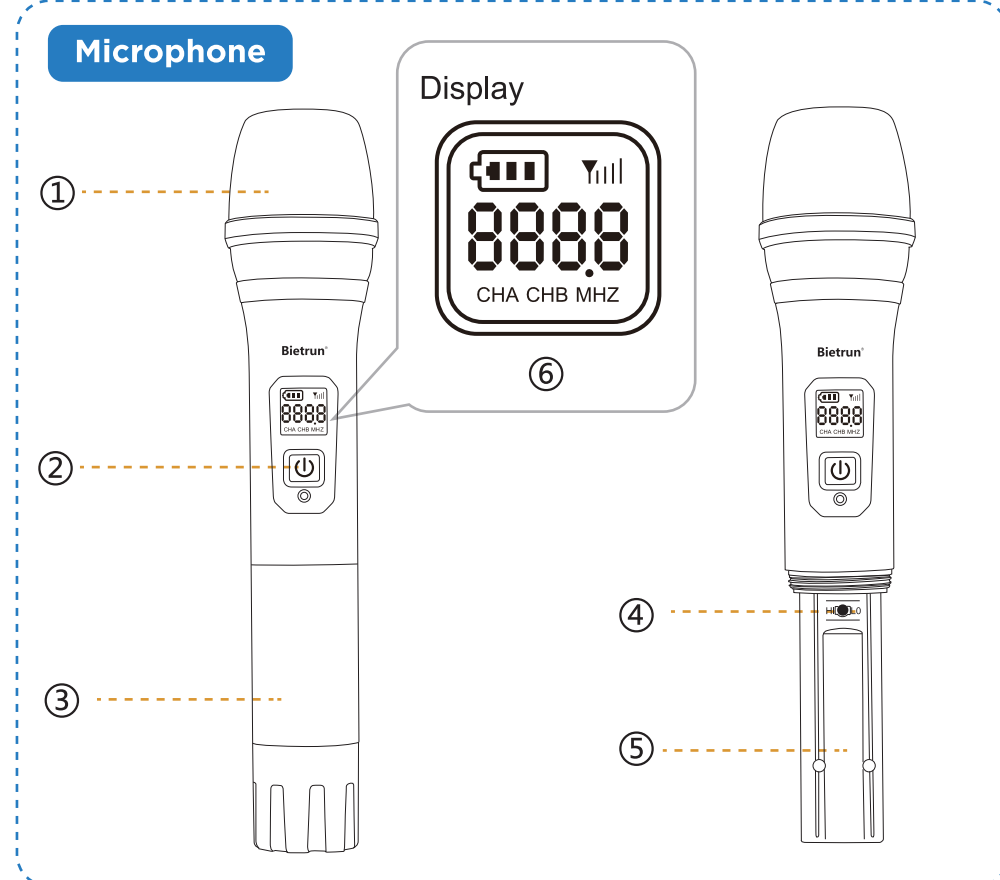

No.	Part Name	Function Description	Notes
1	Mic	Pick up the signal sound.	Don't take apart casually, wear of fall down.
2	Power button	(1) Power on/off: Press and hold for 2 seconds to turn on/off. (2) Adjust volume: Short press to adjust volume, there are 5 levels (level 5-12) in the display.	
3	Battery cover	Remove the battery cover counterclockwise and tighten the battery cover clockwise.	
4	Frequency switch	(1) To avoid interference from other devices or environment, the microphone frequency (15 channels in total) can be changed by pressing the button. (2) After the channel is adjusted, the frequency on the display screen will increase by 1, and the frequency on the receiver will increase synchronously.	In normal case, there is no need to adjust the channel.
5	Battery slot	Insert two AA 1.5V batteries of the same type. (2) AA alkaline battery is recommended. (3) Rechargeable battery is not recommended (low voltage of 1.2V affects the working time).	(1) Don't use old and new battery at the same time. (2) If there is no key operation, it will enter power-saving mode and display power exhaustion only. Press any key to reactivate the display screen.
6	Screen	(1) The working status of microphone, including power, signal, frequency and channel. (2) If there is no key operation, it will enter power-saving mode and display power exhaustion only. Press any key to reactivate the display screen.	Need to change battery when turns to and flash.

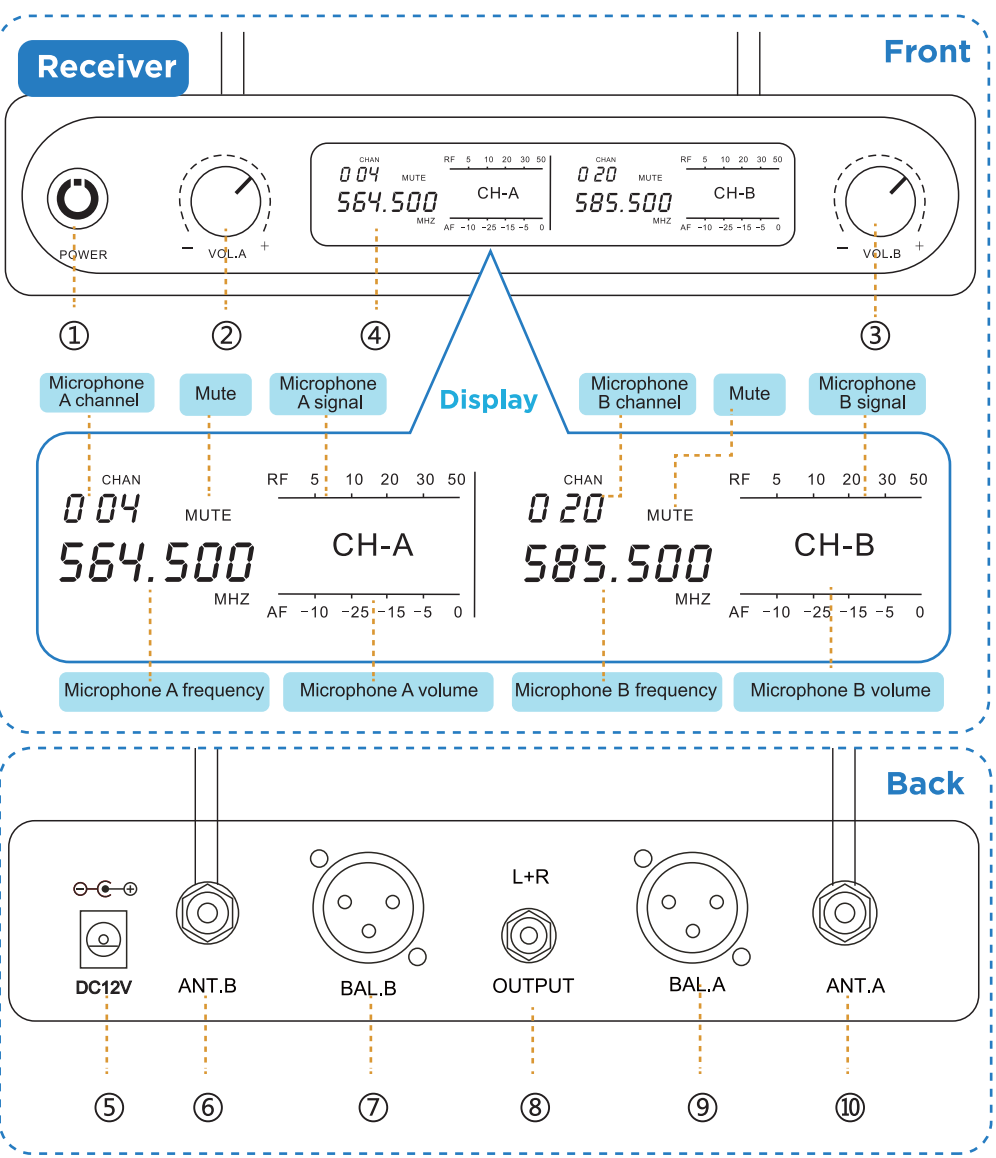

No.	Part Name	Function Description	Notes
1	Power button	Short press to power on, long press to power off.	
2	Microphone A volume adjustment	Turn left to turn down the volume, turn right to turn up the volume.	
3	Microphone B volume adjustment	Turn left to turn down the volume, turn right to turn up the volume.	

No.	Part Name	Function Description	Notes
1	RF	Wireless signal strength	
2	AF	Audio signal dynamic strength	
3	CHAN	Channel number	
4	MUTE	Mute sign	
5	FREQUE	Connection frequency	
6	Power input	Input voltage: DC12V	Please use the adapter that comes with the product.
7	Receiving antenna	Receive wireless signals from microphone A and B.	(1) Please install the antenna before turning it on for the first time, and the antenna should be screwed in to the right and locked. (2) When the connection signal is unstable and the sound is intermittent, you can adjust the antenna direction to improve it.
8	Microphone B output	Audio output for microphone B, can be connected to lower-level equipment.	Output the audio signal of microphone B only.
9	6.35 audio output	6.35 audio output, can be connected to the 6.35 input of the lower-level equipment.	The feature of the microphone A and B, the left and right channels.
10	Microphone A output	Audio output for microphone A, can be connected to lower-level equipment.	Output the audio signal of microphone A only.

3. How to Connect

Output connection

Audio amplification equipment with CANNON interface or 6.35 audio input interface can be connected to this product, including mixer, multimedia speaker, Bluetooth speaker, power amplifier, trolley speaker, etc.

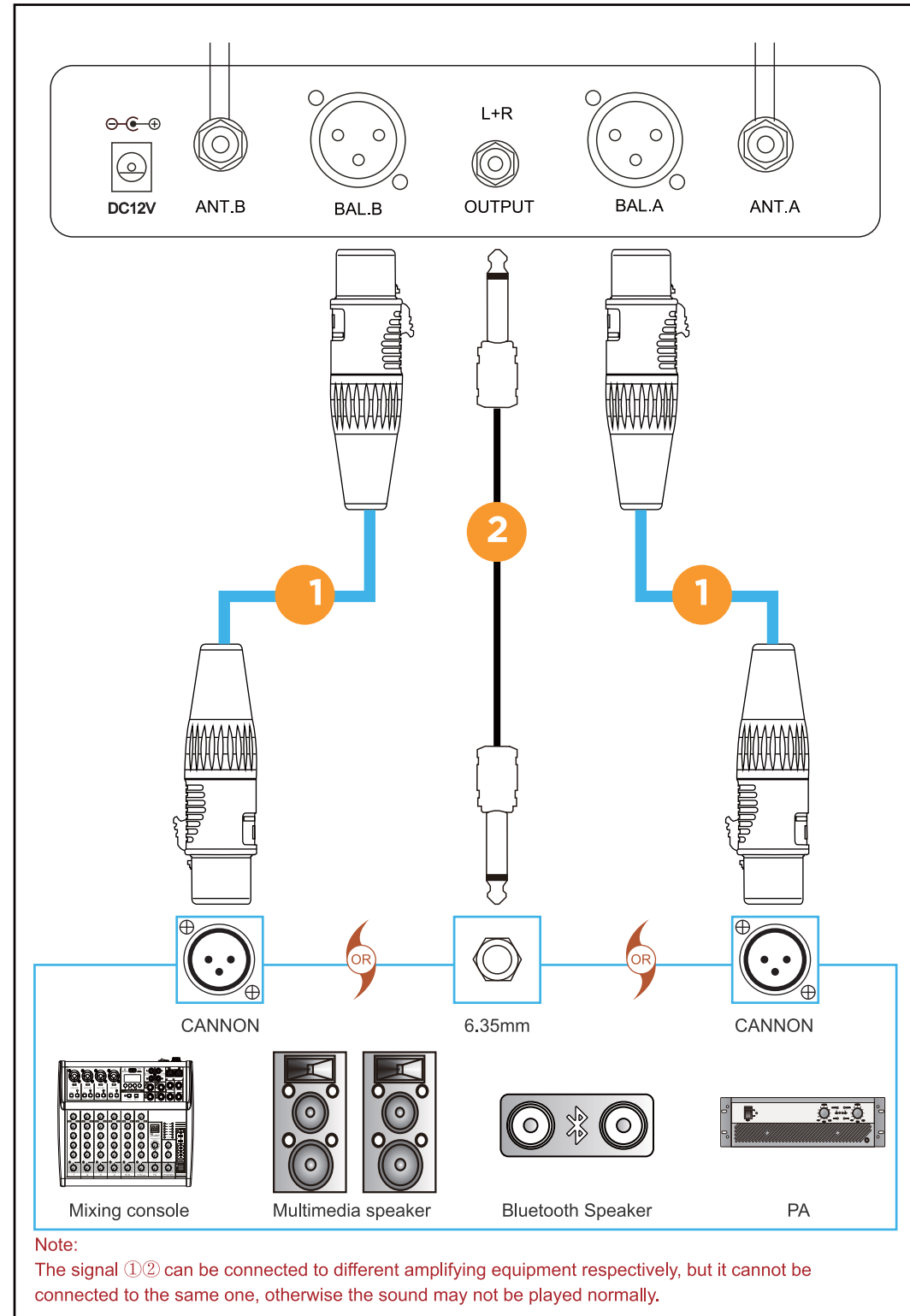

Note:
The signal ①② can be connected to different amplifying equipment respectively, but it cannot be connected to the same one, otherwise the sound may not be played normally.

4. Trouble Shooting

No.	Description	How to fix
1	The receiver cannot be turned on.	(1) Check whether the power adapter wires and host are connected correctly and firmly, and whether the power is turned on. (2) Short press the power button of the receiver to turn it on.
2	The microphone cannot be turned on.	(1) Check whether the battery power of the microphone is sufficient, and replace with new 2 AA batteries. (2) Press and hold the power switch for 2 seconds to turn it on. Note: short press can not turn it on.
3	No sound	(1) Check whether the volume control of the microphone and lower-level equipment is turned on. (2) Check whether the connection between the microphone and the receiver is successful (the information of the microphone will be displayed on the display of the receiver if the connection is successful). (3) Turn up the volume of the receiver. (4) Check whether the connection of CANNON interface or 6.35 interface is correct. (5) The sound amplifier next to the receiver may need to set the signal input mode, please refer to the instruction manual of the sound amplifier for setting.
4	Low sound	(1) Adjust the microphone VOLUME button to increase the volume, 8 is the minimum volume, 12 is the maximum volume. (2) Turn up the volume of the microphone on the receiver, and turn the knob to the right to turn up the volume. (3) Increase the volume of the output device.
5	Intermittent sound	(1) Shorten the distance between the microphone and the receiver, the visual distance should not exceed 50M, the transmission distance will be shortened when there are obstacles in the middle. (2) Check whether the antenna is assembled properly, and adjust the angle of the antenna to point to the position of the microphone. (3) Switch channels.
6	Whistling, screaming	(1) Decrease the volume of the voice amplifier or microphone. (2) The microphone should not be too close to the voice amplifier.

5. Specifications

Receiver			
Receiving frequency	U Band	Frequency stability	<0.002%
Sensitivity	2mV	Interference frequency ratio	> 90dB
Image interference ratio	>88dB	Signal to noise ratio	>95dB
Audio output	800mV-1.4V	Working range	Standard conditions 30 to 50 m
Receive channel	2	Supply Voltage	DC 12V
Power consumption	3W	Antenna	Universal antenna

Handheld Microphones			
Carrier frequency	U Band	Frequency stability	<0.002%
Transmission power	10mW	Current consumption	<25mA
Harmonic	<Main wave 40dB	Standard	Fixed frequency
Pickup	6002 single directivity	Battery	AA Alkaline battery
Antenna	Built-in		

Complex Index			
Dynamic range	>95dB	System distortion	<1%, 1K Hertz modulation
Frequency response	50Hz-18KHz(+3dB)		

6. Packaging Content

2X Microphone (A, B)

1X Receiver

2X Receiving antenna

1X 6.35 to 6.35 signal cable

2X XLR Audio signal cable

1X Power adapter

1X User manual

Frequency

MIC A: CH1: 560.5KHz, CH2: 561.5KHz, CH3: 562.5KHz, CH4: 563.5KHz, CH5: 564.5KHz, CH6: 565.5KHz, CH7: 566.5KHz, CH8: 567.5KHz, CH9: 568.5KHz, CH10: 569.5KHz, CH11: 570.5KHz, CH12: 571.5KHz, CH13: 572.5KHz, CH14: 573.5KHz, CH15: 574.5KHz

MIC B: CH1: 580.5MHz, CH2: 581.5MHz, CH3: 582.5MHz, CH4: 583.5MHz, CH5: 584.5MHz, CH6: 585.5MHz, CH7: 586.5MHz, CH8: 587.5MHz, CH9: 588.5MHz, CH10: 589.5MHz, CH11: 590.5MHz, CH12: 591.5MHz, CH13: 592.5MHz, CH14: 593.5MHz, CH15: 594.5MHz

Manufacturer:
SHENZHEN LONGXIANG INTELLIGENT TECHNOLOGY CO. LTD.
Address: FLOOR 4, BUILDING D, FUXIN INDUSTRIAL AREA, HANGCHENG INDUSTRIAL ZONE FUHUA COMMUNITY, XIXIANG STREET, BAOAN DISTRICT SHENZHEN GUANGDONG CHINA

FCC Warning Statement
Changes or modifications not expressly approved by the party responsible for compliance could void the user's authority to operate the equipment. This equipment has been tested and found to comply with the limits for a Class B digital device, pursuant to Part 15 of the FCC Rules. These limits are designed to provide reasonable protection against harmful interference in a residential installation. This equipment generates uses and can radiate radio frequency energy and, if not installed and used in accordance with the instructions, may cause harmful interference to radio communications. However, there is no guarantee that interference will not occur in a particular installation. If this equipment does cause harmful interference to radio or television reception, which can be determined by turning the equipment off and on, the user is encouraged to try to correct the interference by one or more of the following measures:
- Reorient or relocate the receiving antenna.
- Increase the separation between the equipment and receiver.
- Connect the equipment into an outlet on a circuit different from that to which the receiver is connected.
- Consult the dealer or an experienced radio/TV technician for help.
This device complies with part 15 of the FCC Rules. Operation is subject to the following two conditions: (1) This device may not cause harmful interference, and (2) this device must accept any interference received, including interference that may cause undesired operation.
The device has been evaluated to meet general RF exposure requirement. The device can be used in portable exposure condition without restriction.

14 cm