



Instruction Manual

Model:SL-600H



800-627-4913
www.sterilumen.com

Table of Contents

Description	1
Principles of Purification	3
Instructions Before Use	4
Instructions for Use	5
Wifi Connect Instruction	7
Maintenance	9
Safety Precautions	10
Storage Conditions	11
Common Malfunctions	11
Product Configuration and Parameters	12
Warranty	12
FCC Warning	13
Maintenance Records	14

Description

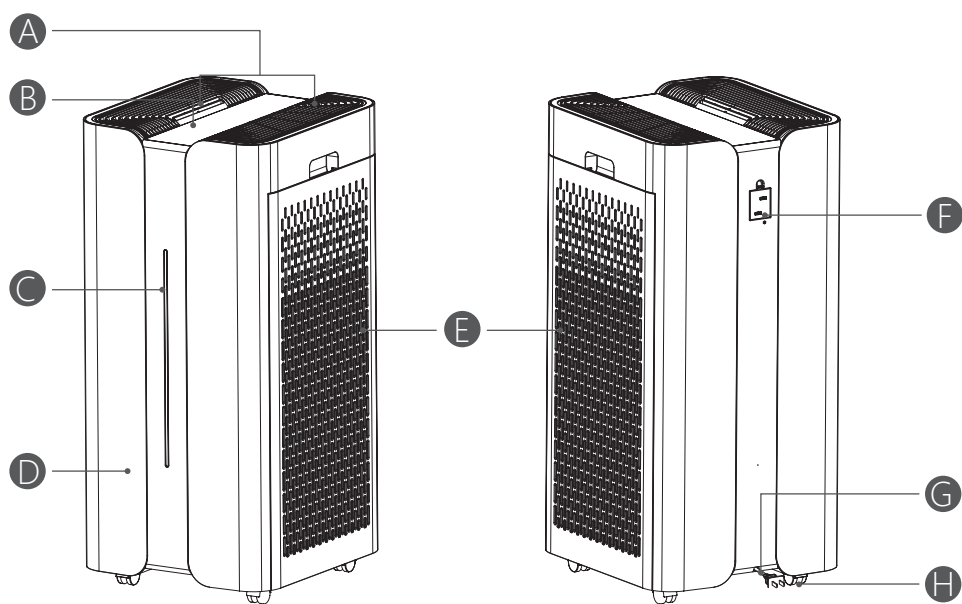

- A Air Outlet B Control Panel C Air Quality Indicator D Body
E Air Inlet F Sensor G Power Cord H Universal Wheel

Description

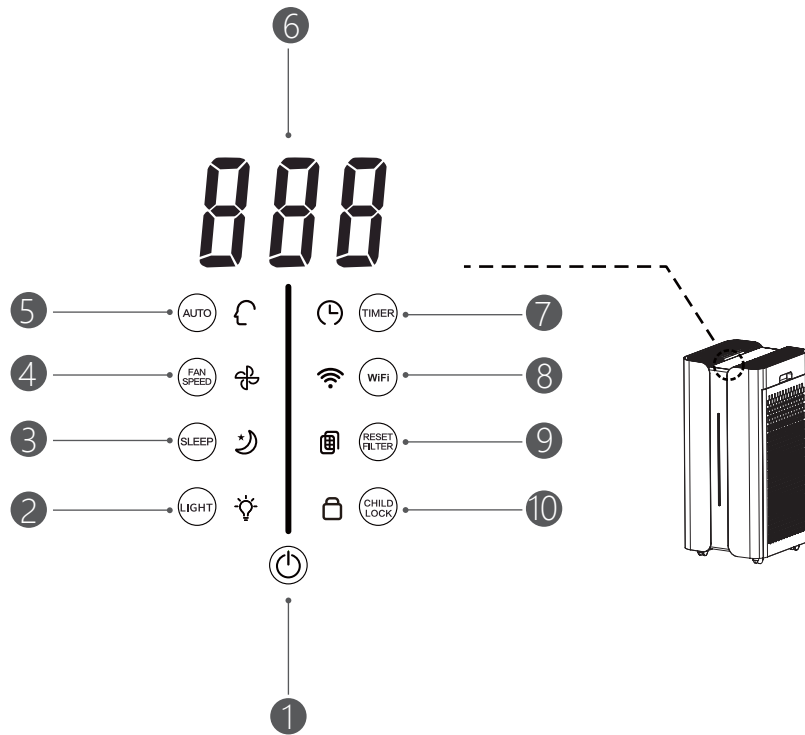

- | | | | |
|----------------|---------------------|-----------------|-------------------------|
| ① Power Button | ② Light Button | ③ Sleep Button | ④ Wind Speed Adjustment |
| ⑤ Auto Button | ⑥ Digital Display | ⑦ Timing Button | ⑧ WiFi |
| ⑨ Filter Reset | ⑩ Child Lock Button | | |

Principles of Purification

This air disinfection machine adopts H13 high-efficiency HEPA filter and activated carbon filter assembly. H13 high-efficiency filter can intercept 99.9% of aerosols and 0.1-10 micron particles carrying bacterial pathogens.

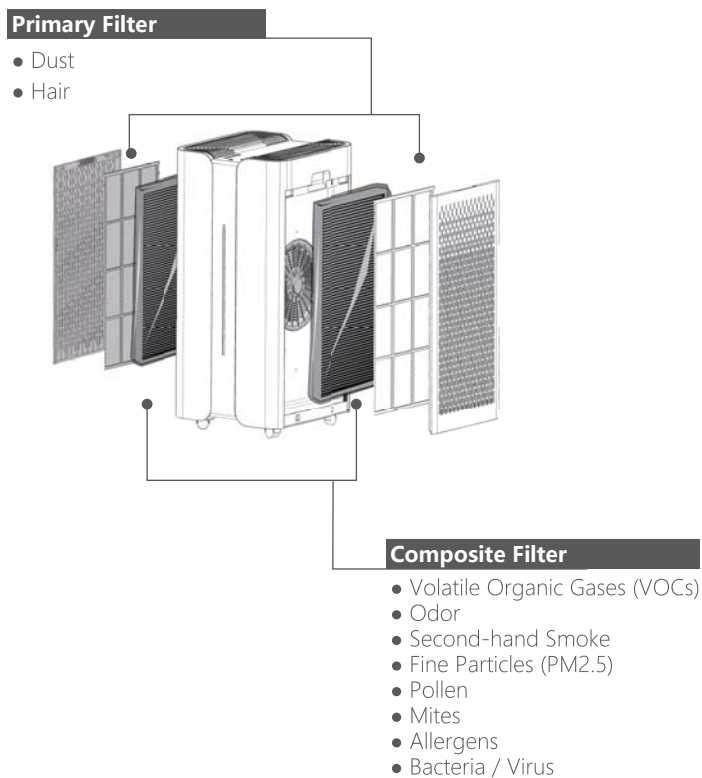

Instructions Before Use

Select the room where the air needs to be purified, and place the air purifier on a stable floor or table in the room.

For free air circulation, avoid placing the air purifier behind curtains, under windows, near furniture or shelves, or near any obstacles position, at least 20 inches (50cm) of free space should be reserved on air purifier.

Please confirm that the filter plastic bag inside the machine has been removed before the first use.

Please also confirm:

- The voltage at your home matches the voltage marked on the device.
- Your device can be connected to an ungrounded power plug. This device is a Class II appliance (Double insulation).
- The air inlet and outlet are completely unobstructed.
- Strainer and air inlet are installed correctly (See as below).
- If the air inlet is not installed properly, the device will not work properly.
- Instructions for removing the filter packaging and replacing the filter after the first use (See as below pic 1 - 6).

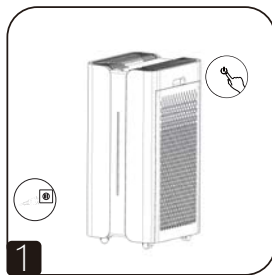

1 Turn off the power after pressing the power button.

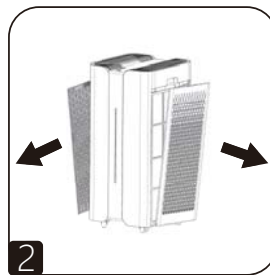

2 Open the panels of two side.

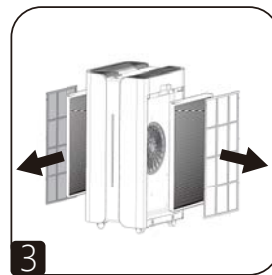

3 Remove all filters inside the product.

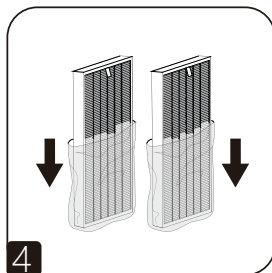

4 Remove all the packages from the filters.

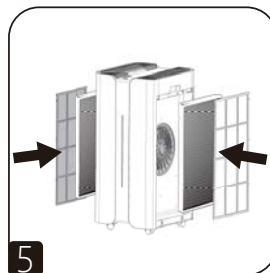

5 Replace the new filters as shown.

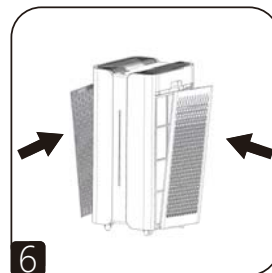

6 Put back the side-panels.

Instructions for Use

Power Switch

Connect the unit to outlet, use power switch to turn power on or off and turns on the air quality detection sensor system of the unit . After the digital tube frame of the operation panel flashes for about 30 seconds, the air quality detection sensor system completes the detection . Through the operation panel a digital display and air quality indicator blue, green, yellow, red, violet colors inform the indoor air quality status.

Digital Display	Color	Air Quality
1-12	Green	Excellent air quality
13-35	Blue	Good air quality
36-55	Yellow	Light pollution
56-150	Red	Average pollution
150 above	Violet	Heavy pollution

Light Button

Touch " Light " key , machine into Light mode operation.

Sleep Button

Touch the sleep button to turn on, the corresponding indicator on the display panel lights up. In this mode, the device will run at speed 1, at the same time, the various indicator lights of the device will go out, and touch the sleep button again to turn off.

Wind Speed Adjustment

You can touch the wind speed button to select the purification speed, and the wind speed indicator on the corresponding wind speed display panel will light up accordingly.

Speed 1: At this time, the purification wind speed is small, suitable for the situation where the air quality is very good;

Speed 2: The purification wind speed is slightly increased at this time, which is suitable for the situation of good air quality;

Speed 3: At this time, the purification wind speed is larger, which is suitable for most polluted indoor situations;

Speed 4: At this time, the purification wind speed is the largest, suitable for indoor conditions with poor air quality.

Auto Button

Turn on the auto mode, the corresponding indicator on the display panel lights up. In this mode, the device will automatically adjust the wind speed according to the air quality data detected by the sensor, which is suitable for most application scenarios.



Timing Button

When the unit is working, press the timer key to select the required working time (The corresponding time will be displayed on the 1 ~ 12h display panel), and the unit will automatically stop working after the set time.



WiFi

Long press " WIFI " for 5 seconds , wifi  symbol will start to flash quickly , long press " WIFI " again for 5 seconds , wifi  symbol will start to flash slowly , unit is ready to start network match . Open app and follow app instructions to complete wireless setup.

- The Wifi indicator lights flash white when matching the network.
- The Wifi indicator will be white when the matching is done.
- Repeat process to reset the WIFI network.



Filter Reset

When the service life of the machine filter expires, the filter light flashes, prompting replacement of the filter. After replacing the filter, press this filter reset button until the flashing lights stop. The filter reset is successful.



Child Lock Button

Long press Child Lock button to prevent changes to air purifier settings .
Long press again to remove Child Lock.

Wifi Connect Instruction

- 1 Download App
“Sterilumen”
on your mobile phone



- 2 Use your email or mobile
phone number to register

- 4 Click “Air purifier”



- 5 Connect the device
(switch on the wifi function on the machine)
click "Next"

- 3 Click “Add Device”

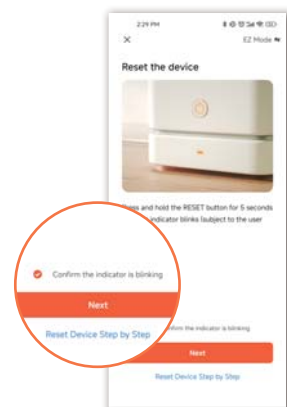

Wifi Connect Instruction

- 6 Input the wifi account and the password of the current room, and then confirm

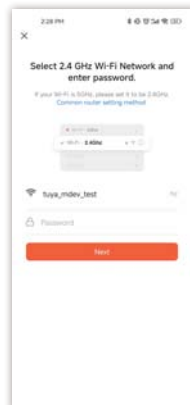

- 8 Connected, click "Done"



- 7 Connecting

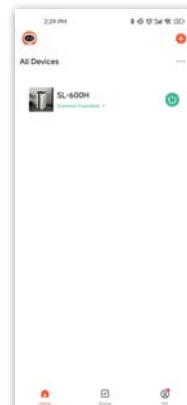
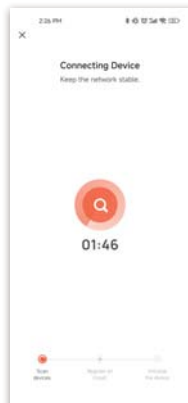

Maintenance

Before performing any maintenance operations, be sure to turn off the machine by pressing the power button and then unplugging the unit from the power outlet.

- The air inlet can be cleaned with water washing and vacuuming equipment (After washing, it must be completely dried before installation).
- The initial primary filter can be cleaned with water washing and vacuuming equipment (After washing, it must be completely dried before installation).

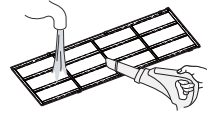
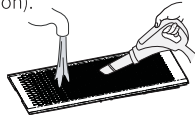

- The casing of the machine can be cleaned with a damp cloth, and the fan grills on both sides of the machine can be cleaned with vacuum equipment.
- The sensor cover can be removed and clean the dust on the sensor hole with a cotton swab.

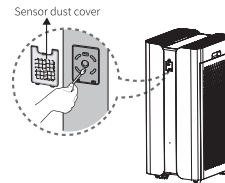

Important note: Do not wash the machine body, and do not use any abrasive objects to avoid damaging the surface of the device.

Filter Replacement	Filter Operating Frequency	Frequency
	Composite HEPA Filter Replace Every	12months

This data is calculated based on the use of low-grade purification wind speed, using 8 hours a day; The recommended filter replacement frequency will vary depending on the duration of use and the working environment. The corresponding indicator lights up when the filter needs to be replaced.

Attention! When your air purifier motor stops working, please check if the filter needs to be replaced.

- The filter life bar is reduced to the last grid and flashes, indicating that the composite filter needs to be replaced;

Note:

- *The composite filter cannot be washed or used repeatedly.
- *Do not wash them with water.
- *Replace the filters one by one, please refer to " Before Use " instructions for removing the filter package for the first use and replacing the filter .

Tips / Warnings

- If you are allergic or have asthma, avoid touching the used filters.
- Wear gloves when replacing the filter, or wash your hands after replacement.
- Put the used filter in a sealed bag and throw it away to prevent the spread of pollutants.
- Place unit as close to center of room for maximum air circulation.

Safety Precautions

Please read this manual carefully before using the product, and keep this manual in a safe place. You need to read these instructions carefully and follow these suggestions.

- For your safety, this product complies with applicable standards and regulations (Low voltage, electromagnetic compatibility, environmental protection ...).
- This product is not suitable for persons with physical, sensory, or mental disorders (including children), or those who lack experience or relevant knowledge, unless supervised by someone responsible for their safety, or given prior guidance on the use of the machine.
- Children should be supervised to ensure that they do not play with the product.
- If the power cord is damaged, please do not use this product. If the power cord is damaged, it must be repaired by the service department of manufacturer, or replaced by the specialized personnel in similar departments.
- Children must not clean and maintain the product without supervision.
- When performing maintenance on this product, refer to the "Maintenance" section in this manual.
- Keep the power cord out of reach of children.
- This product is designed for indoor use and should not be used in industrial applications.
- If the product is damaged due to improper operation, the warranty card is invalid.
- Do not operate the product in dusty, humid or fire-hazardous areas.
- Before use, always ensure that the electrical plug and power cord are good.
- Do not insert foreign objects (Such as needles) into the device.
- Do not pull on the power cord or device, or even unplug the plug from the outlet.
- Before use, extend the length of the power cord to a suitable length.

Important Matters

- Do not cover the air inlet or outlet.
- Do not touch the appliance with wet hands.
- Do not allow any liquid to enter the product.
- Do not use this product in a humid place.
- Do not place this product near a heat source.
- Do not place anything or insert foreign objects on this product.
- Please do not place this product near flammable items or products (Such as curtains, aerosols, organic solvents, etc.)
- Place the product on a stable surface and do not use it on its own or tilted;
- When not using the product for a long time: Use the power to turn off the device and unplug the power plug.
- Turn off the device and unplug it before moving it.
- Remove the plug when assembling or cleaning the device.

Storage Conditions

When not using the air purifier for a long time, please store it in a dry, cool place.

Common Malfunctions

Do not disassemble the machine without permission; improper repair may cause danger to the user!
Before contacting the after-sales service center, please check the following troubleshooting table:

Malfunction	Examination	Approach
Can not start	Is the power plugged in?	Plug in the power supply at the correct voltage.
	Are all the indicators not lit?	Press the switch button to select the desired function
	Is there a power outage?	Device available when power is restored.
	Is the air inlet filter door closed?	Install the air inlet filter door properly.
Airflow is greatly weaker than before	Does the filter need to be replaced?	Check if the filter has reached the replacement cycle and replace the filter if necessary.
Odor from the air outlet	Does the filter need to be replaced?	
Wind speed cannot be changed automatically	Whether it is manual mode?	Choosing the right operating mode.

Product Configuration and Parameters



Product Number:	SL-600H	Product Name:	Air Purifier
Rated Input:	AC 120V / 60Hz	Rated Power:	80W
Noise:	29~64dB(A)	Material:	ABS
Overall Size:	15*16*31 inches	Net Weight/ Gross Weight:	36 / 43 LBS
Application Area:	2800 sq. feet	CADR(Particulates):	660 CFM

Warranty

There is a one year from date of invoice Limited Warranty on all components against defect in material, not including labor or returned freight charges.

This (1) year Limited Warranty is void if equipment has not been operated and service in accordance with this manual.

SteriLumen, Inc. will repair or replace at their option any components which they find to be defective upon inspection this(1) year Limited Warranty does not cover damages from misuse, or neglect of equipment, or when used in other applications than described in this manual.

SteriLumen, Inc. assumes no liability whatsoever for any damages resulting from improper installation, operation, or maintenance not in accordance with this manual.

FCC Warning

This device complies with part 15 of the FCC Rules. Operation is subject to the following two conditions: (1) this device may not cause harmful interference, and (2) this device must accept any interference received, including interference that may cause undesired operation. Any changes or modifications not expressly approved by the party responsible for compliance could void the user's authority to operate the equipment.

NOTE: This equipment has been tested and found to comply with the limits for a Class B digital device, pursuant to Part 15 of the FCC Rules. These limits are designed to provide reasonable protection against harmful interference in a residential installation. This equipment generates, uses and can radiate radio frequency energy and, if not installed and used in accordance with the instructions, may cause harmful interference to radio communications. However, there is no guarantee that interference will not occur in a particular installation.

If this equipment does cause harmful interference to radio or television reception, which can be determined by turning the equipment off and on, the user is encouraged to try to correct the interference by one or more of the following measures:

- Reorient or relocate the receiving antenna.
- Increase the separation between the equipment and receiver.
- Connect the equipment into an outlet on a circuit different from that to which the receiver is connected.
- Consult the dealer or an experienced radio/TV technician for help.

To maintain compliance with FCC's RF Exposure guidelines, This equipment should be installed and operated with minimum distance between 20cm the radiator your body: Use only the supplied antenna.

Maintenance Records



800-627-4913
www.sterilumen.com