

# ROSELOVE

Now, you can boldly explore  
Your  
Sweet Moment.  
Thank you for joining us and  
enjoy yourself.



Official Support Email:  
[support-us@bigshocked.com](mailto:support-us@bigshocked.com)



Official Support Hotline :  
+1 ( 888 ) 868-2241

Hours: Monday-Friday, 9 AM-10 PM EST



## User Manual

Product Name

# ROSELOVE

Enjoy Big “O”



Note: Colors may differ from the image



Official Support Hotline :  
+1 ( 888 ) 868-2241



Official Support Email:  
[support-us@bigshocked.com](mailto:support-us@bigshocked.com)

Hours: Monday-Friday, 9 AM-10 PM EST

# Enjoy Big “O”



Discreet  
Packaging



Body Safe  
Materials



1-Year  
Warranty



Free Shipping

\*Amazon  
Prime Members  
Enjoy Free Shipping

# Table of Contents

First-Time Use Checklist	1
Discover The JOYHUB App	3
How to Use	4
Connect with The JOYHUB App	5
App Features & Fun	6
Charging Instructions	7
Cleaning & Safety Tips	8
Usage Tips & Best Practices	9
Troubleshooting & Customer Support	11
Warranty & Brand Commitment	12

# First-Time Use Checklist

**Before you begin,  
ensure you've done the following:**



## **1. Fully charge the device**

The indicator light flashes during charging and turns solid when full (approx. 90 mins).



## **2. Press and hold power button for 3 seconds**

(Short presses won't work)  
A quick press won't work — long press is required to turn on/off.

# First-Time Use Checklist



## 3. Review safety precautions

Never use while charging.  
Avoid submersion in water.



## 4. Want advanced features?

Download the JOYHUB App to unlock remote play, music mode, and more (see next page).

# Discover The JOYHUB App

**Unlock the full potential of your ROSELOVE  
with the JOYHUB App.**

Enjoy remote control, custom suction patterns, and more.

↓ *Download now from the iOS App Store, or scan the QR code.*  
(Full connection guide on page 5)



**Now, you can boldly explore your sweet moment.**

# How to Use

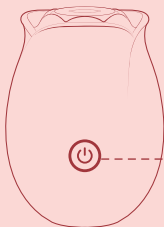

## **Power Button :**

Long press (3s): Turn ON/OFF  
Short press: Cycle through 10 sucking modes

## **Charging Indicator Status**

Flashing = Charging  
Solid = Fully charged  
Off = Device powered off

*\*Make sure to fully charge the toy before first use.*

**If you have any questions, please contact us:**

**Toll-Free Support :** +1 (888) 868-2241

**Email:** [support-us@bigshocked.com](mailto:support-us@bigshocked.com)

**Hours:** Monday-Friday, 9 AM-10 PM EST

# Connect with The JOYHUB App



1.



## Turn on the toy

(Press and hold the power button for 3 seconds until the light turns on).

2.



## Open the JOYHUB App

(Make sure wireless connection is enabled on your phone).

3.

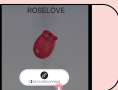

## Pair the toy

The app will automatically detect the toy. If not, try restarting the toy or refreshing BT in the app.

4.



## Start exploring

Once connected, enjoy multiple suction modes, patterns, and remote control options.

### *Tips for successful connection:*

- Fully charge the device before pairing
- Close and reopen the app if BT fails
- Keep the toy powered ON during pairing
- Restart your phone if needed



# App Features & Fun

**Elevate your ROSELOVE experience with the JOYHUB app – your gateway to next-level pleasure.**



*Toy games and rankings*



*Recommended programs and videos*



*Share and connect in JOYHUB*



*Chat freely*



*Mutual control in the room*

## ***Pro Tips:***





- Explore these features in a private, comfortable space.
- Use JOYHUB to unwind, discover new pleasures, and join the sweet moment.
- Note: Features are regularly updated – stay tuned for enhancements!

# Charging Instructions

 90min

 45min

## Warnings

-  Do not use the product while charging
-  **Only use the included charging cable**
-  Ensure the charging port is dry before connecting
-  Recommend using a standard charger



## Charging Instructions

- Connect the USB cable to the charging port on the device.
- Plug the USB end into a power adapter or USB port.
- Charging takes approximately 90 minutes.
- While charging, the indicator light will flash.
- When fully charged, the light will stay on.

# Cleaning & Safety Tips

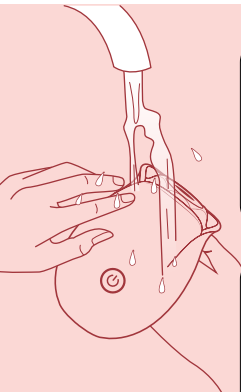

## • Cleaning Instructions



Clean the product before and after each use



Use warm water and mild soap or a toy cleaner



Avoid prolonged submersion to preserve product lifespan



Dry thoroughly with a soft towel

## • Safety Tips



Do not use the product while charging



Keep away from sharp objects or extreme temperatures



Store in a cool, dry place



This product is intended for personal use only

# Usage Tips & Best Practices

**To enjoy your product safely and comfortably, we recommend the following tips:**

## Set the mood



Create a relaxed, private environment. Use soft lighting or calming music.

## Start gently

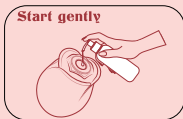

Begin with the lowest intensity settings. Apply water-based lubricant if needed.

## Know your limits

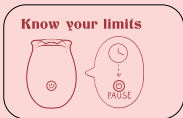

Keep sessions to a comfortable duration. Pause immediately if you feel discomfort.

## Enjoy your sweet moment



Take time to rest and relax afterward. This is your sweet moment.

# Usage Tips & Best Practices

Please refer to the diagram for recommended areas of use for the toy:

## Nipple / Breast



### For Hotspots:

Use the vibrator on nipples or breasts for foreplay fun.

## Clitoral / Anus



**For External Sensations:** Use the vibrator on your clitoral for external sensations. The adult toys will stimulate deep tissue around your clitoral.

## Vagina / Anal



**For Internal Sensations:** Use the vibrator to massage your a-spot.

## Ears



**For External Sensations:** Use the sucking vibrator next to your ears to increase stimulation and pleasure.

# Troubleshooting & Customer Support

## Troubleshooting

### **The toy won't turn on or won't charge**

Ensure it's fully charged with the original cable and hold the power button for at least 3 seconds. If still unresponsive, contact support.

### **Cannot connect to the app**

Verify that wireless connection is enabled and the toy is powered on. If the connection fails, try uninstalling and reinstalling the app.

### **Weak suction or rose not working**

Switch to a different mode or increase the intensity setting. If there's still no response, the product may be defective. Contact us for assistance.

## Customer Support

**We're here for you! If you have any issues with the product, our customer support is here to help — feel free to reach out anytime.**



Official Support Email:  
**support-us@bigshocked.com**



Official Support Hotline :  
**+1 ( 888 ) 868-2241**

Hours: Monday-Friday, 9 AM-10 PM EST

# Warranty & Support Commitment

We support everyone in discovering joy, releasing pressure, and embracing your own sweet moment. Your comfort and satisfaction mean everything to us.

## Our Commitment

If your toy has a manufacturing defect within 12 months of purchase, we'll provide a free replacement or full refund.

### **Warranty Period** **12-month replacement warranty**

#### Warranty Coverage

Excludes damage from misuse, improper cleaning, or storage



Official Support Email:

[support-us@bigshocked.com](mailto:support-us@bigshocked.com)



Official Support Hotline :

+1 ( 888 ) 868-2241

Hours: Monday-Friday, 9 AM-10 PM EST



**FCC Warning:**

This equipment has been tested and found to comply with the limits for a Class B digital device, pursuant to part 15 of the FCC Rules. These limits are designed to provide reasonable protection against harmful interference in a residential installation. This equipment generates, uses and can radiate radio frequency energy and, if not installed and used in accordance with the instructions, may cause harmful interference to radio communications. However, there is no guarantee that interference will not occur in a particular installation. If this equipment does cause harmful interference to radio or television reception, which can be determined by turning the equipment off and on, the user is encouraged to try to correct the interference by one or more of the following measures:

- Reorient or relocate the receiving antenna.
- Increase the separation between the equipment and receiver.
- Connect the equipment into an outlet on a circuit different from that to which the receiver is connected.
- Consult the dealer or an experienced radio/TV technician for help.

**Caution:** Any changes or modifications to this device not explicitly approved by manufacturer could void your authority to operate this equipment.

This device complies with part 15 of the FCC Rules. Operation is subject to the following two conditions:

(1) This device may not cause harmful interference, and (2) this device must accept any interference received, including interference that may cause undesired operation.

This equipment complies with FCC radiation exposure limits set forth for an uncontrolled environment. This equipment should be installed and operated with minimum distance 0cm between the radiator and your body.