

Redefine Your Pleasure

Redefine Your Pleasure



Official Support Email:
support@einseo.com



Official Support Hotline:
+1 (888) 897 2005 (US/CA)

Hours: Monday-Friday, 9AM-10PM EST



1 Year Warranty



Premium Materials



Discreet Shipping



LGBTQ+ Friendly



After-Sales Support



Easy to use

Product Packaging	01
First-Time Use Checklist	02
Introducing the JOYHUB App	03
How to Use	04
Pairing with the JOYHUB App	05
Smart Control via the JOYHUB App	06
Charging Instructions	07
Disassembly Guide & Lubricant Guide	08
Using EINSEO Thermos	09
Cleaning Instructions & Maintenance	10
Troubleshooting Guide	11
After-Sales & Customer Support	12

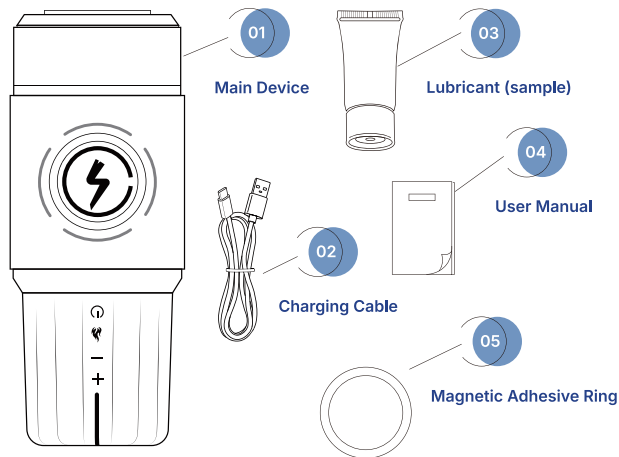

Product Basic Parameters:

Color: Blue & Black

Material: Thermoplastic Elastomer (TPE),
Acrylonitrile Butadiene Styrene (ABS)

Brand: EINSEO

Water Resistance Level: Waterproof

Product Care Instructions: Hand Wash

Package Dimensions: 10.7*4.9*4.9 inches; 3.1 Pounds

Batteries: 1 Lithium Polymer batteries required. (included)

Modes: 5 Thrusting modes & Heating Function

Magnetic Phone Mount Lid: The cup lid serves as a magnetic phone holder. A magnetic ring is included—stick it to your phone to securely attach it to the lid for hands-free use.



Before You Begin

Please review this checklist before first use to ensure optimal performance.

1. Personal Use Only

This device is intended for personal use only. Do not share with others to prevent cross-contamination.

2. Initial Charging

Use the included USB-C cable to fully charge the device for about 3 hours before first use. The LED will pulse while charging and remain solid for 5 minutes once charging is complete. Using third-party chargers may damage the device. Cycle through all speed levels and functions (thrust, heat) to verify normal operation.

3. Assembly and Function Check

Make sure the inner sleeve is properly seated. Hold the power button for 2 seconds to turn on/off. On startup, it defaults to constant-speed Mode 1.

4. Lubrication

Always apply a water-based lubricant before use. Do not use silicone or oil-based lubricants, as they may damage internal materials. Never operate the device without lubrication.

5. Cleaning and Maintenance

After use, turn off the device and wait 5–10 minutes before removing the sleeve—it may still be warm, and waiting ensures safer handling. Clean the sleeve with warm water and mild soap. Do not immerse the main device in water; wipe it with a soft, damp cloth only. See page 10 for details.

6. Safety Precautions

Do not operate while charging.
Stop immediately if you feel discomfort or hear unusual noises.
Do not disassemble.
Keep away from children and pets.
Store in a cool, dry place out of direct sunlight.



Unlock all the features of Martino with the JOYHUB App.

Explore remote control, interactive play, and more.

Download now from the iOS App Store, or scan the QR code.
(Full connection guide on page 5)

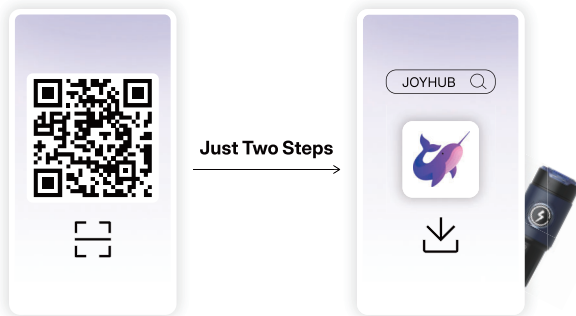

support@joyhub.net

Connect with the JOYHUB app and discover more.
Let Einseo redefine your pleasure.



Power Button

- Hold for 2 seconds to power on (standby).
- Short press to start/switch 5 Thrusting modes. Hold again to power off.



Heating Button

- In standby mode, short press to activate heating mode.

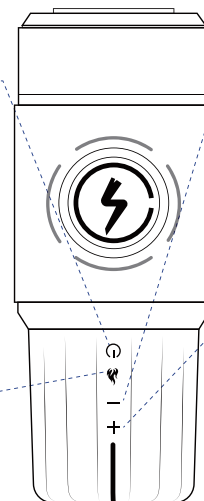

"-" Key

- Short press to decrease speed.
- Long press for 2 seconds to pause. Press any key to resume.



"+" Key

- Short press to increase speed (5 modes).
- Long press for burst mode. Press any key to return to mode 1.

Magnetic Ring Usage Guide:

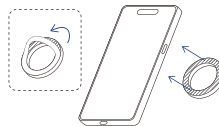

- 1 Remove the backing and stick the ring to your phone's back.

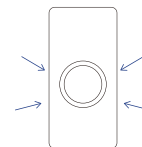

- 2 Attach your phone to the lid's magnetic holder.

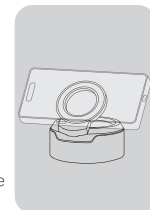

Tips:

fully charge before use for best performance

05 Pairing with the JOYHUB App

EINSEO



Turn on the toy

Press and hold the power button for 3 seconds until the light turns on.

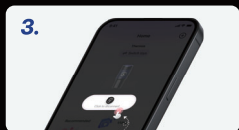

The app will automatically detect the toy.

If not, try restarting the toy or refreshing Bluetooth in the app.

Tips:

Tips for successful connection:

- Fully charge the device before pairing.
- Keep the toy powered ON during pairing.
- Close and reopen the app if Bluetooth fails.
- Restart your phone if needed.

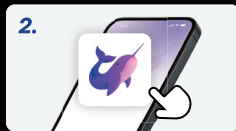

Open the JOYHUB App

Make sure Bluetooth is enabled on your phone.

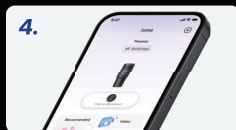

Once connected

You can now explore multiple vibration modes, patterns, and remote control options.

06 Smart Control via the JOYHUB App

EINSEO

Enjoy more

The Einseo Martino, paired with the JOYHUB app, unlocks a new world of pleasure for you!

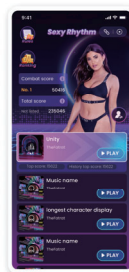

Toy Game and Ranking

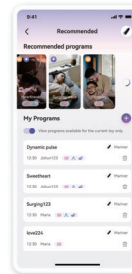

Video Play



Customizable Modes

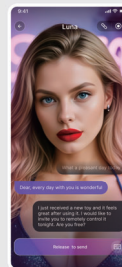

AI Visual Interaction

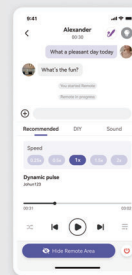

Remote Play

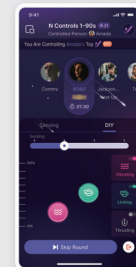

Multiplayer Rooms

Discover more with Joyhub.

Einseo is here to elevate your pleasure experience.

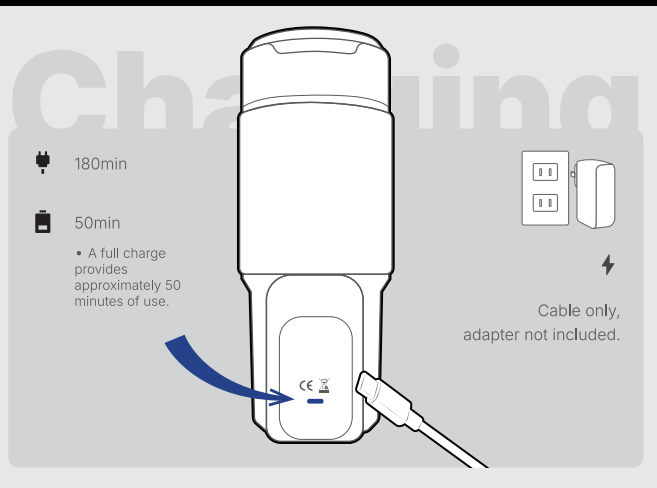

⚠ Charging Instructions

- Use the included USB-C cable and a standard 5 V/1.5 A USB port or charger to power the device.

⚠ Important:

- Plug the USB-C end into the device and the USB-A end into your computer or a USB wall adapter.
- Charging current must not exceed 1.5 A at 5 V.
- While charging, the indicator light will flash. A solid light for 5 minutes after charging indicates completion (approximately 3 hours total). Do not leave the device charging longer than necessary.
- The device cannot be operated while charging. Always unplug the cable before turning it on.

⚠ Indicator Light Behavior

- Low Battery: When battery is critically low, the light flashes 30 times then the device shuts off automatically.
- Charging: Light flashes continuously during charging. After full charge, it stays solid for 5 minutes, then turns off. The device cannot be powered on while charging.
- Power-On Feedback: In standby or on mode, a single tap of the button makes the light flash once to confirm the command.
- Preheat/Pause: During preheating or in a paused state, the indicator remains steadily lit.

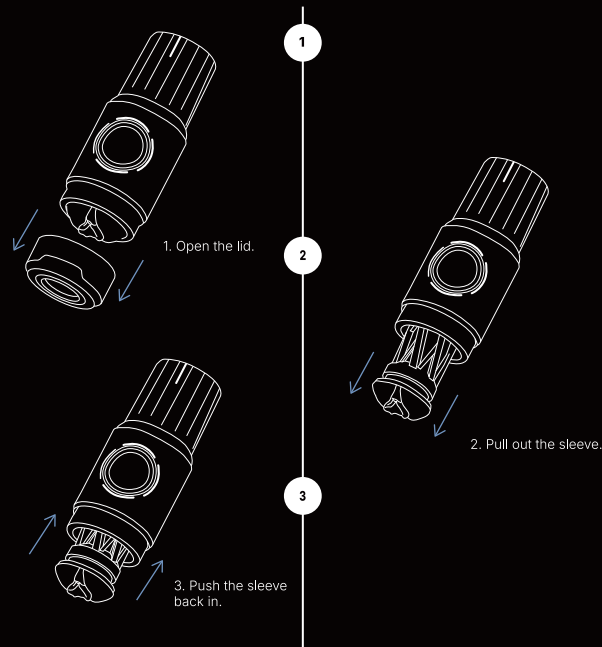

Lubrication Warning: Always use a water-based lubricant before use; Do not use the device the device dry or with silicone/oil-based lubricants.

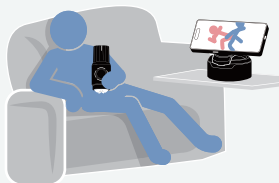

Snap. Stand. Enjoy

Lid Doubles as Phone Stand

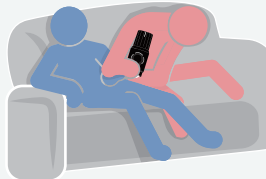

Couple Play

Share intimate moments together.

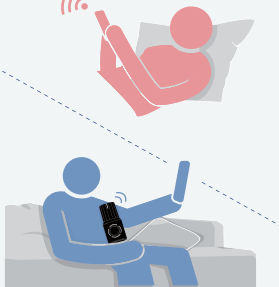

Long-Distance Fun

Connect and play remotely.



App-Connected Gaming

Interactive, app-powered experience.

After use, turn off the device and wait 5–10 minutes before removing the sleeve. It may feel slightly warm, but the chamber can be hotter. Waiting makes removal safer and more comfortable.

1

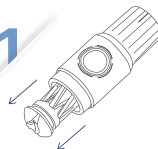

1. Remove the inner sleeve

2



2. Rinse the inner sleeve with water

3



3. Dry the inner sleeve

4

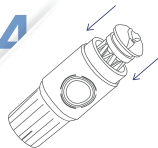

4. Reassemble for next use

5

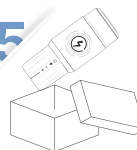

5. Reassemble & store

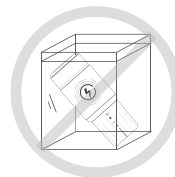

Do not immerse the electronic unit in water.
Avoid alcohol, bleach, and corrosive cleaners.
Make sure all parts are fully dry to prevent mold and odor.



Maintenance & Care

- Clean & Dry. Remove the sleeve and rinse with warm water ($\leq 45^{\circ}\text{C}$) and mild soap. Air-dry thoroughly or pat dry with a lint-free cloth before reassembly.
- Battery Preservation. If unused for over 3 months, recharge once to prevent battery aging.
- Handle with Care. Don't use hot water over 45°C on the sleeve to avoid material damage. Ensure the sleeve is completely dry before reattaching to prevent shorts or malfunctions.



Won't Turn On or Charge Properly

1. Make sure the battery isn't empty. Charge the device for at least 30 minutes before first use using the original USB-C cable and a 5V=2A adapter. The indicator light will pulse while charging and turn solid green when fully charged.

Note: The device won't power on during charging.

2. Check all connections. Ensure the USB cable and adapter are undamaged, and all ports are clean, dry, and secure.

3. Power on properly. Press and hold the power button for 3–5 seconds to turn the device on.

4. Still not working? Try a different USB port or adapter.

If the issue continues, please contact us – we're here to help!



Weak Motor or Low Power

Fully charge the device before use to ensure maximum performance.

For stronger intensity, try the 5th mode or press and hold the [+] button to activate Power Burst Mode.



Program Error or Unresponsive

Turn the device off, then press and hold the power button again to reboot.



We're here for you! If you have any issues with the product, our customer support is here to help — feel free to reach out anytime.

Limitless Pleasure:

Thank you for choosing Einseo Thermos. We hope this product brings you an unprecedented experience. At Einseo, we are committed to Redefining Your Pleasure, combining advanced technology and craftsmanship to unlock limitless possibilities with every touch.

Our Commitment:

We stand behind the quality of our products. If your toy is defective within 12 months of purchase, we offer a free replacement or full refund.

Warranty:

12-month replacement warranty.

Covers manufacturing defects only (not misuse or damage from improper cleaning or storage).



Official Support Email:
support@einseo.com



Official Support Hotline:
+1 (888) 897 2005 (US/CA)

Hours: Monday-Friday, 9AM-10PM EST

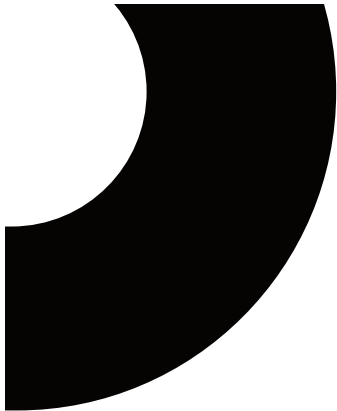

EINSEO

Redefine Your Pleasure

from one touch to infinite sensation, let's start it



FCC Warning:

This equipment has been tested and found to comply with the limits for a Class B digital device, pursuant to part 15 of the FCC Rules. These limits are designed to provide reasonable protection against harmful interference in a residential installation. This equipment generates, uses and can radiate radio frequency energy and, if not installed and used in accordance with the instructions, may cause harmful interference to radio communications. However, there is no guarantee that interference will not occur in a particular installation. If this equipment does cause harmful interference to radio or television reception, which can be determined by turning the equipment off and on, the user is encouraged to try to correct the interference by one or more of the following measures:

- Reorient or relocate the receiving antenna.
- Increase the separation between the equipment and receiver.
- Connect the equipment into an outlet on a circuit different from that to which the receiver is connected.
- Consult the dealer or an experienced radio/TV technician for help.

Caution: Any changes or modifications to this device not explicitly approved by manufacturer could void your authority to operate this equipment.

This device complies with part 15 of the FCC Rules. Operation is subject to the following two conditions:

(1) This device may not cause harmful interference, and (2) this device must accept any interference received, including interference that may cause undesired operation.

This equipment complies with FCC radiation exposure limits set forth for an uncontrolled environment. This equipment should be installed and operated with minimum distance 0cm between the radiator and your body.