

Portable SpeakerDock

Quick Start Guide

Introduction

The Portable SpeakerDock is an easy-to-use device which features a USB connection for seamless business and personal communication.

SpeakerDock Connection

Option 1

- Connect the Portable SpeakerDock to a computer via the USB cable of the Portable SpeakerDock. When the Portable SpeakerDock and the computer are connected, the LED indicator on the Portable SpeakerDock lights up green (15w bus power) or white (7.5w bus power).

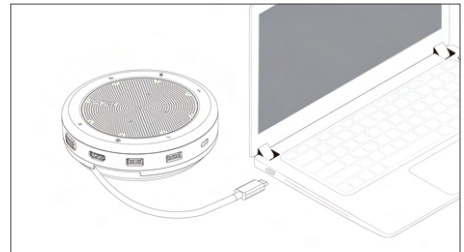

Option 2

- Connect to your computer or mobile device via Bluetooth. The LED will light up blue to indicate the speakerphone is connected and powered on.
- Connect the power adapter to the USB-C port of the Portable SpeakerDock. The Portable SpeakerDock can work as a charger when it is connected with the USB-C power adapter (optional) .

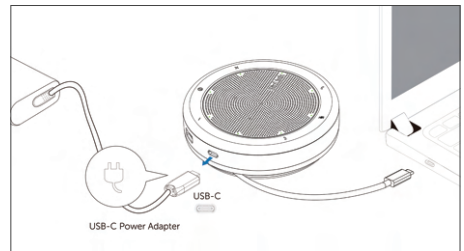
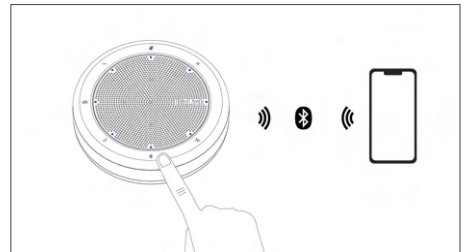

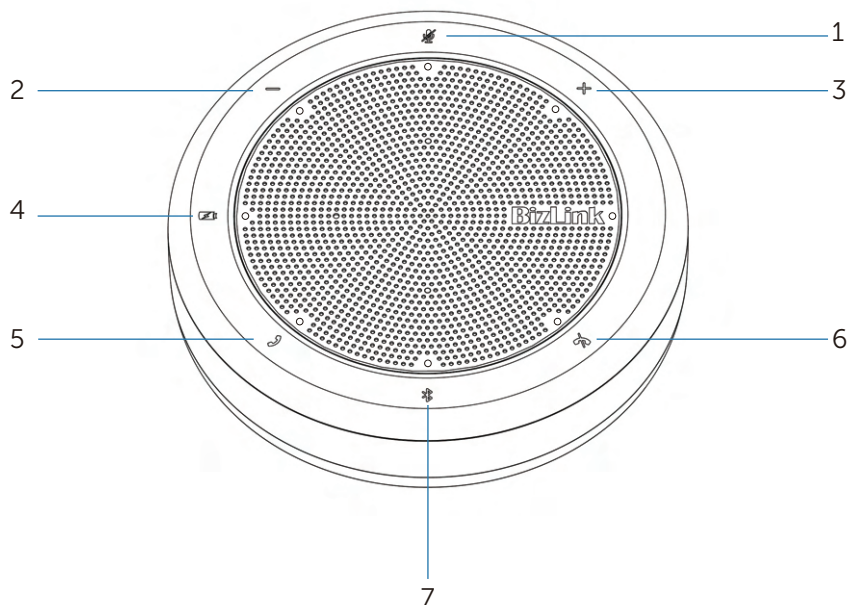

Button Functions

	Name	Description
1	Mute	Press the Mute button to mute the microphone. Press the button again to unmute the microphone.
2	Volume - Button	Decrease the volume of the Portable SpeakerDock.
3	Volume + Button	Increase the volume of the Portable SpeakerDock.
4	Battery Button	Press to view the battery power.
5	Answer Call Button	Press the Answer Call button to answer a call.
6	End Call Button	Press the End Call button to end or reject a call.
7	Bluetooth Button	Press and hold (2 secs) the button to connect with a new Bluetooth device (pairing).

Federal Communication Commission Interference Statement

This device complies with Part 15 of the FCC Rules. Operation is subject to the following two conditions: (1) This device may not cause harmful interference, and (2) this device must accept any interference received, including interference that may cause undesired operation.

This equipment has been tested and found to comply with the limits for a Class B digital device, pursuant to Part 15 of the FCC Rules. These limits are designed to provide reasonable protection against harmful interference in a residential installation. This equipment generates, uses and can radiate radio frequency energy and, if not installed and used in accordance with the instructions, may cause harmful interference to radio communications. However, there is no guarantee that interference will not occur in a particular installation. If this equipment does cause harmful interference to radio or television reception, which can be determined by turning the equipment off and on, the user is encouraged to try to correct the interference by one of the following measures:

- Reorient or relocate the receiving antenna.
- Increase the separation between the equipment and receiver.
- Connect the equipment into an outlet on a circuit different from that to which the receiver is connected.
- Consult the dealer or an experienced radio/TV technician for help.

FCC Caution: Any changes or modifications not expressly approved by the party responsible for compliance could void the user's authority to operate this equipment.

This transmitter must not be co-located or operating in conjunction with any other antenna or transmitter.

Radiation Exposure Statement:

The product complies with the FCC portable RF exposure limit set forth for an uncontrolled environment and are safe for intended operation as described in this manual. The further RF exposure reduction can be achieved if the product can be kept as far as possible from the user body or set the device to lower output power if such function is available.