

使用说明书

2.4G 八轮特技遥控车

遥控车及遥控器部件说明



遥控车及遥控器电池安装

遥控车电池安装步骤



遥控器电池安装步骤



遥控车电池充电



遥控车加水说明



电池使用注意事项

1. 遥控车使用3.7V可充电锂电池，遥控器使用2颗1.5 “AA” 非充电电池。
2. 非充电电池不可充电。
3. 充电电池只能在成人监护下充电。
4. 充电电池在充电前应从玩具中取出。
5. 如何取出和放入电池：用螺丝刀松开螺丝钉，打开电池盖，按正确极性放入和取出电池。
6. 取出和放入电池时应按其电池盖上的标识进行。
7. 只能使用与原装电池一样或相同的电池。
8. 不可混用新旧或不同品牌的电池。
9. 电池应以正确的极性放入。
10. 用尽的电池应从玩具中取出。
11. 电源端子不应短路。

功能演示说明

开启电源：打开遥控车开关。车头灯会一直快速闪烁，此时，应该打开遥控器对频。遥控车完成对频后，车头灯停止快速闪烁。当对频完成的时候，遥控器红色指示灯变成常亮状态。可以推动面板上相应的功能摇杆控制遥控车动作。

遥控距离：遥控距离30米左右

使用时间：满电状态下，可达25分钟左右

前进



后退



左旋转



右旋转



前轮上升摆臂



前轮下降摆臂



后轮上升摆臂



后轮下降摆臂



站立旋转



利用前后轮升降摆臂调整好造型之后任意长按动左右旋转其一即可完成

炫酷灯光 开启/关闭



一键喷雾 开启/关闭



一键自动演示



温馨提示：
演示的时候只要任意操作前后或者左右旋转操作杆即可解除



温馨提示:

当前后轮空转时
碰撞一瞬间时发
出“咔哒”声，
松开按钮，然后
再次按钮，车轮
向反方向旋转松
开。



不能对着水龙头加水!



不能将车子浸泡在水里!



警告

当遥控器无法控制遥控车时，
先关闭遥控器电源，再关闭
遥控车电源，再开启电源，
然后再扳动遥控器控制杆重
对频。

注意事项

- 1.可拆卸的小零件要放好，千万不可
让小孩吞食。
- 2.如操作场地有电波干扰，请另选场
地操作。
- 3.遥控器电源低电时，请立即停止操作。
- 4.对拆除后的包装物，请不要随地丢弃，
以免污染环境卫生。
- 5.请将您的遥控模型存放在干燥，阴凉
的地方。
- 6.不要置于近火的高温、潮湿的地方
储存。
- 7.当电池被水浸湿，请将水分充分地
擦拭干净，如有变形，请停止使用。

FCC警告声明

未经负责遵守的一方明确批准的改变或修改可能会使用户操作设备的权力失效。

本设备已经过测试，符合FCC规则第15部分对B类数字设备的限制。本设备已经过测试，符合FCC规则第15部分规定的B类数字设备的限制。这些

这些限制旨在提供合理的保护，防止住宅安装中的有害干扰。

安装中的有害干扰。本设备会产生并辐射无线电频率能量，如果不按照说明书的要求安装和使用，则会产生干扰。

如果不按照说明安装和使用，可能会对无线电通信造成有害干扰。

通信造成有害干扰。然而，我们不能保证在特定的安装环境下不会发生干扰。

安装。如果本设备确实对无线电或电视接收造成有害干扰。

如果本设备确实对无线电或电视接收造成有害干扰，可以通过关闭和开启设备来确定，我们鼓励用户尝试通过以下一种或多种方式来纠正干扰。

通过以下一项或多项措施来纠正干扰。

- 调整接收天线的方向或重新定位。
- 增加设备和接收器之间的间隔。
- 将设备连接到与接收器所连接的电路不同的插座上。
- 向经销商或有经验的无线电/电视技术员寻求帮助。

本设备符合FCC规则的第15部分。操作须符合以下条件

- (1) 本设备不得造成有害干扰，以及
 - (2) 本设备必须接受任何收到的干扰，包括可能导致不希望的操作的干扰。
- 导致不希望的操作。

AN INSTRUCTION MANUAL

2.4G EIGHT WHEEL STUNT REMOTE CONTROL VEHICLE

DESCRIPTION OF REMOTE CONTROL VEHICLE AND REMOTE CONTROL COMPONENTS



REMOTE CONTROL VEHICLE AND REMOTE CONTROL BATTERY INSTALLATION

Battery installation steps



1-unscrew the battery cover with a screwdriver



2-finally, connect the body plug with the battery plug

Battery installation steps



1-unscrew the battery cover with a screwdriver



2-finally, install two 1.5"AA" batteries

REMOTE CONTROL VEHICLE BATTERY CHARGING



INSTRUCTIONS FOR ADDING WATER

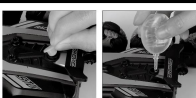

FUNCTION DEMONSTRATION DESCRIPTION

POWER ON:

Turn on the remote control car switch, and the headlights will flash rapidly all the time. You should turn on the remote control to check the frequency. When the remote control vehicle completes frequency alignment, the headlights stop flashing rapidly. When the frequency matching is completed, the remote car's red indicator light at the front will become normally on. Can push the panel the corresponding function remote lever controls the action of the remote control vehicle.

REMOTE CONTROL DISTANCE:

The remote control distance is about 30 meters.

USAGE TIME:

It can take about 25 minutes when it is fully charged.

Precautions for battery use

1. The remote control car uses 2/28 rechargeable lithium batteries, and the remote control car uses two 1.5 "AA" non-rechargeable batteries.
2. Non-rechargeable batteries cannot be recharged.
3. The rechargeable battery can only be charged under adult supervision.
4. The rechargeable battery should be taken out of the car before charging.
5. How to take out and put in the battery (insert the screw with a screwdriver, unscrew the battery cover, and press the control key).
6. Please put it in and take out the battery.
7. Take out the battery according to the identification on the car battery cover.
8. Only use the same or the same battery as the recommended battery.
9. Do not mix new and old batteries or different types of batteries.
10. The battery should be charged in the correct polarity.
11. The recharged battery should be kept in a cool place.
12. The power terminal should not be short-circuited.

FORWARD



BACK OFF



LEFT ROTATION



RIGHT ROTATION



FRONT WHEEL LIFTING SWING ARM



FRONT WHEEL LOWERING SWING ARM



REAR WHEEL LIFTING SWING ARM



REAR WHEEL LOWER SWING ARM



STANDING ROTATION



USE THE FRONT AND REAR WHEELS TO MOVE AND
LOWER THE SWINGARM FORWARD/BACK
PUSH LEFT/RIGHT BUTTON FOR ANGLE AFTER
NEED ACTION/COME TO PHASE

COOL LIGHTS ON / OFF



ONE KEY SPRAY ON / OFF



ONE KEY AUTOMATIC DEMONSTRATION



REMINDER:

WHEN DEMONSTRATING, JUST BEFORE AND
AFTER ANY OPERATION OR ROTATE THE
CONTROL LEVER LEFT AND RIGHT TO RELEASE

REMOTE CONTROL VEHICLE STUNT ACTION REFERENCE



REMINDER:

When the front rear wheel is deformed
When collision leads together
"Click" sound,
Release the key and
Press again, wheel
Rotate loose in the
opposite direction On.



Don't add water to the tap!



Don't soak the car in water!

WARNING

When the remote control cannot control the remote control car, Turn off the power of the remote control first, and then turn it off to control the vehicle power, and then turn on the power, then pull the remote control lever again frequency alignment.

MATTERS NEEDING ATTENTION

1. The small detachable parts should be placed well, never let the child swallow.
2. If there is radio interference in the operation site, please choose another site/ground operation.
3. When the power supply of the remote control is low, please stop the operation immediately.
4. Please do not discard the removed packages anywhere, so as not to pollute environmental sanitation.
5. Please store your remote control model in a dry and cool place/where.
6. Do not put it in a hot and humid place near the fire Storage.
7. When the battery is wet by water, please fully remove the water/Wipe it clean. If it is deformed, please stop using it.

FCC Warning Statement

Changes or modifications not expressly approved by the party responsible for compliance could void the user's authority to operate the equipment. This equipment has been tested and found to comply with the limits for a Class B digital device, pursuant to Part 15 of the FCC Rules. These limits are designed to provide reasonable protection against harmful interference in a residential installation. This equipment generates uses and can radiate radio frequency energy and, if not installed and used in accordance with the instructions, may cause harmful interference to radio communications. However, there is no guarantee that interference will not occur in a particular installation. If this equipment does cause harmful interference to radio or television reception, which can be determined by turning the equipment off and on, the user is encouraged to try to correct the interference by one or more of the following measures:

- Reorient or relocate the receiving antenna.

- Increase the separation between the equipment and receiver.

- Connect the equipment into an outlet on a circuit different from that to which the receiver is connected.

- Consult the dealer or an experienced radio/TV technician for help.

This device complies with part 15 of the FCC Rules. Operation is subject to the following

two conditions: (1) This device may not cause harmful interference, and

(2) this device must accept any interference received, including interference that may cause undesired operation.