

THE NAME OF THE MAIN ACCESSORY OF THE PRODUCT

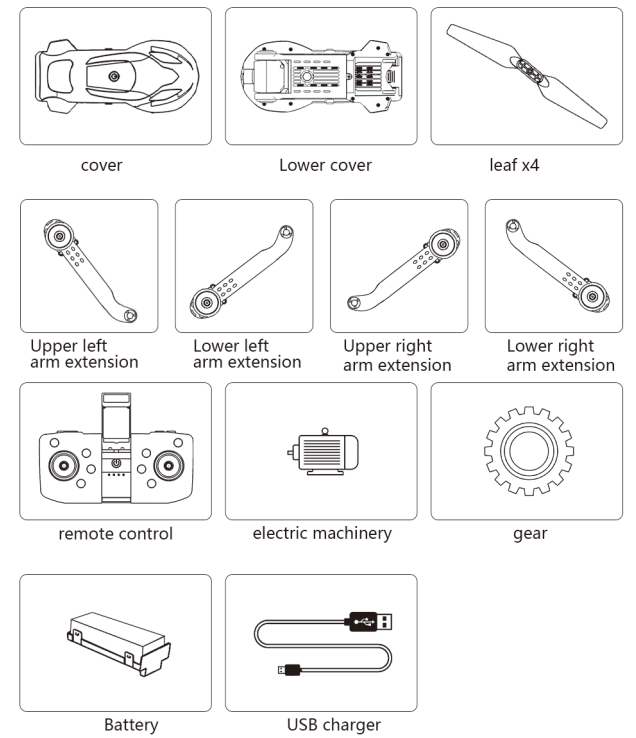

7

REMOTE CONTROL FUNCTION NAME

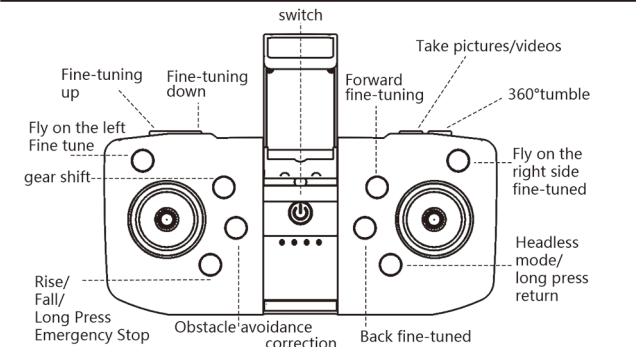

REMOTE CONTROL

NOTE: BEFORE THE AIRCRAFT TAKES OFF, CALIBRATE. TAKE-OFF SHOULD BE PLACED ON A LEVEL OPERATE ON THE GROUND, OTHERWISE IT WILL AFFECT THE NORMAL OPERATION OF THE AIRCRAFT!

1. 2.4G FREQUENCY

Turn on the aircraft power switch and place the aircraft flat Ground, at this time the aircraft indicator flashes, turn on the remote control electricity Source switch, buzzer prompt "drip" sound! Aircraft indicatorLong light, the frequency is completed, and it is time to take off!

2. ONE KEY TO TAKE OFF AND ONE KEY TO LAND

Tip: This product is set high by barometer due to Various environmental temperatures and other different factors affect, The aircraft will automatically exit when starting flight or at low voltage Now the change in height is normal.

3

FOLDABLE AIRCRAFT
USER'S MANUAL

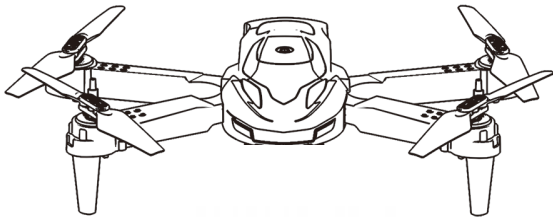

FCC Statement

Any Changes or modifications not expressly approved by the party responsible for compliance could void the user's authority to operate the equipment.

This device complies with part 15 of the FCC Rules. Operation is subject to the following two conditions:

- (1) This device may not cause harmful interference, and
- (2) This device must accept any interference received, including interference that may cause undesired operation.

2.4GHZ
EDITION

Read the instructions completely before use (read them carefully for details and instructions) and save them for future reference.

FOR AGES
14+

DIRECTION DEFINITION AND MODE SELECTION FOR HEADLESS MODE

When you press the button (pictured) to switch to headless mode, the lights on the aircraft begin to flash, The aircraft will abandon its front, back, left and right orientation, and re-set it with the remote control as the reference point Bits front and back left and right. For example: when the right joystick is pushed forward, the aircraft will fly away from the remote controller: When the right joystick is pulled back, the aircraft will fly towards the remote controller.

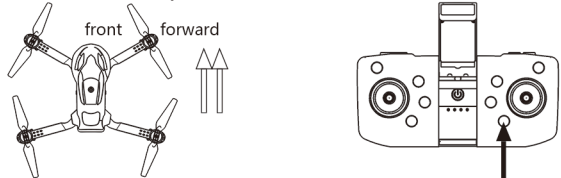

1. Definition of the direction before take-off: The forward direction of the aircraft is directly in front of you(Front on camera side) The remote control presses another key to the straight flying tail Take-off, that is, the completion of the flight headless mode direction definition,
2. Press the headless mode key when flying, the remote control emits two sounds of "flute, flute", and the aircraft lights flash quickly and enters headless mode.

FAST/MEDIUM/SLOW SELECT

Fast, medium, and slow gears divide forward, backward, and left and right side flight into three speeds. After the remote control is turned on, it is considered slow, and press the remote control key to issue "Flute" and "flute" two sounds are mid-range, flute "flute" "flute"Press three times for the fast gear, and the "flute" will return to the slow gear. (It is recommended that beginners use slow gear operation)

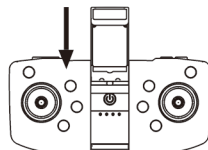

OBSTACLE AVOIDANCE SWITCH

After turning on the aircraft, press the obstacle avoidance mode button to open the obstacle avoidance The pattern airplane eyelights will start to slow flash, which is to work in obstacle avoidance mode State. At the same time, pressing the obstacle avoidance button is closed (At this time, the aircraft eye light will not start to blink)

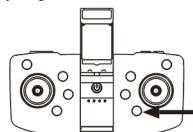

5

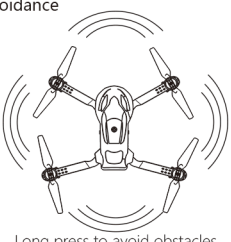

Long press to avoid obstacles

IMPORTANT SAFETY INFORMATION

- (1) The product is not a toy, but integrates mechanical, electronic, aerodynamic, high-frequency emission and other professional knowledge into one The precision equipment that needs to be properly assembled and commissioned to avoid accidents, the product holder must use a safe manner To operate control Improper operation may cause serious personal injury or property damage. We are not responsible for this. Because we can't control the process of assembly, use, and operation.
- (2) This product is suitable for people with experience in operating models and who are not less than 14 years old.
- (3) The flight site must be a local legal remote control model flight site.
- (4) Once the product is sold, we will not be responsible for any safety responsibility arising from operation, use, control, etc.,
- (5) In case of problems such as use, operation, maintenance, etc., we entrust dealers to provide technical support and after-sales service.Please contact your local dealer.

2. Safety precautions:

Remote-controlled model aircraft are high-risk commodities, and it is important to fly away from crowds, Improper human assembly or damage to the body,Poor electronic control equipment and unfamiliar operation may lead to damage to the aircraft or personal injury Surprise on the pre-side. Pilots are advised to pay attention to safety and understand the responsibility for accidents caused by their own sulfur accidents.

- (1) Stay away from obstacles and crowds
- (2) Keep away from humid environments
- (3) Safe operation

RC aircraft have uncertain flight speed and status when flying, and there are potential dangers. Must be kept away when flying Crowds, high-rise buildings, high-voltage power lines, etc., while avoiding flying in bad weather such as wind and rain, thunderstorms, etc., to ensure that pilots, The safety of the crowds and property in the garden.

- (2) Keep away from humid environments
- (3) Safe operation

Please operate the remote control aircraft according to your own status and flight skills. Fatigue, poor mental health, or improper handling will increase The probability of unexpected risk.

- (4) Keep away from high-speed rotating parts

When the propellant is flying at high speed, please keep the pilot, the surrounding crowd and objects away from the rotating parts to avoid danger

Damage.

The product fruit is lithium polystyrene battery(LIPO)
Lithium batteries differ from ordinary batteries in that they consist of a thin layer of tin foil wrapped around its chemicals. This can be very large The degree of weight reduction, but makes it more vulnerable in the face of rough and inappropriate operation. As it is Like batteries, unpleasant operation can cause a fire and explode.



- Do not put the battery in the pole type for charging, this may cause the battery to catch fire and damage you of the aircraft,
- If you plan to leave this product alone for a week or longer, leave the battery at 50% charge Increase the life of the battery, the stop battery retains 50% of the charge, just when the battery is fully charged Between a sheep to recharge.
- Please use the original professional charger to charge the battery
- Never charge on the carpet to prevent fire
- Lithium batteries need to be charged after storage for more than three months to maintain the voltage and ensure that they should be availablelifetime.

1

REMOTE CONTROL AND AIRCRAFT BATTERY INSTALLATION AND CHARGING INSTRUCTIONS

REMOTE CONTROL BATTERY INSTALLATION:

Follow the electrode instructions of the battery box as shown in the figure (10/1)
Properly place the battery (as shown),

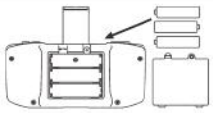

AIRCRAFT BATTERY CHARGING

1. Connect the computer with the USB cable to charge: The USB charging end is connected to the aircraft battery plug, and the other end can be connected to the computer The USB port charges the battery, the light is on when charging, and the light is off when it is charged.



- 2Connect the aircraft power supply: Put the recharged battery into the battery holder of the aircraft, After connecting, turn on the aircraft power switch, and the aircraft lights up at this time.



AIRCRAFT INSTALLATION

1. FOLDING FUNCTION DISPLAY

When folding, fold the back first The exhibition replot, and then fold the front of the unfolding bone Unfold the opposite!



2. AIRCRAFT BLADE INSTALLATION

Please follow the picture in the right direction of the "Bursting Award, Luo Jing. The upper logo is installed into several lines of the upper left corner and the lower right corner Genus on the bone, the same as the successor to the mark B An Go to the upper right corner and lower left corner of the aircraft and install it When aligning the blade with the square fittings of the brace assemblyTighten the screws after installing them in place!

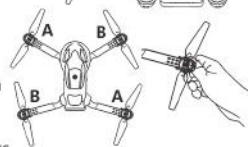

3. AIRCRAFT PROTECTIVE FRAME INSTALLATION

Align the protective frame with the aircraft osteosus position (e.g. circumference) Ann buckled the most

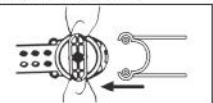

2

THE AIRCRAFT IS SET UP FOR RESET

Novices in the operation of this remote control aircraft, If the flight is unstable after takeoff, it appears to one When drifting rapidly in each direction, a gyroscope can be used The level correction function of the instrument corrects the aircraft. The method is as shown in the figure, after booting the frequency, will be completed The aircraft is placed on a flat ground controller Two senses of maneuvering outside the eight, the aircraft lights flashed After the long light, indicating that the horizontal correction is complete.

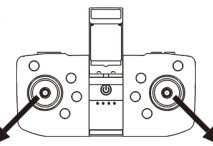

PROBLEM SOLVING GUIDELINES

PROBLEM	CAUSE	PROCESSING METHODS
The aircraft battery is connected, and the indicator light on the aircraft continues to flash, and the operation is unresponsive	The remote control and the plane were not successfully paired	Please perform the frequency-to-frequency action between the remote control and the aircraft
After connecting the aircraft battery, the aircraft did not react	1. Whether the remote control and the aircraft are connected to electricity 2. Check whether the remote control and the aircraft battery are in a low power state 3. Whether the positive and negative plates of the battery are in poor contact	1 Turn on the remote control and plug in the aircraft battery to turn on 2. Use a fully charged full battery 3 Reinset the battery and confirm that the contact between the battery and the positive and negative plates of the battery is normal.
The main motor does not turn when the throttle remote lever is pushed, and the indicator light on the aircraft begins to blink	The aircraft lithium poly battery is low	Charge the battery to replace another full battery
The main rotor of the aircraft continues to rotate but cannot take off	1. Main rotor deformation 2. The aircraft battery is low	1. Replace the main rotor 2 Charge the battery or replace another full battery
The plane shook very badly	Main rotor deformation	Replace the main rotor
The plane will still move forward or backward	The gyroscope midpoint is not correct	The remote control can be in auto-correction mode or rebooted
After the plane fell, it lost its level and could not fly	The gyroscope midpoint is not correct	The remote control can be in auto-correction mode or rebooted

6