

MIDAS

The Next Chapter in Restorative 3D Printing Quick Start Guide

Rev3 - 012224

Congratulations!

You've just unboxed the future of restorative dentistry. Midas operates a little differently than other printers, so read this guide in its entirety before printing.

We're so excited to see how you use Midas to push the boundaries of dentistry!

Training

SprintRay University provides personalized virtual and in-person courses designed to maximize your printing experience. Discover more at sprintrayuniversity.com

Support

If you have questions about your new products, please reach out to SprintRay:



Visit
Chat
Email

support.sprintray.com
sprintray.com/chat
support@sprintray.com



Sign Up account.sprintray.com

Sign Up with SprintRay

Your SprintRay account is used for sending print jobs, ordering designs, and purchasing consumables.



You'll need a SprintRay account to send print files to Midas.

Order Midas Cartridges

Visit the SprintRay store to order from a wide array of resin cartridges to suit your needs.

Visit store.sprintray.com

Simplify with Cloud Design

Submit scan files and patient information and receive 3D designs that are ready to print.

Available treatments include AI Crown, Inlay/onlay/filling, Prep & no-prep veneers.

Unbox

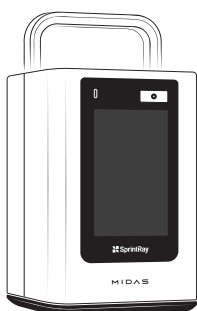

Midas 3D Printer



Cleaning Cloth

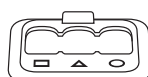

Cartridge Template



Support Snipper



Gloves



Documentation



Power Cable

4 Place on the Template

Set the cartridge on the print glass in the template slot indicated by the touchscreen.

i If you are using multiple cartridges, repeat this process, starting with the scan, until all cartridges have been placed.

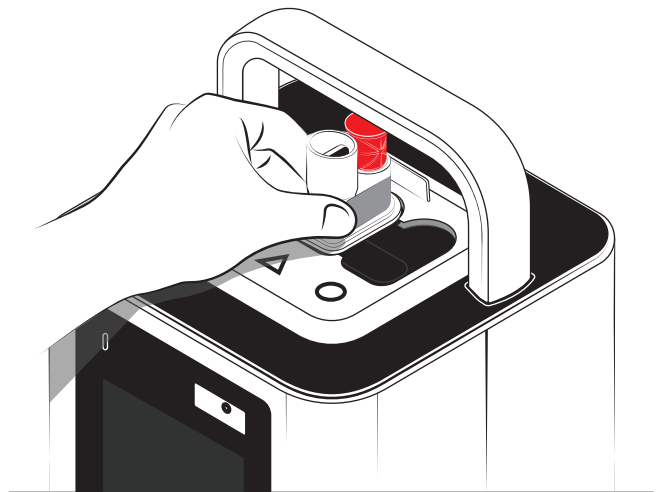

5 Print

When you start the job, the print arm will slowly lower and the build platform will rise out of the opposite side of the cartridge.

! Do not touch the print arm or cartridges during printing operations. The touchscreen will inform you when the print job is finished.

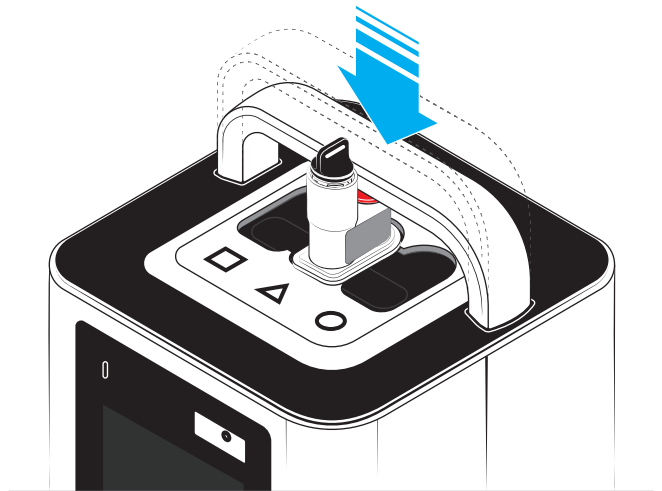

6 Remove the Cartridges

When the print job is finished, carefully remove the cartridges from the print template.

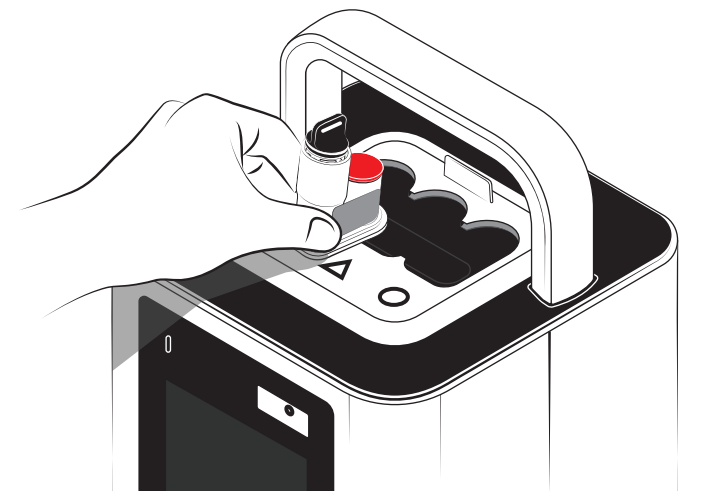
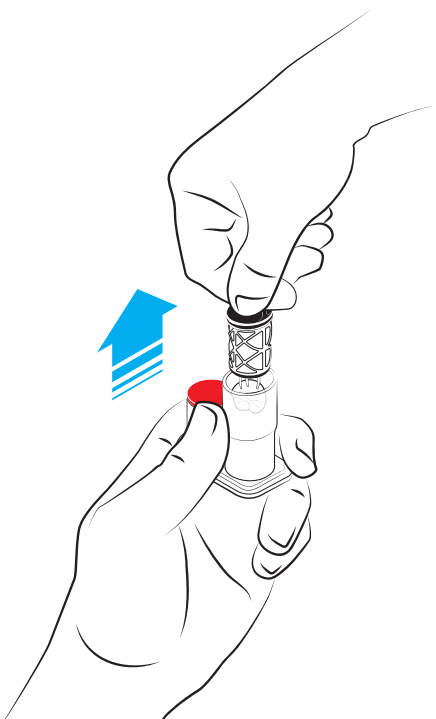

7 Extract the Build Platform

Hold the build platform by the handle and gently pull it up until it releases from the cartridge. Remove your part, then discard the cartridge.

8 Post Process

Consult the IFU and workflow guide for the resin you're using for the next steps. For best results, post process with SprintRay products.

All-In-One Midas Cartridge

Midas is a little different from other 3D printers. There's no resin to pour, tanks to manage, and no reusable build platform. Everything you need to fabricate strong, aesthetic restorations is contained in the cartridge.

Build Platform

When Midas has finished printing, the build platform side of the cartridge will rise.

Resin Press

The end of the cartridge goes under the print arm. During the printing process, it will be slowly pressed down.

 Do not touch or compress the resin press.

Safety Film

The optical window on the bottom of the cartridge is covered by a thin layer of safety film. Do not remove the safety film until after you have scanned the cartridge.

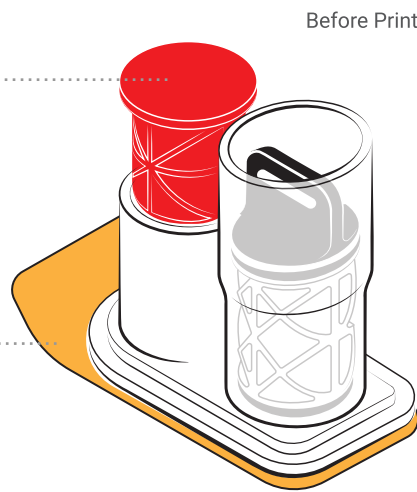

Before Print



After Print

The Printing Workflow

The printing workflow for Midas requires no liquid resin and no resin tanks. Simply follow the steps below to reliably produce strong, aesthetic restorations.

 Workflow steps may vary depending on the resin. Always consult the IFU and workflow guide for your resin and appliance type.

1 Prepare Print Job

Set up a print job using RayWare or build a print job on Midas using Autoprint.

 Visit rayware.sprintray.com to set up your first print job.

2 Scan the QR Code

Before each print job, Midas will instruct you to scan the QR code on the cartridge. This helps ensure the correct resin is always used.

3 Remove the Safety Film

Hold the cartridge by the sides and peel off the safety film. Do not touch the optical window beneath.

 Always remove the safety film before printing. Do not touch the print glass.

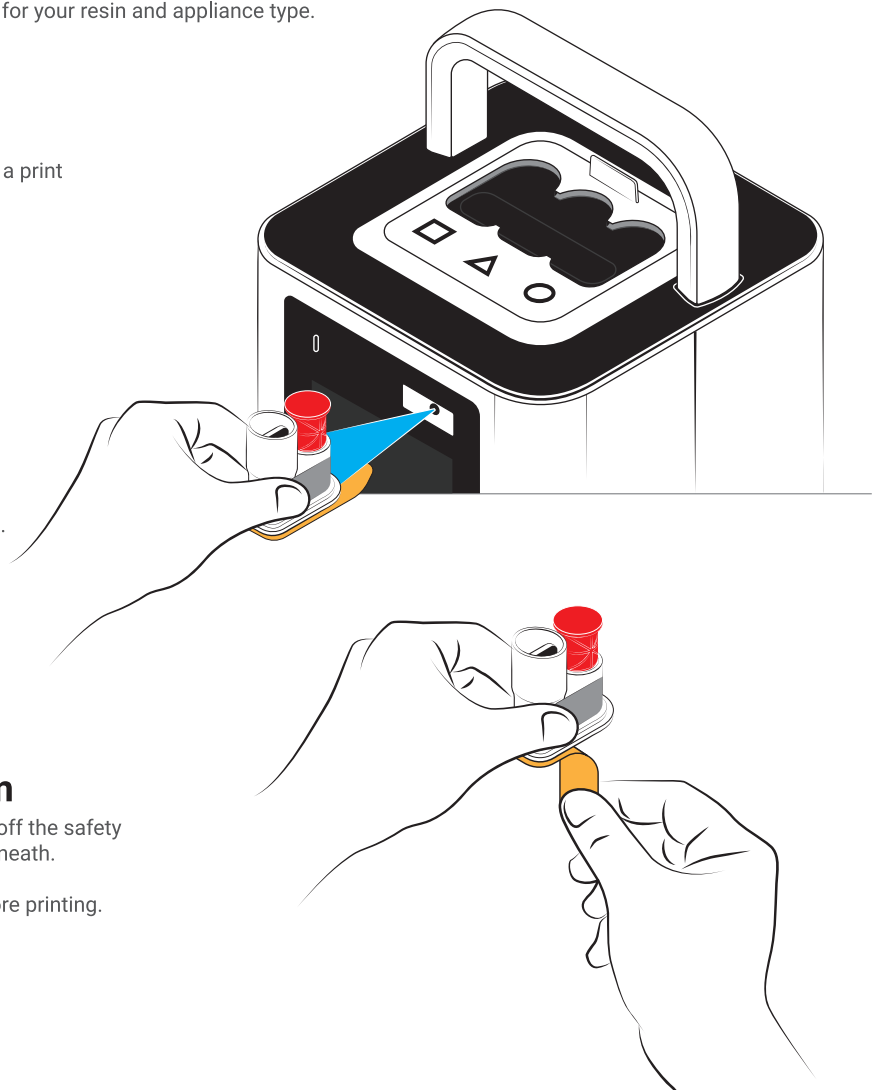

Create a Workspace

The physical space your printer occupies plays a vital role in its success. Dust, heat, and direct sunlight can drastically impact your system's success or failure.

For best results, set Midas up near your other SprintRay devices for optimal workflow efficiency. Turn the leveling feet on the bottom of the device to fine-tune the position of the printer and ensure that it sits level.

Recommended Operating Temperature

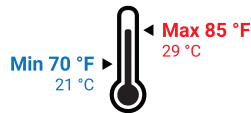

DUST WARNING!

Do not place your printer near a mill or other equipment that produces dust. The inner components of the printer are highly sensitive, and excessive dust accumulation can impact print quality and accuracy.



Do

- Level surface
- Clean workspace
- Away from other equipment
- Away from windows and sunlight
- Consistent temperature 70-85 F
- Well ventilated area



Level Surface
Optimal Environment



Don't

- Uneven surface
- Dusty, dirty workspace
- Near other lab equipment
- Near windows or in sunlight
- Large temperature swings
- Poor ventilation

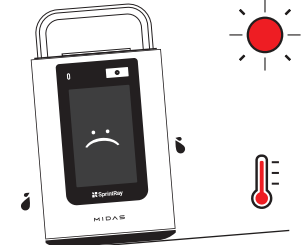

Uneven Surface
Warm Environment

Connecting Your SprintRay

Midas is designed to be used with an active internet connection. Ordering designs, sending print jobs, and automatic handoff between devices require a SprintRay account with an active internet connection.

Advanced security protocols may prevent Midas from connecting to the internet. Contact your network administrator for assistance.



SprintRay Account



Wireless Connection

Great for most offices

A wireless connection is recommended for most offices that use normal networking and security protocols. Once you start up your Midas, you'll be prompted to connect to a wireless network by selecting your network name and entering the password.



A wireless router is required to establish a wireless connection.

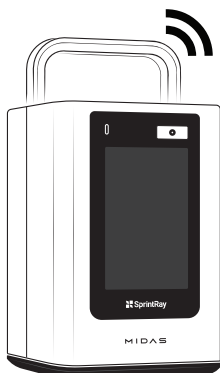

Internet

OR



Wired Connection

Great for offices with high security

A wired connection is recommended if your wireless network uses advanced security protocols or if your Wi-Fi signal is poor. Once you power up Midas, select the LAN option to connect to the internet.



A network switch or router is required to establish a wired connection.

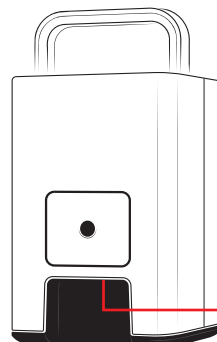

Internet



Network Security May Block Connection

Firewalls or antivirus software designed to secure your network may prevent your computer from finding the printer and connecting to SprintRay Cloud. If you need help getting connected, work with your network administrator and SprintRay support.

Hello, SprintRay

Before you start printing, you'll need to install the print template and power up Midas.

Plug In and Power Up

Use the provided power cable to plug Midas into an uninterrupted power supply or surge protector. To turn it on, press the power button.

When Midas is on, press the power button to power off or restart. You can press and hold the power button for 5 seconds to power it off.

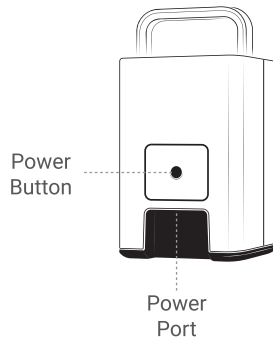

Print Glass

This panel of glass is where the printing happens. It must remain spotless at all times so that light can easily pass through. While printing, the glass heats up to aid printing. It may be hot to the touch.

Cleaning Print Glass

Dust and residue may accumulate on the print surface, so clean the Print Glass regularly using the procedure below.

1

To clean the print glass, lift the print template to remove it.

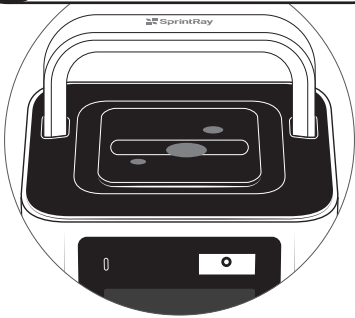

2

Use IPA and a soft cloth to remove any resin residue.

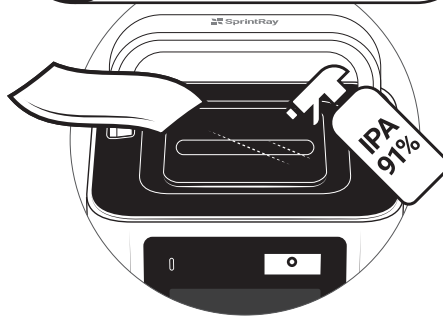

3

Use glass cleaner and a soft cloth to remove smudges, dust, and other imperfections.

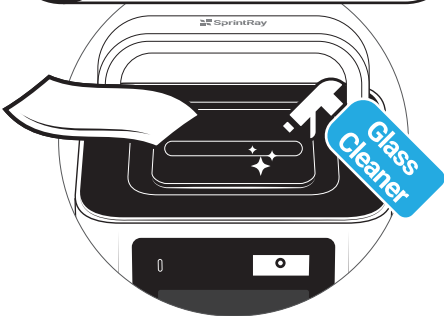

4

Place the print template back in place with the shapes facing the front of the machine.

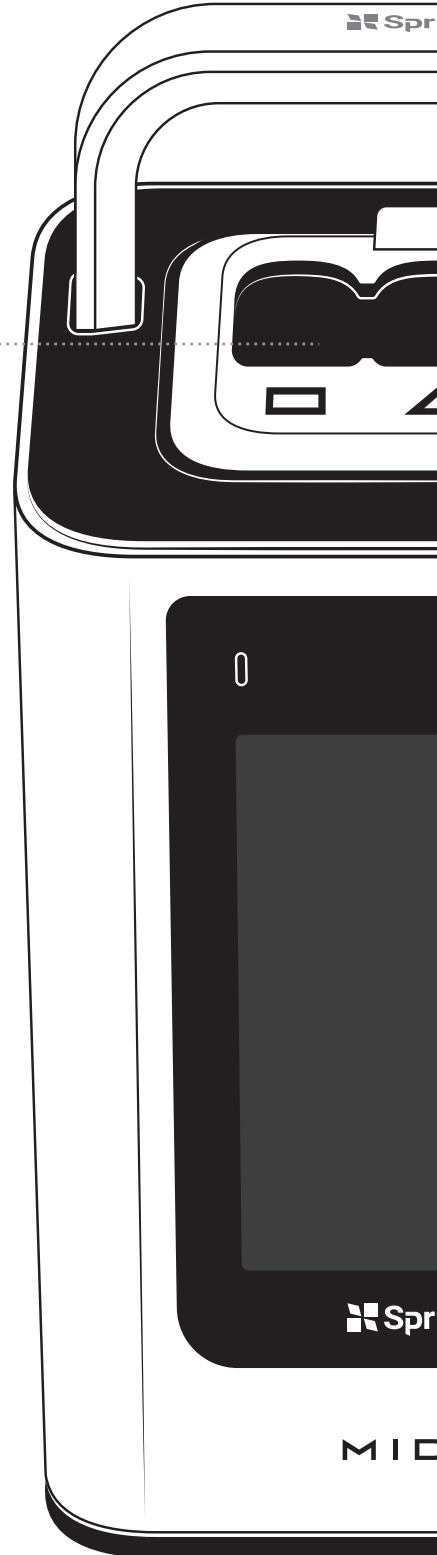

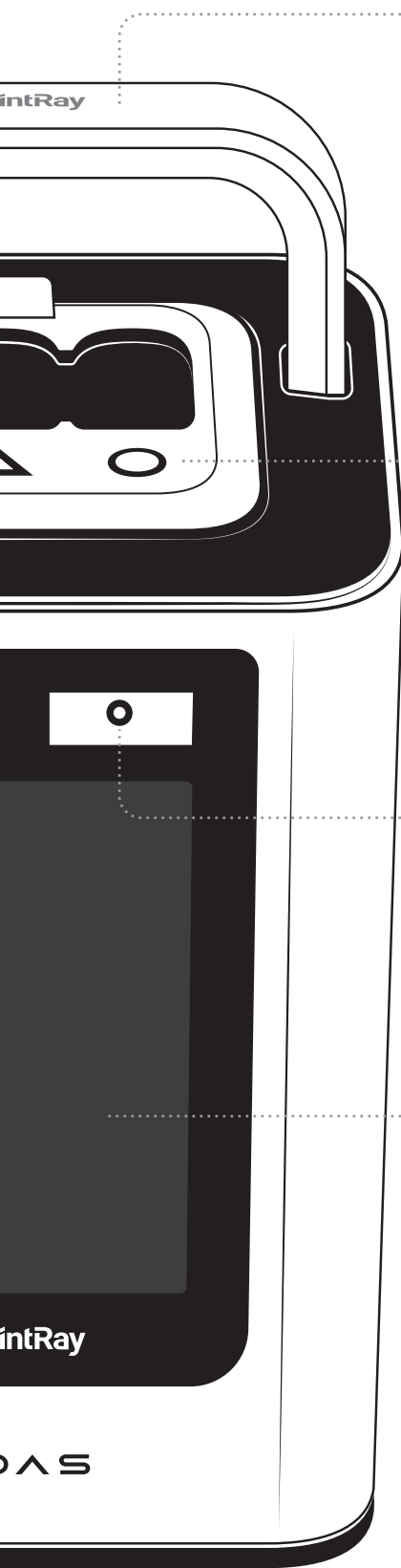

Print Arm

The only moving part on Midas is the print arm. It lowers during print and rises back up after print is finished.



WARNING!

Do not touch the print arm during the print process.

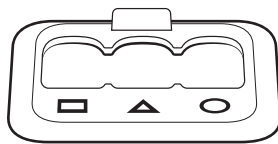

Cartridge Template REMOVABLE

This template helps ensure your cartridges are perfectly aligned for every print job. To install, place the template on the print glass as indicated.

When installed correctly, the template should sit level and not move from side to side. It can be removed at any time to clean the print glass.



WARNING!

Do not start a print without the print template in place

Barcode Scanner

Midas uses barcode scanning to verify which resin cartridges you use, track expiration dates, and log other important information. You must scan each cartridge before use.

Command Center

A large touchscreen and powerful onboard computer allow you to build print jobs right from Midas. You can prepare files with AutoPrint or RayWare Cloud.



Visit print.sprintray.com to prepare and send files to Midas



Sign In with SprintRay

A SprintRay account is required to use Midas. Make sure to connect it to the internet and sign in with your SprintRay account.

Offline Printing

Use the USB-C port if you're having connectivity issues. Set up your job on RayWare Cloud, then download it to the USB drive. Plug into Midas and start printing.