

## user's Guide

BA 64V



BURTONAUDIO.COM

## Precautions

- Before using this machine for the first time, please read the user manual carefully and follow all operating instructions and precautions.
- Because the high voltage inside the machine is dangerous, do not repair it by yourself. All repairs and adjustments must be performed by professionals.
- The power source used in this machine must match the type indicated on the nameplate.
- The power supply on the socket must not be overloaded, the power cord should be placed where it cannot be stepped on, and items should not be placed on the power cord.
- Do not place this machine on a sofa, near unventilated places such as curtains, or in direct sunlight and humidity, and avoid dropping or subjecting this machine to shock.
- Unplug the machine from the power outlet before cleaning. Do not use thinner or other chemical cleaners, just wipe with a soft cloth.
- After the machine is turned off, if you do not use the machine for a long time or in a thunderstorm, please unplug the power plug from the power.
- To avoid the risk of fire, electric shock, or product damage, do not expose the machine to rain, moisture, or dripping liquids, and do not place water-containing objects such as vases on the machine.
- Do not expose batteries or battery-installed devices to excessive heat, such as sunlight and fire.

## Panel and interface functions

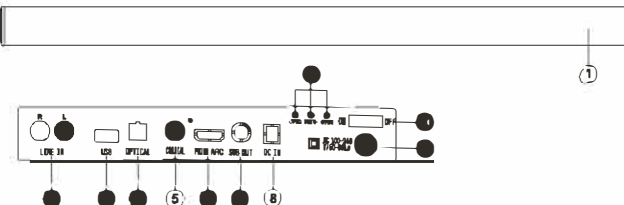

- Audio display screen
- Audio auxiliary input
- Audio USB interface
- Audio Optical input
- Audio coaxial input
- Audio HDMI(ARC) input
- Subwoofer Output
- DC powerjack  
(This interface is limited to passive subwoofers with an impedance of 8 ohms)
- Audio power switch
- Audio power cord

## sound bar and device connection diagram

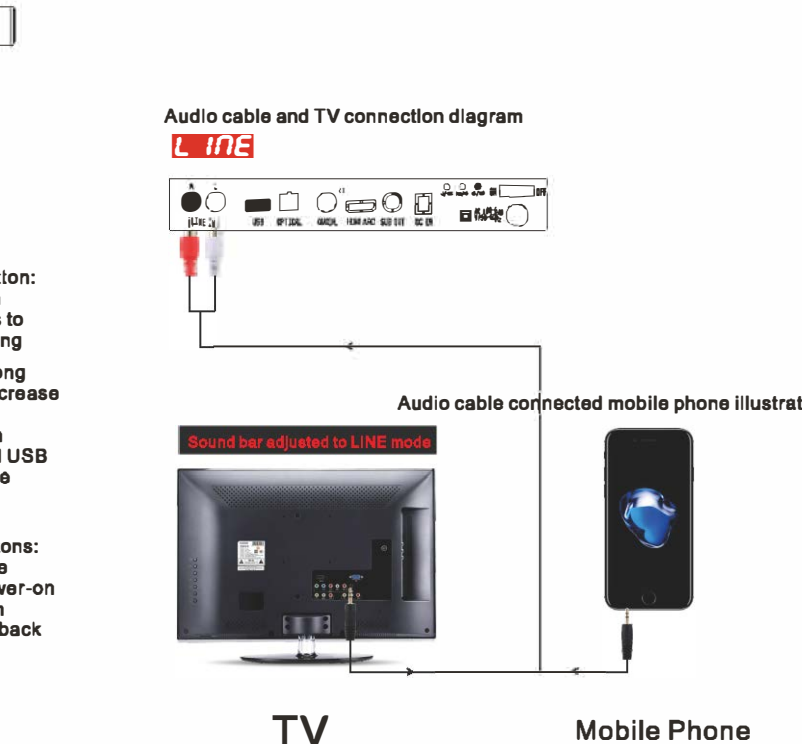

## Coaxial connection diagram with TV or network set-top box

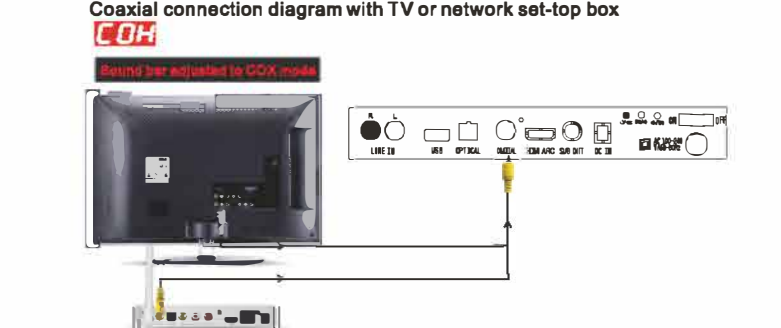

## Optical connection diagram with TV or network set-top box

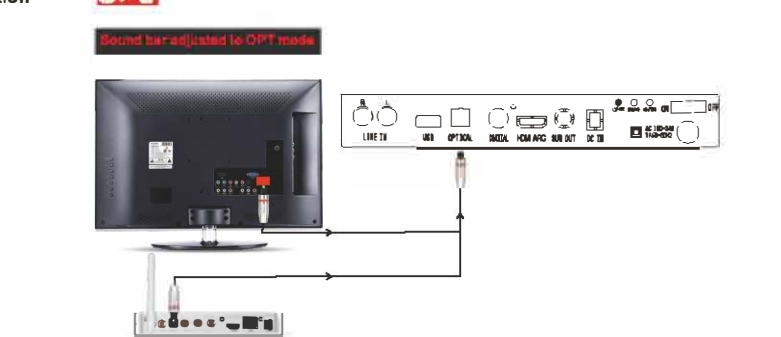

## Remote control function introduction

- Power button:** press to boot
- USB play mode button:** press to switch to USB playback.
- Bluetooth playback mode button:** press to switch to Bluetooth playback.
- Speaker volume up button:** press to increase speaker volume.
- Speaker volume down button:** Press to decrease speaker volume.
- Next button:** You can switch to the next song in USB playback mode and Bluetooth playback mode
- Play pause button:** press to switch play and pause.
- Previous button:** USB playback mode and Bluetooth playback mode can be switched to the previous song.
- EQ:** Press to switch between different sound modes
- 1. Music:** Press to switch the speaker's playback profile to music mode; this mode provides balanced audio playback.
- 2. Movie:** Press to switch the playback mode of the speaker to the movie mode; in this mode, the speaker will produce a simulated surround effect, enhancing the presence of the movie.
- 3. News:** This mode highlights the medium frequency and provides clear voice.
- Treb+:** Press to increase the treble input volume
- Treb-:** Press to decrease the treble input volume
- Bass+:** Press to increase the bass input volume
- Bass-:** Press to decrease the bass output volume
- Source selection button:** Press to switch between AUX, coaxial, fiber, input modes



## Functional operation

- POWER**  
After connecting the audio signal cable to the corresponding interface of the machine, plug in the power cable and turn the power switch to ON; the LED display will show the current working mode.
- Working mode conversion**  
After powering on, short press the "M" button on the rear panel of the machine or the remote control audio source button to switch to different working modes; the LED display shows the working mode corresponding to the characters: BT = Bluetooth OPT = Optical input COX = Coaxial input LINE = auxiliary input USB = USB playback ARC=HDMI(ARC) input
- Volume button operation function**  
The remote control's "Volume +" and "Volume-" long or short press can increase or decrease the volume, the LED display will show the corresponding volume level, the maximum level is 32.
- Bluetooth operation method**  
This product will automatically enter the pairing mode when using the Bluetooth input mode for the first time. At this time, the LED display will show BL and flicker. You can directly use your Bluetooth playback device to connect to this product. When the connection is successful, a voice prompt "Bluetooth has connection". This product will automatically switch to pairing mode when no device is connected in Bluetooth mode. If you intend to switch to another Bluetooth playback device while the Bluetooth playback device is connected, please disconnect the Bluetooth playback device that is currently connected, wait for the product to automatically switch to Bluetooth pairing mode, and then use the new Bluetooth playback device. Connect.

## Wall operation

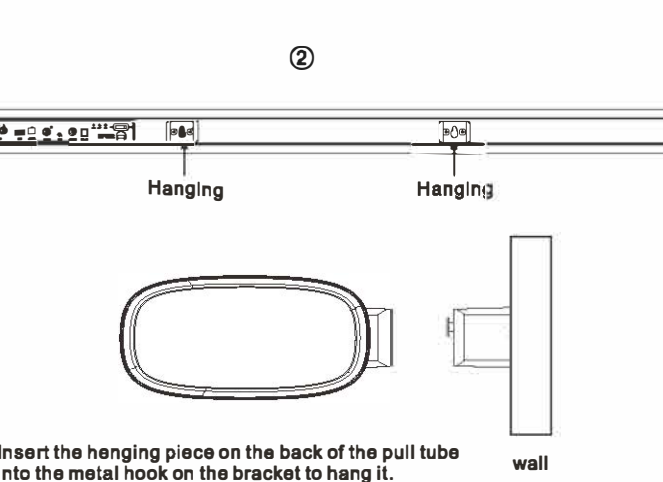
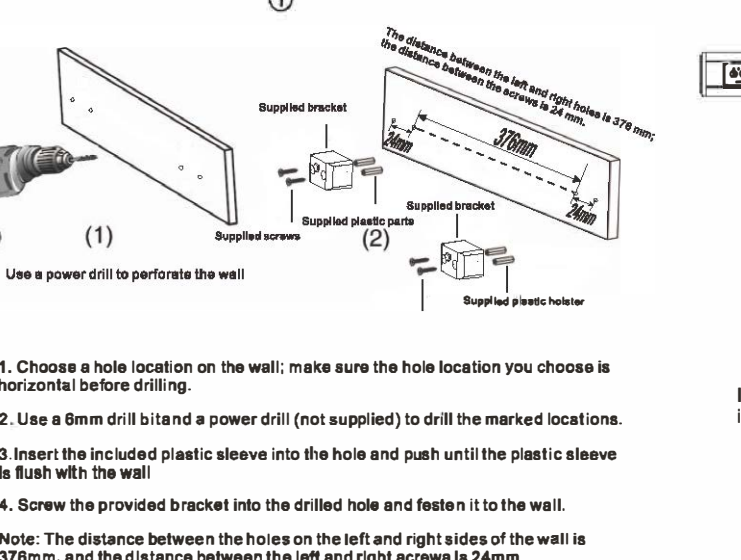

## Technical Parameter

Product Model	BA 64V
Product Name	Sound Bar
Power supply	AC 100-240V ~ 50/60Hz 0.5A
output power	40W+40W
Interface	USB * 1 optical input interface * 1 3.5mm recording interface * 1 Coaxial input interface * 1 RCA stereo input interface * 1 HDMI(ARC) input interface * 1
Sound mode	Film + Music + News
Weight	3KG
The machine size	1065*113.3*66.36mm
Accessories	Manual, remote control, warranty card

This product is only suitable for safe use in areas below 2000 meters above sea level.  
Disconnecting device description  
Since the power plug is used as the main power source to cut off the machine, connect the machine to an easily accessible AC outlet. If you notice any unusual conditions, immediately unplug the power plug from the AC power plug.



BURTONAUDIO.COM

# Page 11

FCC Statement  
This equipment has been tested and found to comply with the limits for a Class B digital device, pursuant to part 15 of the FCC Rules. These limits are designed to provide reasonable protection against harmful interference in a residential installation. This equipment generates, uses and can radiate radio frequency energy and, if not installed and used in accordance with the instructions, may cause harmful interference to radio communications. However, there is no guarantee that interference will not occur in a particular installation. If this equipment does cause harmful interference to radio or television reception, which can be determined by turning the equipment off and on, the user is encouraged to try to correct the interference by one or more of the following measures:

- Reorient or relocate the receiving antenna.
- Increase the separation between the equipment and receiver.
- Connect the equipment into an outlet on a circuit different from that to which the receiver is connected.
- Consult the dealer or an experienced radio/TV technician for help.

Caution: Any changes or modifications to this device not explicitly approved by manufacturer could void your authority to operate this equipment.  
This device complies with part 15 of the FCC Rules. Operation is subject to the following two conditions: (1) This device may not cause harmful interference, and (2) this device must accept any interference received, including interference that may cause undesired operation.

RF Exposure Information  
This equipment complies with FCC radiation exposure limits set forth for an uncontrolled environment. This equipment should be installed and operated with minimum distance 20cm between the radiator and your body.