

User Manual of Birdkiss Smart Bird Feeder

FCC Statement

This equipment has been tested and found to comply with the limits for a Class B digital device, pursuant to part 15 of the FCC rules. These limits are designed to provide reasonable protection against harmful interference in a residential installation. This equipment generates, uses and can radiate radio frequency energy and, if not installed and used in accordance with the instructions, may cause harmful interference to radio communications. However, there is no guarantee that interference will not occur in a particular installation. If this equipment does cause harmful interference to radio or television reception, which can be determined by turning the equipment off and on, the user is encouraged to try to correct the interference by one or more of the following measures:

- Reorient or relocate the receiving antenna.
- Increase the separation between the equipment and receiver.
- Connect the equipment into an outlet on a circuit different from that to which the receiver is connected.
- Consult the dealer or an experienced radio/TV technician for help.

To assure continued compliance, any changes or modifications not expressly approved by the party.

Responsible for compliance could void the user's authority to operate this equipment. (Example- use only shielded interface cables when connecting to computer or peripheral devices).

This equipment complies with Part 15 of the FCC Rules. Operation is subject to the following two conditions:

- (1) This device may not cause harmful interference, and
- (2) This device must accept any interference received, including interference that may cause undesired operation.

FCC Radiation Exposure Statement:

The equipment complies with FCC Radiation exposure limits set forth for uncontrolled environment. This equipment should be installed and operated with minimum distance 20cm between the radiator and your body.

.

Contents

- 1. Packing List-----4
- 2. Pruduct Diagram-----5
- 3. Camera Specifications-----6
- 4. How to Assemble Smart Bird Feeder -----7
- 5. How to Set up the Camera -----8
- 6. Installation-----18
- 7. How to Add Bird Seed----- 21
- 8. How to Do Bird Identification-----22
- 9. FAQ-----22

1. Packing List



Birdspy Feeder Cover*1



Birdspy Feeder*1
(Camera included)

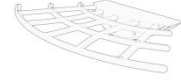

Bird Stand*1

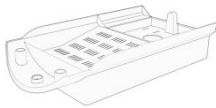

Base*1



Mounting bracket*1

2. Pruduct Diagram

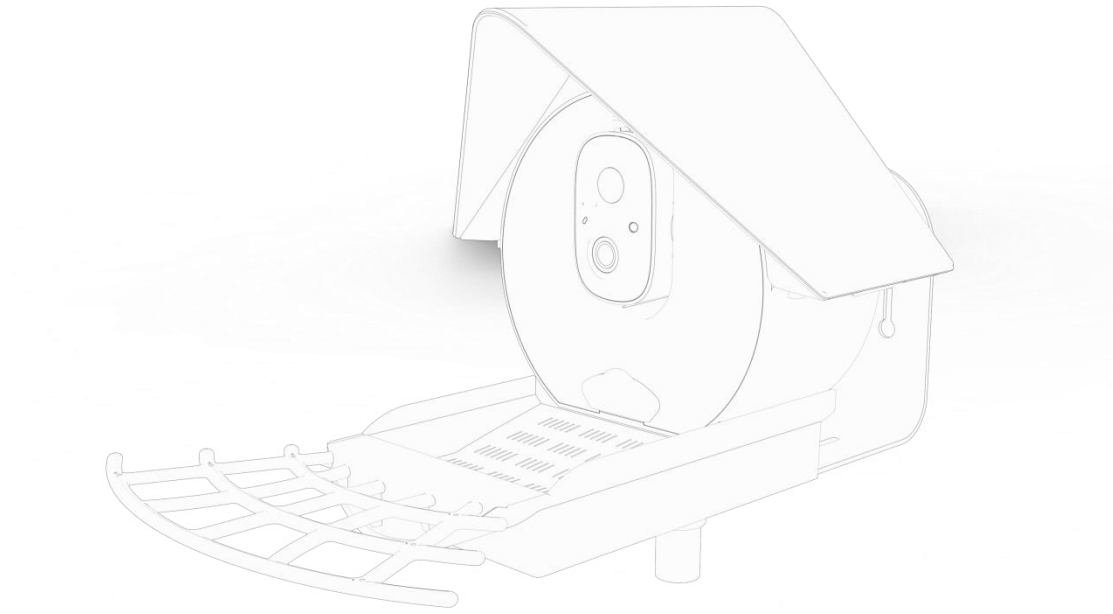

Bird Feeder Container

PIR Infrared

Microphone

Satatus Light

Bird Stand

Lens

LED Infrared

Spot Light

3.Camera Specifications

Item	Specification
Camera Lens	M12,f:3.3mm, F2.0, 200W
Viewing angle	Vertical: 85° Diagonal: 168° Horizontal: 135°
Minimum illumination	0.01Lux
Video compression method	H.264/ H.265
lighting frequency	50Hz, 60Hz
Image frame rate	15fps
Image Resolution	Max. 1920 X 1080
Infrared night vision distance	22.97ft
Video bit rate	Adaptive
Wi-Fi	2.4G WiFi
Supporting agreement	TCP/IP、UDP/IP、DHCP、RTMP、MUTP
Storage media	Micro SD card(Up to 128GB)
Battery capacity	5000mAh
Standby time	1 Year
Charging voltage	DV 5V+-5% 1.5A
Charging time	10 hours
Waterproof level	IP65
Shutdown power consumption	0.32mW (4V 80uA)
Standby power consumption	1.68mW (4V 0.42mA)
Working power consumption during the day	0.88W (4V 220mA)
working temperature	-10° ~-45° C/ 0%-80%
storage environment	-20° ~-60° C/ 0%-90%
Size	67*58*89(mm)
Certificate	CE, FCC, RoHs, WEEE, MSDS, UN38.3, UL62368, BattG

4.How to Assemble Bird Feeder

4.1 Insert Micro SD Card into Camera

Birdkiss Camera comes with a built-in card slot which supports up to 128GB Micro SD card. Insert the card into the camera before you assemble the whole unit.

Step 1: Gently rotate the camera down to the bottom.

Step 2: Open the top silicone plug. Insert the Micro SD card. Make sure to plug it in the right direction.

Step 3: Finally, Cover silicone plug.

4.2 Assemble Birdspy Feeder Cover

Step 1. Align the two protrusions on the left side of the lid with the buckled slits of the bird seed container.

Step 2. Align the lid with the roof of bird seed container and gently put it down, then fasten the buckle on the right side of the lid to the bird seed container. You hear a clicking sound which indicates that the lid is securely mounted.

4.3 Assemble the base

Step 1. Align the bottom of the bird seed container with the groove on the base and insert it.

Step 2. Use one of the screws in the kit to screw onto the hole in the middle of the back of the bird seed container.

4.4 Assemble the Bird Stand

Step 1.Install the bird stand in front of the base.

Step 2.Use the provided bird stand screw to fix the bird stand.

5.How to Set up the Camera

5.1 Download and Install the VicoHome App

5.1.1. Scan the QR code below or search”VicoHome” on APP Store or Google Play Store to download and install the app.

5.1.2. Open the link to download and install the App:

<https://www.vicohome.io/download/>

5.2 Sign up

4.2.1 Click into the app and input your Email address, check and select to agree the agreement, and tap Register. (For better user’s experience, please allow to open all permissions to avoid missing any notification from the app.)

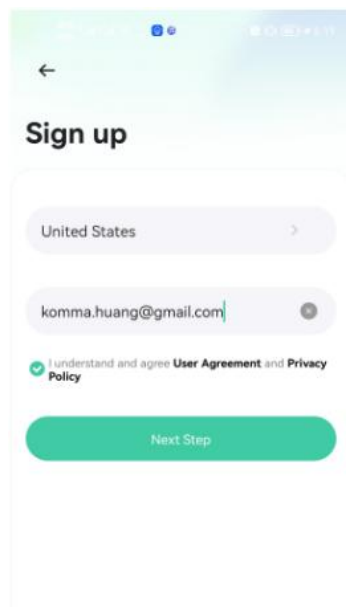

5.2.2 You will get an Email with a verification code for account confirmation. Enter it to go to the next step.

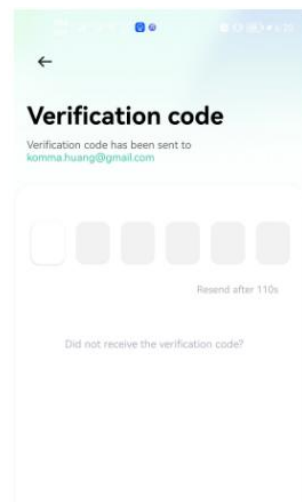

5.2.3 Set the login password and confirm the login password. Then tap “Next Step”. (For your account’s safety, the password needs to be a combination of at least 8 characters and upper and lower case letters.)

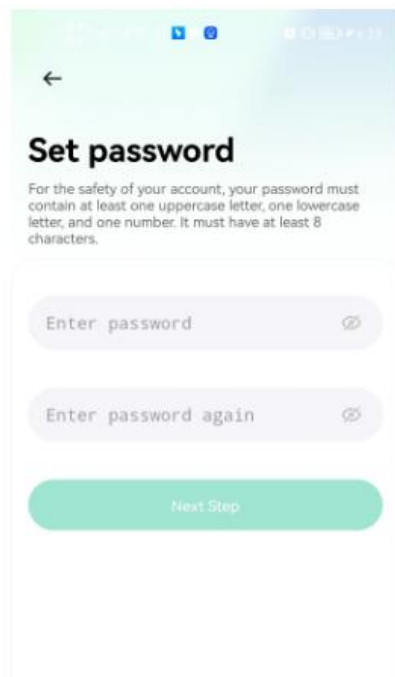

5.2.4 At last, set your username to complete the entire APP registration process.

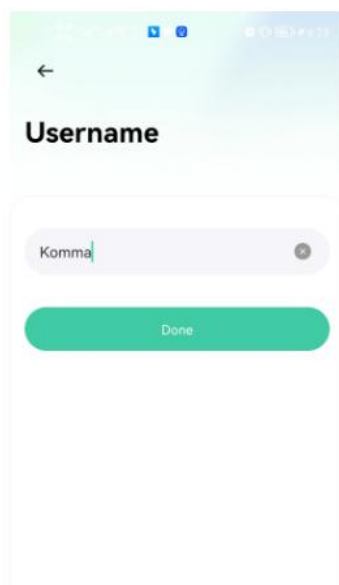

5.3 Add the Camera

5.3.1. Click “Add a new device now ”on the VicoHome APP.

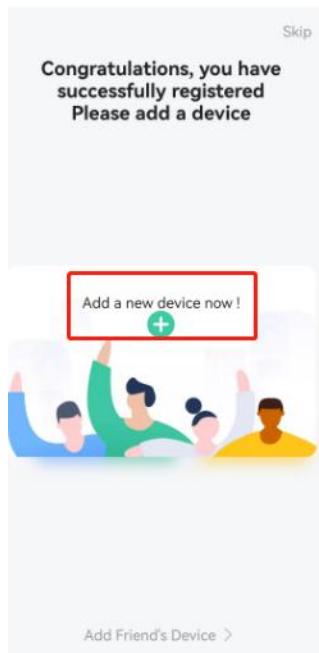

5.3.2. Follow the instructions on the APP to turn on the camera: Long press the power button of the camera for 3s to turn on the camera. Then the Status Light in the front of the camera will be solid blue. Double click the power button to enter WiFi mode after the prompt tone.

5.3.3. Make sure your camera is ringing the sound of ding dong ding dong, after hearing the sound, tick "I heard the sound or saw the light on" on APP. Then click "Next Step".



5.3.4. For quick connection, please follow the instructions to open the Bluetooth settings.

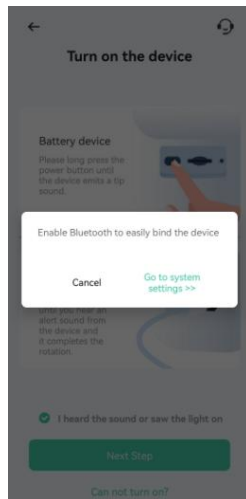

5.3.5. At this point, the phone enters the search camera state

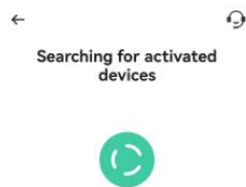

5.3.6. Make sure that your camera sounds Ding dong ding dong, after hearing Ding dong ding dong, tick "I heard the beeping sound". Then click "Next Step".



5.3.7. Select the camera you need to connect.

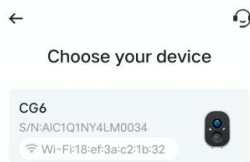

If your device is not listed
[Other connection methods>](#)

5.3.8. Enter the WiFi name and WiFi password you want to connect to, tick “remember the Wi-Fi name and password after successful connection” and click “Next Step”. (Note: The camera only supports 2.4GHz WiFi network with stronger wall penetration capability)

Configure Wi-Fi for the device

Please enter a 2.4 GHz Wi-Fi network name (SSID) and the password to connect to the device. Currently 5 GHz Wi-Fi and enterprise Wi-Fi networks are not supported. [Learn more >>](#)

2.4 GHz ☒ 5 GHz ☐

Wi-Fi Name (SSID)
Digitalstone-2.4G-V

Password

☒ Remember the Wi-Fi name and password after successful connection. 

Next Step

5.3.9. Confirm the WiFi name and password.

Configure Wi-Fi for the device

Please enter a 2.4 GHz Wi-Fi network name (SSID) and the password to connect to the device. Currently 5 GHz Wi-Fi and enterprise Wi-Fi networks are not supported. [Learn more >>](#)

2.4 GHz ☒ 5 GHz ☐

Help

Please reconfirm whether your Wi-Fi name (SSID) and password are correct (case sensitive).

Wi-Fi Name (SSID)
Digitalstone-2.4G-V

Password:
a12345679

Cancel Confirm

Next Step

5.3.10. Click" Connect"

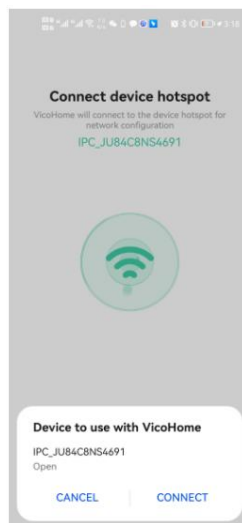

Note: If the camera cannot be searched by Bluetooth, a QR code will appear, point the QR code at the lens of the camera to connect.



Keep the phone at about 6-12 in (15-30 cm) from the device to scan the QR code, and complete the scanning process after the beep

5.3.11. When connecting, please wait patiently for 15 seconds and then you will hear a sound"WiFi Connected".

Connecting...



Connect the device to the network

- *** New device is found
- *** Register it to the cloud service
- *** In...

Connection successful.

5.3.12 Then set a name and location for the device.

Set a name and location for the device

device Name
Smart bird feeder

Location Edit
Living room Front door
Garden Office Back door
Garage +

Done

5.3.13. Finally, you will be informed of the current wifi network status.

Please place the device where you need to install it and check the strength of the Wi-Fi signal.

Confirm your Wi-Fi signal strength: **Strong**
It's recommended to mount the device in the current location.

Next Step

5.4 Possible problems with binding:

5.4.1 When you hear the "Wi-Fi Password Error", please check whether the Wi-Fi password you entered in the App is correct;

5.4.2 When you hear the "Authentication error", please ensure that your Wi-Fi network is not an enterprise-level network, and the device supports only the network with the security level below WPA-2;

5.4.3 When you hear the "Wi-Fi not found", please check whether you select or enter the correct Wi-Fi name, and place the device near the Wi-Fi router and ensure that the router is powered on. Please note that 5Ghz Wi-Fi cannot be searched by the device;

5.4.4 When you hear the "Retrieving IP timeout", it indicates that the number of devices connected to the router in your home is too many to connect more devices. Please remove some of the connected devices that are not commonly used or restart the router to clear the unconnected devices. You may need to contact the router administrator;

5.4.5 When you hear the "Cloud service connection fail", please check whether your router is connected properly to the external network.

5.4.6 When you hear this error prompt, it is common on the condition of network disconnection or that the selected router in your home is a local area network server. Please ensure that the network connection is normal, and try to temporarily turn off the firewall to connect again.

5.5 Share the camera

You can use this feature when you need to use the camera with other family members or friends. Only the admin user who has bound the camera for the first time can share and set up the camera, while other members can only view the live video or video playback feature of the camera.

1) For admin user of the camera, find the camera you wish to share on the app homepage or camera settings screen, then click the share button and enter the Share page. Click "Device Sharing" to generate a shared QR code.

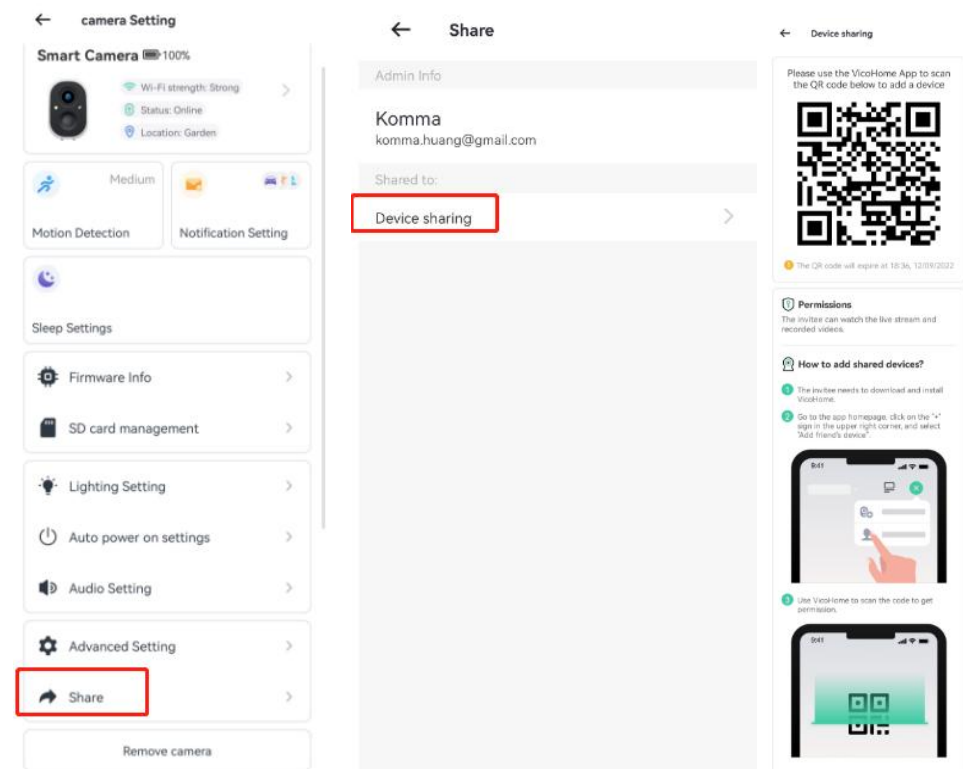

2) For users who need to be shared with, click "+" on the homepage and select "Add Friend's Device" to enter the scan code page.

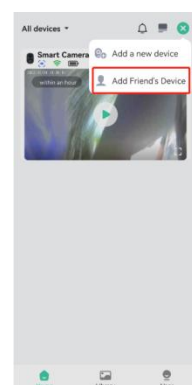

3) After the shared user successfully scans the QR code on the admin user's mobile phone, the admin user will receive a confirmation notification, then click “Accept” to complete the camera sharing.

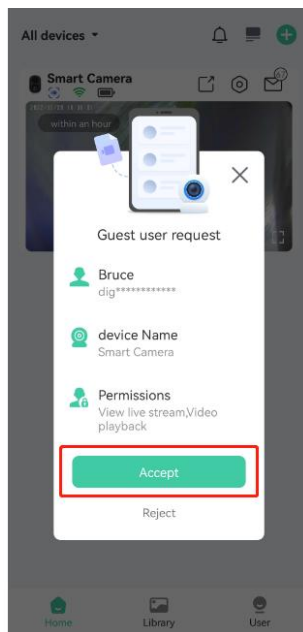

5.6. How to Charge the Camera

5.6.1. Check Battery Level

After connected, please check the battery level of the camera to make sure it is fully charged before installing it into the yard. App will also remind you to charge your camera when the battery is low.

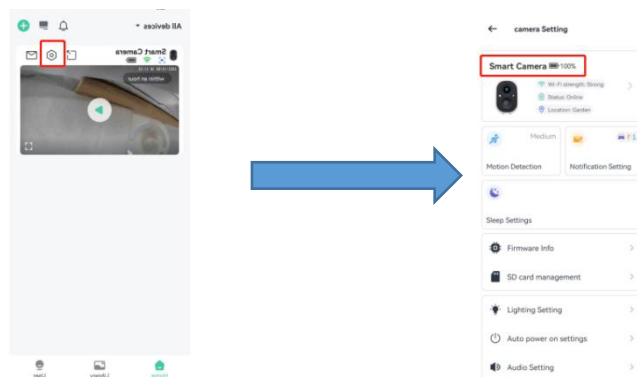

5.6.2. Charge the camera

If you need to charge after installation, please don't move the camera, just remove the bird seed container, the charging port is in the middle of the right side of the bird seed container. Please use the Micro USB cable to plug into the 5V/1.5A charging adapter to charge the camera. During charging, the camera's indicator light is solid yellow, and when the camera is fully charged, the indicator light will turn into solid green. It will take 10 hours to fully charge the camera.

Indicator Light Status

Mode	Status
Working mode	Blue
Sleep Mode	Off
Charging mode	Yellow
Fully charged mode	Green

6.Installation

2.1 Before Installation

- 7.1.1 Keep Birdspy Feeder and all accessories out of reach of children and pets.
- 7.1.2 Make sure the camera has been fully charged (DC5V / 1.5A).
- 7.1.3 Working temperature: -10°C to 50°C (14°F to 122°F) Working relative humidity: 0-95%
- 7.1.4 Please do not expose the camera lens to direct sunlight.
- 7.1.5 The camera has an IP65 waterproof rating, which supports working properly under rains or snows. But it can not be soaked in water.

Note:

- 7.1.1.1. Birdspy Feeder Cam only works with 2.4GHz Wi-Fi.
- 7.1.1.2. Strong lights may interfere with the device's ability to scan QR code.
- 7.1.1.3. Avoid placing the device behind furniture or near microwaves products. Try to keep it within range of your Wi-Fi signal.

6.During Installation

Check the following things before you drill holes on your wall:

Birdspy Feeder Cam has been successfully added to your VicoHome App and is able to stream video.

6.2.1 Find a good installation spot:

Please install the camera in a position where its view is not blocked and ensure that it is within the coverage of the Wi-Fi network. We recommend installing it at a height of 2.2-3.5 meters in an open area to make it easier for birds to find it. Birdspy Feeder provides four installation methods. Please choose the method that works the best for you.

6.2.2 Wall Installation:

Step 1:

1. First mark the location of the holes on the wall by using the included drill template stickers. Then use drill bit (5/16", 8mm) to drill two holes.

2. Install anchors to fix the screws.

3. Install the Birdspy Feeder Bracket on your wall with the screws provided.

Step 2:

Slide the Birdspy Feeder into the mounting bracket through the slide rail.

Step 3:

Screw in the bottom of the interface between the bird seed container and the mounting bracket.

6.2.3 Tree Installation:

Step 1: Wrap the Birdspy Feeder Bracket around the tree with a strap (not provided).

Step 2: Slide the Birdspy Feeder into the bracket.

Step 3: Screw in the bottom of the interface between the bird seed container and the mounting bracket..

6.2.4 Stand Installation:

Step 1:

The Birdspy Feeder can be placed steadily on a flat surface, but for stability, we recommend that the backplane is installed and fixed on a flat surface. Use the provided drilling template Sticker to mark the position of holes on flat surface. Use drill bit (5/16", 8mm) to drill two holes.

Step 2:

Install anchors to fix the screws.

Step 3:

Install the Birdspy Feeder mounting Bracket on flat surface with the screws provided.

Step 4: Slide the Birdspy Feeder into the bracket.

Step 5: Screw in the bottom of the interface between the bird seed container and the mounting bracket.

6.2.5 Tripod Installation:

Make sure you don't have the bracket installed on the bottom of the Birdspy Feeder. If you need to remove it, please take a look at "Special Step for Bracket & Tripod Connector Removal" for instructions on how to remove the bracket.

Step 1:

Slide the Birdspy Feeder into the Tripod Connector.

Step 2:

Install the bird feeder on the corresponding accessories, such as a photography stand (not provided).

If you want to remove the bracket from the Birdspy, please pull the pull tab in the center bottom of the bracket first and then slide the bracket off from the Birdspy through the slide rail.

Special Step for Bracket & Tripod Connector Removal

Pull Tab

Slide Rail

If you want to remove the Tripod Connector from the Birdspy, please pull the pull tab in the center bottom of the Tripod Connector and then slide the connector off from the Birdspy through the slide rail.

7.How to Add Bird Seed

Step 1: Open the catch on the left side of the bird seed container and gently lift the lid upwards.

Step 2: You can add bird seeds using the silicone measuring cup that came with our package.
Finally, close the Birdspy Feeder lid.

8.How to Do Bird Identification

8.1 Click "User" in the lower right corner of the APP, and then click "VicoHome Awareness Plus" to get

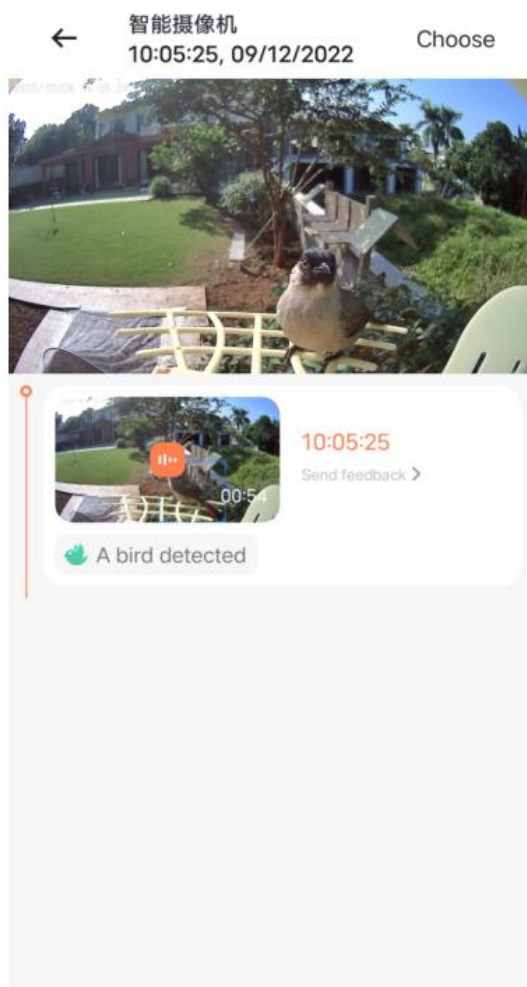

9.FAQ

1.Q:Camera permission management: How to invite family and friends to use my camera together?

A: Open the App and select your camera on the home page. Click the share button on the home page or the "Share" in the camera settings to enter the sharing page, and then click "Invite " to generate a QR code. Your friends can now get some of the access rights by scanning the QR code in your phone.

2. Q:Why doesn't the Wi-Fi name appear when I connect to Wi-Fi?

A: On Apple devices with iOS13 and above, you need to turn on the "location permission" for the app in the system settings and change it to "allow when using."

3. Q:Will the camera show red lights when night vision is activated?

A: The built-in infrared lamp beads make the camera only show some dim red lights when night vision is activated, but the image quality is still clear under no light environment.

4. Q:What are the requirements for Wi-Fi?

A: Please use a 2.4GHz wireless network. The device does not support the 5GHz wireless network. Meanwhile, please set the Wi-Fi authentication method to WPA2-PSK or other lower level of security method. A password is required.

5. Q:How far should the camera be placed from the router?

A: After testing, the Wi-Fi connection distance can normally reach up to 150 meters in the open area. However, the actual situation depends on the strength of Wi-Fi and its surrounding environment (thick walls, electromagnetic devices, large metal objects will all cause interference to the Wi-Fi signals). If the camera connection signal is weak or unstable, please place the camera as close to the router as possible.

6. Q:What is the maximum length of recording time?

A: If you set the duration as "Auto", when someone occurs in the view of the camera, it will start recording a video for up to 3 minutes.

7. Q:How to quickly view videos by category?

A: Click the icon in the upper left corner of the "Library" page to start filtering videos by category. Select the category you want to see and then click "Save" to view the video playbacks.

8. Q: What should I do when the device is in malfunction?

A: Long press the power bottom for 3 seconds to restart it. If there is no response, you can remove the rubber plug at the button of the camera. Press the reboot hole with a pointed object to restart the camera.