



Key Features

- Compact design: 56mm long
- Cable free WiFi antenna solution
- 2.4 to 2.5GHz operating frequency
- 2dBi peak gain
- Antenna Designation: SMA Plug Antenna

General Description

The Delta 14 is a direct connect stubby antenna tuned to 2.4GHz - the WiFi / WLAN / Bluetooth / ZigBee frequencies and is built with a straight connector.

Despite its small size of 56mm in length, it still performs at a high level that most stubby antennas cannot compete with. The Delta 14 offers a small and compact, cable-free antenna solution that is ideal for use with WiFi enabled terminals and modems. Not having to deal with cables makes the job much easier for installers as you simply screw the antenna into the antenna port of your device.

The Delta 14 is commonly used with WiFi, Bluetooth and ZigBee applications to help improve the signal strength and better the performance of your short-range terminal. This 2.4GHz antenna can be used with most modern day WiFi modems such as NetGear and TP-link's that operate on the traditional 2.4GHz frequency.

The Delta 14 is supplied, as standard, with a reverse polarity (RP) SMA male connector. This antenna can be built with a connector of your choice for volume requirements.

Please see the Delta 15 for the RIGHT ANGLE version of the Delta 14.

Additional Considerations

- Made out of durable TPS for long lasting antenna
- Supplied with RP SMA connector for direct connection to a device
- Omnidirectional radiation to ease installation
- RoHS compliant

Rev 1.1

Delta 14

Stubby WiFi / WLAN Antenna

Key Specifications - Electrical

Operating temperature:	-20 to +60°C
Storage temperature:	-30 to +75°C
Impedance:	50 ohm
Gain:	2.0dBi
VSWR:	2.0 max
Operating frequencies:	2400MHz
Polarization:	Vertical
Radiation:	Omni
Electrical wave:	$\frac{1}{4} \lambda$ dipole

Key Specifications - Mechanical

Dimensions:	56mm
Connector:	SMA RP
Mounting method:	Direct connect

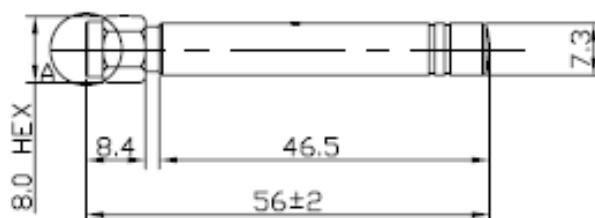

Key Specifications - Electrical

