

70.00 mm

560.00 mm

感应灯使用手册(联动款)

联动感应

- 1.每个感应灯的感应距离为3-5米，感应角度120度。
- 2.当人进入整组感应灯之中任何一个灯的感应范围时，整组灯同步亮起，离开感应范围，30秒后灯缓缓熄灭。

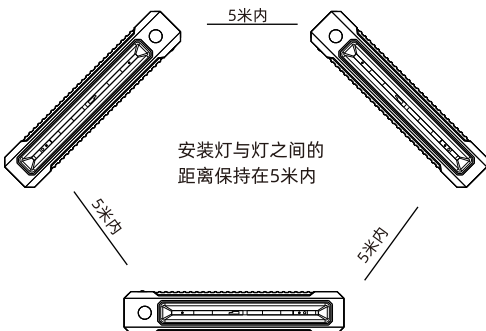

结构介绍

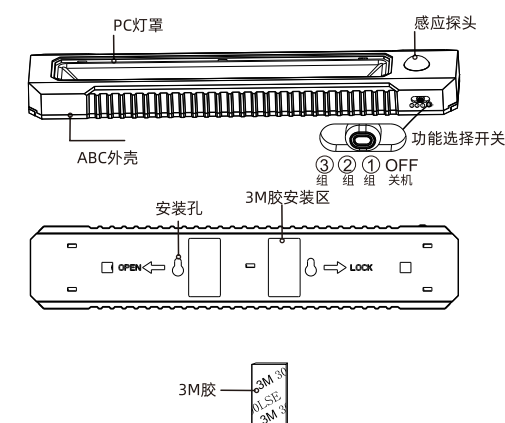

组网联动方法

产品组网联动使用

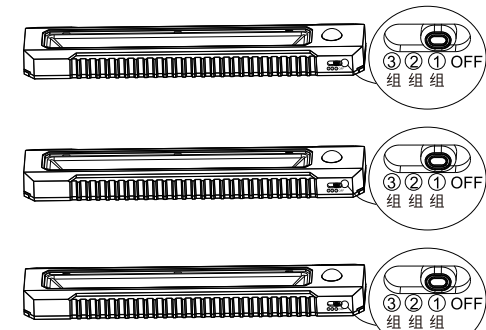

*将开关调至同一序号，即可设置同组联动，可布局3组

产品单个使用

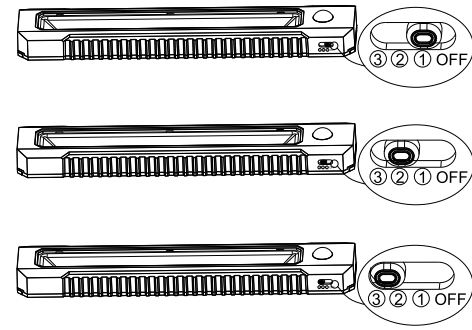

*单个使用只需将开关调至随意一个序号即可

安装方式

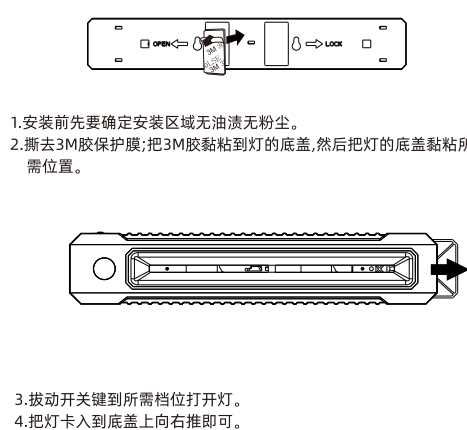

电池安装

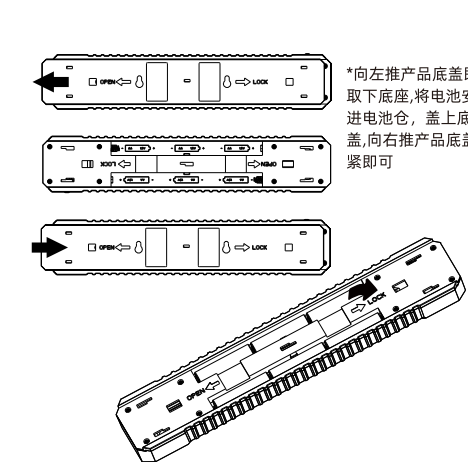

产品参数

产品型号	TDL-7156	灯珠颜色	白光/暖光
感应模式	人体感应	感应距离	3-5m
电 池	1.5V*5号电池*6	联动距离	5m
工作电流	130mA	感应角度	120°
功 率	1.2W	使用温度	-10°C~ 50°C
光 通 量	100LM	材质	ABC+PC
显 指	>80	重 量	153g(±5g)
延时时间	30s(±2s)	尺 寸	290*56*30mm

注意事项

- 1.产品不防水，请勿在雨水或者潮湿的环境下使用。
- 2.不可将产品安装在强光照射或冷热气进出口，以免影响灵敏度和产生错误动作。
- 3.灯光暗淡和不停闪烁时，请及时给产品更换电池。
- 4.长期不使用时，取下电池，以免发生危险！

Linkage motion sensor lights

Linkage sensor

- 1.The sensing distance of each sensor light is 3-5 meters, and the sensing angle is 120 degrees.
- 2.When the people enters the sensing range of any one of the whole group of induction lights, the whole group of lights will light up synchronously, leave the sensing range, and the lights will slowly turn off after 30 seconds.

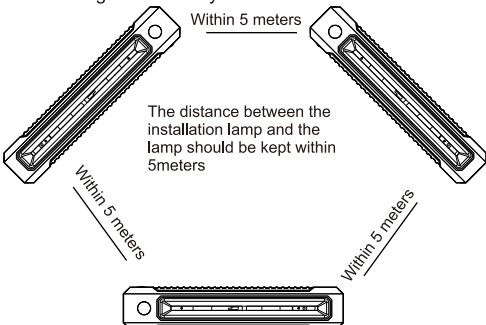

Structure introduction

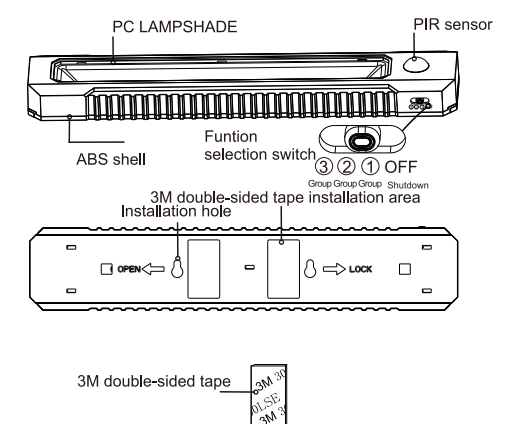

Networking linkage Method

Product network linkage use

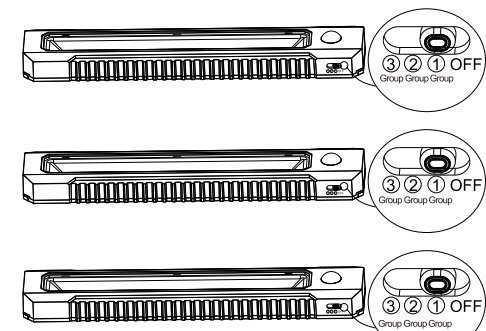

*Adjust the switch to the same serial number, you can set the linkage of the same group, can be arranged in 3 groups

How to use a single product

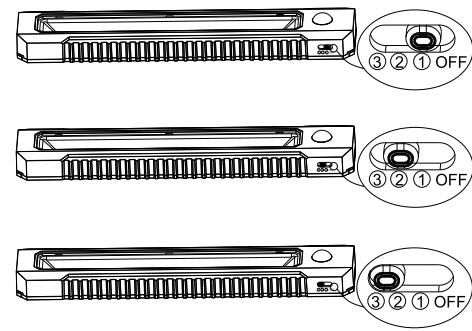

*Single use only need to adjust the switch to any serial number

Installation method

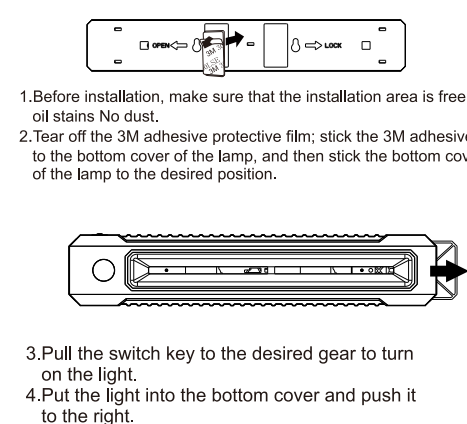

Battery installation

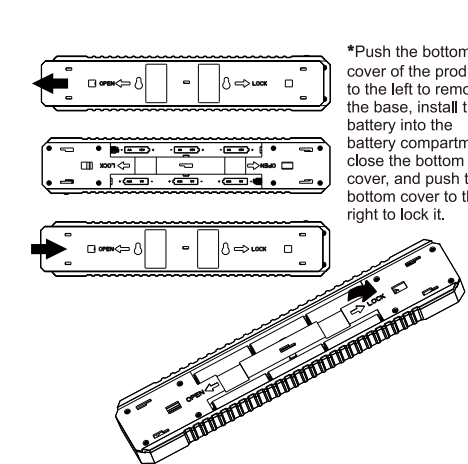

Product Parameters

Product Model	TDL-7156	Light color	White/Warm White
Induction Mode	PIR Motion sensor	Induction distance	3-5m
Batteries	1.5V*6AA	Linkage distance	5m
Working Current	130mA	Induction angle	120°
Power	1.2W	Operating temp	-10°C~ 50°C
Luminous Flux	100LM	Material	ABC+PC
CR	>80	Weight	153g(±5g)
Delay time	30s(±2s)	Size	290*56*30mm

Matters needing attention

- 1.The product is not waterproof, please do not use it in rain or humid environment.
- 2.Do not install the product in strong light or in the inlet and outlet of hot and cold air, so as not to affect the sensitivity and cause erroneous actions.
- 3.When the light is dim and keeps flashing, please replace the battery of the product in time.
- 4.When not in use for a long time, remove the battery to avoid danger!

FCC Caution:

This device complies with part 15 of the FCC Rules. Operation is subject to the following two conditions: (1) this device may not cause harmful interference, and (2) this device must accept any interference received, including interference that may cause undesired operation.

Any changes or modifications not expressly approved by the party responsible for compliance could void the user's authority to operate the equipment.

NOTE: This equipment has been tested and found to comply with the limits for a Class B digital device, pursuant to Part 15 of the FCC Rules. These limits are designed to provide reasonable protection against harmful interference in a residential installation. This equipment generates, uses and can radiate radio frequency energy and, if not installed and used in accordance with the instructions, may cause harmful interference to radio communications. However, there is no guarantee that interference will not occur in a particular installation.

If this equipment does cause harmful interference to radio or television reception, which can be determined by turning the equipment off and on, the user is encouraged to try to correct the interference by one or more of the following measures:

- Reorient or relocate the receiving antenna.
- Increase the separation between the equipment and receiver.
- Connect the equipment into an outlet on a circuit different from that to which the receiver is connected.
- Consult the dealer or an experienced radio/TV technician for help.

To maintain compliance with FCC's RF Exposure guidelines, This equipment should be installed and operated with minimum distance between 20cm the radiator your body: Use only the supplied antenna.