



Foreword

Thanks for buying the RGBICW floor lamp. Read the manual carefully, especially the warnings, and keep it for future reference. Follow the instructions closely for proper installation. After installation, control the lamp using the app or button.

Specification

Product Name	RGBICW Floor Lamp
Material	Aluminum & PC
Dimension	Φ13×H1415CM
Rated Power	12W
Input Voltage	AC 100~240V
Color of light	RGBICW
Max Luminous Flux	960lm
LED Light Source	Digital RGB+warm white, total 78LEDs
Controlled	Voice/APP/Touch
Waterproof	Indoor Use Only

We provide 2 years warranty for any questions since you received the product, please feel free to contact our customer service.



Part 1: Installation

Open the package and take out all the lamp components, includes as following:

1 x Lamp Base A

2 x Lamp B

1 x Lamp C

1 x Power adapt with wire

1 x User Manual 1 x Hex Wrench 5 x Spare Screws

① Put the base with the Lamp Base A in place.

② Insert 2 x Lamp B and 1x Lamp C into Lamp Base A

③ Install screws on the joint of A, B and Lamp C, then tighten them clockwise with a hex wrench.

④ Plug in the power adapter and complete the installation.



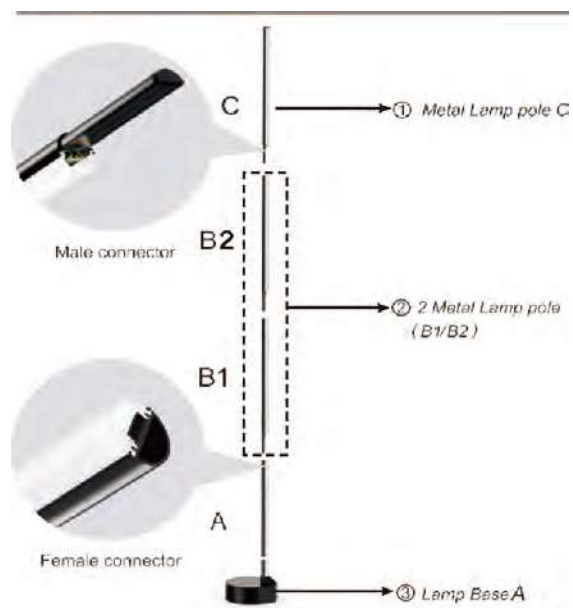

NOTE:

When disassemble the floor lamp, keep gently to shake the connection, pull out lamp bar while twisting the screw, do not pull violently, it may damage cable.

For the best performance, please note adjust the RGBICW floor lamp's position, keep a proper distance with you. make sure not affect your In-room activities

Part 2: Operating Guidelines

2.1.Three buttons on the base

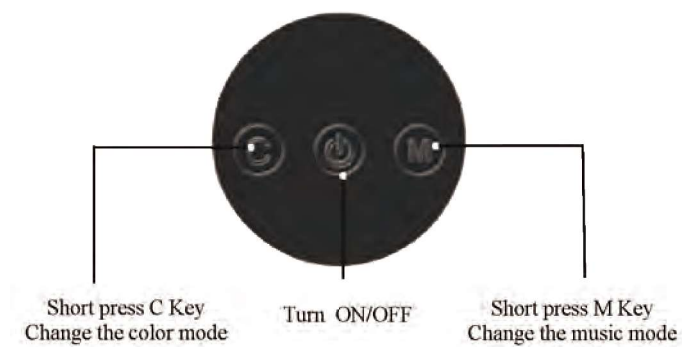

2.2.Remote controller

Functions of RF Remote Controller

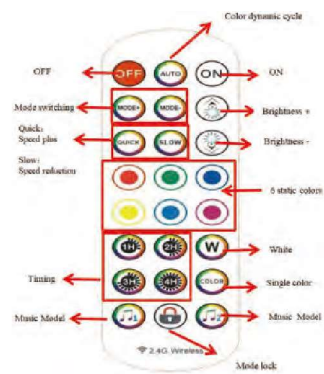

2.3.Smart APP

How to Download the Smart APP?

Android user

A: You can download it by scanning the QR code.

B: You can go to Google Play and download the "Symphony Lotus Lantern" application

IOS user

A: You can download it by scanning the QR code.

B: You can download "Magic Lantern" from the Apple Store.



How to operate the Smart APP?

- ① The first time you need to agree to use Bluetooth.
- ② Turn on Bluetooth on your phone.
- ③ After turning on Bluetooth, you can find the new device in the "Group Manage" screen, please connect it.
- ④ Here you can adjust the light colour what you want screen, please connect it.
- ⑤ Lighting styles & Music selection
- ⑥ Timing setting & Voice or mic Mode

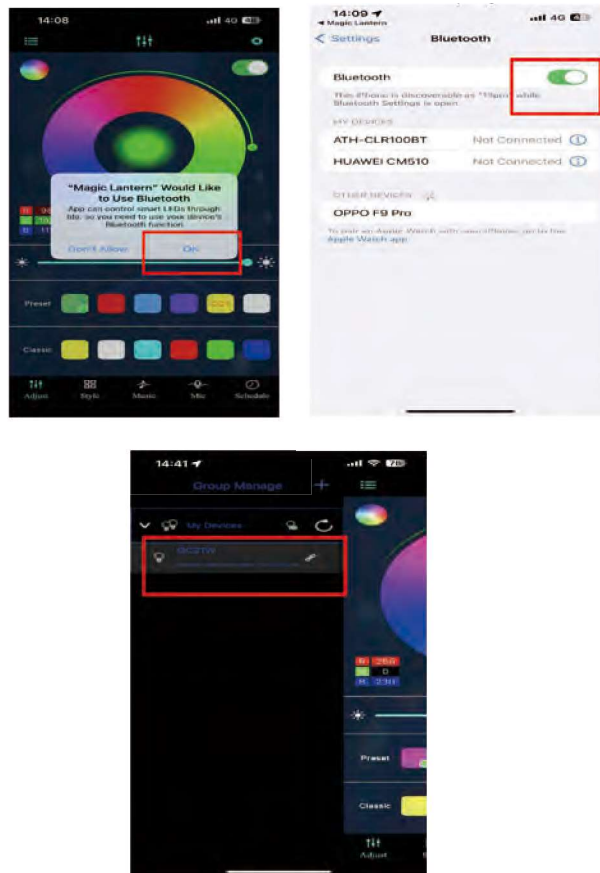

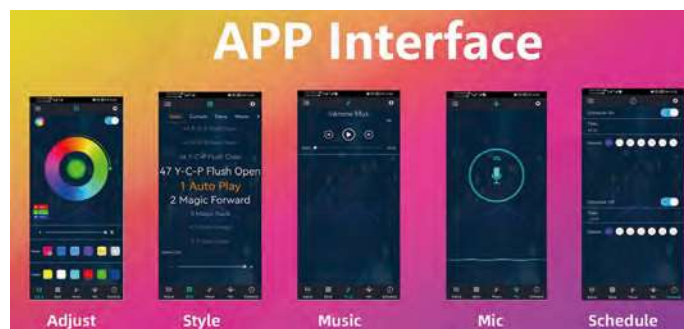

TPart 3 :Safety Warning

- ①The RGBICW Floor lamp and surrounding parts might get hot after hours of continuous use, do not place your hands directly on the light.
- ②Please ensure the stated minimum distance is maintained at all times.
- ③This product should be kept away from combustible materials (eg. curtains).
- ④Power off when replacing and cleaning to avoid electric shock.
- ⑤Be cautions of static electricity during installation and usage.
- ⑥Do not stare at the lamp for a long time.
- ⑦Please keep it away from children.
- ⑧The product is not water resistant, be cautions when installing and using.

ISED Statement: This device complies with Part 15 of FCC Rules [and contains license-exempt transmitter(s) that comply with innovation, Science and Economic Development Canada's licence-exempt RSS Standard(s)]. Operation is subject to the following two conditions:
(1) This device may not cause interference; and
(2) This device must accept any interference received, including interference that may cause undesired operation.

The digital apparatus complies with Canadian CAN ICES 3 (B)/ NMB 3(B). This device meets the exemption from the routine evaluation limits in section 2.5 of RSS 102 and compliance with RSS 102 RF exposure, users can obtain Canadian information on RF exposure and compliance.
This equipment complies with Canada radiation exposure limits set forth for an uncontrolled environment.
This equipment should be installed and operated with minimum distance 200mm between the radiator & your body.

French: L'appareil est conforme à la partie 15 des règles de la FCC [et contient des émetteurs exemptés de licence qui répondent aux critères du CNR d'exemption de licence d'innovation, sciences et développement économique Canada]. L'opération doit remplir les deux conditions suivantes:
(1) L'appareil ne peut pas causer d'interférence; Et
(2) L'appareil doit accepter toute interférence reçue, y compris celles qui peuvent entraîner un fonctionnement indésirable. Les appareils numériques sont conformes à la norme canadienne can ICES 3 (b) / NMB 3 (b).

L'appareil est conforme à l'exemption des limites d'évaluation de routine de la section 2.5 du CNR 102, l'exposition aux radiofréquences est conforme au CNR 102 et les utilisateurs peuvent obtenir des renseignements canadiens sur l'exposition aux radiofréquences et la conformité.
L'appareil est conforme aux limites d'exposition aux rayonnements établies au Canada pour les environnements non contrôlés.
Lors de l'installation et de l'utilisation de cet appareil, la distance minimale entre le radiateur et le corps doit être de 200mm.

FCC Warning This device complies with part 15 of the FCC rules. Operation is subject to the following two conditions: (1) this device may not cause harmful interference, and (2) this device must accept any interference received, including interference that may cause undesired operation.

Changes or modifications not expressly approved by the party responsible for compliance could void the user's authority to operate the equipment.

NOTE: This equipment has been tested and found to comply with the limits for a Class B digital device, pursuant to part 15 of the FCC Rules. These limits are designed to provide reasonable protection against harmful interference in a residential installation. This equipment generates uses and can radiate radio frequency energy and, if not installed and used in accordance with the instructions, may cause harmful interference to radio communications. However, there is no guarantee that interference will not occur in a particular installation. If this equipment does cause harmful interference to radio or television reception, which can be determined by turning the equipment off and on, the user is encouraged to try to correct the interference by one or more of the following measures:

- Increase the separation between the equipment and receiver.

- Connect the equipment into an outlet on a circuit different from that to which the receiver is connected.

- Consult the dealer or an experienced radio/TV technician for help.

Radiation Exposure Statement

This equipment complies with FCC radiation exposure limits set forth for an uncontrolled environment.

This equipment should be installed and operated with minimum distance 20cm between the radiator and your body.