

English

User Manual

Model: HYD-0501501A

Wall Sconces

Safety Instructions

- The lamp is not waterproof. Avoid exposing it to splashing or dripping water.
- The operating temperature should be within -10°C to 40 °C.
- If the light sources break or can not be charged, please tell us.
- Avoid using the lamp near heat sources.
- Because the product includes Li-ion battery, please stop to use if it's overheating.

Introduction

Thanks for choosing Wall Sconces. This lamp can meet your different applications, such as bedside, bathroom mirror, stairs.

What You Get

Lamp Base	1PC for 1pack; 2PCS for 2pack
Light Sources	2PCS for 1pack; 4PCS for 2pack
Charger Cable	1PC for 1pack; 2PCS for 2pack
User Manual	1PC
2.4G Remote	1PC

At a Glance

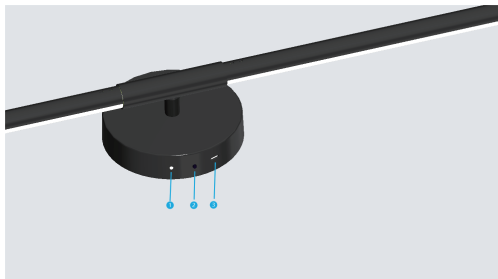

1. Charger display (Red means in charging, Green means full charged).
- 2 On/Off button.
3. Type-C charger port.

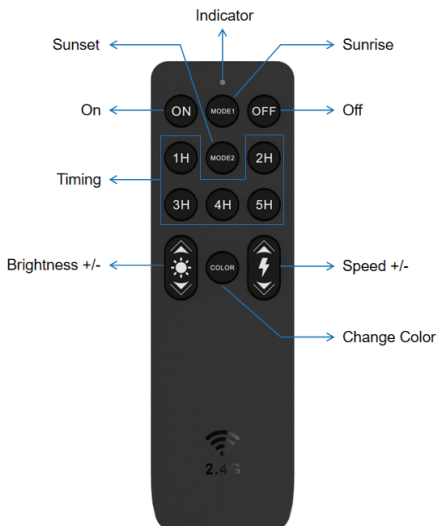

Installing Your Device

1. Use charger cable to charge the lamp base.

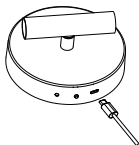

2. Install the two lamp sources into lamp base.



3. Drill a hole with a diameter of 6 mm and a depth of 30 mm in the wall, and insert a plastic plug into the hole.

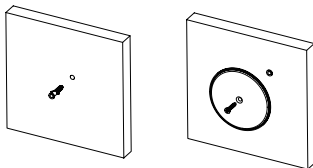

4. Or peel off the protective film from the base plate's double-sided adhesive and affix it directly to the wall, ensure the adhesive is applied to a smooth and even wall surface for maximum bonding strength.

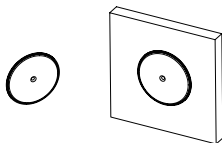

5. Attach the magnet-equipped light fixture to the pre-installed base plate.

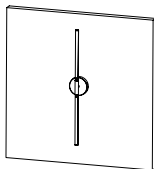

6. You can rotate the light sources like below illustration, and use 2.4G remote to operate the lamp.

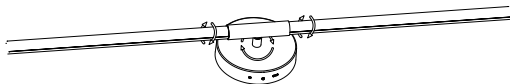

Specifications

Input	5V2A
Battery	Li-ion
Charger Time	4hours
Cylcles	300
Power	1.5W
Maximum Lumen	400lm
Light Source Color	CW+WW
Control Options	Remote Control
Product Dimension	24in;30in
Waterproof	Indoor Use Only

Customer Service

Waranty : 12-Month Limited warranty

Support : Lifetime Technical Support

FCC and ISED Canada Statement

This device complies with Part 15 of the FCC Rules and industry Canada licence, exempt RSS standard(s). Operation is subject to the following two conditions :

- (1) This device may not cause harmful interference, and.
- (2) This device must accept any interference received, including interference that may cause undesired operation

Warning : Changes or modifications not expressly approved by the party responsible for compliance could void the user's authority to operate the equipment.

FCC Statement: This equipment has been tested and found to comply with the limits for a Class B digital device, pursuant to part 15 of the FCC Rules. These limits are designed to provide reasonable protection against harmful interference in a residential installation. This equipment generates, uses and can radiate radio frequency energy and, if not installed and used in accordance with the instructions, may cause harmful interference to radio communications. However, there is no guarantee that interference will not occur in a particular installation.

If this equipment does cause harmful interference to radio or television reception, which can be determined by turning the equipment off and on, the user is encouraged to try to correct the interference by one or more of the following measures:

- Reorient or relocate the receiving antenna.
- Increase the separation between the equipment and receiver.
- Connect the equipment into an outlet on a circuit different from that to which the receiver is connected.
- Consult the dealer or an experienced radio/TV technician for help.

This device complies with Part 15 of FCC Rules and contains license-exempt transmitter(s) that comply with innovation, Science and Economic Development Canada's licence-exempt RSS Standard(s)]. Operation is subject to the following two conditions:

- (1) This device may not cause interference; and
 - (2) This device must accept any interference received, including interference that may cause undesired operation
- The digital apparatus complies with Canadian CAN ICES 3 (B)/NMB 3(B).

This device meets the exemption from the routine evaluation limits in section 6 of RSS 102 and compliance with RSS 102 RF exposure, users can obtain Canadian information on RF exposure and compliance.

French:

Cet appareil est conforme à la partie 15 des Règles de la FCC et contient un ou plusieurs émetteurs exonérés de licence qui sont conformes à la norme RSS exonérée de licence de Sciences et Développement économique Canada.

L'exploitation est soumise aux deux conditions suivantes:

- (1) Ce dispositif ne peut pas causer d'interférences; et
- (2) Ce dispositif doit accepter toute interférence reçue, y compris les interférences qui peuvent provoquer un fonctionnement indésirable

L'appareil numérique est conforme aux normes canadiennes CAN ICES 3(B)/NMB 3(B).

Cet appareil répond à l'exemption des limites d'évaluation de routine prévues à l'article 6 de la RSS 102 et à la conformité à la RSS 102 en matière d'exposition aux RF. Les utilisateurs peuvent obtenir des renseignements canadiens sur l'exposition aux RF et la conformité.