



● **Connecting through the Website**

The operation is the same as the App. If the App is already connected, the status will be automatically synchronized on the PC.

1.2 “Work with Alexa” skills

NO	Skill	Remark
1	Alexa, turn off “ Frame ”	Turn on sleep mode
2	Alexa, turn on “ Frame ”	Turn off sleep mode
3	Alexa, volume up on “ Frame ”	Volume up
4	Alexa, volume down on “ Frame ”	Volume down
5	Alexa, mute on “ Frame ”	Mute
6	Alexa, unmute on “ Frame ”	Unmute
7	Alexa, go home on “ Frame ”	Go to the Home Page
8	Alexa, go settings on “ Frame ”	Go to Settings
9	Alexa, play on “ Frame ”	Video playback
10	Alexa, pause on “ Frame ”	Video pause
11	Alexa, previous on “ Frame ”	Previous
12	Alexa, next on“ Frame ”	Next

Guarantee

If the product does not meet your expectations, please feel free to contact us through "contact seller", excellent after-sales service will be completed within 24 hours.

Contact Information:

Email:xiskt@outlook.com

Digital photo frame

User Manual



Contents

- 1.Included Accessories-----3
- 2.Function Introduction-----3
- 3.How to Install the Bracket-----4
- Whale Photo web
- Getting started -----5
- 1.Log in and log out- -----5
 - 1.1 Scan code login-----5
 - 1.2 Log out -----6
- 2.Photo sharing----- 6
 - 2.1 Photo selection -----6
 - 2.2 Photo editing-----7
 - 2.3 Frame selection-----9
 - 2.4 Send -----10
- 3.Taskbar-----10
- 4.History-----11
- 5.Profile-----11
 - 5.1 Switching languages-----11
 - 5.2 Profile-----12
- Whale Photo APP
- 1.Whale Photo APP-----13
 - 1.1 Introduce the Whale Photo Frame-----13
 - 1.2 Download the Whale Photo App-----13
- 2.How to use Whale Photo Frame-----14
 - 2.1 Quick setup-----14
 - 2.2 Connecting a new friend-----14
 - 2.3 Navigating your Whale Photo-----15
 - 2.3.1 Power Icon-----15
 - 2.3.2 Connecting with your friend-----16
 - 2.3.3 Gallery-----16
 - 2.3.4 Loop / Sequence-----17
 - 2.3.5 Settings-----17
 - 2.3.6 Hide/Show photos-----17

- 2.3.7 Fill frame/Fit to frame-----17
 - 2.3.8 Adjust photos-----18
 - 2.3.9 Slideshow-----18
 - 2.3.10 Horizontal/Vertical rotation-----19
 - 2.3.11 Weather & Time -----19
 - 2.3.12 Video Content Settings-----19
- 2.4 Settings-----19
 - 2.4.1 My frame-----19
 - 2.4.2 Photo management-----20
 - 2.4.3 Manage account----- 22
 - 2.4.4 Display-----23
 - 2.4.5 Photo settings-----24
 - 2.4.6 Notifications-----26
 - 2.4.7 Wi-Fi-----26
 - 2.4.8 Help-----26
 - 2.4.9 About-----27
- 3.How to use Whale Photo APP-----27
 - 3.1 Quick Setup-----27
 - 3.2 Photo Share-----28
 - 3.3 History-----29
- 4.Warranty, compliance, technical support and safety information-----29
- Work with Alexa
- 1. Voice Assistant-----29
 - 1.1 Preparation work-----30
 - 1.1.1 Download the Amazon Alexa App----30
 - 1.1.2 Log in to the Amazon Alexa App and photo frame with the same Amazon account-----31
 - 1.1.3 Alexa App add skills (Whale Photo Skill)-----33
 - 1.2 Work with Alexa skill-----35
- Guarantee-----35

XISK T —— Operating Instruction

In order to ensure that you can fully understand and use this product, please ensure to read the instructions carefully. After reading, please keep it properly for the future reference.

1. Included Accessories



Digital Photo Frame



Bracket

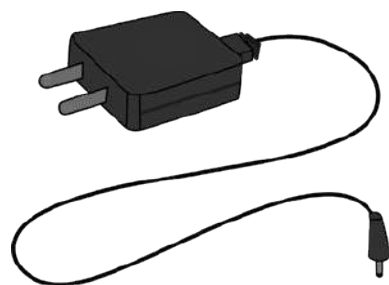

Power adapter

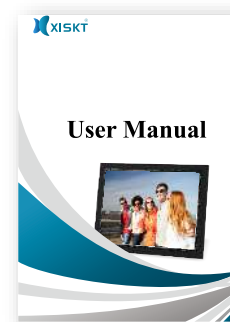

Instruction manual

2. Function Introduction

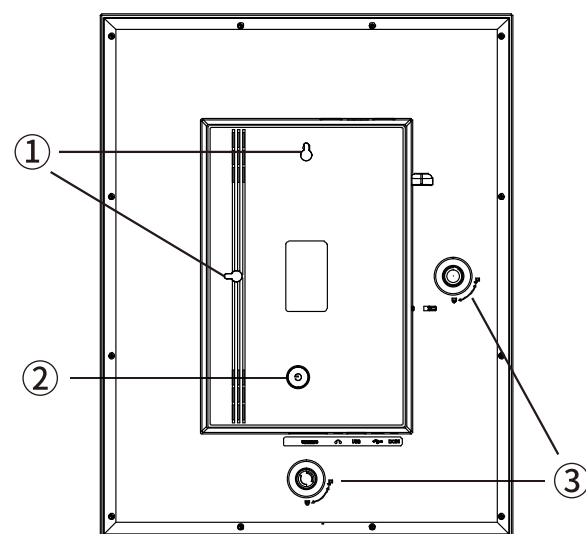

- ① Wall-mounted hole
- ② Power switch button
- ③ Removable bracket

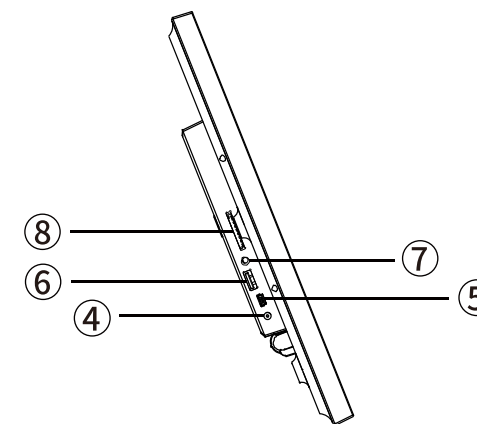

- ④ Power port
- ⑤ USB upgrade interface
(Dedicated port for technicians)
- ⑥ USB port
- ⑦ Earphone port
- ⑧ SD card slot

3. How to Install the Bracket

① Install the bracket

- Find the bracket hole of the photo frame and install it directly.
- Mounting holes are required if you'd like to install on the wall.

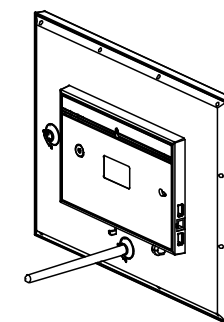
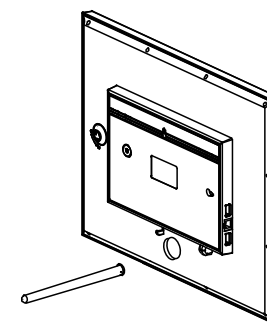

② ON/OFF

Connect the adaptor that the photo frame will enter the system in a few seconds.

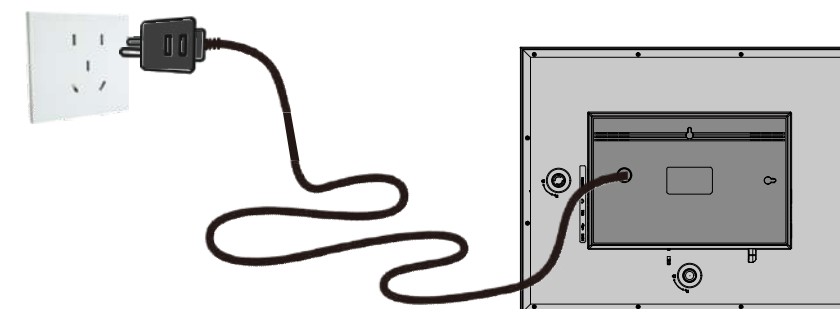

③ Connect the WiFi

Select the WiFi network, then input password.

Note: Please close to the router then wait few seconds later if your WiFi is not on the list.

Getting started

Whale Photo Web is a pc online transferring tool for Whale Photo Frames. Through the Whale Photo Web, you can share up to 500 photos to the photo frame at once.

1. Log in and log out

1.1 Scan code login

Visit the website to get access to Whale Photo Web: <https://whalephoto.zeasn.tv>

Download, install and open the "Whale Photo" APP on your mobile devices, and find the QR code under [Scan] to log in.

NOTE: When successfully logged in, the web will automatically synchronize the information from the APP (eg. profile picture, nickname, connected device).

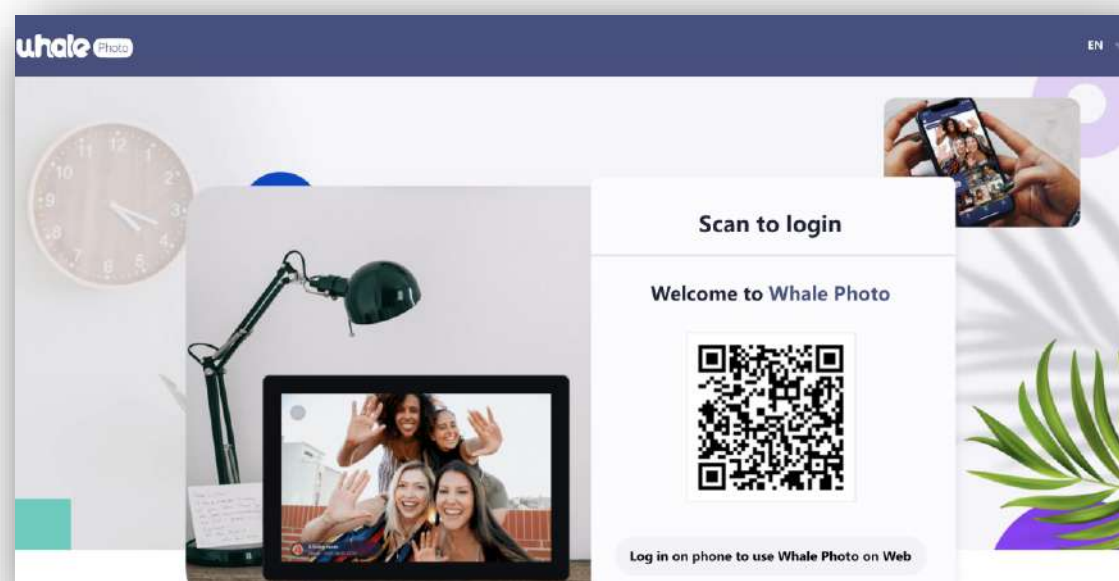

1.2 Log out

To switch accounts for sharing, Log out the current account in the upper right corner, and scan the code to log in another account.



2. Photo sharing

2.1 Photo selection

After logging in, select photos to share in two ways.

- 1) Click the button to open the local folder and select photos;
- 2) Drag photos or a folder directly to the area, then click [Next] to upload;

NOTE:

1) Hold down Ctrl to select batches or drag photo(s) to the area.

2) Currently supported formats: JPG、JPEG、PNG、BMP

2.2 Photo editing

When the photos are on the list to be transferred, you can edit the photo information, such as adding photos onto the existing list, renaming and removing photos, and more.

1) Adding more photos onto the existing list.

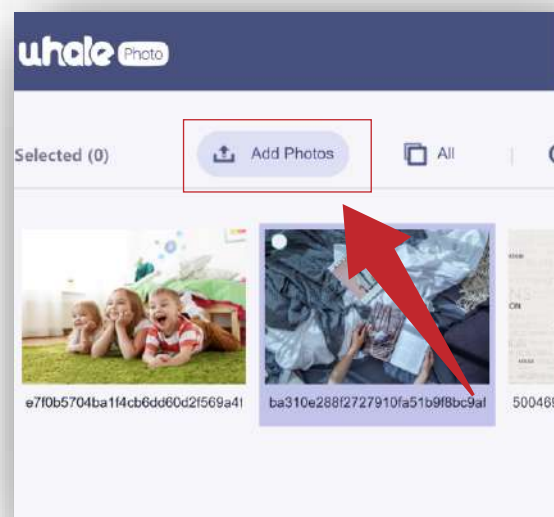

2) Select All: Click [Select All] to select all photos, and the number of selected photos will be displayed in the upper left corner. Click [Select All] again to undo.

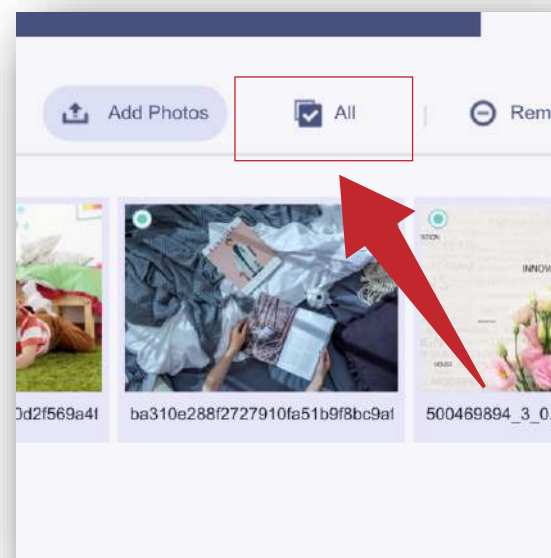

3) Remove: Selected photo(s) can be removed from the current transfer list by clicking [Remove].

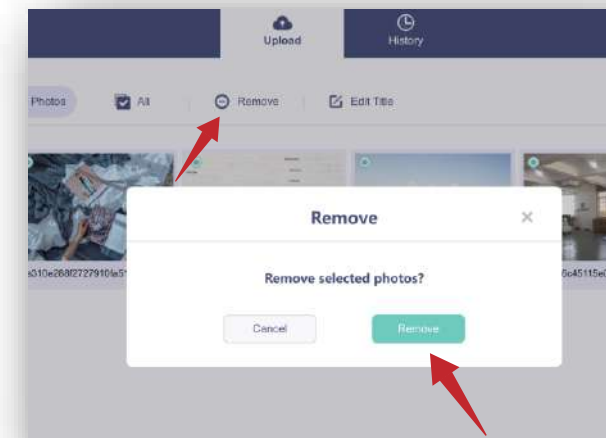

4) Renaming multiple photos: Selected photo(s) can be renamed in batch on the page.

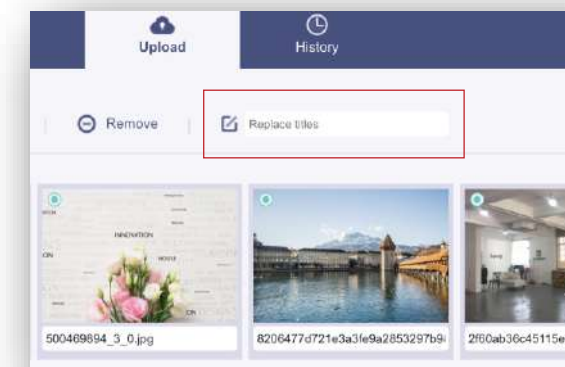

5) Renaming a photo: Supports name re-editing for a selected photo.

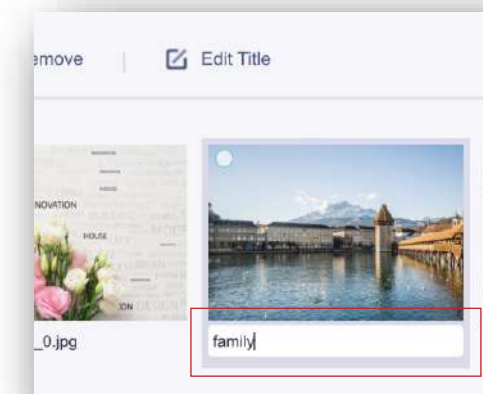

NOTE: Exit the editing mode, select a photo frame to complete photo sharing. Photo(s) cannot be shared under editing mode.

2.3 Frame selection

When finishing editing all photos, click [Next] to select a photo frame. If there is a binding device, the online photo frame information will be displayed; and if there is no binding device, you will be prompted to go to the APP to bind one.

Offline display:

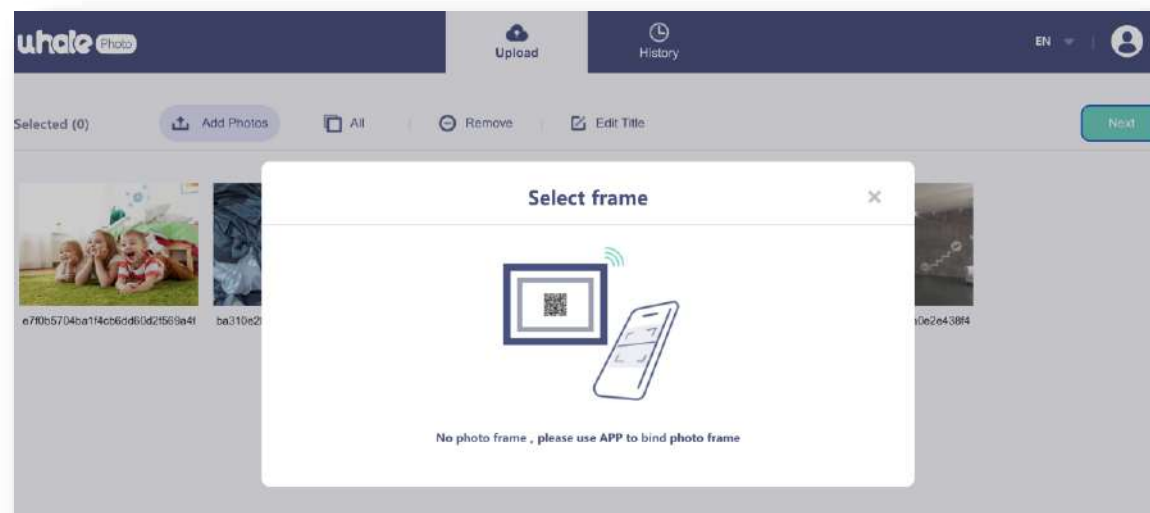

Online display:

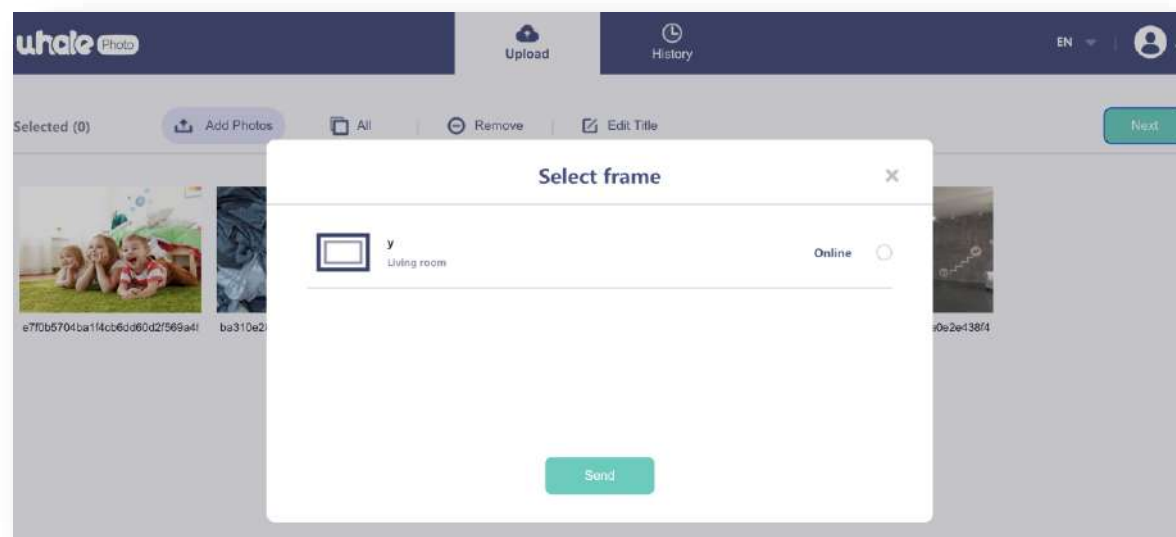

2.4 Send

Select the photo frame and click [Send]. Then, a task will be created in the taskbar. Check the photo sending progress on the page or click [History] to view it.

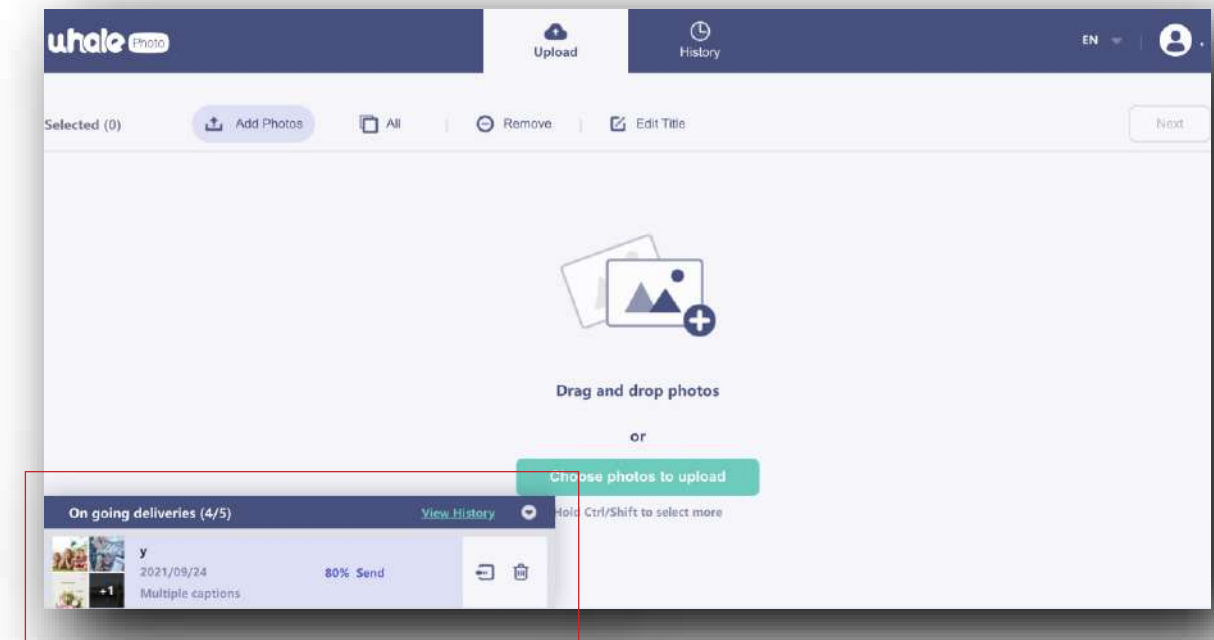

3. Taskbar

The Taskbar displays the photo transfer tasks for users to check sending progress. The Taskbar supports quick operations, including re-send, withdraw, delete and more.

1) View history: Click [View History] to jump to the history record. The functions of the history record are the same as Taskbar; but in here, you can view the transmission details of a single task.

2) Maximize/Restore down the Taskbar: When the taskbar is maximized, scroll up and down to view each transmission task; restore down to display in a smaller window.

3) Resend: Re-select the photo frame to send the photo(s) again.

4) Withdraw: Withdraw photo(s) from the photo frame.

5) Delete: Delete current task.

4. History

History obtains the same functions as Taskbar but in here, you can view the details of a task to check the transferring status of photo(s) (successful, transferring, failed).

5. Profile

5.1 Switching languages

Currently, switching amongst 12 languages is supported.

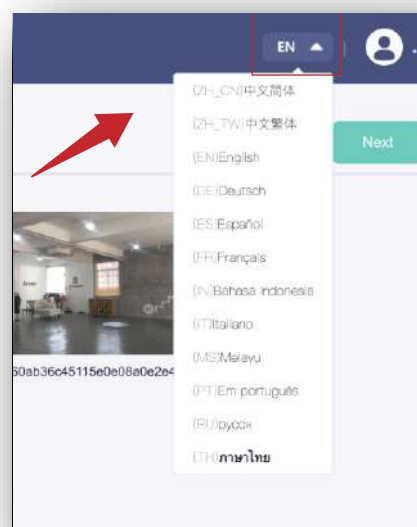

5.2 Profile

Basic information is displayed under the profile section.

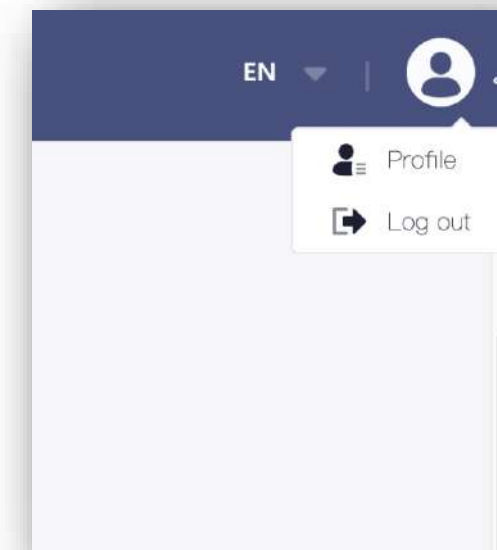

1) Connected frames : Display information of connected frames, name, location and status.

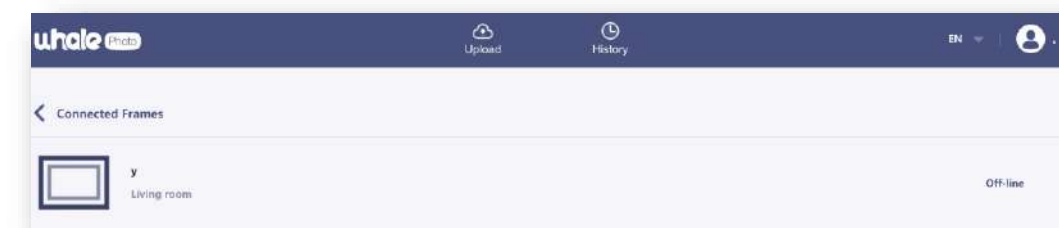

2) Privacy Policy: Displays Privacy Policy and Terms of Use.

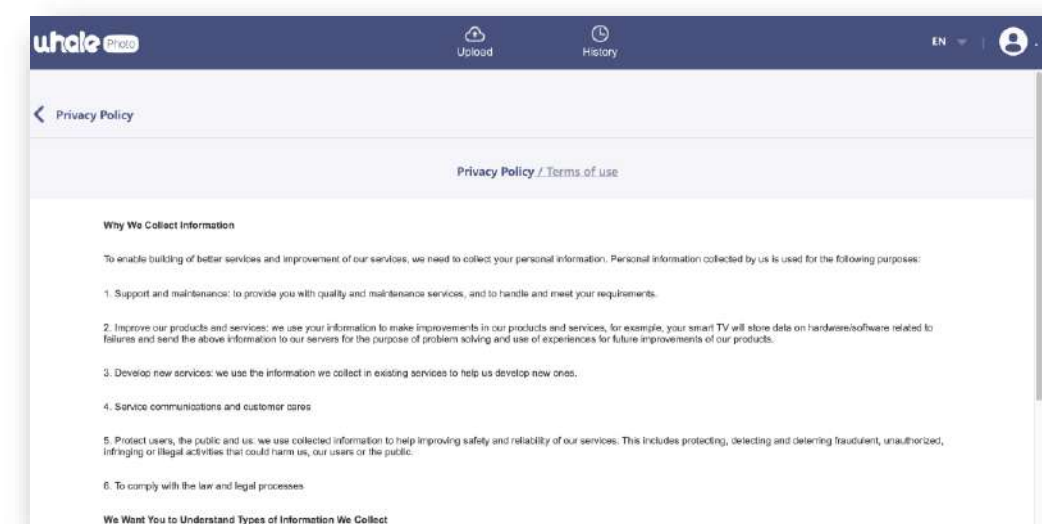

3) Support: displays contact information of the support team.

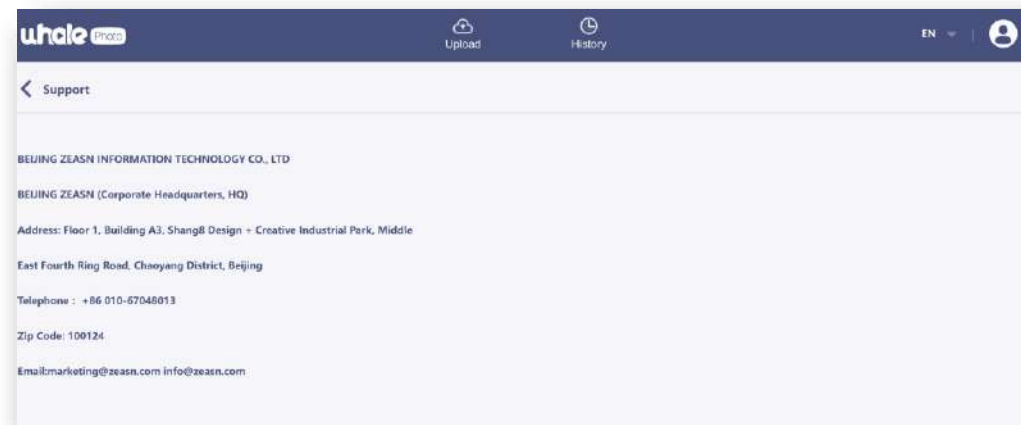

1. Whale Photo APP

1.1 Introduce the Whale Photo Frame

Whale Photo Frame displays wonderful moments shared by mobile devices. Touch-screen operation is easy to use, making sharing photos and videos smoother and more convenient.

1.2 Download the Whale Photo App

To send photos to your frame by using the Whale Photo App for ios or Android.



Find the Whale Photo App on:

- Android: Search for "Whale Photo" on Google Play
- IOS: search for "Whale Photo" on the App Store

2. How to use Whale Photo Frame

2.1 Quick setup

When starting your frame for the first time, you will need to setup the frame.

- Whale Photo Frame may request to upgrade to the latest version. If so, it is recommended to upgrade the photo frame before proceeding.
- Choose a language you preferred as default.
- Connect the photo frame to the Internet via Wi-Fi.
- Name the photo frame (Eg: Jack's Frame) ; Set the location of the photo frame (Eg: Living Room, Kitchen, Office);
- Set the time zone if needed.
- Check the quick guide on the Whale Photo frame.

2.2 Connecting a new friend

- Make sure that your friend has downloaded and installed the Whale Photo App (See 1.2).
- Click the "Add friend" icon on your frame. A dialog will appear showing both QR code and SN code (valid for 12 hours).

● Now share either the QR code or the SN code through your preferred way E.g. SMS, E-Mail, IM, phone call, to your friend.

Once the frame is connected to your friend's Whale Photo App, you will be able to find them on the sharing list on the frame.

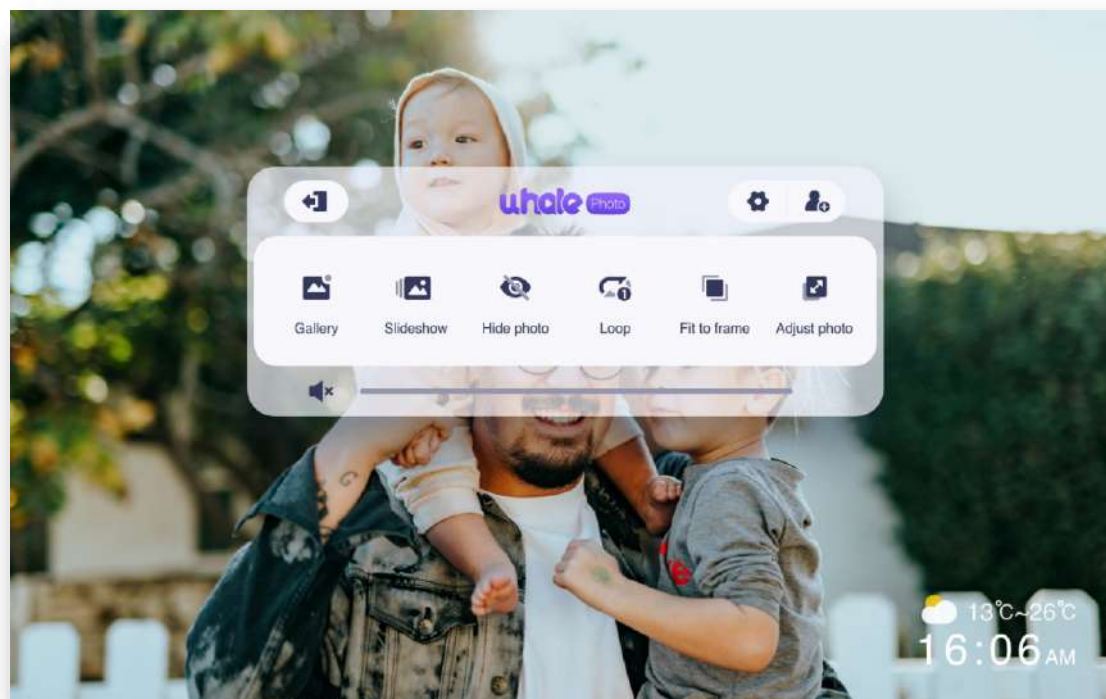

2.3 Navigating your Whale Photo

You interact with your frame through its touchscreen. To browse your photos, swipe left or right. To access the menu bar, simply tap once on the screen.



2.3.1 Power Icon

Click the power icon , you can choose from three options: power off, restart, and sleep.

Click  to power off, click  to re-boot, click  to switch to sleep mode.

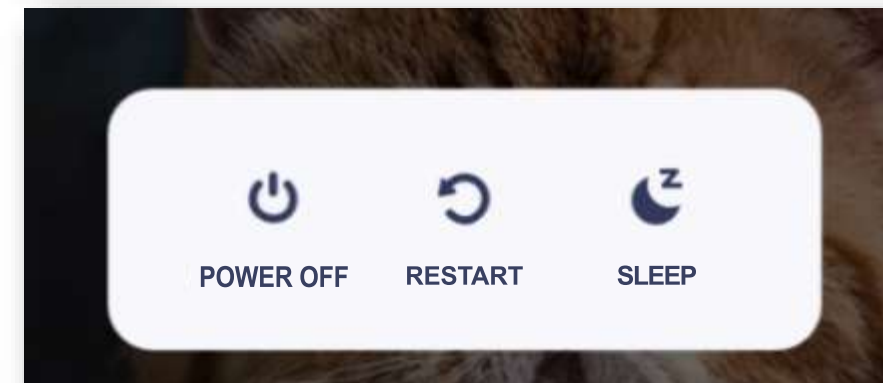

Note: Remember always turn the frame off properly by using the physical button on the device or tapping the power off icon in the interface. Do not dis-connect the power adaptor directly while the photo frame is running.

2.3.2 Connecting with your friend

SN and QR code are generated for device connection by tapping the icon[Add Friend]. Use either of the two to connect the frame with mobile devices to enable photo sending .

2.3.3 Gallery

Open the gallery and browse media sources in the gallery.

● In the gallery, you can view photos shared by different accounts;

- In the gallery, you can hide categories to view more photos;
- In the gallery, you can view photos in chronological order/reverse order;
- In the gallery, you can only view videos or photos.

2.3.4 Loop/ Sequence

To set the picture display mode: select [Loop], the current photo or video will be presented in a loop; select [Sequence] to play the contents of the gallery in sequence.

2.3.5 Settings

For more options in settings.

2.3.6 Hide/Show photos

Hide the current photo. It means this photo will no longer be displayed in the slide show but still stored in the library. Go to settings-> Manage photos-> Show/hide photos.

2.3.7 Fill frame/Fit to frame

This function is to switch the photo display mode in the frame. Fill frame: It is the default display mode. The photo is scaled proportionally to fit the entire frame. Fit to frame: the entire photo is displayed in the frame as its original proportion.



Fill frame



Fit to frame

2.3.8 Adjust photos

This only appears when “fill frame” is selected. Select the part of photo to be displayed.



2.3.9 Slideshow

Set the playback effect through the menu's [Slideshow]. Above 6 effects are provided, but only valid for the photo slideshow.