



懿集團有限公司
EMAY GLOBAL LIMITED

1/F., Centre 600, 82 King Lam Street,
Cheung Sha Wan, Kowloon, Hong Kong

Email : cs@emayplus.com

Tel : +852 2312 0900 (HK) /
+86 755 8654 2891 (China)



Dual Lifting Face Slimmer

User Guide

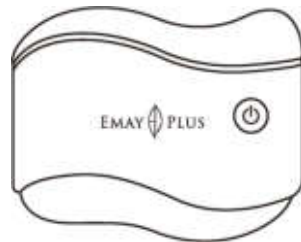

Safety

- Do not use it if metal **allergy** and **allergic** constitution.
- Please stop using it immediately if you feel any discomfort or have an **allergic** reaction during use.
- Pregnant or breastfeeding women should **consult** a doctor before use.
- Please **consult** with your doctor before use if you are diagnosed or suspicious with skin diseases.
- Do not use on wounded, scarred skin, surgery area, inside your mouth, eye area and **eyeball**.
- People with medical devices implanted (such as pacemakers) should not use this product.
- Do not throw or **place** this product close to heat sources, naked **flames**, sub-zero temperatures, water, and humid environments. Do not expose it to sun or rain or immerse it in water.
- Do not rinse the device with water and immerse in water/any other liquids.
- Avoid any liquid or conductive object inside the device.
- Do not disassemble, repair or **alter** the product. Improper handling may cause fire, electric shock, injury, or failure. Unauthorized disassembling or modification could void the product warranty.
- Refrain from dropping, bumping it against other objects or pressuring the device.
- Do not use the product if the device, USB cable or the **plug** are damaged; or if the charger is under abnormal situation, damaged, or dropped into water.
- Please charge the device once a month to ensure the best performance. Please switch off the device after use.
- Keep out of reach of children. Children are not **allowed** to use this product.

Product Structure



How to use

1. Power button:

Press the button for 3 seconds to turn on the device, press for 3 seconds again to turn off the device.

2. Pause:

The device **will** be paused after working for 10 minutes, under any modes.

3. Working modes:

Press the button to switch to different modes. Low-heating mode is suitable for face massage. Medium and High-heating mode is suitable for body massage. Please test the temperature before using directly on your face.

3.1) "Low-heating + Vibration", power button lights up with **blue**. Red indicator light stays on.

Heating temperature: 40 °C.

3.2) "Medium-heating + Vibration", power button lights up with **green**. Red indicator light stays on.

Heating temperature: 45 °C.

3.3) "High-heating + Vibration", power button lights up with **red**. Red indicator light stays on.

Heating temperature: 48 °C.

4. Low power reminder:

If the device is out of power, it **will** shut down after the indicator **flashing** with red lights.

5. Charging:

USB charging. The device cannot be run **while** charging. The indicator **will** show in red while charging and turns to green when it is **fully** charged.

* Use the massage **plate** together with different modes for shape **lifting**, or simply massage with terahertz beads roller.

Usage area

1. Slide from forehead to ear area
 2. Slide from nose wing top ear area
 3. Slide from ear area to collarbone area
 4. Slide from the area behind the ear to collarbone area
 5. Slide from chin to ear area, then slowly move along the neck line to collarbone area
- *Repeat 3-4 times, drink water after massage.

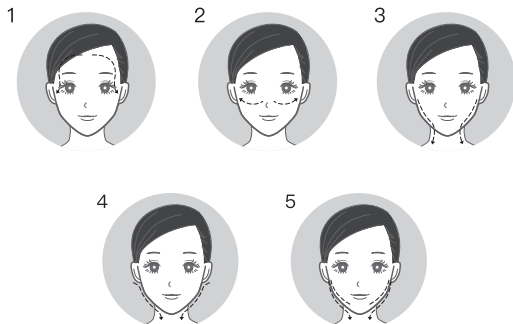

Usage area

Slimming & lifting Massage

1. Face: Slowly slide upward to the cheek area, and gently apply with pressure. For skin firming and shape lifting.
2. Mouth: Spiral movement on both corners of mouth. Prevent drooping of mouth corner muscle.
3. Forehead: Move slowly on forehead from bottom to top, and from middle to right/left. Effectively firm, prevent and reduce wrinkles.

*Repeat 3-5 times.



Tips of Massage

Mouth Corner: Massage slowly around mouth corner, slide up and move from left to right, to reduce laugh lines and wrinkles.

Neck: Massage your neck upward to reduce neck lines.

Content

- | | |
|-----------------|--------------------|
| 1. Device x1 | 3. User guide x1 |
| 2. USB cable x1 | 4. Storage Bag x 1 |

Cleaning

- Clean the massage plate and terahertz beads roller by cotton swab or soft cloth after use.
- Please do not use following liquid to clean the device such as alkaline cleaner, diluents, volatile oils, nail polish remover and other solvents.
- Do not rinse the device with water and immerse in water/any other liquids.

Warranty

- 1 year warranty starts from the purchase date of the product
- For warranty and repair service, please contact the local distributor.
- Please retain your receipt as proof of purchase and product packing for warranty purposes, (You may need to provide other information depends on the local distributor's warranty policy).
- Please do not modify, repair, or disassemble this product. These actions could avoid the product warranty.
- Warranty coverage does not cover misuse, abuse and any damage caused by other external causes.
- Warranty does not cover accessories, batteries or any other consumable item.
- If part is missing or damaged, please contact the local distributor.
- The warranty and supporting service are subject to the clause of the distributor.

Product Specification

Product Name	Dual Lifting Face Slimmer
Materials	ABS, PC, TPE, Stainless Steel, THZ Stone
Size	101 (L) x82 (W) x20 (H) mm
Weight	80g
Power	3W Max
Voltage	3.7V
Input	5V/500mA
Battery Capacity	500mAh
Heating Temperature	40/45/48 °C
Vibration Frequency	10000 rpm
Usage Time	Approx. 60 minutes
Charging Method	USB 5V/500mA
Charging Time	Approx. 90 minutes
Timer Control	Auto Off in 10 mins

<p>EU regulatory conformance :</p> <p>CE DOC</p> <p>Hereby,[Emay Global Limited] declares that the radio equipment type [EP-416] is in compliance with Directive 2014/53/EU. The full text of the EU declaration of conformity is available at the following internet address: https://www.emayplus.com</p> <p>RF exposure information: The EIRP power of the device at maximal case is below the exempt condition, 20mW specified in EN62479: 2010. RF exposure assessment has been performed to prove that this unit will not generate the harmful EM emission above the reference level as specified in EC Council Recommendation(1999/519/EC).</p> <p>Operation temperature: 0~45℃</p> <p>Operation frequency(Max power)</p> <p>Bluetooth: 2402-2480 (0 dBm)</p>	<p>FCC regulatory conformance:</p> <p>This device complies with Part 15 of the FCC Rules. Operation is subject to the following two conditions:</p> <p>(1) This device may not cause harmful interference.</p> <p>(2) This device must accept any interference received, including interference that may cause undesired operation.</p> <p>NOTE: This equipment has been tested and found to comply with the limits for a Class B digital device, pursuant to part 15 of the FCC Rules. These limits are designed to provide reasonable protection against harmful interference in a residential installation.</p> <p>This equipment generates uses and can radiate radio frequency energy and, if not installed and used in accordance with the instructions, may cause harmful interference to radio communications. However, there is no guarantee that interference will not occur in a particular installation. If this equipment does cause harmful interference to radio or television reception, which can be determined by turning the equipment off and on, the user is encouraged to try to correct the interference by one or more of the following measures:</p> <ul style="list-style-type: none"> - Reorient or relocate the receiving antenna. - Increase the separation between the equipment and receiver. -Connect the equipment into an outlet on a circuit different from that to which the receiver is connected. -Consult the dealer or an experienced radio/TV technician for help <p>NOTE: The manufacturer is not responsible for any radio or TV interference caused by unauthorized modifications to this equipment. Such modifications could void the user's authority to operate the equipment.</p> <p>This equipment complies with FCC radiation exposure limits set forth for an uncontrolled environment.</p>
---	---

IC regulatory conformance

This device complies with CAN ICES-003 (B)/NMB-003(B).

This device complies with Industry Canada licence-exempt RSS standard(s). Operation is subject to the following two conditions:

(1) this device may not cause harmful interference, and

(2) this device must accept any interference received, including interference that may cause undesired operation.

Cet appareil est conforme à la norme CAN ICES-003 (B)/NMB-003 (B).

Le présent appareil est conforme aux CNR d'Industrie Canada applicables aux appareils radio exempts de licence. L'exploitation est autorisée aux deux conditions suivantes :

(1) l'appareil ne doit pas produire de brouillage, et

(2) l'utilisateur de l'appareil doit accepter tout brouillage radioélectrique subi, même si le brouillage est susceptible d'en compromettre le fonctionnement.

This equipment complies with IC radiation exposure limits set forth for an uncontrolled environment.

Cet équipement est conforme aux limites d'exposition aux radiations de la IC définies pour un environnement non contrôlé.