

# M03 Portable Wireless Charging Power Bank User Manual

## Item List:

1. Wireless Power bank \* 1
2. USB to Type-C cable \* 1
3. User manual \* 1

## Operation of wireless charging power bank

1. Take out M03 power bank from box, attach the magnet side to the back of iPhone 12 series or later, where it can charge wirelessly. The magnet will align automatically and start wireless charging automatically. Indicator will light up means work normally. (Other wireless charging mobile phone need to stick magnetic circle then can charging magnetically, or it's hard to align the magnet)
2. Charge power bank M03. Take out USB to Type-C cable, insert to the power bank charging interface to charge. Indicator turns to orange color and flash slowly. After full charge, indicator turns to white color and keep lighting, then remove the USB cable.
3. While charging mobile phone and power bank at the same time, it will charge mobile phone on priority and charge less to M03 power bank.
4. While power bank capacity is lower than 20%, indicator will flash orange light 1/4>
5. While M03 detecting there is foreign body on the magnetic coil, indicator will flash orange color quickly.
6. Power bank will turn off automatically after 10 seconds of removing mobile phone from M03. For next time using, repeat the first step.

## Kickstand Usage

1. While charging mobile phone magnetically, unfold the stand to hold the phone, it can be used horizontally or vertically. (Refer to the below picture)



2. While unfolding the kickstand, the white light and orange light will flash alternately, lasting for about 10 seconds.
3. While put mobile phone horizontally on the power bank, need to unfold the kickstand to turn on the power bank to start charging. If put vertically, it will turn on and charge automatically.

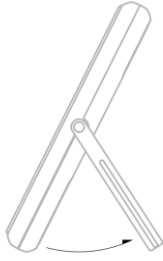

## Specification

Size: 99.5mm\*66.5mm\*12.4mm

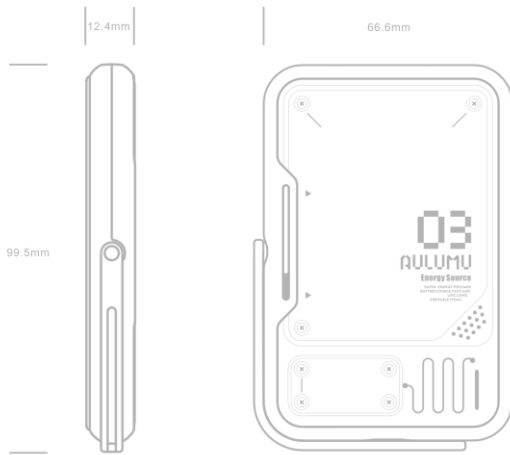

## Function Indication

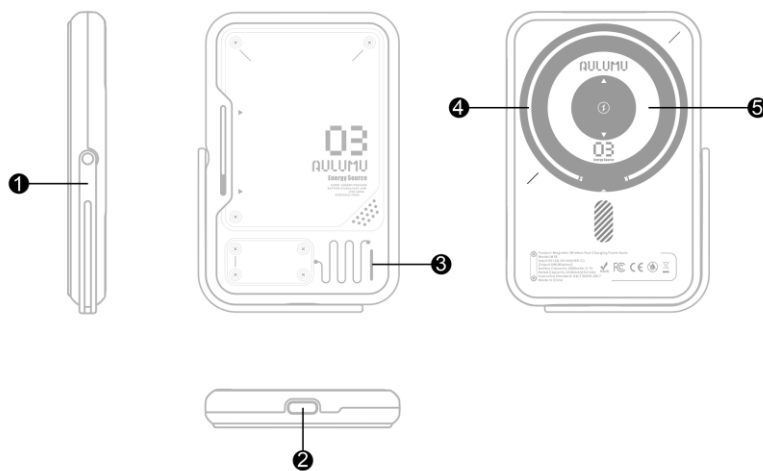

1. Metal foldable kickstand, can be unfolded to hold the phone.

2. Type C charging interface
3. Indicator light
4. Magnetic Coil
5. Charging launch coil

## Important Safety Instruction

1. While using this product, basic precautions should always be followed, or will cause fire, electric shock, or charging devices damaged. Please do not drop or disassemble this product, or store product in hot or humid environment.
2. Please keep this product away from kids to avoid dangerous.
3. Suggestion: Please charge this product fully while the first time of using it.
4. If this product is not used for long periods of time, please kindly charge and discharge it at least one time once every two months.
5. To expand service time, please charge it before run out of power.
6. Do not disassemble this product, or crash it or put into fire or water.
7. Do not remodel this product.
8. If found battery swollen, leakage or smelly, please stop use it at once.
9. Please keep away from water.

**NOTE:** Before charge device, please check if the cable or interface is normal or not. If can't charge, might because there is abnormal while using it, and the built-in IC enable short circuit protection. To use it normally, please charge the power bank to disable the protection.

FCC statement:

This device complies with Part 15 of the FCC rules. Operation is subject to the following two conditions: 1) this device may not cause harmful interference, and 2) this device must accept any interference received, including interference that may cause undesired operation.

Note: This equipment has been tested and found to comply with the limits for a Class B digital device, pursuant to part 15 of the FCC Rules. These limits are designed to provide reasonable protection against harmful interference in a residential installation.

This equipment generates uses and can radiate radio frequency energy and, if not installed and used in accordance with the instructions, may cause harmful interference to radio communications. However, there is no guarantee that interference will not occur in particular installation. If this equipment does cause harmful interference to radio or television reception, which can be determined by turning the equipment off and on, the user is encouraged to try to correct the interference by one or more of the following measures:

- Reorient or relocate the receiving antenna.
- Increase the separation between the equipment and receiver.
- Connect the equipment into an outlet on a circuit different from that to which the receiver is connected.
- Consult the dealer or an experienced radio/TV technician for help.

Changes or modifications not expressly approved by the party responsible for compliance could void the user's authority to operate the equipment.

Radiation Exposure Statement

This device complies with FCC RF radiation exposure limits set forth for an uncontrolled environment. This transmitter must not be co-located or operating in conjunction with any other antenna or transmitter. During the operation of device a distance of 0 cm surrounding the device and 0 cm above the top surface of the device must be respected.