

**PICKFUN**

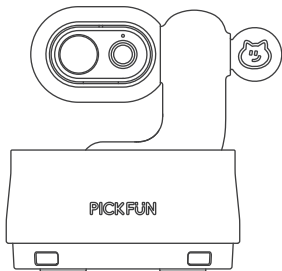

**Smart P0  
PICKFUN AI PET COMPANION  
USER MANUAL**

# I. Product Info

P0 is the initial AI pet companion in the PICKFUN product lineup. It features a 5-megapixel camera, 2K real-time video, 350° horizontal smart pet tracking, continuous monitoring, and video playback capabilities.

## 1.Packing List



- Pickfun AI Pet Companion x1



- Power Adapter x1



- Post-Purchase Support Card x1



- User Manual x1

## 2. Product Structure

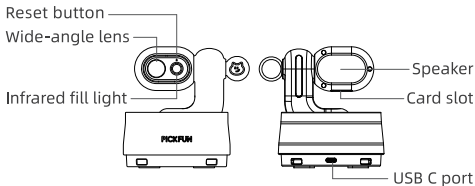

## II. Setup Instructions

### 1. Download the APP

Look for "Pickfun" in the Google Play Store or iOS App Store to download and install the PickFun app.

### 2. Power On

To turn on the PickFun P0 device, connect the provided power adapter. Please avoid using this adapter for charging other electronic devices, such as mobile phones. After you turn it on, the device will conduct a power-on self-test (POST). Once this test is finished, the device will be in a waiting state for connections, and the indicator light will alternate between red and green.

### 3. Connection

1) Click 'Add Device' button or 'QR Code' icon on 'Mine' page in PickFun app.

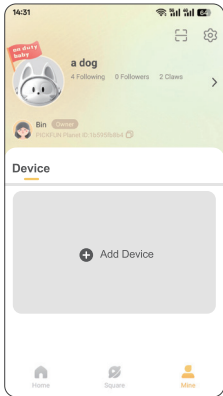

2) Scan the QR code at the bottom of the PickFun P0 device.



**3) Wait for device's LED lights until they start blinking in red and green.**

14:34

**Prepare the device**

1 Power the device

2 Wait for device self-check

3 Observe if the red and green indicator lights are blinking alternately

The red and green indicator lights are blinking alternately

Next step

**4) Enter the Wi-Fi name and password, and click 'Next'.**

14:34

**Device Connection**

**Select the Wi-Fi of the device**

Connection to 5G Wi-Fi works better

change

Wi-Fi password entry error is one of the most common causes of failure, please double check the Wi-Fi password

Next step

5) Please hold on while the device sets up the network.

6) The device will state that the network setup is successful, and the app will show a message confirming that the device is connected.

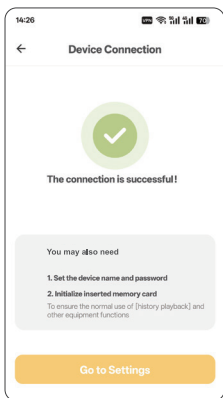
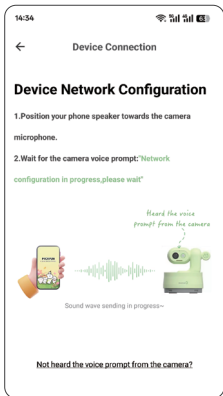

## 4. Indicator Light Status Description

**Yellow light: Power on**

**Red and green light alternating: Awaiting network setup**

**Green light: Working**

**Red light: Offline**

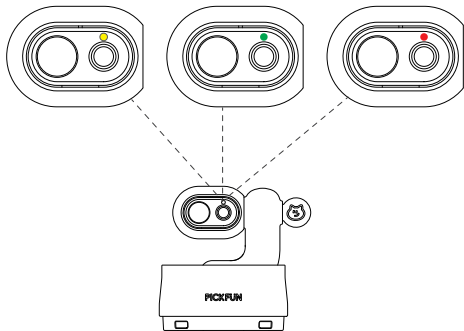

### **III. Main Features**

#### **1. Real-time Monitoring**

Once the device is added to the app, you can access the monitoring screen to see live images, manually adjust the camera lens, and participate in two-way communication.

#### **2. History Playback**

When a memory card is inserted into P0, it can play back recordings. The length of these recordings is determined by the memory card's capacity. If the memory card runs out of storage space, it will replace the oldest files continuously.

#### **3. Privacy Protection**

You can adjust the sleep time for device P0 using the PickFun app. When in sleep mode, the camera lens will be automatically covered to ensure user privacy.

#### **4. Device Sharing**

P0 allows the device to be linked to a single account, but it can be accessed by up to four different accounts for shared camera viewing.

#### **5. Password Protection**

P0 enables users to set a device password within the app. After it's set, the password is necessary for accessing real-time monitoring and playback of recordings, providing security for the user.



## IV. Specifications

Specifications	
Product Name	PICKFUN P0 AI Pet Companion
Product Model	Smart P0
Net Weight	400g
Working Temperature	0°C~40°C ( Recharge,discharge )
Storage Temperature	-10°C~50°C
Lens Angle	90°
Resolution	1080P
Power Input	12V=1.5A
Video Encoding	H.265
Dimensions	118×100×114.5mm
System Required	Android 5.0 or iOS10.0 and above
Local Storage	Supported
Implementation Standard	GB8898-2011
Wireless Connection	802.11n150Mbps WiFi

## Specifications

Number of Fill Lights	1 pcs
Focal Length	Lens: 3.0mm
Pixels	5MP
Privacy Protection	Automatically hide the camera under custom conditions
Zoom	Not support
Night Vision	Support
Category	Home PTZ
Storage Method	TF card
Tracking Method	PTZ tracking
Internet Connection	Wireless WIFI
APP Control	Horizontal+Vertical
DVR Connection	Not support DVR connection
Steering Angle	Horizontal: 350°; Vertical: 90°

## **V. Cautions**

- **Power Adapter Specification:** This product needs a 12V/1.5A power adapter. This adapter is specifically made for this product and shouldn't be used to charge mobile phones or other devices.
- **Safety Reminder:** The power adapter is for adult use. It should be used by children only when an adult is present.
- **Wi-Fi Signal Requirement:** Make sure the device is used within the coverage area of a wireless Wi-Fi signal.
- **Electromagnetic Interference:** Keep the device away from strong sources of electromagnetic radiation to avoid any interference.
- **Sunlight Exposure:** Keep the device out of direct sunlight to avoid it getting too hot.
- **Obstructions:** Make sure there are no items blocking the device's field of view or affecting its performance.
- **Environmental Conditions:** Avoid positioning the device outside or in areas with extreme temperatures, high humidity, or strong sunlight.

## VI. Hazardous Substances Content by Component

This form has been created following SJ/T 11364 regulations, outlining the hazardous substances found in our product's components. The symbols in this table are explained as follows:

Component	Table of Hazardous Substances Content					
	Lead (Pb)	Mercury (Hg)	Cadmium (Cd)	Hexavalent chromium (CrVI)	Polybrominat- ed biphenyls (PBB)	Polybrominated diphenyl ethers (PBDE)
PCBA	×	○	○	○	○	○
Power adapter	×	○	○	○	○	○
Housing	○	○	○	○	○	○
Gaskets, tapes and other small structural parts	○	○	○	○	○	○

○: Shows that the amount of the specified hazardous substance in all uniform materials within the component meets the standards established by GB/T 26572.

×: Shows that the amount of the specified hazardous substance is above the limits set by GB/T 26572 in at least one uniform material within the component.

## **VII. Non-warranty Scope**

The warranty does not cover the following situations:

- Unauthorized maintenance
- Misuse, collision, negligence, or abuse of the product
- Liquid damage or accidents
- Use of accessories not designed for this product
- Removal or alteration of labels and anti-counterfeiting marks

Furthermore, the warranty is not applicable in these cases:

- After the 1-year warranty period from the purchase date has ended
- Product failure due to external factors like impact or pressure
- Damage from force majeure events (extreme and unexpected situations beyond the manufacturer's control)
- Damage or defects in product accessories.

## VIII.Warranty Claim Card

Customer Name		Contact Number	
Purchasing Date		Model No.	
Name of Dealer			
Reason for Repair			

If you require after-sales service, feel free to contact [service@pick-fun.com](mailto:service@pick-fun.com) or call the Tommi Service Hotline at +86 400-689-2108.

**Manufacturer:** Chengdu Tommi Technology Co., Ltd.

**Address:** 14th Floor, Building 6, No. 399, West Section of Fucheng Avenue, High-tech Zone, Chengdu

## FCC WARNING

This device complies with part 15 of the FCC Rules. Operation is subject to the following two conditions: (1) this device may not cause harmful interference, and (2) this device must accept any interference received, including interference that may cause undesired operation.

Any changes or modifications not expressly approved by the party responsible for compliance could void the user's authority to operate the equipment.

NOTE: This equipment has been tested and found to comply with the limits for a Class B digital device, pursuant to Part 15 of the FCC Rules. These limits are designed to provide reasonable protection against harmful interference in a residential installation. This equipment generates, uses and can radiate radio frequency energy and, if not installed and used in accordance with the instructions, may cause harmful interference to radio communications.

However, there is no guarantee that interference will not occur in a particular installation. If this equipment does cause harmful interference to radio or television reception,

which can be determined by turning the equipment off and on, the user is encouraged to try to correct the interference by one or more of the following measures:

- Reorient or relocate the receiving antenna.
- Increase the separation between the equipment and receiver.
- Connect the equipment into an outlet on a circuit different from that to which the receiver is connected.
- Consult the dealer or an experienced radio/TV technician for help.

To maintain compliance with FCC's RF Exposure guidelines, This equipment should be installed and operated with minimum 20cm distance between the radiator and your body: Use only the supplied antenna.