

SPECIFICATIONS

SYSTEM:

- ① Frequency preparation: PLL
- ② Frequency range: Optional (60 frequencies for selection)
- ③ AF Response: 80Hz~15KHz(± 3 dB)
- ④ Distortion: $\leq 1\%$
- ⑤ Operating Temperature Range: $-10^{\circ}\text{C} \sim +40^{\circ}\text{C}$

RECEIVER :

- ① Sensitivity: 12dB μV (80dB S/N)
- ② Sensitivity adjust range: 12~32dB μV
- ③ Audio output level: 0~0.5V/600 Ω
Audio output: 0~0.5V/5k

TRANSMITTER :

- ① RF output power: 11mW (10mW~30mW)
- ② Spurious rejection: < -50 dB
- ③ Battery: 2*1.5V AA (common)
2*1.2V AA(rechargeable)
- ④ Cartridge: dynamic

Hiberr®

PROFESSIONAL WIRELESS MICROPHONE SYSTEM

USER'S MANUAL

YU-E20

OPERATING INSTRUCTIONS

Please read the instruction manual carefully before operating the appliance and keep the instruction manual properly.

TROUBLESHOOTING

PROBLEM	POSSIBLE CAUSE	SOLUTION
The unit is dead	*Piece suddenly goes dead *No power supply	*Check the power supply *Connect power adapter
No reception	*Transmitter is not switched ON *Transmitter and receiver don't work though all LEDs and connections seem ok	*Switch ON the transmitter *Make sure that the transmitter and receiver are on the same frequency *Receiving antennas are not pulled out, extend the antennas
The hand mic is not working	*2x1.5V battery inserted wrong *2x1.5V battery is weak	*Reverse the Polarity *Reverse the battery
Distorted sound	*Input Gain of the Amplifier or Mixer very high *Gain on the hand mic is too high	*Reduce the gain in the Mixer or Amp and adjust the volume control on the transmitter *Reduce the gain in the Hand mic
No "RF" signal on the receiver	*Transmission distance between the transmitter and receiver is very far *Defective or broken antenna *Transmitter and receiver have different frequencies	*Reduce the distance between transmitter and receiver *Check antenna and replace it if necessary *Make sure the transmitter and receiver are of the same frequency
Noise / Distortion	*Two transmitters using the same frequency interference from other transmitter *Battery of the transmitter is weak	*Switch off the other transmitters *Avoid using two transmitter of the same frequency *Replace the battery

IMPORTANT NOTICE

- Please kindly read and keep this manual carefully.
- Take attention of the full items show on the manual.
- Must cut off the power while cleaning the equipment.
- It is better using the original accessories, such as adapter and cable.
- While it is thunderstorm weather or don't use the equipment for a long time, please unplug the receiver from equipment.
- Do not place the receiver and transmitter near the source of heat, such as radiator, oven and also keep them away from water.

CLEANING AND MAINTENANCE

- Do not spill the liquid into the device, otherwise it will damage the electronic components of the device.
- Disconnect the power before cleaning
- Clean the device with a soft cloth.
- No solvent or cleaner is allowed for cleaning.

contact details

WEB: www.hiberr.com

Facebook: <https://www.facebook.com/hiberr.mic>

E-Mail: service@hiberr.com

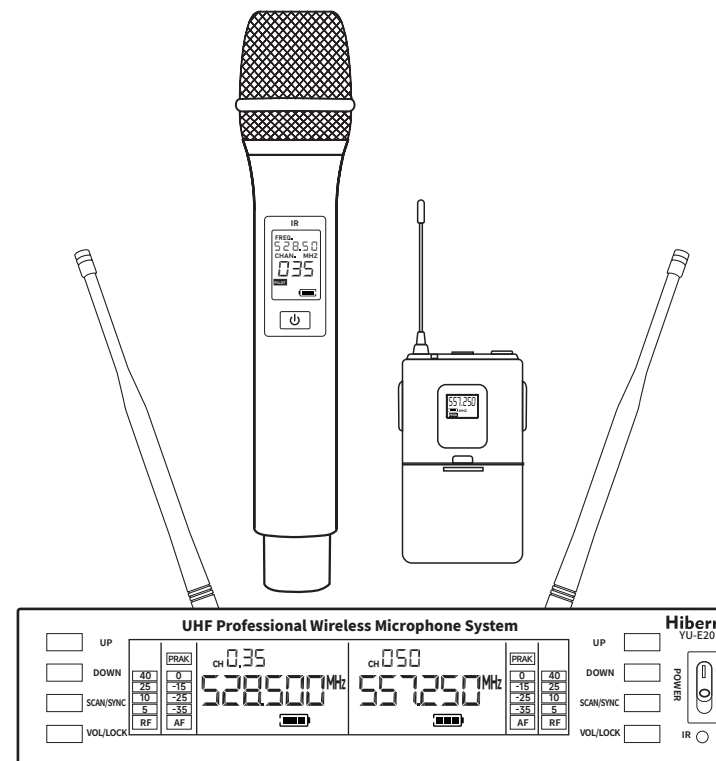

FEATURES

FRONT PANEL

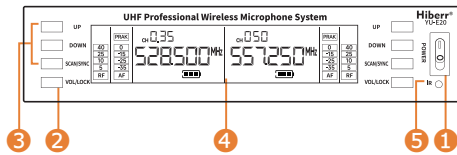

- ① Power Switch
- ② Lock/Unlock
- ③ Manually set the frequency Automatic frequency selection

REAR PANEL

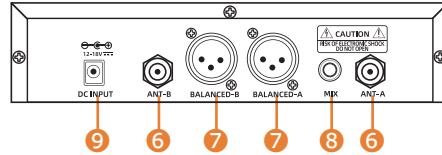

- ④ LCD Screen
- ⑤ Sync
- ⑥ Antenna Jack A/B
- ⑦ XLR Output Jack A/B
- ⑧ 1/4" Output Jack
- ⑨ AC Adapter Jack

一、LOCK: PRESS AND HOLD THE ② VOL/LOCK BUTTON (ABOUT 3 SECONDS)

the receiving host will enter the locked state (the screen of the receiving host will display a lock symbol).

Note: After locking, the system cannot adjust the frequency.

二、UNLOCK: WHEN THE RECEIVING HOST IS LOCKED

press and hold the ② VOL/LOCK button (about 3 seconds) to unlock (the screen lock symbol of the receiving host disappears).

三、MANUALLY SET THE FREQUENCY③:

1. Press UP or DOWN to select target frequency;
2. Press the SCAN / SYNC to confirm the selected frequency;
3. Press the SCAN / SYNC again to enter the sync frequency interface (The receiving host will display the IR-----);
4. Align the infrared window of the transmitting and the receiving host (about 3cm to 7cm). When the frequency displayed of the transmitter and the receiving host same, the synchronization is successful.

四、AUTOMATIC FREQUENCY SELECTION③:

1. Press and hold the SCAN / SYNC (about 3 seconds) to enter the automatic frequency selection mode (the frequency number on the receiving host screen is changing), the system will scan all channels;
- Note: If you want to stop the program during scanning, please press the SCAN / SYNC .
2. After the scan is completed, the receiving host screen will display the optimal communication frequency, press SCAN / SYNC to enter the synchronization frequency interface (The receiving host will display the IR-----);
3. Align the infrared window of the transmitting and the receiving host (about 3cm). When the frequency displayed of the transmitter and the receiving host same, the synchronization is successful.

五、VOLUME ADJUSTMENT②③:

1. Press the VOL/LOCK key to switch to the volume adjustment interface;
2. Press the UP or DOWN button to adjust the volume;
3. Press the SCAN / SYNC key to confirm the volume setting.

FEATURES

HANDHELD TRANSMITTER

- ① Interchangeable Microphone Head
- ② Handheld Body
- ③ LED Display
- ④ On-off Switch
- ⑤ Battery Case
- ⑥ Infrared receiving window

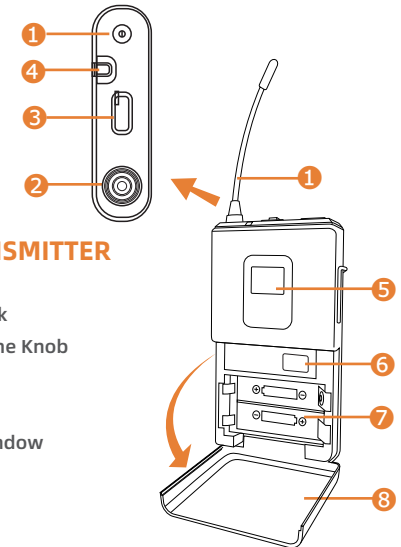
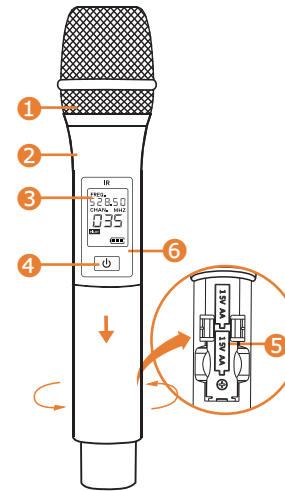

BODYPACK TRANSMITTER

- ① Antenna
- ② Microphone Input Jack
- ③ Power Switch / Volume Knob
- ④ Power Indicator
- ⑤ LED Display
- ⑥ Infrared receiving window
- ⑦ Battery Case
- ⑧ Battery Case cover

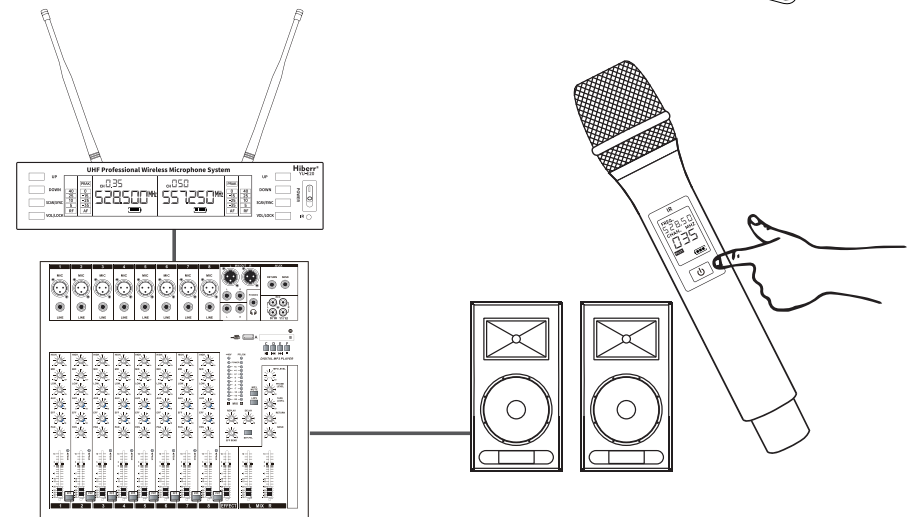

FCC Statement

This equipment has been tested and found to comply with the limits for a Class B digital device, pursuant to part 15 of the FCC Rules. These limits are designed to provide reasonable protection against harmful interference in a residential installation. This equipment generates, uses and can radiate radio frequency energy and, if not installed and used in accordance with the instructions, may cause harmful interference to radio communications. However, there is no guarantee that interference will not occur in a particular installation. If this equipment does cause harmful interference to radio or television reception, which can be determined by turning the equipment off and on, the user is encouraged to try to correct the interference by one or more of the following measures:

- Reorient or relocate the receiving antenna.
- Increase the separation between the equipment and receiver.
- Connect the equipment into an outlet on a circuit different from that to which the receiver is connected.
- Consult the dealer or an experienced radio/TV technician for help.

Caution: Any changes or modifications to this device not explicitly approved by manufacturer could void your authority to operate this equipment.

This device complies with part 15 of the FCC Rules. Operation is subject to the following two conditions: (1) This device may not cause harmful interference, and (2) this device must accept any interference received, including interference that may cause undesired operation.

RF Exposure Information

The device has been evaluated to meet general RF exposure requirement. The device can be used in portable exposure condition without restriction.