

## RC Car Introduction

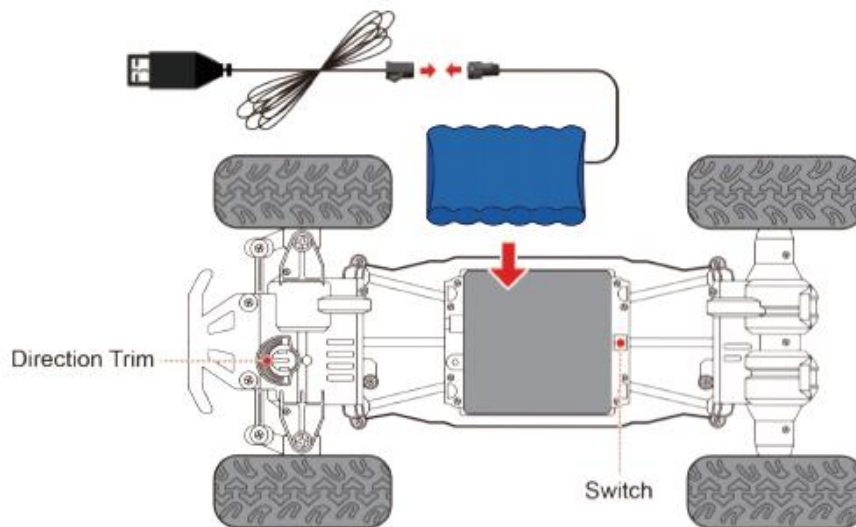

## Install Introduction



Step 1: Take out all assembly. A is a part needed for the car wheels, B is parts of the front anticollision piece.



Step 2: Put the hub into the lower cavity of the tire.



Step 3: Buckle these four wheels into car body in turn.



Step 4: Screw the tire into the car body and screw in the buckle, and then complete tire assembly.



Step 5: Buckle the front anticollision piece into the bottom of front of the car body and screw in the buckle.



Step 6: Please double check this diagram whether the installation is correct.

## Controller Introduction

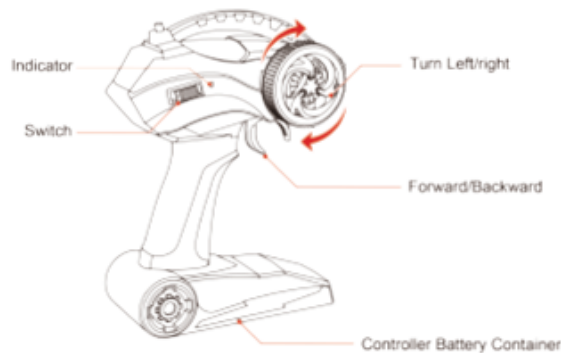

### Battery Caution:

1. Please do not over discharge or over charge the battery.
2. Please do not use new and old batteries together or different types batteries.
3. The battery must be replaced when it's broken or leaking.
4. Please wash immediately once your skin or clothes touched the liquid from the battery.
5. Keep batteries away from fire and heat resource.
6. If you do not play for a long time, please remove the battery.

### Caution:

1. Please follow the right instruction to play this product.
2. Avoid rough use such as knocking the product or swinging it around.
3. Children under 3 years old are not recommended to play.
4. This product contains small parts which may cause suffocation if swallowed by children.

### FCC Warning Statement

Changes or modifications not expressly approved by the party responsible for compliance could void the user's authority to operate the equipment. This equipment has been tested and found to comply with the limits for a Class B digital device, pursuant to Part 15 of the FCC Rules.

These limits are designed to provide reasonable protection against harmful interference in a residential installation. This equipment generates uses and can radiate radio frequency energy and, if not installed and used in accordance with the instructions, may cause harmful interference to radio communications. However, there is no guarantee that interference will not occur in a particular installation. If this equipment does cause harmful interference to radio or television reception, which can be determined by turning the equipment off and on, the user is encouraged to try to correct the interference by one or more of the following measures:

- Reorient or relocate the receiving antenna.
- Increase the separation between the equipment and receiver.
- Connect the equipment into an outlet on a circuit different from that to which the receiver is connected.
- Consult the dealer or an experienced radio/TV technician for help.