

User Manual

Doorbell Chime - LDC01

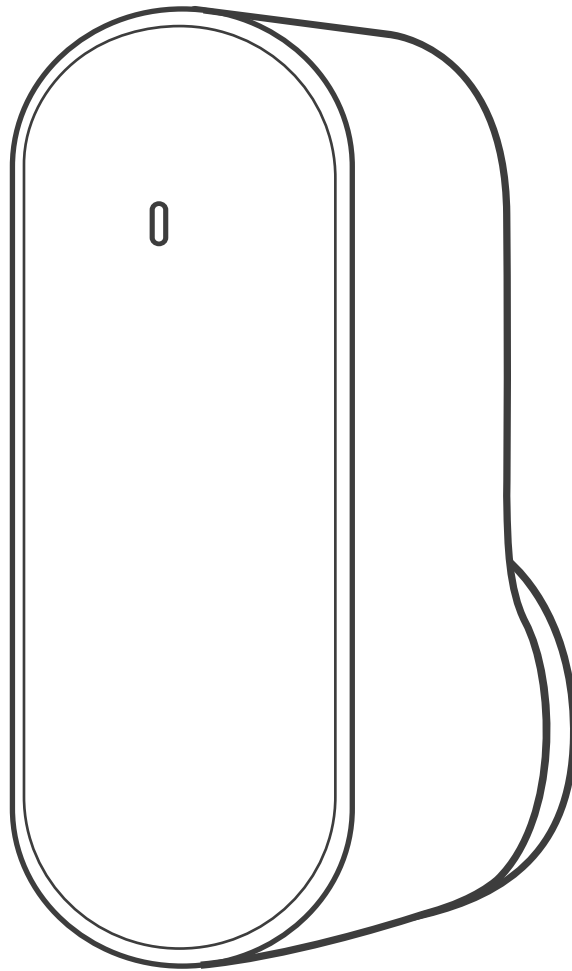

1. WHAT'S INCLUDED

For Video Doorbell Installation

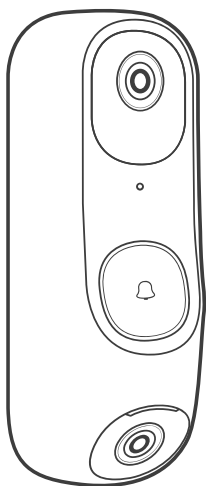

Dual-Cam
Video Doorbell
(Model : LVD01)

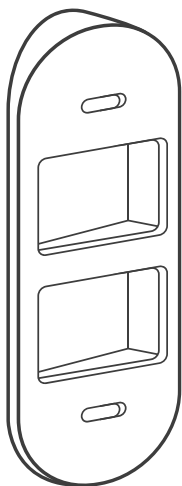

15° Mounting Wedge
(Optional)

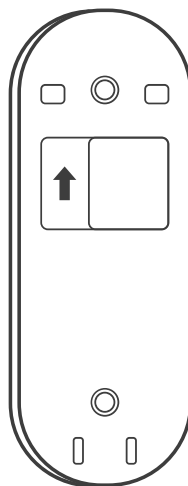

Mounting Bracket

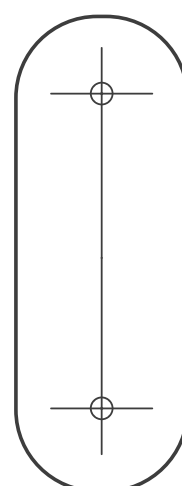

Screw Hole
Positioning Card

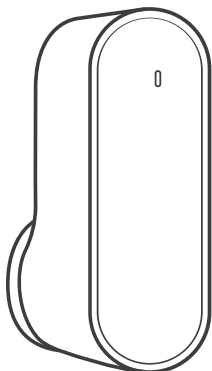

Doorbell Chime
(Model : LDC01)



Doorbell
Detaching Pin

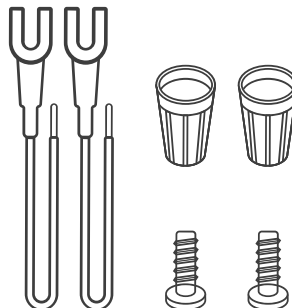

Extension Wires and
Wire Nuts (Optional)

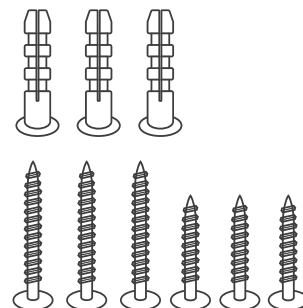

Screw Packs

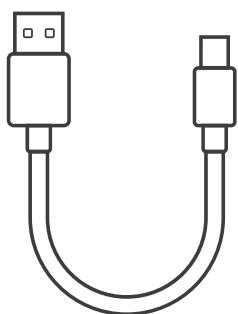

USB-C Charging Cable

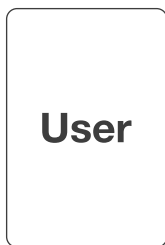

User Manual

Doorbell Chime

Front View:

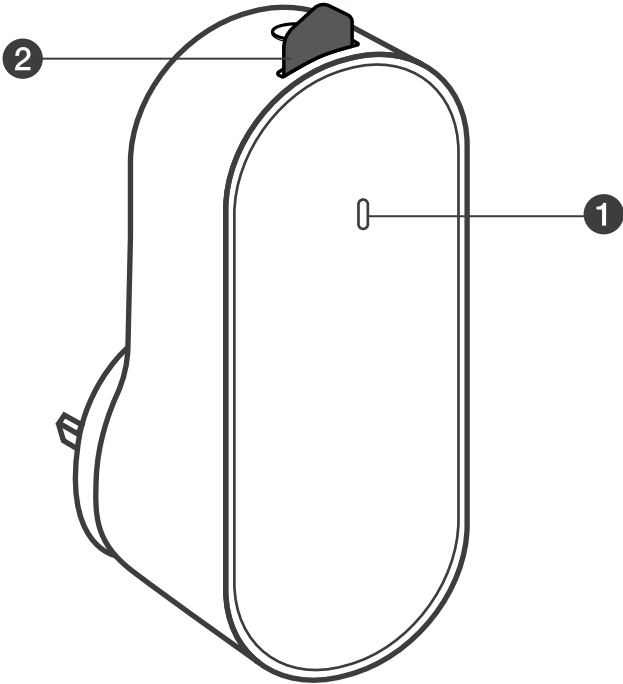

- 1. Chime LED Ring
- 2. Doorbell Detaching Pin

Rear View:

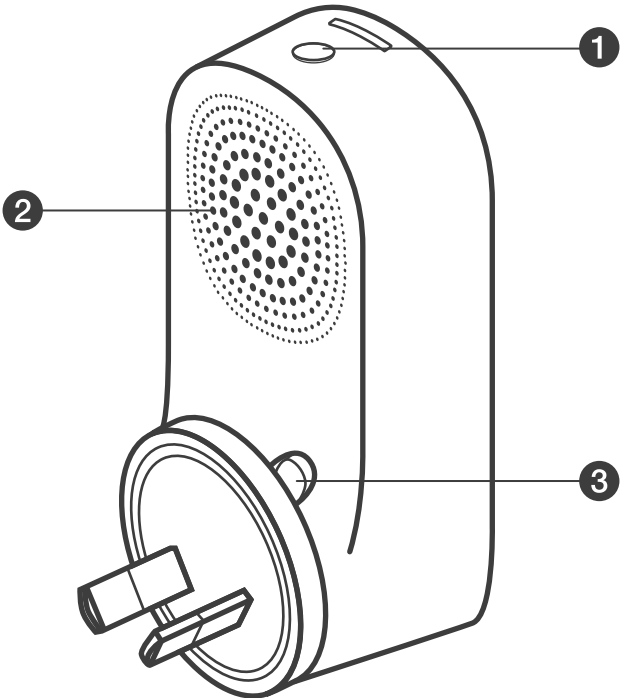

- 1. Chime Button
- 2. Chime Speaker
- 3. Plug Transfer Button

2. HOW THE SYSTEM WORKS

How the System Works

The video doorbell system includes 2 parts. One is the video doorbell at your door. The other is the Chime in your house.

The video doorbell detects motion at your porch and allows you to answer the door anytime and anywhere. When someone rings the doorbell, people in the house will be notified by the Chime.

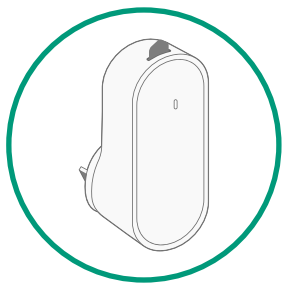

Doorbell Chime

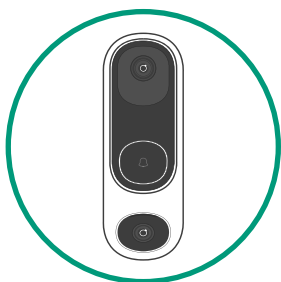
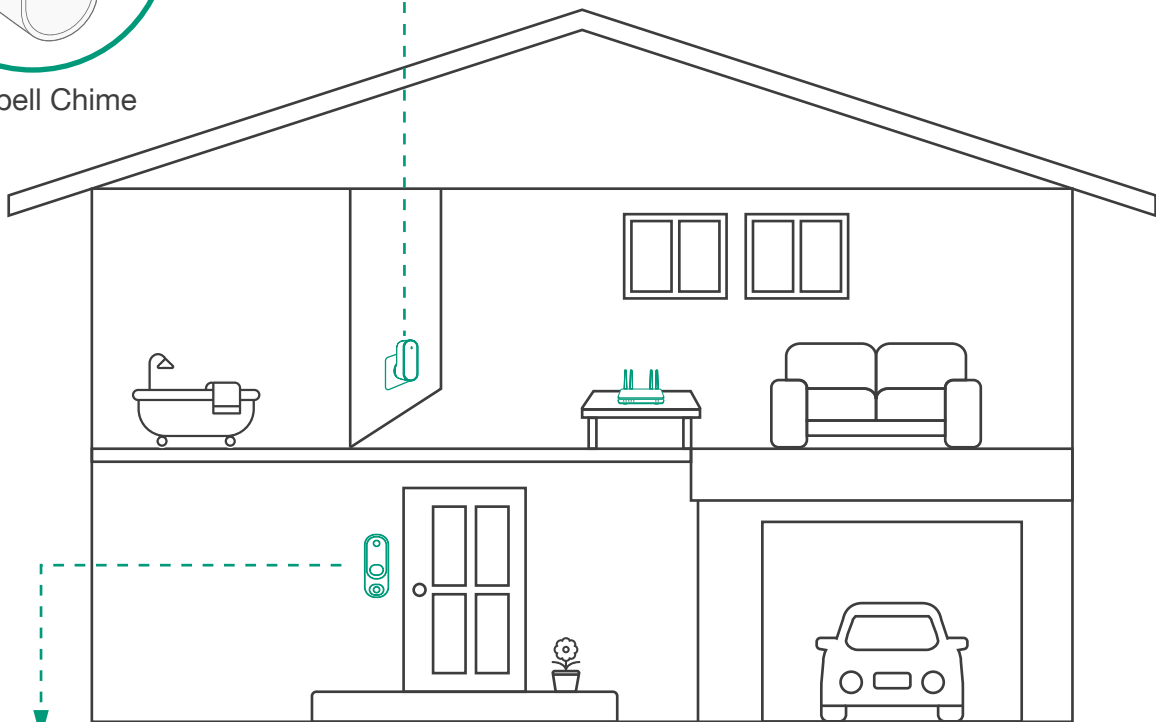

Dual-Cam
Video Doorbell

3. Add Device

Plug the chime into the power socket

1. Install the power pin into the chime body as pictured.
2. Plug it into a power socket where you want the chime to ring and wait for the LED to turn red.

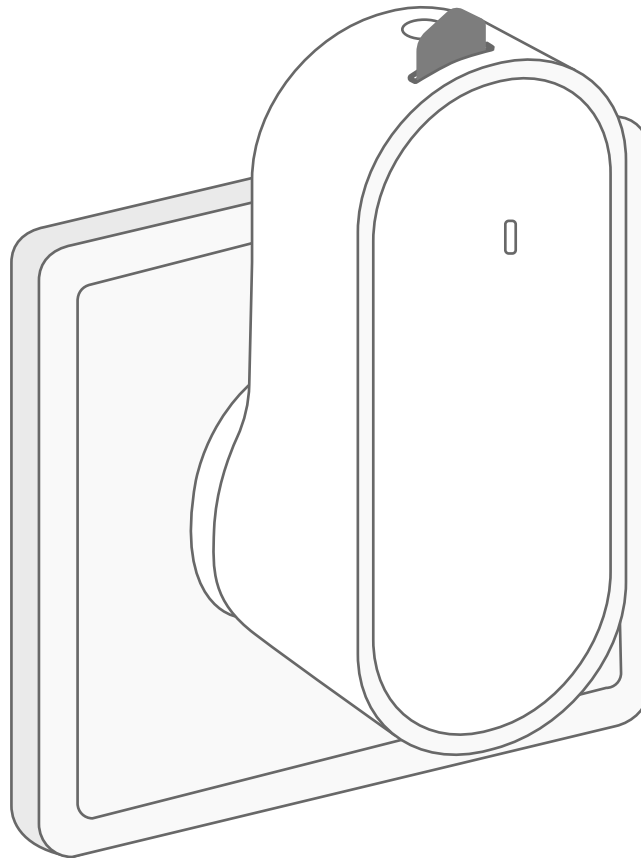

4. DETACH THE DOORBELL

Detach the Doorbell

What you need: Doorbell Detaching Pin

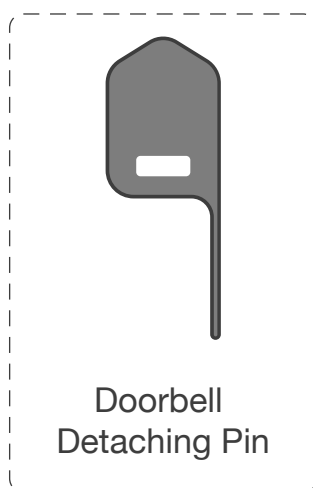

Step1

Take the doorbell detaching pin out from the top of doorbell chime.

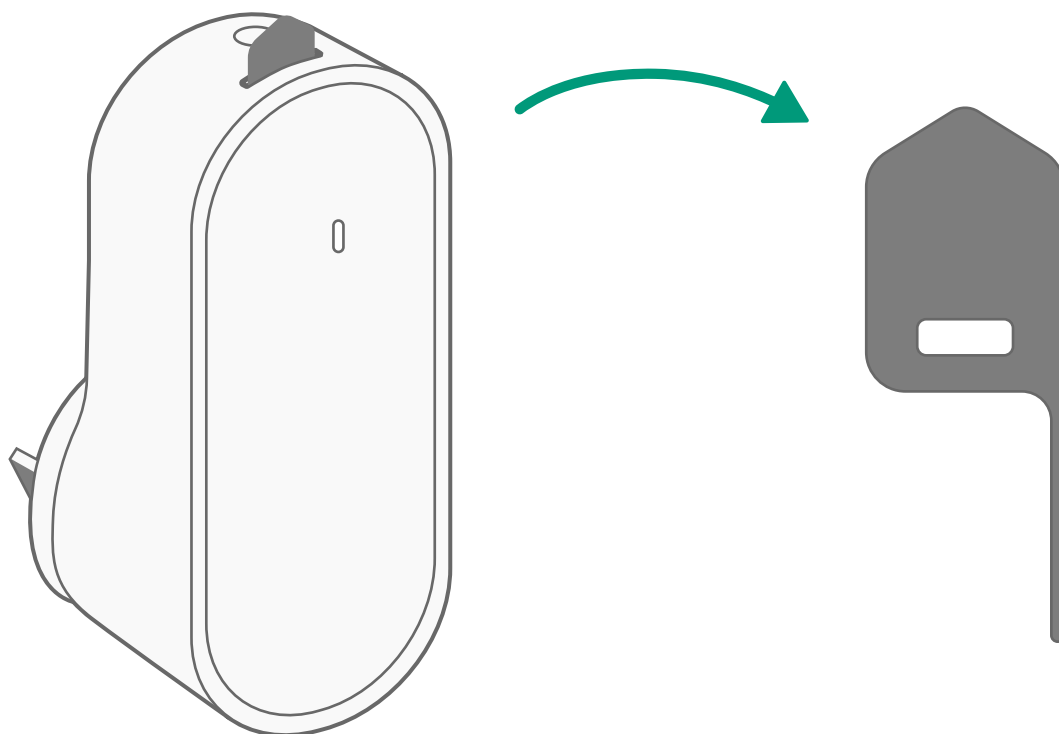

Step2

Press the pin into the pinhole on the bottom of the doorbell, pull the bottom away from the bracket, and lift the doorbell for removal.

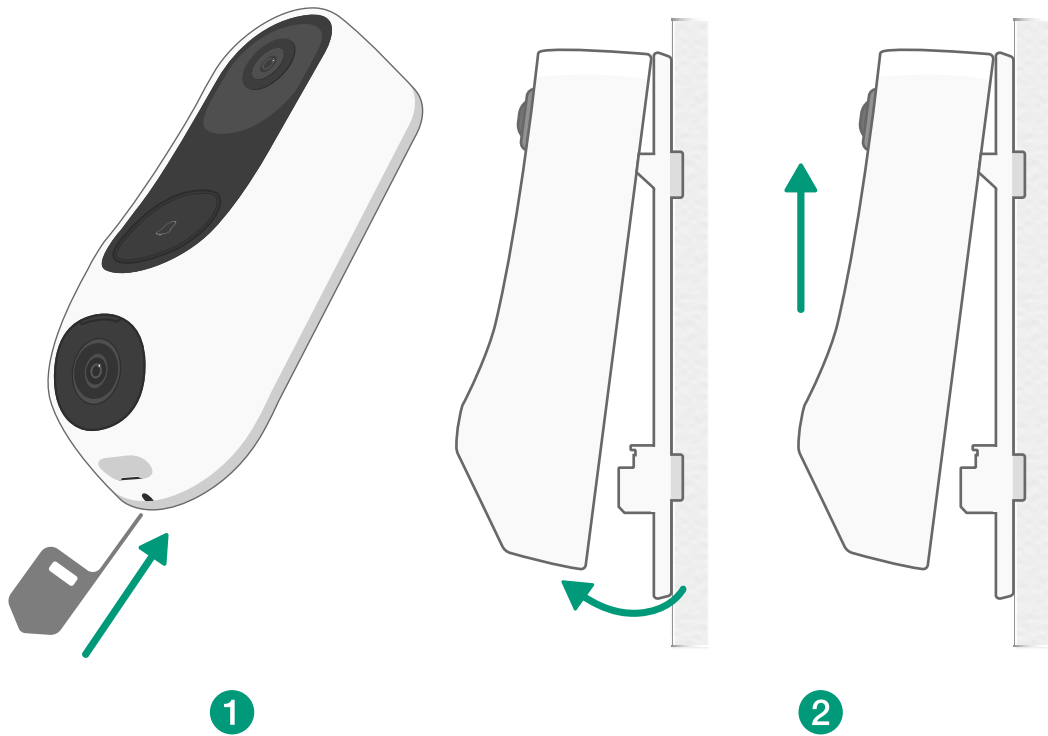

Step3

Put the detaching pin back to the top of the chime.

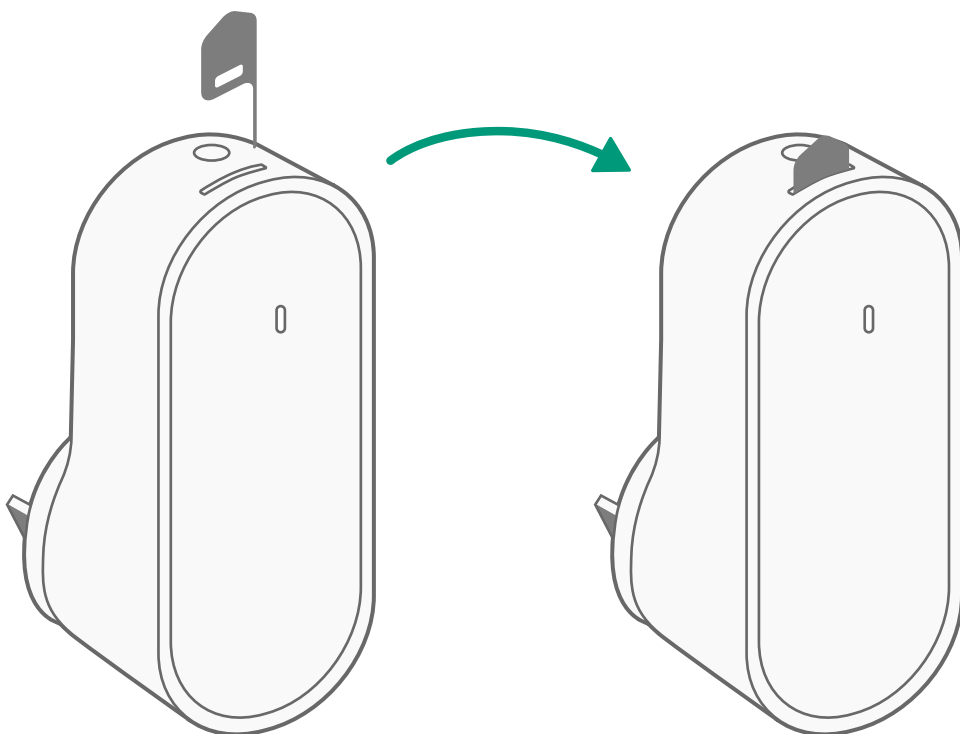

5. NOTICE

FCC Statement

This device complies with Part 15 of the FCC Rules. Operation is subject to the following two conditions:

- (1) This device may not cause harmful interference, and
- (2) This device must accept any interference received, including interference that may cause undesired operation.

Warning: Changes or modifications not expressly approved by the party responsible for compliance could void the user's authority to operate the equipment.

NOTE: This equipment has been tested and found to comply with the limits for a Class B digital device, pursuant to Part 15 of the FCC Rules. These limits are designed to provide reasonable protection against harmful interference in a residential installation. This equipment generates uses and can radiate radio frequency energy and, if not installed and used in accordance with the instructions, may cause harmful interference to radio communications. However, there is no guarantee that interference will not occur in a particular installation. If this equipment does cause harmful interference to radio or television reception, which can be determined by turning the equipment off and on, the user is encouraged to try to correct the interference by one or more of the following measures:

Reorient or relocate the receiving antenna.

Increase the separation between the equipment and receiver.

Connect the equipment into an outlet on a circuit different from that to which the receiver is connected.

Consult the dealer or an experienced radio/TV technician for help.

FCC Radiation Exposure Statement

This equipment complies with FCC radiation exposure limits set forth for an uncontrolled environment. This equipment should be installed and operated with minimum distance 20cm between the radiator and your body.

Customer Service

Warranty

12-month limited warranty