

STEAMBOX

Bye microwave.

Bye boring sandwich.

Bye unhealthy takeout.

Hello freedom.

A hot meal anywhere, anytime.

Full control of *what* you eat, *when* you eat and *where* you eat. That's what we call *Freedom of Food*. Our self-heating lunchbox is designed in The Netherlands and made for food lovers all across the globe. Thank you for joining our community – Bon Appétit!

Steamy regards,
Team Steambox 🔥



SCAN TO WATCH OUR
QUICKSTART VIDEO.

[STEAM-BOX.COM/QUICKSTART](https://steam-box.com/quickstart)

Features



Rechargeable

Use up to 3x on a single charge



Steam

Fast and tasty method for reheating food



Leak-proof

Leak- and dishwasher-proof food container



Safe

Safe to use and travel friendly



App-connected

Use the app to control Steambox (iOS & Android)



Natural design

100% natural bamboo & food grade materials

What's in the Box



Steambox



**Food
container**



**Water
container**

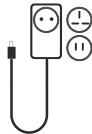

Charger

Controls Explained

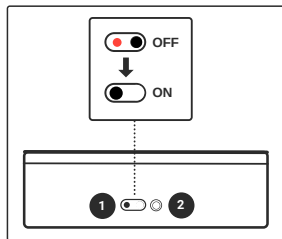

Back

- 1. On-off switch
- 2. Charging port

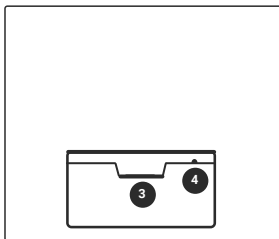

Side

- 3. Snap fits (2x) - *always* pull both snap fits at the same time (otherwise they might break)
- 4. Steam outlets (2x)

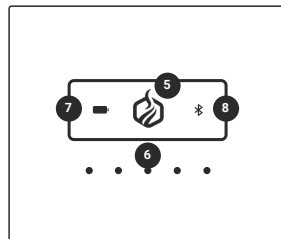

Front

- 5. Main button (touch)
- 6. Timer button (touch)
- 7. Battery indicator - appears when you have 1 cycle left, blinks when battery is critical.
- 8. Bluetooth indicator

Getting Started

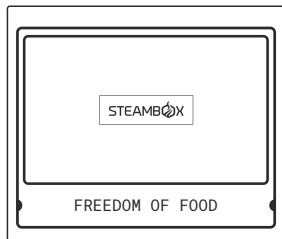

Inspect

Remove all packaging materials and make sure all items are in good condition.

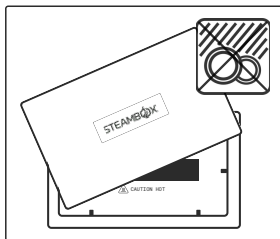

Clean body & bamboo lid

Wipe the body and bamboo lid clean with a damp cloth. These are **NOT** dishwasher proof.

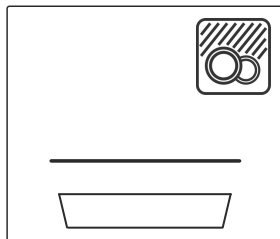

Clean food container & silicone seal

Clean the food container and silicone seal with warm soapy water. Both are also dishwasher proof.

How to Charge

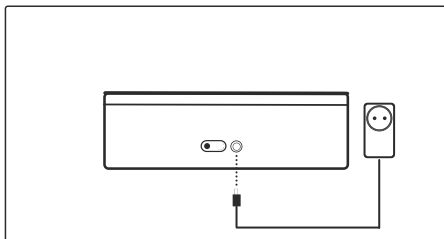

Charging

Only charge Steambox using the provided charger. A full 0% - 100% charge takes approximately 3 hours.

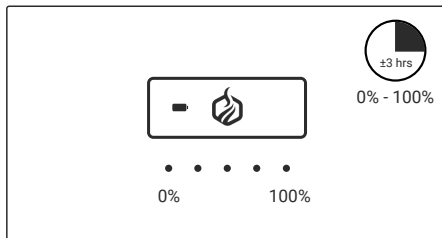

Charging indicator

Each bullet represents $\pm 20\%$ of charged battery. When 5 bullets *and* the battery icon light up during charging, Steambox is fully charged.

How to Steam

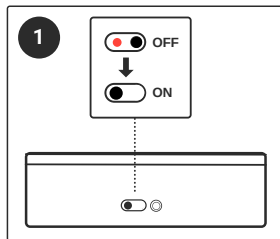

SWITCH - Turn on Steambox through the switch on the back. Make sure it's charged before use!

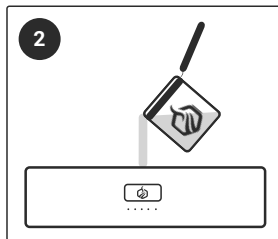

WATER - Remove the food container and pour 35ml (1,2oz) of water onto the heating element using the provided water container. Leave the water container outside of Steambox during steaming.

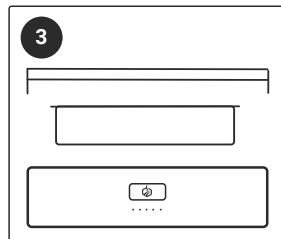



FOOD - Insert the food container back into Steambox *without* the silicone seal. Close Steambox by putting the bamboo lid on top and pressing it downwards.

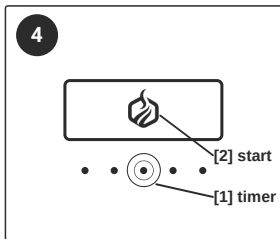

TIP - Fill up your water container before travelling.



STEAM - [1] Tap the  to select steaming time. Each bullet represents 5 minutes of steaming (an average meal takes 20 mins.). [2] Tap the  to start steaming. It will start pulsing during the steaming process.



NO WATER = orange logo.
Add enough water (35ml).

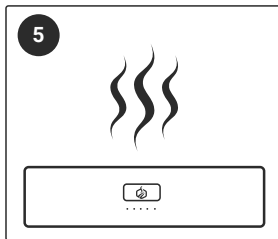

EAT - Once steaming has been completed, switch off Steambox through the switch on the back. Wait at least 1 minute before opening, then carefully remove the bamboo lid. It's now time to eat, bon appetit!



CAUTION - be careful with hot surfaces and steam.



WHY READ
IF YOU CAN
WATCH?

[STEAM-BOX.COM/QUICKSTART](https://steam-box.com/quickstart)

Steambox App

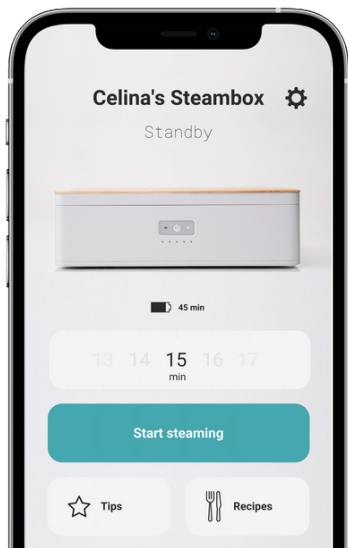

UNLOCK YOUR
FULL POTENTIAL

[STEAM-BOX.COM/APP](https://steam-box.com/app)



Steambox App

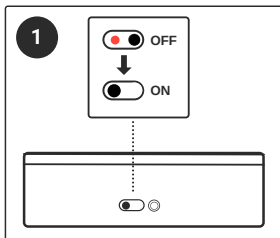

SWITCH - Turn on Steambox through the switch on the back. Make sure it's charged before use!

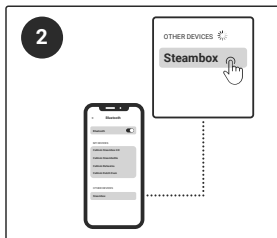

PAIRING - Download and open the Steambox app on your smartphone. Select "Steambox" to start pairing.



CONNECTED - When pairing is successful, the Bluetooth symbol will light up.



TIP - Once paired, Steambox will auto-connect next time.

Cleaning & Maintenance

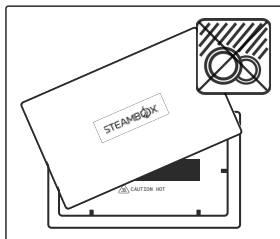

Steambox body & bamboo lid

Clean the body and top lid with a soft damp cloth (without detergents). You can occasionally use mineral oil to treat the bamboo cover. These are **NOT** dishwasher-proof.

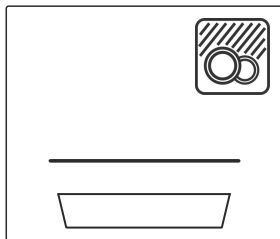

Food container & silicone seal

The food container and silicone seal are dishwasher-proof. Clean like regular dinnerware with soapy water.



CAUTION - not cleaning can lead to health issues.

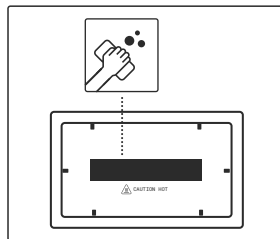

Heating element

Treat limescale on the heating element with a descaler once every other month (more often if needed).



CAUTION - not cleaning can damage Steambox.

Tips

- Make sure to properly close the top lid before you start steaming to avoid steam to escape.
- Cut down large chunks of food (e.g. meat) into smaller pieces for faster and better heating.
- If you have a dense meal, carefully open Steambox during steaming and stir your food for more evenly heated food.
- You can heat up multiple meals on a full charge. So, if you have a long day ahead, make sure to bring an extra food container. Visit www.steam-box.shop to learn more and order extra food containers.
- Food containers can be stored in the fridge. Prep meals for the week at home or store your lunch in a fridge at the office. If you want to heat a refrigerated food container, try taking it out of the fridge about 20 minutes in advance for faster heating!
- If you are not willing to share your delicious food with annoying colleagues at work, make sure to find a nice and quiet place to enjoy your hot and well-deserved lunch. They have chosen boredom, you have not.
- If you are frequently travelling to the same location (like an office), you can choose to leave Steambox at the office and just bring the food container home. Simply wash it, fill it up with food and take it with you the next day.

FAQ

How long should I steam to heat up my meal?

This depends on several factors including meal type, portion size, starting temperature and food density. On average, it takes about 20 minutes to heat up a meal. Try to experiment with different steaming times to find your preferences.

Can I cook raw food with Steambox?

Steambox was primarily designed for reheating (already cooked) food. However, it is possible to cook/steam certain types of food (some type of vegetables are no big deal). Please be careful when cooking raw meats, chicken, or fish with Steambox. We do not recommend this.

Can I heat up frozen meals with Steambox?

It might take a bit longer, but you are able to heat up cooked frozen meals with Steambox.

OMG IS THAT A SELF-HEATING LUNCHBOX?!

Yes.

Can I use Steambox while it is charging?

It is not possible to steam while Steambox is charging. Battery charging and discharging combined with water can be dangerous, which is why Steambox doesn't have this functionality. Fortunately, you have ± 45 minutes of steaming time with a single charge.

Specifications

Steambox

Battery	12.8V 6.000 mAh 76,8Wh
Steaming time	±45 minutes (2-3 meals)
Power	120W
Length	27 cm (10.5 ")
Height	16.5 cm (6.5 ")
Width	9 cm (3.5 ")
Weight	1991 g (4.4 lbs)
Materials	Food grade PCABS & bamboo

Charger







Charger input	Charger input: 110 - 240V ~ 50/60Hz
Charging time	±3 hours
Cable length	1.8m (5' 9")

Food container

Volume	750 ml / 25 oz
Material container	Food grade stainless steel
Material seal	Food grade silicone
Dishwasher-safe	Yes

Specifications

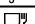
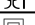
Certifications & symbols

	European Conformity
	Federal Communication Commission
	UL recognized
RoHS	Restriction of hazardous substances
	Read instruction manual
	Keep product dry
	Food safe materials
	Class II appliance
	Don't dispose with regular household waste

Important safety instructions

Please read the following safety instruction carefully before using Steambox. Steambox B.V. does not assume any liability for damage that may occur on account of noncompliance. Use Steambox in accordance with its designated use and for its intended purpose only.

- Read and fully understand all instructions before using Steambox.
- Clean all components before use (see 'Cleaning & Maintenance').
- Make sure Steambox is laid on a flat surface before you start steaming. If Steambox is tilted during steaming, it may shut off due to overheating
- During first use, Steambox might emit an odd smell. This is normal and will disperse within a few minutes.
- Steambox should be cleaned after every use.
- Steambox can be used up to an altitude of 2000m/6562ft above sea level.
- Steambox complies with the safety regulations and directives in effect at the time of manufacturing.
- **CAUTION:** Allow Steambox to cool down before handling any parts and before you start cleaning.
- **CAUTION:** Plug the charger into household electric outlets only (110–240V AC). Always (un)plug by pulling the power plug directly instead of pulling the connector.
- **CAUTION:** Avoid sudden ambient temperature changes while using Steambox.
- **CAUTION:** Be careful when moving Steambox while it contains hot contents or liquids. Otherwise, injuries and/or burns might result.

Important safety instructions

- **CAUTION:** Make sure to always open the top lid of Steambox with 2 hands by gently pulling both snap fits simultaneously. Not doing so may cause the snap fits to break, tear or get damaged.
- **CAUTION:** Be careful when opening the lid during or after use, hot air and steam may escape and could cause injury.
- **CAUTION:** Always allow Steambox to cool completely before cleaning.
- **CAUTION:** Store Steambox away from sources of heat and moisture and out of reach from children and pets.
- **CAUTION:** Always use regular drinkable water for steaming. Never use any type of liquid other than regular drinkable water. If any substance is used other than regular drinkable water, your warranty will no longer be valid.
- **CAUTION:** Ensure that the area between the heating element and food container is always clean and free from any foreign substances (except regular drinkable water). This is important to ensure proper steaming.
- **CAUTION:** Make sure to switch-off Steambox when not in use, especially during travel. Use the on-off switch on the back for this.
- **CAUTION:** Make sure there is enough clearance ($\pm 10\text{cm}$ | $\pm 4"$) between Steambox and other objects while steaming.
- **DO NOT** touch hot surfaces. The outer surface of Steambox may heat up during use.
- **DO NOT** let any other person use this Steambox if they are not familiar with the instructions.
- **DO NOT** move Steambox while steaming. If Steambox is moved during steaming, it may shut off due to overheating.
- **DO NOT** use of any objects that might damage the heating element. A damaged heating element may function less well.
- **DO NOT** place the appliance in or near microwaves or dishwashers (at least 25 centimeters distance).

Important safety instructions

- **DO NOT** let Steambox get in contact with hot surfaces.
- **DO NOT** use abrasive cleaners or scouring pads.
- **DO NOT** use Steambox to cook raw food (especially raw meats). We do not recommend this.
- **DO NOT** put anything else than food into Steambox. This includes objects, non-edible substances and (living) animals.
- **DO NOT** immerse Steambox, the charger, cord or plug into water at any time. This will void all warranty directly.
- **DO NOT** use Steambox with an empty food container. Doing so may cause malfunction and can be dangerous.
- **DO NOT** overfill your food container to avoid inefficient heating and risk of leakage during travel.
- **DO NOT** preheat the Steambox before use.
- **DONUTS** are delicious. Especially the glazed ones. 🍩
- **DO NOT** place food directly on the heating element of the appliance. This might cause damage.
- **DO NOT** use Steambox in extremely humid or wet environments.
- **DO NOT** use Steambox in environments below 10°C/50°F or above 45°C/113°F.
- **DO NOT** place Steambox in or near microwaves, ovens, refrigerators, dishwashers, freezers or other appliances.
- **DO NOT** use accessories that were not provided by Steambox. This could lead to fire, electric shock, or serious personal injury.
- **DO NOT** use or charge Steambox if any part is damaged or seems to be malfunctioning.
- **DO NOT** open, modify or manipulate Steambox. Doing so may lead to damage, injury and will limit your warranty.

Warnings

Please read all safety warnings and instructions. Failure to follow the warnings and instructions may result in electric shock, fire and/or serious injury.

- This appliance has a polarized plug (one blade is wider than the other). As a safety feature, this plug will fit in a polarized outlet only one way. If the plug does not fit fully in the outlet, reverse the plug. If it still does not fit, contact a qualified electrician. Do not attempt to defeat this safety feature.
- This appliance can be used by children aged from 8 years and above if they have been given supervision or instruction concerning use of the appliance in a safe way and if they understand the hazards involved. Cleaning and user maintenance shall not be made by children unless they are older than 8 and supervised. Keep the appliance and its cord out of reach of children aged less than 8 years.
- Appliances can be used by persons with reduced physical, sensory or mental capabilities or lack of experience and knowledge if they have been given supervision or instruction concerning use of the appliance in a safe way and understand the hazards involved. Children shall not play with the appliance.
- The SUPPLY CORD cannot be replaced. If the cord is damaged the appliance should be scrapped.
- CAUTION: In order to avoid a hazard due to inadvertent resetting of the THERMAL CUT-OUT, this appliance must not be supplied through an external switching device, such as a timer, or connected to a circuit that is regularly switched on and off by the utility.
- Prevent unintentional starting. Ensure the switch is in the off-position before connecting to battery pack, picking up or carrying the appliance. Carrying the appliance with your finger on the switch or energizing appliance that have the switch on invites accidents.
- Recharge only with the charger specified by the manufacturer. A charger that is suitable for one type of battery pack may create a risk of fire when used with another battery pack.

Warnings

- Use appliances only with specifically designated battery packs. Use of any other battery packs may create a risk of injury and fire.
- When battery pack is not in use, keep it away from other metal objects, like paper clips, coins, keys, nails, screws or other small metal objects, that can make a connection from one terminal to another. Shorting the battery terminals together may cause burns or a fire.
- Under abusive conditions, liquid may be ejected from the battery; avoid contact. If contact accidentally occurs, flush with water. If liquid contacts eyes, additionally seek medical help. Liquid ejected from the battery may cause irritation or burns.
- Do not use a battery pack or appliance that is damaged or modified. Damaged or modified batteries may exhibit unpredictable behavior resulting in fire, explosion or risk of injury.
- Do not expose a battery pack or appliance to fire or excessive temperature. Exposure to fire or temperature above 130°C may cause explosion.
- Follow all charging instructions and do not charge the battery pack or appliance outside of the temperature range specified in the instructions. Charging improperly or at temperatures outside of the specified range may damage the battery and increase the risk of fire.
- Have servicing performed by a qualified repair person using only identical replacement parts. This will ensure that the safety of the product is maintained.
- This appliance contains batteries that are only replaceable by skilled persons.
- Do not modify or attempt to repair the appliance or the battery pack (as applicable) except as indicated in the instructions for use and care.
- Normal Charging temperature: 4°C/39.2°F - 40°C/104°F.
- For use only with manufacture provided charger.*

**SHENZHEN XINSPower TECHNOLOGY CO., LTD, model: A361-1442300I charger.*

Warnings

- Please take attention that changes or modification not expressly approved by the party responsible for compliance could void the user's authority to operate the equipment.
- This device complies with Part 15 of the FCC Rules. Operation is subject to the following two conditions:
 - (1) This device may not cause harmful interference, and
 - (2) This device must accept any interference received, including interference that may cause undesired operation.
- This device contains licence-exempt transmitter(s)/receiver(s) that comply with Innovation, Science and Economic Development Canada's licence-exempt RSS(s). Operation is subject to the following two conditions:
 - (1) This device may not cause interference.
 - (2) This device must accept any interference, including interference that may cause undesired operation of the device.
- Under Industry Canada regulations, this radio transmitter may only operate using an antenna of a type and maximum (or lesser) gain approved for the transmitter by Industry Canada. To reduce potential radio interference to other users, the antenna type and its gain should be so chosen that the equivalent isotropically radiated power (e.i.r.p.) is not more than that necessary for successful communication.
- When the battery is low, it should be charged in time. This will help to extend the battery life. If the battery is not charged in time (within ± 2 months), the service life of the battery will be affected.

Avertissements

Lire toutes les mises en garde et toutes les instructions. Le non-respect des mises en garde et des instructions peut causer des chocs électriques, des Incendies et/ou des blessures graves.

- Cet appareil n'est pas destiné à être utilisé par des personnes (y compris les enfants) dont les capacités physiques, sensorielles ou mentales sont réduites, ou qui manquent d'expérience et de connaissances, à moins qu'elles n'aient été supervisées ou n'aient reçu des instructions concernant l'utilisation de l'appareil par une personne responsable de leur sécurité. Les enfants doivent être surveillés pour s'assurer qu'ils ne jouent pas avec l'appareil.
- Le CORDON D'ALIMENTATION ne peut pas être remplacé. Si le cordon est endommagé, l'appareil doit être mis au rebut.
- ATTENTION : Afin d'éviter tout danger dû à une réinitialisation par inadvertance de la coupure thermique, cet appareil ne doit pas être alimenté par un dispositif de commutation externe, tel qu'une minuterie, ou connecté à un circuit qui est régulièrement mis en marche et arrêté par le service public.
- Emêcher une mise en marche accidentelle. S'assurer que l'interrupteur est à la position arrêt avant de raccorder la batterie, de lever ou de déplacer l'appareil. Transporter l'appareil en gardant un doigt sur l'interrupteur, ou mettre sous tension un appareil dont l'interrupteur est à la position marche peut causer un accident.
- Recharger uniquement avec le chargeur prescrit par le fabricant. Un chargeur convenant à un type de batterie peut présenter un risque d'incendie lorsqu'il est utilisé avec une autre batterie.
- Utiliser uniquement les batteries recommandées pour l'appareil. L'utilisation d'autres types de batteries peut présenter un risque de blessure ou d'incendie.

Avertissements

- Lorsque l'appareil n'est pas utilisé, tenir la batterie loin d'objets métalliques comme des trombones, des pièces de monnaie, des clés, des clous, des vis ou autres petits objets qui pourraient établir une liaison entre les bornes. Un court-circuit des bornes des batteries peut causer des brûlures ou un incendie.
- En condition d'usage abusif, du liquide peut s'échapper de la batterie ; éviter tout contact avec ce liquide. En cas de contact accidentel, rincer abondamment avec de l'eau. En cas de contact avec les yeux, consulter également un médecin. Le liquide projeté peut causer des irritations ou des brûlures.
- Ne pas utiliser une batterie ou un appareil endommagé ou qui a été modifié. Des batteries endommagées ou modifiées peuvent avoir un comportement imprévisible pouvant causer un incendie, une explosion ou un risque de blessure.
- Ne pas exposer une batterie ou un appareil à la flamme ou à des températures excessives. L'exposition à une flamme ou à des températures supérieures à 130 °C peut causer une explosion.
- Respecter toutes les instructions de chargement et ne pas charger la batterie ou l'appareil à des températures qui ne sont pas incluses dans la gamme de températures indiquées dans la notice d'instructions. Un chargement mal effectué.
- Confier les réparations à une personne qualifiée qui utilisera uniquement des pièces de remplacement identiques. Cette façon de faire garantira la sécurité du produit.
- Ne pas modifier ni tenter de réparer l'appareil ou la batterie (selon le cas) sauf comme il est indiqué dans les instructions d'utilisation et d'entretien.
- Température de charge normale: 4°C/39.2°F - 40°C/104°F.
- Pour une utilisation uniquement avec le chargeur fourni par le fabricant.*

**SHENZHEN XINSPower TECHNOLOGY CO., LTD, model: A361-1442300I charger.*

Avertissements

- l'appareil contient des émetteurs/récepteurs exempts de licence qui sont conformes aux CNR exempts de licence d'Innovation, Sciences et Développement économique Canada. L'exploitation est soumise aux deux conditions suivantes :
 - (1) l'appareil ne doit pas produire de brouillage,
 - (2) l'utilisateur de l'appareil doit accepter tout brouillage radioélectrique subi, même si le brouillage est susceptible d'en compromettre le fonctionnement.
- Conformément à la réglementation d'Industrie Canada, le présent émetteur radio peut fonctionner avec une antenne d'un type et d'un gain maximal (ou inférieur) approuvé pour l'émetteur par Industrie Canada. Dans le but de réduire les risques de brouillage radioélectrique à l'intention des autres utilisateurs, il faut choisir le type d'antenne et son gain de sorte que la puissance isotrope rayonnée équivalente (p.i.r.e.) ne dépasse pas l'intensité nécessaire à l'établissement d'une communication satisfaisante.

Other

EN - Product Warnings can be found by scanning the QR code to the right or by visiting the website.

FR - Les avertissements peuvent être trouvés en scannant le code QR à droite ou en visitant le site Web.

DE - Produktwarnungen finden Sie, indem Sie den QR-Code rechts scannen oder die Website besuchen.

ES - Encuentre advertencias de productos escaneando el código QR a la derecha o visitando el sitio web.

PT - Os avisos podem ser encontrados digitalizando o código QR à direita ou visitando o site.

IT - Trova gli avvisi sui prodotti scansionando il codice QR a destra o visitando il sito web.

PL - Ostrzeżenia można znaleźć skanując kod QR po prawej stronie lub odwiedzając stronę internetową.



STEAM-BOX.COM/WARNINGS

Disclaimer

Your use of the product is at your own risk. It is understood that you are voluntarily using it with full knowledge that there are inherent and/or associated risks in doing so, and you assume and accept any and all risks that may be associated with or that arise out of possession or use of the product, including, but not limited to, the risk of property damage or loss, and/or serious injury (including shock or death).

Neither Steambox nor its retailers assume any responsibility or liability for any injuries or damages, physical or otherwise, resulting, directly or indirectly, from the use or possession of this product. Steambox reserves the right to revise this publication and to make changes from time to time in the contents thereof without obligation to notify any person of such revision or changes. The product model may be changed for improvements without notice at any time at the discretion of Steambox.

For complete information on limited product warranties, disclaimer of warranties, limitation of liability, release and indemnity, please see the Steambox website at www.steam-box.com/policy.

Warranty

We offer a 12 to 24-month warranty for your Steambox from date of purchase (differs per region). It covers faults in construction, workmanship and material. Excluded from this guarantee are damage from hydro-chemical influences (e.g. owing to calcification), damage to all wear parts, damage from inappropriate use or maintenance, as well as damage from modifications or repairs carried out by unauthorized third parties. Please keep your proof of purchase to verify any claims under guarantee. The full warranty policy is available on our website (www.steam-box.com/policy) and can be modified by Steambox at any moment without notice.

Contact

Steambox BV
Laan van Ypenburg 108
2497GC The Hague
The Netherlands

info@steam-box.com
www.steam-box.com

steam-box.com



@steambox.official



@steambox_