

B. On PC/MAC

You can easily remove the memory card from the camera and insert it directly into your PC if you have a card reader.

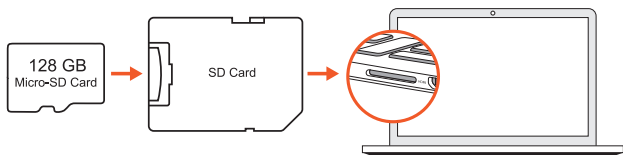

Next, locate the added memory card drive on your computer and double-click the video to play it.

VIDEO SETTINGS

The camera comes with default settings, allowing you to start using it right out of the box without the need to adjust any settings. Make sure to format the TF memory card before using it for the first time.

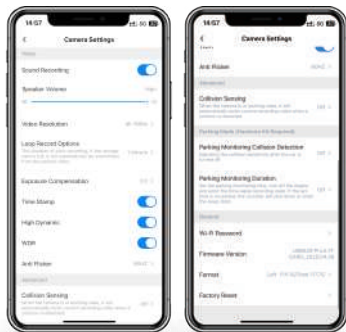

Single-lens camera settings



Dual-lens camera settings

SOUND RECORDING

The MANGOAL OEM Style Dash Cam features a built-in microphone to record both audio and video. You can choose to record video without audio

- OFF
- ON (Default)

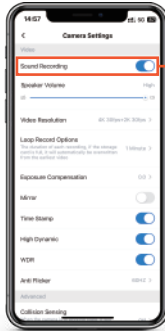

SPEAKER VOLUME

This feature allows you to adjust the volume levels for the button beep, video playback, and boot-up chime through the camera's internal built-in speaker.

- OFF
- Low
- Middle
- High(Default)

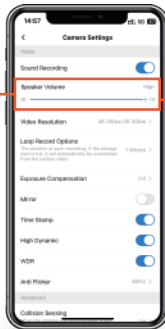

VIDEO RESOLUTION

You can choose the video resolution you prefer. Keep in mind that higher-resolution videos will take up more storage space.

- 4K 30fps (Default)
- 2K 60fps
- 1080P 70fps

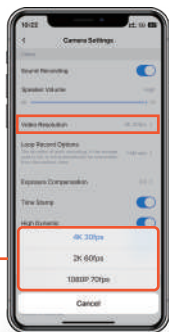

Single-lens camera settings

- 4K 30fps+2K 30fps(Default)
- 2K 60fps+2K 30fps

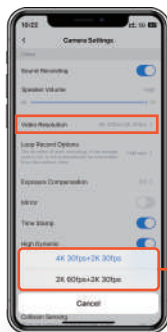

Dual-lens camera settings

LOOP RECORD OPTIONS

This feature allows the camera to continuously record in loops. It automatically deletes the oldest video files when the memory card becomes full, so you don't have to manually delete them. It will also split each video file into the appropriate length based on your selection.

- 1-MINUTE(Default)
- 2-MINUTES
- 3-MINUTES

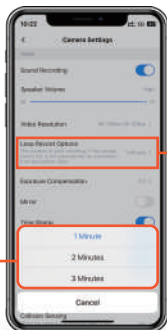

EXPOSURE COMPENSATION

This feature allows you to adjust the brightness of a captured image.

- +2.0
- +1.6
- +1.3
- +1.0
- +0.6
- +0.3
- 0.0
- -0.3
- -0.6
- -1.0
- -1.3

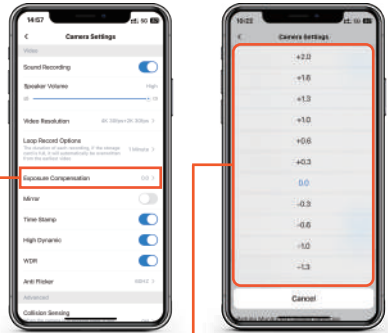

MIRROR

The rear cam image mirroring setting

- OFF (Default)
- ON

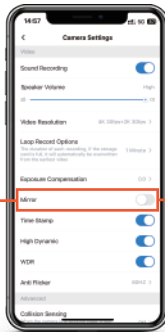

TIME STAMP

This function allows you to switch the video recording timestamp watermark.

- OFF
- ON (Default)

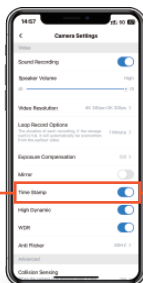

HIGH DYNAMIC

High Dynamic Range (HDR) sets about improving the contrast in an image while maintaining clarity. HDR improves image quality with better contrast, greater brightness and enhances the colours seen.

- OFF
- ON (Default)

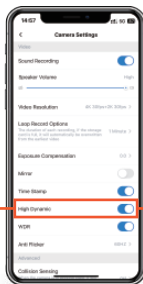

WDR

WDR is an image processing technology primarily used in scenes with strong light contrast. It allows the dashcam to clearly display both bright and dark areas in the image.

- OFF
- ON (Default)

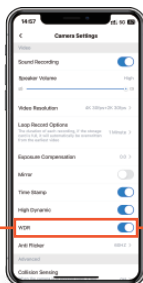

ANTI FLICKER

50Hz applicable countries: China, Europe, most Asian countries, Australia, New Zealand, South Africa, etc.

60Hz applicable countries: United States, Canada, North African countries, Brazil, etc.

- 50HZ
- 60HZ (Default)

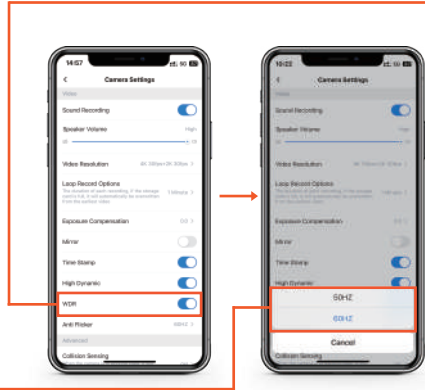

NOTE

Backup option, primarily used to prevent the camera from flipping during subsequent software upgrades.

COLLISION SENSING

The G-Sensor is a 3-axis gravitational accelerometer designed to detect physical and gravitational forces on the camera.

While the Video is Being Recorded:

If the G-Sensor is triggered by physical or gravitational impact on the camera, the current video file's loop cycle will be locked. This prevents it from being deleted by the loop cycle function.

- OFF(Default)
- Low
- Medium
- High

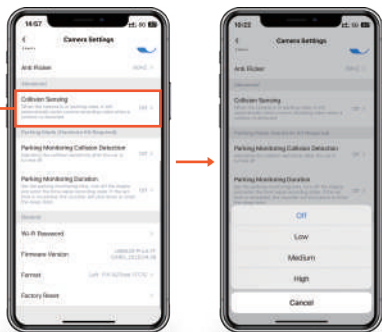

⚠ CAUTION

In the event of an accident, make sure to retrieve your footage before using your camera again. This will prevent the loss of important video files due to the loop cycle function. This is especially important if the force was minor and did not trigger the G-Sensor to automatically lock the video file. It is strongly recommended that you retrieve all necessary video footage after any accident before using your camera again to avoid losing vital files.

ADVANCED SETTINGS

MANGOAL has 2 different parking modes.

NOTE

The power cable included with some packages does not support the parking monitoring function (see the purchase link). You can purchase the parking monitoring cables: the "OBD Power Adapter" (search ASIN: BoCVTKTGvy) and the "Fuse Box Power Adapter" (search ASIN: BoCXXXV4YG) on Amazon.

1 G-SENSOR PARKING MODE

This feature is designed to activate when the camera detects shaking during a hit-and-run event while your car is parked. If someone hits your car and the shaking is detected based on your G-sensor settings, the camera will automatically turn on and start recording for one minute. After that, the video file will be locked to prevent it from being deleted by the loop cycle function. The camera will then turn off automatically.

G-Sensor Parking Mode:

G-Sensor setting also impacts Parking Mode feature based on your setting selection.

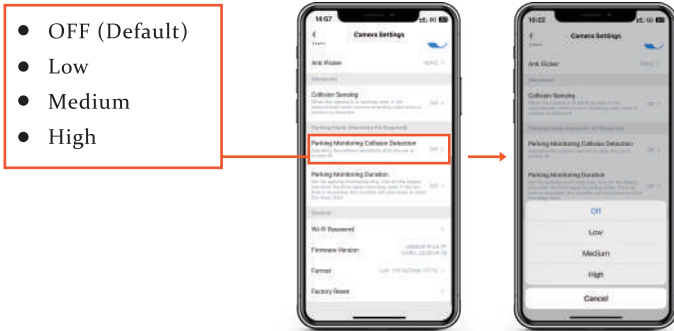

G-Sensor Parking Mode: (See how this feature works)

- 1 When this feature is turned ON and the 12V constant parking mode cable is installed properly, the camera will stop continuous video recording. It will then enter sleep mode when the car's engine is turned off and the key is in the lock position.
- 2 While in G-Sensor Parking Mode, if someone hits your car and the impact reaches the set G-Sensor level, the camera will stop motion detection. It will then begin recording the video currently being captured (the video duration is determined by the "Loop Recording" setting) and save and lock that video in the LOCKED folder. Afterward, it will return to G-Sensor Parking Mode.
- 3 When you start your car again, the camera will automatically exit G-Sensor Parking Mode. It will then return to normal video mode and resume continuous recording.

NOTE

Some models come with a standard Y-cable harness that does not support parking mode (details are provided in the product description on the purchase link). You can purchase a parking monitoring harness, such as the "OBD Power Adapter" (Amazon search ASIN: BoCVTKTGVY) or the "Fuse Box Power Adapter" (Amazon search ASIN: BoCXXXV4YG).

⚠ CAUTION

In the event of an accident, please ensure that you retrieve your footage before using your camera again. This will help prevent the loss of important video files due to the loop cycle function. This is especially crucial if the force of the accident was minor and did not trigger the G-sensor to automatically lock the video file. It is considered best practice to retrieve all necessary video footage after any accident before using your camera again in order to avoid losing vital files.

2 TIME-LAPSE VIDEO PARKING MODE

Time-lapse recording mode allows you to capture specific images per second at a much lower rate. When these images are combined and played at the normal 30 fps rate, everything appears to move faster in the time-lapse.

NOTE

Time-Lapse is off by default. If it is programmed to be turned on, it will remain on even after the camera restarts. As a result, all your videos will play at time-lapse speed (faster playback).

NOTE

A. After the time-lapse recording mode is activated, when the car is turned off, the dashcam's green indicator light will change from flashing once every second to flashing once every two seconds. The voice prompt will then say, "Turn on time-lapse recording." (Note that the ACC power cutoff status may vary by car. It can take up to 10 minutes for the power to be completely cut off after the car is turned off.) You can sit in the driver's seat and observe. The recorded video will be saved in the "Parking" folder. After connecting to the app, you can view it under "Camera File" > "Parking."

B. Will the battery be drained, preventing the vehicle from starting?
The parking monitoring mode will not drain the battery completely because the MANGOAL dashcam uses advanced power protection technology. When the camera detects that the battery voltage drops below 11.6V, it will automatically enter sleep mode, consuming almost no power. This ensures that the battery has enough voltage for the next time you start the car.

Time-Lapse Video Parking Mode :

Set different options for the 'Parking Record Time' mode based on your selected settings.

- OFF (Default)
- 12 HOURS
- 24 HOURS
- 48 HOURS

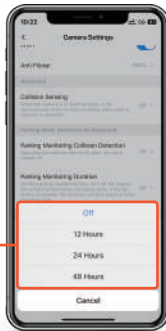

We have custom-designed this feature in response to numerous requests from our valued customers. Many of you have asked why we couldn't design a parking mode or motion detection that automatically switches to parking mode. We're excited to inform you that we've developed this feature, and it's even better than what you asked for. Thank you for your continued support and valuable suggestions.

Time-Lapse Video Parking Mode : (See how this feature works)

- 1 When this feature is set to ON and the 12V constant parking mode cable is properly installed, the following occurs:
- 2 When you turn off the car's engine and switch the key to the lock position, the camera will stop continuous video recording. It will then automatically switch to timelapse 1 fps recording mode.
- 3 If the timelapse recording exceeds the "Parking Record Time" setting, the camera will stop the timelapse video.
- 4 The next time you start your car, the camera will automatically stop the timelapse 1 fps parking mode. It will then switch to normal video mode to resume continuous recording.

NOTE

Time-Lapse is off by default. Once it is turned on, it will remain on even after the camera restarts. As a result, all your videos will play in time-lapse speed (faster playback).

CAUTION

In the event of an accident, please ensure you retrieve your footage before using your camera again. This will prevent the loss of important video files due to the loop cycle function, especially if the force was minor and did not trigger the G-Sensor to automatically lock the video file. It is best practice and strongly recommended to retrieve all necessary video footage after any accident before using your camera again to avoid losing vital files.

WI-FI PASSWORD

The default Wi-Fi password is 12345678, which consists of 8-12 digit and letter combinations. The password can be changed according to your requirements. Click 'OK' to complete the modification.

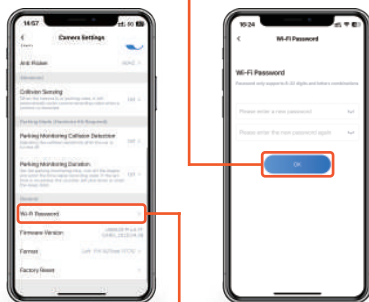

* After changing the password, if you cannot connect to WiFi, First of all, click the phone WiFi list to find the camera WiFi, click in and select "Forget WiFi" and click Action. Then restart the dashcam again: press and hold the camera power button to force shutdown, then press it again to restart. and search for the WiFi connection again.

If you forget the password, please restore the factory settings to retrieve the initial password: 12345678. See page 47 for details.

FIRMWARE VERSION

Display the latest firmware version of the dash cam.

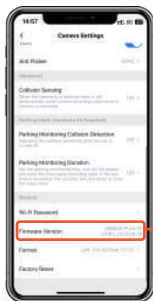

FORMAT SD CARD

See page 23

NOTE

The locked pictures and videos in the memory card will not be overwritten cyclically. Please format the memory card regularly every 2-3 months to maintain stability.

FACTORY RESET**Default Settings**

Click "Confirm" to restore the configuration items of the dash cam and app to their factory settings.

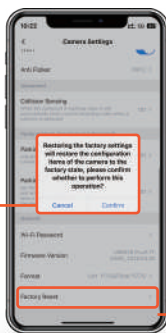
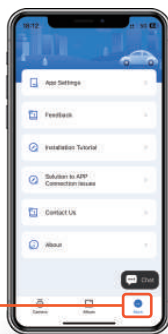
**APP SYSTEM**

LANGUAGE&DATE FORMAT

This setting allows you to choose the language for the camera's firmware.

- English (Default)
- French
- Spanish
- Portuguese
- Deutsch
- Italian
- Simplified Chinese
- Traditional Chinese
- Russian
- Japanese
- Thai
- Polish

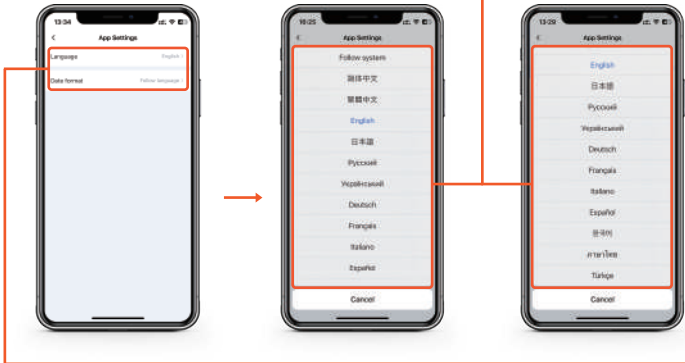

This setting allows you to choose the date format for the camera's firmware.



FEEDBACK

Feedback : (See how this feature works)

If any issues occur while using the dash cam, follow these steps:

- 1 Connect the dash cam to the app via Wi-Fi and enter the app to reproduce the operation problem.
- 2 Then, disconnect the dash cam Wi-Fi from the mobile phone. Identify the corresponding issue.
- 3 In the 'Contact Details' section, select either 'Mobile' or 'Email' as your preferred contact method.
- 4 Finally, click 'Submit' to send your report.

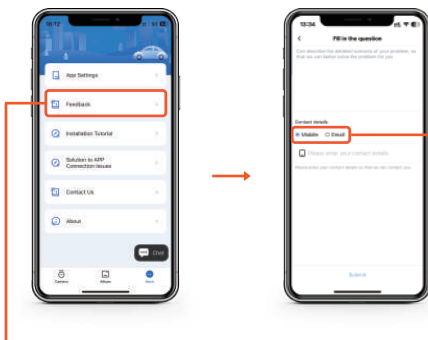

* After submitting feedback, please send the registered "Contact Details" information to the email address: "support@mangoaltech.com" to ensure that mangoal resolves your feedback in a timely manner!

INSTALLATION TUTORIAL

Scroll down to find the installation video for the corresponding model. If you encounter any other installation or usage issues, please click "Chat with us" in the lower left corner to contact customer service.

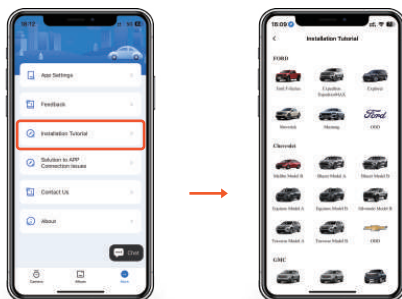

CONTACT US

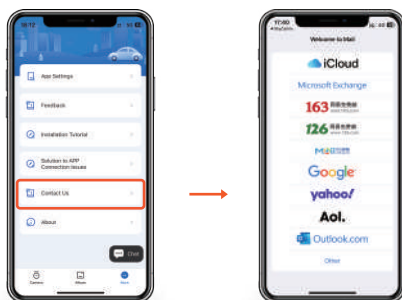

ABOUT US

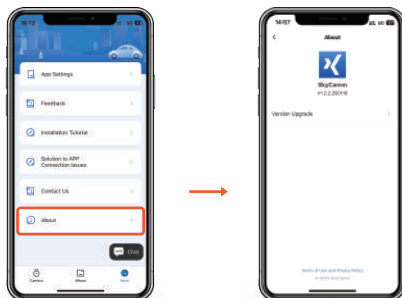

ALBUM

- 1 The "Album" file is generated from the "DOWNLOAD" operation in "PLAYBACK MODE." See pages 27-28 for more details.



- 2 The "Album" file is accessed from the main interface of the app.

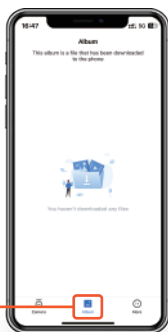

NOTE

Android Mobile Phone: Videos and pictures in the "Album" are automatically synchronized with the local photo album on the Android device.

Apple Mobile Phone: Videos and pictures in the "Album" are stored only within the app and cannot be synchronized to the local photo album on the Apple device. To save them to the local photo album, select the files in the "Album" individually or in batches, then click "Save."

RESETTING THE CAMERA

Resetting hardware and resetting software are two different things.

1 Reset The Hardware/Camera:

A. If the camera is freezing or unresponsive, use the following two methods to operate it:

Press the **RESET** button at the bottom of the camera only ONCE, using a paperclip or the tip of a pen while the camera is turned ON. This will restart the camera.



B. Please long-press the 'camera'  button for 10 seconds to restart the camera.

*After restoring factory settings, please click the phone's Wi-Fi list and find the camera Wi-Fi, then click to enter, select "Forget Wi-Fi", "Delete network" or "Disconnect" and confirm the operation once.

Then restart the dashcam again. Then search for the camera Wi-Fi in the phone's WLAN list and enter the initial password "12345678" to connect.

2 Setting Firmware/Camera to the default settings:

If you get stuck with any settings, you can reset the camera to its factory defaults. To do this, go to System Settings. Scroll down until you see "DEFAULT SETTINGS" and select it to reset everything.

ONE-YEAR LIMITED WARRANTY

We at MANGOAL would like to offer a one (1) year limited warranty for your product from the date of purchase. This warranty ensures that your product is free from defects in materials and craftsmanship.

IMPORTANT: Please retain your warranty/serial number card as proof of purchase. A proof of original purchase is required for any warranty service (online order receipt is also accepted).

Warranty Terms and Conditions

1. The warranty is limited to the first purchaser of the product and is non-transferable.

2. Service and repairs during the warranty period shall be carried out only by company-authorized personnel.
3. It is the purchaser's responsibility to bring the product to the authorized service center at their own cost and risk.
4. The company will not be liable for any hardware or data loss resulting from the use of any third-party software, whether downloaded or otherwise.
5. In the event of repairs or replacement of any part(s) of the product, this warranty will remain in effect only for the unexpired portion of the warranty.
6. If physical damage to the product and/or misuse is detected by authorized service center personnel, the warranty will be void. Service or repairs will then be performed on a chargeable basis, subject to the availability of parts.
7. The company's obligation under this warranty is limited to the repair or replacement of part(s) only. The maximum claim(s) entertained by the company will be subject to the maximum retail price of the product purchased or the purchase price, whichever is lower. Claims must be supported by the original proof of purchase. If spares are unavailable during the warranty period due to unforeseen circumstances, a commercial solution in lieu of repairs will be provided. This solution will be calculated based on the company's prevailing depreciation rules. It will also be binding on the purchaser. The replacement unit may be new or refurbished, depending on availability. We reserve the right to upgrade you to the newest version, whether similar or not, if the current model has been discontinued.

LIMITATIONS / DISCLAIMER OF WARRANTY / LIABILITY

1. The company shall not be liable or responsible, directly or indirectly, for any claims for compensation, damages, losses, etc., under this "Limited Warranty," including but not limited to inconvenience, loss of time, loss of profits, loss of business opportunity, loss of data, loss of goodwill, work stoppage, personal or commercial losses, compensation for mental anguish, anxiety, or any other direct or indirect loss of any nature whatsoever.

ever, including personal injury or death, resulting from the use of the product(s).

2. The company disclaims all warranties, except for those set forth herein. This includes all expressed, implied, or statutory warranties, such as the implied warranties of merchantability or fitness for a particular purpose. The company's maximum liability under any circumstances shall be
3. limited to an amount equal to the invoice amount paid by the purchaser. This applies whether the purchase was made directly to the company or through a company-authorized reseller for the product(s).
4. The company shall not be liable, either directly or indirectly, for any claim for compensation if the product has been exposed to moisture, dampness, extreme thermal or environmental conditions, or rapid changes in such conditions. Additionally, the company will not be liable for claims arising from corrosion, oxidation, spillage of food or liquid, or influence from external chemical products.
5. MANGOAL guarantees to the purchaser that this product is covered by a warranty. The warranty period begins from the date of purchase, as mentioned above.

SAFETY & LEGAL ASPECTS:

All rights are reserved. Duplication, transfer, or distribution of the contents herein in any manner without the prior written permission of MANGOAL is prohibited. MANGOAL reserves the right to add, modify, or delete any of the contents herein, or withdraw this document at any time, without prior notice and without assigning any reasons. For detailed terms and conditions, refer to www.mangoaltech.com.

- Please check your local or state laws before using an in-car recording device. It is the user's responsibility to comply with all local and state laws.
- The MANGOAL OEM Style Dash Cam must be placed in a proper location so it does not obstruct your view while driving.
- Do not use or manipulate any functions or accessories of the Dash Cam while driving. Distraction is a leading cause of accidents.

AGREEMENTS

By purchasing the MANGOAL Style Dash Cam, you agree to all terms and conditions of the warranty, warnings, and precautions. If you do not agree with these terms, you may return the product unused and in its original packaging within the return window for a full refund.

Still Need Help or Have Questions?

Please feel free to contact our world-class support team at support@mangoaltech.com. Most emails are usually replied to within 24 hours. However, all questions are answered within 24 hours—no exceptions! For customer service phone support, please visit <https://www.mangoaltech.com>.

A BIG THANK YOU!!

Thank you for purchasing your new MANGOAL Style Dash Cam! We hope you find your new dash cam both useful and enjoyable to use.

If you're having trouble setting it up, please email us at support@mangoaltech.com. 99% of setup issues can be easily resolved, and we'll have you up and running in no time.

In the unlikely event that we can't assist you, we're always happy to offer a full, hassle-free refund. Our goal is for you to be happy and proud to use your MANGOAL Style Dash Cam!

While no product is perfect, we are committed to providing excellent customer service to you.

Great care has been taken in creating this user manual, though there may be minor typos. If you find any mistakes or have suggestions, please let us know so we can correct them. Be sure to visit our website for the latest version of the user manual, if available. We also frequently update other valuable content for our customers.

Please note that camera upgrades, firmware, and box contents may change without notice. Visit our website for the most up-to-date information.

⚠ WARNING

- **INGESTION HAZARD:** This product contains a button cell or coin battery.
- **DEATH** or serious injury can occur if ingested.
- A swallowed button cell or coin battery can cause **Internal Chemical Burns** in as little as **2 hours**.
- **KEEP** new and used batteries **OUT OF REACH OF CHILDREN**
- **Seek immediate medical attention** if a battery is suspected to be swallowed or inserted inside any part of the body.



- A. Remove used batteries immediately and recycle or dispose of them according to local regulations. Keep away from children. Do NOT dispose of batteries in household trash or incinerate them.
- B. Even used batteries can cause severe injury or death.
- C. Call a local poison control center for treatment.
- D. Battery Type: FDK-ML621
- E. Battery Voltage: DC 3V
- F. Non-rechargeable batteries should not be recharged.
- G. This product contains non-replaceable batteries.

Correct Disposal of this product

This marking indicates that this product should not be disposed of with other household waste throughout the EU. To prevent possible harm to the environment or human health from uncontrolled waste disposal, recycle it responsibly to promote the sustainable reuse of material resources. To return your used device, please use the return and collection systems or contact the retailer where the product was purchased. They can take this product for environmentally safe recycling.

This device contains license-exempt transmitters/receivers that comply with Innovation, Science and Economic Development Canada's license-exempt RSS(s). Its operation is subject to the following two conditions:

1. This device must not cause interference.
2. This device must accept any interference, including interference that may cause undesired operation.

L'émetteur/récepteur exempt de licence contenu dans le présent appareil est conforme aux CNR d'Innovation, Sciences et Développement économique Canada applicables aux appareils radio exempts de licence. L'exploitation est autorisée aux deux conditions suivantes :

1. L' appareil ne doit pas produire de brouillage;
2. L' appareil doit accepter tout brouillage radioélectrique subi, même si le brouillage est susceptible d'en compromettre le fonctionnement.

This equipment complies with IC exposure limits set for uncontrolled environments. It should be installed and operated with a minimum distance of 20 cm between the radiator and the body.

Cet équipement est conforme aux limites d'exposition IC définies pour un environnement non contrôlé. Cet équipement doit être installé et utilisé avec une distance minimale de 20 cm entre le radiateur et la carrosserie.

FCC Warning

This device complies with Part 15 of the FCC Rules. Operation is subject to the following two conditions:

(1) This device may not cause harmful interference, and (2) this device must accept any interference received, including interference that may cause undesired operation.

NOTE 1: This equipment has been tested and found to comply with the limits for a Class B digital device, pursuant to part 15 of the FCC Rules. These limits are designed to provide reasonable protection against harmful interference in a residential installation. This equipment generates, uses and can radiate radio frequency energy and, if not installed and used in accordance with the instructions, may cause harmful interference to radio communications. However, there is no guarantee that interference will not occur in a particular installation. If this equipment does cause harmful interference to radio or television reception, which can be determined by turning the equipment off and on, the user is encouraged to try to correct the interference by one or more of the following measures:

- Reorient or relocate the receiving antenna.
- Increase the separation between the equipment and receiver.
- Connect the equipment into an outlet on a circuit different from that to which the receiver is connected.
- Consult the dealer or an experienced radio/TV technician for help.

NOTE 2: Any changes or modifications to this unit not expressly approved by the party responsible for compliance could void the user's authority to operate the equipment.

RF Exposure Statement

To maintain compliance with FCC'S RF Exposure guidelines, This equipment should be installed and operated with minimum distance of 20cm between the radiator and your body. This device and its antenna(s) must not be co-located or operation in conjunction with any other antenna or transmitter.