

**MANGOAL**

# OEM STYLE DASH CAM

TAILER FOR YOUR CAR

Please Read



(Optional)

**MODEL: MGA-0xxX**

(xx=01-50,X=A-Z)



## USER MANUAL

Copyright (C) 2025, All rights reserved

[www.mangoaltech.com](http://www.mangoaltech.com)



# EXPERIENCING PROBLEMS?

- ▶ Item NOT as described?
- ▶ Damaged or defective?
- ▶ Missing items?
- ▶ Any issues whatsoever?

**CONTACT US BEFORE RETURNING THE ITEM**

**WE WILL HELP YOU RESOLVE ANY ISSUES ASAP.**

## CUSTOMER SERVICE

**Hours: 8:00 am to 8:30 pm beijin time**

**Hours: 7:00 pm to 8:30 am New York Time**

**EMAIL US**



Response in just 24 hours

**[support@mangoaltech.com](mailto:support@mangoaltech.com)**

Scan the QR Code to Download APP



Wi-Fi Name: WiFi\_USB529 Pro\_XXXX

Wi-Fi Password: 12345678

### NOTE

\* The dashcam WiFi does not need to be connected to the mobile phone APP all the time. The dashcam will automatically start and record normally when you start the car. The function of Camera WiFi is only to transfer or download the videos and pictures recorded by the memory card to the APP. After use, delete the camera WiFi or Click "Forget This Network" in the phone WiFi list to prevent your phone from automatically connecting to the camera WiFi when you start the car next time. And affect the normal Internet access on mobile phones and CarPlay & Android Auto functionality.

## NOTE

Please read the following precautions carefully before installation and use. They will save you a lot of trouble!

**The following are common problems. You can set them up according to the process.**

**1. you need to find the correct camera WiFi and enter the password to connect. The initial camera WiFi name is: 'WiFi\_USB529 Pro-XXXX' (X:A-Z), and the password is: 12345678.**

If you see "Unable to join the network", "Connection Failed", "Password incorrect" or other prompts when connecting to the camera wifi or in the APP "Add Camera" process, please follow the instructions below to restore the factory settings.

## Reset The Camera:

Use the following two methods to restore factory settings (see page 47 of the manual), please see the picture guide for specific operations, After the factory settings are successfully restored, the camera will restart and the prompt "start recording" will sound.

\* If your iPhone system version is iOS 18.0/18.1/18.2/18.3/18.4 or later, During the process of downloading the APP, click Allow on the various options that pop up to prevent the mobile phone from blocking the camera WIFI. please make sure to turn on the "Local Network" permission of the APP: iPhone "Settings" >> "Apps" at the bottom >> click "SkyCamm" to turn on "Local Network". Then restart your iPhone and dashcam, try to connect to the APP again

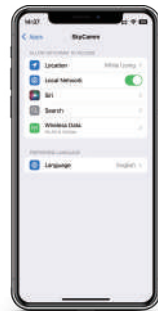

\*The cameraWiFi will go into sleep mode if there is no connection for 5 minutes after the dashcam is turned on and will disappear from the phone's WiFi list. You can activate WiFi by pressing the camera power button once

### 2. Download another APP "Viidure" and try to connect

A、 Search "viidure" in App Store

Search "viidure" in Google Play Store

B、 Scan the QR code below to download.



\* If the above methods still cannot solve the problem, please install "Feedback" on page 44 to submit a log, take a screenshot of the submission interface or send the filled contact details to the **email: support@mangoaltech.com**. We will help you solve it.

Thank you in advance for your time and patience!

## INDEX

CUSTOMER SERVICE .....	2
INTRODUCTION .....	6
PRODUCT OVERVIEW .....	6
FEATURES .....	7
USER AGREEMENT .....	8
PRECAUTIONS .....	8
OUT OF THE BOX INSTRUCTIONS .....	10
SPECIFICATIONS .....	12
PACKAGE CONTENTS .....	13
UNIT STRUCTURE APPEARANCE & BUTTONS .....	14
INSTALLATION .....	15
TURNING YOUR CAMERA ON/OFF .....	16
USING Wi-Fi FEATURE .....	16
SHORTCUTS & UNDERSTANDING BUTTONS .....	19
LED STATUS LIGHT INDICATOR .....	19
CONNECTING DASH CAM WITH SMARTPHONE .....	20
APP HOME SCREEN .....	22
INSERTING/REMOVING A MICRO TF CARD .....	23
FORMAT SD CARD .....	24
UNDERSTANDING 3 – CAMERA MODES .....	25
PLAYBACK YOUR RECORDED VIDEOS.....	27
VIDEO SETTINGS .....	30
ADVANCED SETTINGS .....	36
RESETTING THE CAMERA .....	47
ONE-YEAR LIMITED WARRANTY .....	47
LIMITATIONS .....	48
SAFETY & LEGAL ASPECTS .....	49
AGREEMENTS .....	50

## INTRODUCTION

Thank you for purchasing MANGOAL Ultra HD 3840 x 2160 @30 fps OEM Style Dash Cam (Automobile Black Box). This product provides high quality image capture and irrefutable evidence for what goes on from the perspective of your dashboard. Dash Cam is a very elegant, convenient and durable multi-vehicle driving recorder.

## PRODUCT OVERVIEW

This product is a leading Ultra HD Digital Vehicle Black Box Recorder. It features ULTRA-HD Front 2160P @30fps with the NOVATEK NT-96670 processor and SONY IMX335 sensor, providing excellent low-light sensitivity and a high dynamic range. This allows for continuous high-quality video playback and stunning 4K Ultra HD resolution, even at night, without the need for infrared sensors. The recorder also boasts superior night vision technology, capturing exceptional video in all low-light conditions. and Rear 1440P @30fps.

Additional features include built-in Wi-Fi, GPS, a G-sensor, an emergency video lock button, audio recording, loop cycle recording, 180-degree auto video rotation, a wide dynamic range, G-sensor parking mode, and time-lapse video parking mode. Compared to most dash cameras, this exclusive design offers an elegant appearance, packed with top-rated features that deliver unbeatable video quality and ease of use.

## FEATURES



Built-In WiFi



Auto Power OFF



G-Sensor Built-In



Time, Date



Video Rotate



Time Lapse Video



G-Sensor Parking Mode  
(Parking Mode Hardwire Kit is required)



Built-In Speaker & Microphone



Time-Lapse Parking Mode  
( Parking Mode Hardwire Kit is required)



NOVATEK NT-96670 Processor + SONY IMX335 Sensor



4K Ultra-HD 3840\*2160 @30 fps



150° Ultra-Wide A+ Viewing Angle



Loop Cycle and Split Recording Mode



Up to 128GB Class 10, U3 Speed for 4K Video is Required



HDR (High Dynamic Range) function

## USER AGREEMENT

By purchasing the MANGOAL OEM Style Dash Cam, you automatically agree to the precautions, user warnings, and all terms and conditions of the warranty. If, for any reason, you do not agree with any of the terms mentioned in this manual, you may return the product. The product must be in its original packaging, unused, and returned within the designated return window for a full refund.

## PRECAUTIONS

Please read this manual carefully before using the camera or installing it, and keep it safe for future reference. It will be helpful if you have any questions or encounter any operational issues.

## WARNINGS

Failure to comply with safety warnings and regulations may result in serious injury or death.

Please read and understand all instructions before using this product. Failure to follow the instructions may result in damage and void the warranty.

- Do not expose this product to rain, moisture, or water under any circumstances, as it may cause internal or external damage.
- Do not place the unit in a damp environment, as this device is not designed to be moisture-resistant.
- Do not attempt to open the cover or repair the device yourself. If there are any issues with the accessories, please contact the seller for assistance.
- This camera is intended for use inside a motor vehicle. Do not install it in a location that obstructs the driver's view of the road, including mirrors or the deployment of airbags.



- Do not place the camera loosely on top of the dashboard or in front of the airbags.
  - Do not mount the camera where it could become a distraction if it loosens and falls off the windshield while driving.
  - Do not expose this device to excessive heat, dust, or use any chemical substances or cleaning solvents. Instead, use a soft, moist cloth for cleaning.
  - Pay careful attention when cleaning the lens surface. Use a soft, moist cloth to clean the lens and avoid scratches that may compromise video quality.
  - It is recommended to remove the camera from the vehicle when not in use. This helps reduce the likelihood of theft and exposure to excessive heat, which could damage the unit.
  - Do not operate or install the camera while driving, or attempt to change any settings. Pull off the road first and only do so when it is safe.
  - Do not drop, puncture, or disassemble this product.
  - Do not use the charger if the cord is broken or damaged. Keep it out of reach of children.
  - Do not leave the camera in direct sunlight for long periods or in areas where the temperature may exceed 140°F (60°C).
- 
- Some countries or U.S. states prohibit drivers from mounting anything on the windshield or restrict mounting in certain areas of the windshield. It is the owner/operator's responsibility to mount or use this device in compliance with local laws.
  - The company is NOT responsible for the loss of any data or content during operation or under any circumstances.

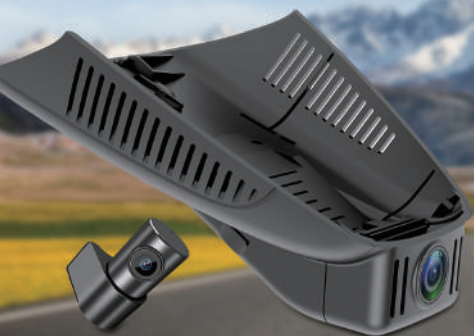

# Getting Started

## OUT OF THE BOX INSTRUCTIONS

Please read and understand the warnings and safety instructions before operating the camera.

- 1 Always ensure that the camera is plugged into a power source, as it does not have an internal battery.
- 2 You will need to insert a memory card before you can start recording. Please use only a branded Class 10, U3, or higher-speed microSD card with a maximum capacity of 128 GB for reliable operation.
- 3 Before using the camera for the first time, you **MUST** format the memory card in the camera to prevent errors and ensure smooth operation.
- 4 The MANGOAL OEM Style Dash Cam is programmed to automatically turn ON and start recording when it receives power. It will automatically stop recording and turn OFF when power is disconnected (within 4-5 seconds), such as when you start or stop your car.

### 5 Setting Date & Time:

When the power is turned on for the first time, you need to download the MANGOAL brand-exclusive app, "SkyCamm." Then, follow the guide link to connect to the recorder (see Page 21).

### 6 How to Hide the Power Cable Inside Your Car's Dashboard:

Many people on YouTube have already demonstrated how and where to hide the power cable inside your car. You can view one of the possible methods via the link. Please note, this video is NOT recorded by us. (See Page 15)

### 7 How to Transfer Videos to PC/Mac: (See Page 30)

## CAMERA SPECIFICATIONS

<b>Front Chipset / Sensor</b>	NOVATEK 96670/ SONY IMX335
<b>Rear Chipset / Sensor</b>	NOVATEK 96671/GC2093
<b>Lens</b>	150° A+ Ultra HD Wide Angle
<b>Front Video Resolution</b>	3840x2160 @30fps (4K) 2560x1440 @60fps (2K) 1920x1080 @70fps (1080P)
<b>Rear Video Resolution</b>	3840x2160 @30fps (4K) +2560x1440@30fps (2K) 2560x1440 @60fps (2K) +2560x1440@30fps (2K)
<b>Lens Aperture</b>	F 1.8
<b>WiFi</b>	Built-in
<b>Photo / Video Format</b>	JPEG / MP4
<b>Memory Card (Extended)</b>	TF Card Class 10, U3 Speed, Max Support 128 GB
<b>G-Sensor</b>	Built-in 3-Axis Impact Accelerometer Gravitational sensor to lock and protect the current video.
<b>Multi Language Support</b>	English, French, Spanish, Portuguese, Deutsch, Italian, Russian, Simplified Chinese, Traditional Chinese, Japanese, Thai, Polish
<b>Anti Flicker</b>	60 Hz, 50 Hz
<b>Distortion Correction</b>	Support
<b>Loop Recording</b>	Support – seamless recording
<b>G-SENSOR Parking Mode</b>	Support
<b>TIME-LAPSE Parking Mode</b>	Support
<b>Mic / Speaker</b>	Built-in Micro Phone & Speaker: "Start recording". "Start emergency recording". "Restoring factory Settings". "Turn on time-lapse recording".
<b>Power Interface</b>	12V, 2A
<b>Temperature Guideline</b>	Operating Temperature -22° F (-30°C) ~ 166° F (70°C), Working Humidity: 10 – 90%

## PACKAGE CONTENTS



Charging Cable



Dash Cam



Car Wire Trim  
Tool & Cable tie



TF Card



Rear Cam & Rear  
Cam Charging Cable  
(Optional)



User Manual

### NOTE

The picture shows a sample of the main unit. The appearance of each OEM-style dash cam main unit and wiring harness may vary. The specific model will depend on the order selected.

## UNIT STRUCTURE APPEARANCE &amp; BUTTONS

**NOTE**

The picture shows a sample of the main unit. The appearance of each OEM-style dash cam main unit and wiring harness may vary. The specific model will depend on the order selected.

## INSTALLATION

The MANGOAL OEM Style Dash Cam is customized to fit different models. The disassembly, assembly, power supply, and wiring methods vary depending on the specific model's original car accessories. There are three ways to obtain the installation instructions for your order:

- A. Email us at [support@mangoaltech.com](mailto:support@mangoaltech.com) to receive the installation video. We will send it to you within 24 hours and provide further installation guidance.
- B. Download the "SkyCamm" app, go to "MORE" > "Installation Video," find the corresponding model, and click to view the installation video.



- C. Visit the official website of the "MANGOAL" brand to view the installation video for related models. Website: <https://mangoaltech.com/>

## ⚠ CAUTION

Please turn off the car before installation, so as not to cause car failure alarm

## TURNING YOUR CAMERA ON/OFF

- **Auto Power ON:** The MANGOAL OEM-style dash cam is designed to automatically turn on and start recording when it receives power, such as when the car engine is started.
- **Auto Power OFF:** The camera is preconfigured to turn off automatically within a few seconds when the power is disconnected, such as when the car key is turned to the LOCK position.

### NOTE

The first time the recorder is turned on, connect the app to automatically calibrate the clock. Do this only once.

## MANUAL POWER ON/OFF

- **To turn ON manually:** Press the power button once.
- **To turn OFF manually:** Press and hold the power button for at least 2-3 seconds.

### NOTE

Make sure to insert the memory card before powering on the device. Do NOT insert or remove the memory card while the camera is turned ON. Only do so when the camera is turned OFF.

## USING WI-FI FEATURE





### What is the Wi-Fi feature?

The Wi-Fi feature is designed to allow you to connect your smartphone instantly to the dash cam. This lets you easily view, download, and share your videos with friends and family. Just as you would connect your Bluetooth speaker to your smartphone for wireless music playback, dash cameras use WiFi (instead of Bluetooth) to pair with your smartphone.

### What is the Wi-Fi feature?

The Wi-Fi signal range is approximately 10 feet when there are no obstructions in between. Please note that, just like your home WiFi network, you cannot expect the WiFi signal to extend beyond the device. The range is limited to about 10 feet from this small device.

### Can I watch the videos or surveillance around my car remotely?

This dash cam is not designed to broadcast footage over the cloud or internet. It is neither a cloud camera nor an IP camera and is not intended for that purpose. You can view live video and footage on the SkyCamm app as long as you remain within a 10-foot range of the dash cam.

### NOTE

Regarding the issue of the camera WiFi not being connected to the internet, which affects internet access on mobile phones:

This is normal because the MANGOAL dashcam's WiFi is not connected to the internet. The WiFi's purpose is solely to transfer or download videos and photos recorded on the memory card to the app. It operates as expected whether you're driving or not using it, and there is no need for an internet connection. After using the camera, be sure to delete its WiFi or select "Forget This Network" from your phone's WiFi list. This will prevent your phone from automatically reconnecting to the camera's WiFi the next time you start the car. This will also help avoid interference with your phone's normal internet access.

## Connect your Dash cam with your Smart Phone using Wifi



1

Search for "SkyCamm" in the App Store or Google Play Store to find the app. Then, download and install it on your phone.



Wi-Fi Name: WiFi\_USB529 Pro\_XXXX  
Wi-Fi Password: 12345678

2

Scan the QR code above to download the app.

### NOTE

1. Please make sure the APP is updated to the latest version, Android: v1.0.47.250110, IOS: v1.2.2 (as of March 1, 2025, If there is a newer version, please click Upgrade), We have fixed common connection bugs. Please click "More"-"About" in the lower right corner of the APP main interface to view the APP version number. If it is not the latest version, please click Upgrade. Of course, the best option is to delete the APP and then search and download the latest version.

If the iPhone system version is IOS 18.0/18.1/18.2/18.3 or later, During the process of downloading the APP, click Allow on the various options that pop up to prevent the mobile phone from blocking the camera WIFI. please make sure to turn on the "Local Network" permission of the APP: iPhone "Settings" >> "Apps" at the bottom >> click "SkyCamm" to turn on "Local Network". Then restart your phone and try again.

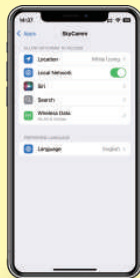

2. Download another APP "Viidure" and try to connect.  
A、 Search "viidure" in App Store  
Search "viidure" in Google Play Store

## NOTE



B. Scan the QR code below to download.



\* If the above methods still cannot solve the problem, please install "Feedback" on page 44 to submit a log, take a screenshot of the submission interface or send the filled contact details to the email: [support@mangoaltech.com](mailto:support@mangoaltech.com). We will help you solve it.

Thank you in advance for your time and patience!

## SHORTCUTS & UNDERSTANDING BUTTONS

BUTTON IMAGE	BUTTON NAME	SHORTCUTS / FUNCTIONS	ACCOMPANIED BY VOICE REMINDER
	<b>POWER BUTTON</b>	To Turn ON The Camera: Press power button once.	Dong Dong Dong
		To turn off the camera: Press and hold the power button for 5 seconds.	Dong Dong Dong
		To turn on/off the Wi-Fi: Press the power button once (the camera will be on).	Wi-Fi is turned on/ Wi-Fi is turned off.
	<b>PHOTO BUTTON</b>	To take a photo: Press the photo button once.	Ka Ka
		Reset: Long press the photo button for 10 seconds.	SD format completed

## LED STATUS LIGHT INDICATOR

SOLID RED LED - Wi-Fi not working

NO RED LED - Wi-Fi is working.

BLINKING BLUE LED - Video Recording Started

SOLID BLUE LED - Stop Video Mode

SOLID RED LED - Rear cam is working

NO RED LED - Rear cam not working

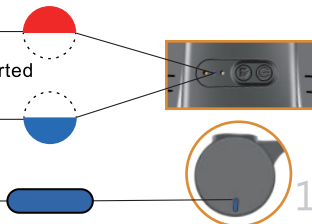

## CONNECTING DASH CAM WITH SMARTPHONE

**TURN ON WiFi FROM THE CAMERA:** The dash cam powers on, and WiFi starts working automatically.

**CONNECT TO WiFi:** Simply join the dash cam's WiFi by going to your iPhone or Android phone's Settings > WiFi > WiFi\_USB529 Pro\_XXXX. Then, enter the default password: 12345678, and connect to the network.

**OPEN THE SKYCAM APP:** Once your phone is successfully connected to WiFi, open the SkyCamm App. The camera will sync automatically. You should now see the live video feed from the camera on the SkyCamm app. Feel free to continue exploring the app from here.

\*The camera WiFi will go into sleep mode if there is no connection for 5 minutes after the dashcam is turned on and will disappear from the phone's WiFi list. You can activate WiFi by pressing the camera power button once

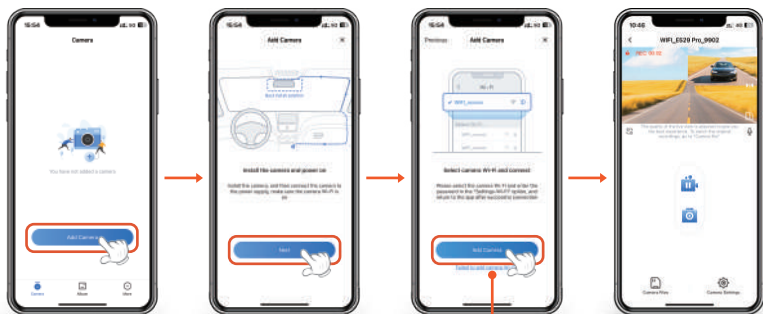

If a reminder appears indicating that the camera Wi-Fi failed to be added, please click "Failed to add camera Wi-Fi?" below to access the troubleshooting guide.

## For Android phones:

Once you connect to WiFi or open the SkyCamm app, it will display "No Internet," which is normal. Wait about 5-10 seconds until you see the pop-up notification below. Simply tap on the pop-up notification that appears to confirm that you want to stay connected, even though there is no internet. Once you select "OK," you're all set. Please contact us if you need any assistance.

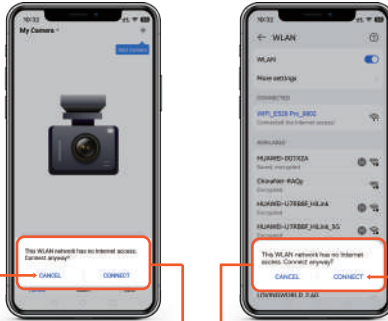

Once you enter the default Wi-Fi password and tap "Connect," you will see this pop-up within a few seconds.

Then, tap "Connect" to stay connected to this Wi-Fi and save the preference.

\*Some phones do not display this reminder and do not require any action.

## NOTE

Android & Other Systems Settings:

A. Turn off the smart network switching on your phone:

Go to "Settings" > "WLAN" > "Advanced Settings" > "WLAN Assistant."

Disable the "Smartly connect to the best WLAN network" option.

\*The settings may vary by phone model.

Since the dashcam Wi-Fi cannot connect to the internet, your phone will automatically switch to mobile data once connected. This prevents your phone from accessing the internet through the dashcam Wi-Fi.

B. Enable "SkyCamm" app permissions:

Open "Settings" on your phone. Find the "SkyCamm" app and open permission management. Enable the main permissions like "GPS Location," "Storage," and "WLAN Link."

C. After connecting to the camera Wi-Fi, your phone may display a prompt indicating no internet access. Please click "Keep WLAN Connection."

D. Turn off cellular data.

E. Enable Bluetooth.

\*After adjusting these settings, exit the app, restart it, and try connecting again!

## For iPhone:



If you see this pop-up on your iPhone while using the Wi-Fi feature, make sure to tap "Keep Trying WLAN." Otherwise, the camera will disconnect from the Wi-Fi, and you'll need to forget the network and pair it again to make it work.

## NOTE

## IOS IPHONE Settings:

A、Set "SkyCamm" APP permissions: 1. Click "Settings" on the phone to enter the operation interface; 2. Swipe down to find the "SkyCamm" APP and click to enter; 3. Click "Location" to select "While Using the App" or "Always", click "Wireless Data" and select "WLAN & Cellular Data". Then exit the settings and try again.

B、Turn off the Cellular Data. (It is not necessary to close, which is more conducive to connection)

C、Turn off the Bluetooth. (It is not necessary to close, which is more conducive to connection)





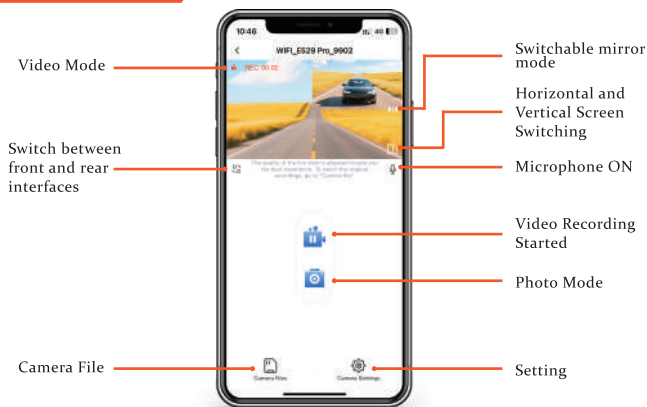

D、"Local Network" Select to turn on.





\*After adjusting the settings, exit the app and restart it. Try connecting again!

## APP HOME SCREEN



## Home Screen Status Icons

ICONS	WHAT DOES IT MEAN?
	Video Recording Started
	Photo Mode
	Setting
	Camera File
	Horizontal and Vertical Screen Switching
	Switchable mirror mode

ICONS	WHAT DOES IT MEAN?
	Microphone ON
	Microphone OFF
	Switch between front and rear interfaces
	Video Mode
	Stop Video Mode

## INSERTING/REMOVING A MICRO TF CARD

### ■ TF Card: MANGOAL Style Dash Cam

The position of the TF card slot is reserved. Insert the memory card directly into your PC or Mac to view or download the files.



### 1 TO INSTALL

Ensure the car is stalled first. Then, align the GOLD CONTACTS facing up and insert the memory card halfway in. Use your fingernail or a paper clip to push the card all the way in until it clicks and locks into place.

### 2 TO REMOVE

To remove the Micro TF card, gently push its edge inward until it clicks and pops out. Then, simply pull it out of the slot.

## NOTE

The locked pictures and videos on the memory card will not be overwritten cyclically. To maintain stability, please format the memory card every 2-3 months.

**FORMAT SD CARD**

Ensure your smartphone is successfully connected to WiFi. Open the SkyCamm app to view the live video feed from the camera.

- 1 Click on the bottom  right corner of the screen to open the settings interface. Scroll down to locate the option labeled "Format SD Card."



- 2 Click on "Format SD Card." When the following reminder appears, click "Confirm" to begin formatting.

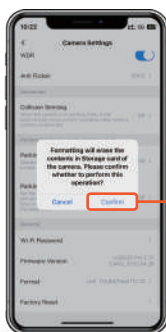
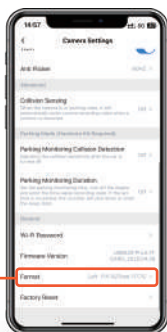



- 3** If the formatting is successful, a "Format succeeded" reminder will appear. This message confirms that the formatting process is complete.

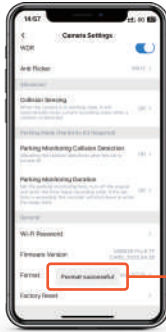

## UNDERSTANDING 3 – CAMERA MODES

MANGOAL Style Dash Cam 3 different camera modes:



- 1. VIDEO MODE**
- 2. PHOTO MODE**
- 3. PLAYBACK MODE**

### 1. VIDEO MODE:



- 1 Video mode allows you to record live videos and store them on the installed microSD card.
- 2 Click the preview interface icon to switch between play and pause functions.



### While in the Video Mode:

- The LED status light indicator flashes a blue light every second. ●
- Press the  button once to take a snapshot.
- Press the  button once to turn the Wi-Fi on/off.



### 2. PHOTO MODE:

### While in the Photo Mode:

- Press the  button once to take a snapshot.
- Press the  button once to turn the Wi-Fi on/off.

### 3. PLAYBACK MODE:

Playback mode allows you to play your video files or photos. It also lets you delete or lock any videos while viewing them.

## Playback Your Recorded Videos

There are 2 different ways you can access your videos.

### A. APP On Smart Phone

To play on your smartphone, simply connect to Wi-Fi and open the correct SkyCamm app for your model.

(For more step-by-step instructions on the Wi-Fi feature, see page 20 for details.)

- 1 Enter the app's main preview interface. Click the '  ' icon in the lower left corner and wait 3-5 seconds to access the camera file.

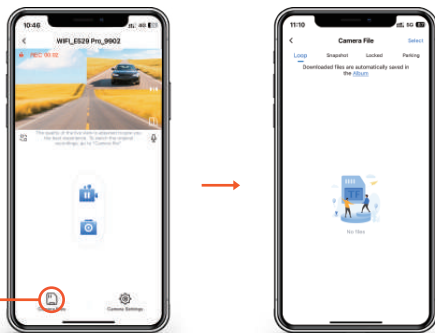

### NOTE

When you enter the camera file to view the video, the recorder automatically pauses recording, and exits the camera file to automatically start recording!

## 2 There are four options in the "Camera File":

- "Loop" stores all the videos recorded by the recorder in a continuous loop. The videos are arranged from top to bottom according to the recording time, with the latest video at the top.
- "Snapshot" stores the photos captured by the recorder.
- "Locked" stores videos saved by the recorder after collision sensing is triggered.
- "Parking" stores videos recorded in the two parking monitoring modes: "G-SENSOR PARKING MODE" and "TIME-LAPSE VIDEO MODE."

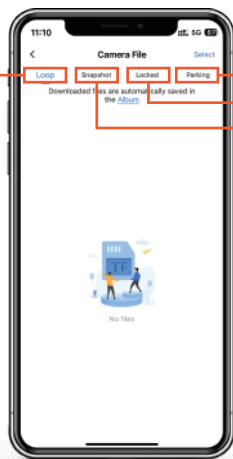

## Playback operation

Click on any picture or video to view and play.

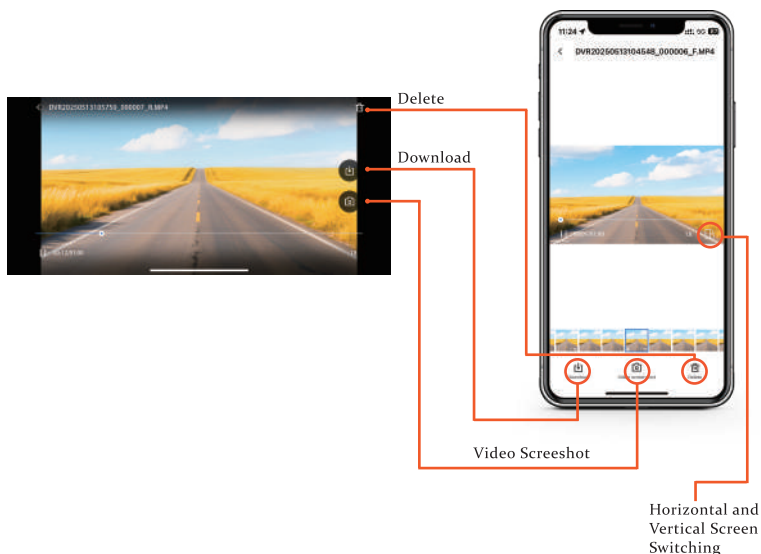

## NOTE

The video downloaded using the "Download" function is saved in the "Album" app, not in the phone's local photo album (see page 46).