

JSK-L30 Instructions

(2024 Edition)

Bedside lamp controlled by Tuya APP, with built-in Bluetooth Speaker, white noise, and alarm clock functions

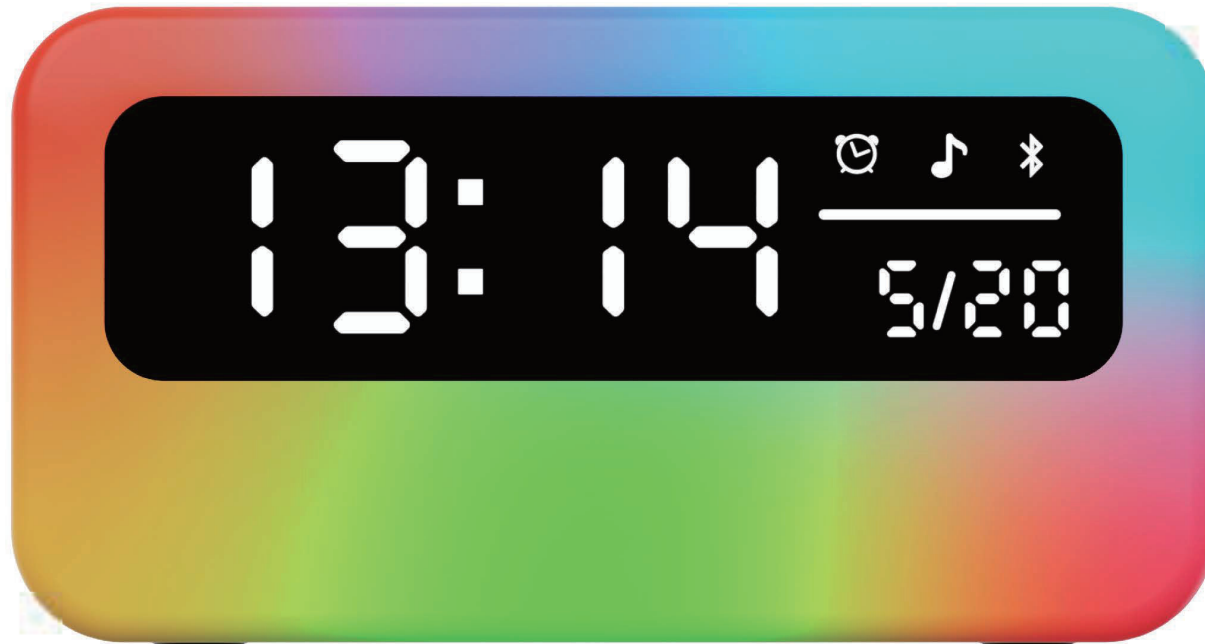

Thank you for using this product. Please read the safety precautions in detail:

- Applicable adapter specifications: AC: 100-240V Type-C: 5V/2A
- Please check if the input power supply of the controller (which must be matched with the controller power supply voltage) meets the product requirements.
- Please do not repair any problems without authorization. If you have any questions, please contact the supplier.

1. Product Introduction:

- The product is an intelligent blue-tooth speaker alarm clock, which can be connected to 2.4G Bluetooth network.
- You can use a mobile app or physical buttons to turn on and off the lights, or switch the color, brightness, scene mode, white noise, and Bluetooth music of the lights.
- After connecting to the Tuya app, the display time will be automatically updated.
- The product has 7 physical buttons.

Product Button Function Definition



Bluetooth/white noise button: Short press to activate Bluetooth or white noise function; Long press to forcibly clear the device connection information of the Tuya app and enter the network configuration.



Clock brightness adjustment key: 4-level brightness adjustment 0% -30% -65% -100% cycle.



Play/Pause key: Short press to play or pause.



Phantom lighting effect key: Short press to turn on phantom scene lighting or switch between various phantom scene lighting, long press to turn off phantom lighting.

- ① Static light adjustment: Short press to turn on static lights or switch between eight static lights, long press to turn off lights.
- ② Previous key: In Bluetooth/white noise mode, short press to activate the previous song function, and long press to activate the volume reduction function.
- ③ Next key: In Bluetooth/white noise mode, short press to activate the next song function, long press to activate the Volume increase function.

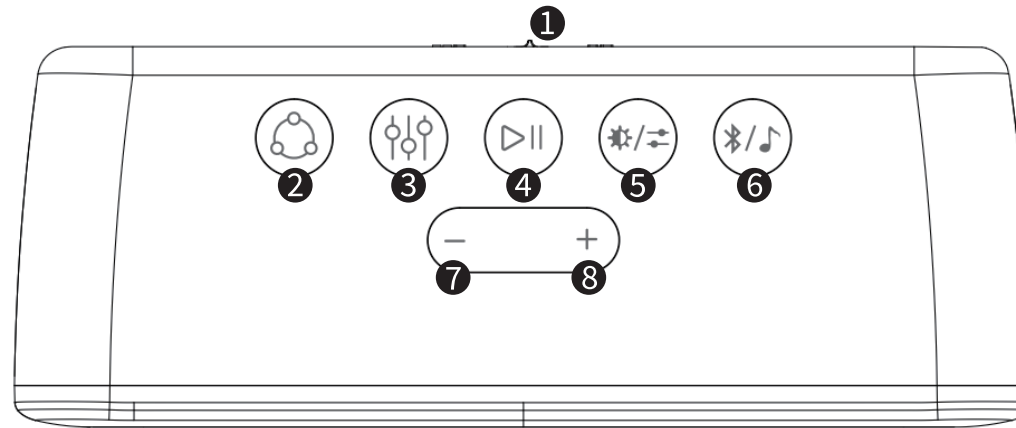

- ① On/off
- ② Short press to turn on static lights or switch between seven static lights, long press to turn off lights.
- ③ Short press to turn on phantom scene lighting or switch between various phantom scene lighting, long press to turn off phantom lighting.
- ④ Short press to play or pause.
- ⑤ 4-level brightness adjustment 0% -30% -65% -100% cycle

- ⑥ Short press to activate Bluetooth or white noise function; Long press to forcibly clear the device connection information of the Tuya app and enter the network distribution function.
- ⑦ In Bluetooth/white noise mode, short press to activate the previous song function, and long press to activate the volume reduction function.
- ⑧ In Bluetooth/white noise mode, short press to activate the next song function, long press to activate the Volume increase function.

2. APP Description:

- The product supports the Tuya APP; After entering the APP operation page, users can switch and set the light on/off, alarm clock, color, brightness, and scene mode ;

The Apple app requires iOS 10.0 or higher, while Android requires Android 4.4 or higher ;



Search for the "Tuya" app on the user's mobile app store to download, install, and register. You can also scan the QR code for installation and registration:

3. Add products within the app:

- Before adding a product, please confirm that the Bluetooth on your phone is turned on and the product is correctly connected before connecting to the power.
- When the red light flashes rapidly, it indicates that the current status is in the network configuration, and the mobile phone logs in to the Tuya app.
Enter the product addition interface through the (+) in the upper right corner of the welcome interface on the APP homepage or the (Add Device) in the middle of the page.

When configuring the network, please first turn on your phone's Bluetooth.

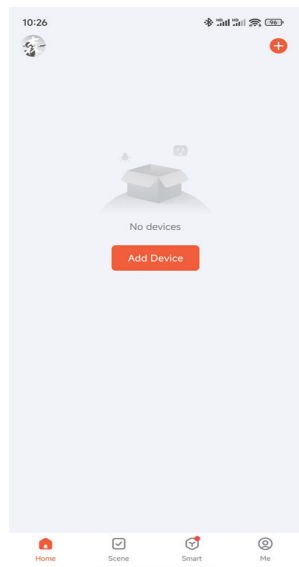

1

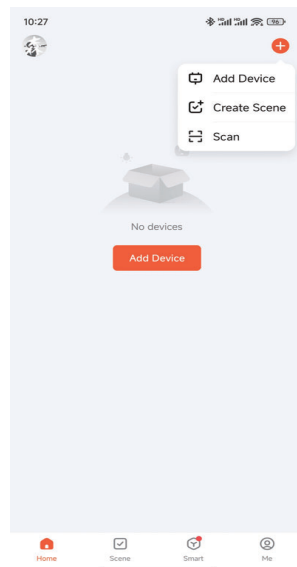

2

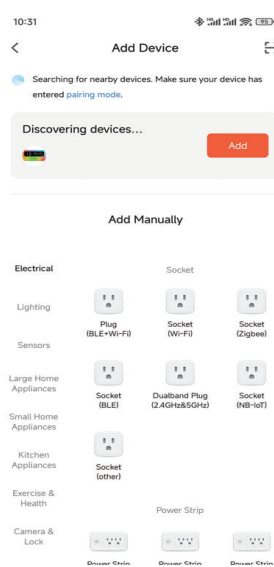

3

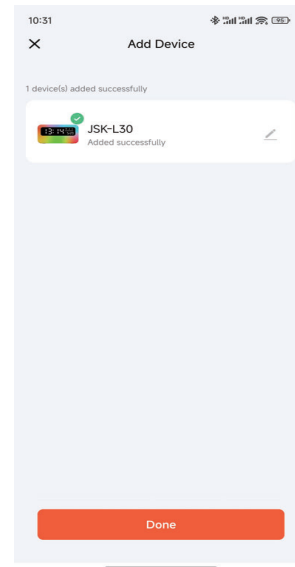

4

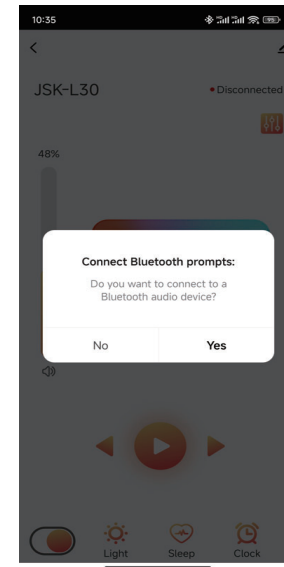

5



6

4. APP product control interface: (on/off-light effects-sleep-alarm clock)

Open the Bluetooth search device JSK-L30 in the phone settings, add the device and connect successfully. You can choose to play music on the app interface. Click  to turn off the light effect and multi coal.

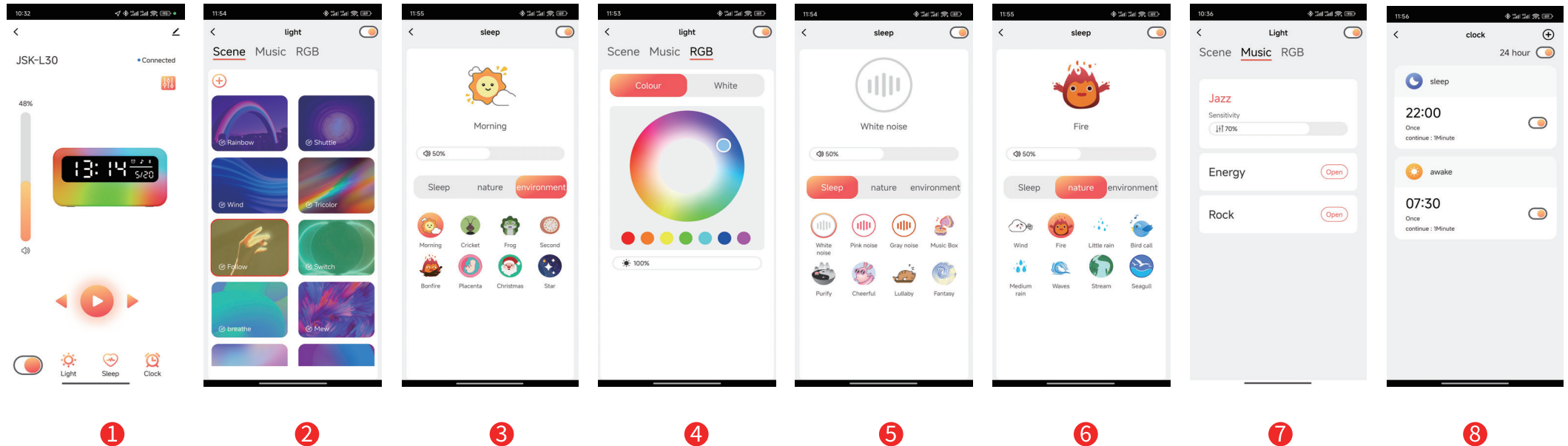

Figure 2/8 Scene Interface (18 in total): Scene modes can be switched freely.

Tricolor Flow / Shuttle / Wind Chasing / Rainbow / Chasing Light / Open and Close / Breathing / Dream / Gradient Drift / Neon Colorful / Rebound / Meteor / Embrace / Collision / Bloom Random / Flash

Figure 3/8 Music Rhythm (3 in total) :

Jazz / Energy / Rock

Figure 4/8 RGB :

There are seven options for colored lighting / white light .

Figure 5-7/8 White Noise Tracks :

Sleep Series:

White noise / Pink noise / Lebron's sound / Music boxZen / Happy / Calming / Fantasy

Nature Series:

Wind / Fire / Light / rain / Birdsong / Moderate rain / Ocean / waves / Stream / Seagulls

Environment Series:

Early morning / Crickets / Frogs / Clock / Bonfire / Umbilical cord / Christmas / Stars

Figure 8/8 Alarm Clock

5. APP product control interface:

Click  in the upper right corner of the product control interface to exit the APP, as shown in the figure above, click  to remove the device.

6. Regarding unexpected power outages and network reconfiguration:

• Unexpected power outage

The app displays a pop-up notification for device connection failure. After repowering on, the product returns to its pre-power off settings. After returning to the homepage of the app, scroll down to refresh in the blank space, and the product will automatically reconnect.

• Redistributing the network

If you need to disconnect the APP from the product, you can remove the device through the APP or press and hold the physical button of the product for 5 seconds to force the product into network configuration mode.

7. Product parameters

Product name	Bedside lamp
Model	JSK-L30
Battery capacity	4000mAh
Control mode	Tuya APP and Button
Power	6W
Input power supply	Tpye-C : 5V = 2A
Working hours	2 - 8 Hrs
Charging time	3 - 3.5 Hrs

FCC WARNING:

This device complies with part 15 of the FCC Rules. Operation is subject to the following two conditions:

- (1) this device may not cause harmful interference
- (2) this device must accept any interference received, including interference that may cause undesired operation.

Any changes or modifications not expressly approved by the party responsible for compliance could void the user's authority to operate the equipment.

FCC WARNING

This device complies with part 15 of the FCC Rules. Operation is subject to the following two conditions: (1) this device may not cause harmful interference, and (2) this device must accept any interference received, including interference that may cause undesired operation.

Any changes or modifications not expressly approved by the party responsible for compliance could void the user's authority to operate the equipment.

NOTE: This equipment has been tested and found to comply with the limits for a Class B digital device, pursuant to Part 15 of the FCC Rules. These limits are designed to provide reasonable protection against harmful interference in a residential installation. This equipment generates, uses and can radiate radio frequency energy and, if not installed and used in accordance with the instructions, may cause harmful interference to radio communications.

However, there is no guarantee that interference will not occur in a particular installation.

If this equipment does cause harmful interference to radio or television reception,

which can be determined by turning the equipment off and on, the user is encouraged to try to correct the interference by one or more of the following measures:

- Reorient or relocate the receiving antenna.
- Increase the separation between the equipment and receiver.
- Connect the equipment into an outlet on a circuit different from that to which the receiver is connected.
- Consult the dealer or an experienced radio/TV technician for help.

To maintain compliance with FCC's RF Exposure guidelines, This equipment should be installed and operated with minimum 20cm distance between the radiator and your body: Use only the supplied antenna.