

PRODUCT INTRODUCTION

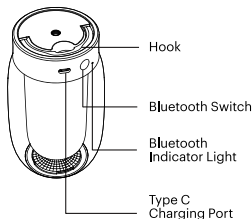
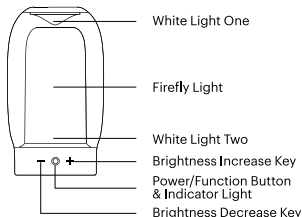

SPECIFICATIONS

Product Name:	Unigear Enchantglow
Model:	LTN0123FS
Battery Capacity:	3.7V 8700mAh
Input:	5V 3A
Luminous Flux:	200+100 lumens
Color Temperature:	4000K
Water Resistance:	IP67
Dimensions:	89mm * 89mm * 155mm
Weight:	410g
Packaging Contents:	Unigear Enchantglow / Type-C Data Cable / Manual / Instruction bag

HOW TO USE

Power On/Off:	Press and hold the Power/Function Button for 2 seconds to turn on/off.
Mode Switching:	Single press the Power/Function button to switch between White Light Mode and Firefly Mode.
White Light Mode:	Enchantglow and the light on the bottom off, flipping the lamp will automatically switch.



1 Upright

White Light 1 on,
White Light 2 off



2 Inverted

White Light 2 on,
White Light 1 off

Single press the Brightness Increase Key and Brightness Decrease Key to adjust the brightness of the white light (three levels), long press the Brightness Increase Key/ Brightness Decrease Key to infinitely adjust the brightness of the white light.

		White Light One(lm)	White Light Two(lm)
Upright	Level One	40	0
	Level Two	100	0
	Level Three	200	0
	Infinite Dimming	40 - 200	0
Inverted	Level One	0	20
	Level Two	0	50
	Level Three	0	100
	Infinite Dimming	0	20 - 100

Firefly Mode

In Firefly Mode, Enchantglow can change the state of fireflies by shaking the lamp (this function can be turned off in the APP), the more intense the shaking, the more fireflies, and the faster they will fly.

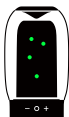

1

A few fireflies in a resting state



2

A moderate amount of fireflies flying slowly with gentle shaking

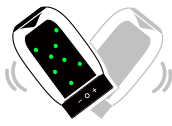

3

A large number of fireflies flying swiftly with vigorous shaking

Battery Indicator

When turned on without charging:

When the battery indicator light is white and always on, the remaining battery is 60%-100%

When the battery indicator light is orange and always on, the remaining battery is 30%-60%

When the battery indicator light is red and always on, the remaining battery is 5%-30%

When the battery indicator light is red and flashing, the battery is below 5%

When charging:

When charging 0%-30%, the red light flashes. When charging 30%-60%, the orange light flashes

When charging 60%-99%, the white light flashes. When fully charged, the white light remains on

Bluetooth Switch

1. After turning on, the Bluetooth is turned on by default and is in the pairing state, at this time the Bluetooth indicator light flashes blue.

2. If Enchantglow is not connected to the APP after more than 5 minutes after turning on, the Bluetooth will automatically turn off, and the Bluetooth indicator light will go out, you can press and hold the Bluetooth switch for 2 seconds to turn on the Bluetooth again or turn off the Bluetooth again.

3. After Enchantglow is successfully connected to the APP, the Bluetooth indicator light remains on.

App Connection

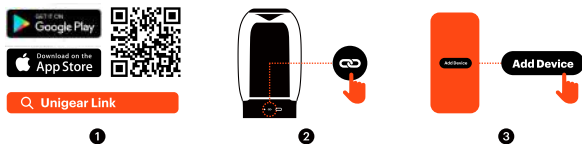

1. Download the Unigear Link APP from Google Play or APP Store
2. Make sure that Enchantglow is turned on and the Bluetooth is turned on and in the pairing state.
3. Bring the phone close to Enchantglow, click on 'Add Device' in the APP, and find Unigear Enchantglow to click and connect. After the connection is successful, the APP will automatically jump to the control page of Enchantglow, and the Bluetooth indicator light of Enchantglow changes from flashing to always on.

TROUBLESHOOTING AND PRECAUTIONS

Troubleshooting

If Enchantglow does not work properly:

1. Turn off and then turn on again.
2. Plug in the charger to confirm if there is electricity
3. Long press/short press the plus/minus key below the lamp

Precautions

1. Do not put the product into the fire
2. Do not place Enchantglow in the liquid before removing the power cord. In addition, do not put Enchantglow into the water during charging. Do not charge when the charging port is damp.
3. Do not store for a long time when the battery is completely discharged, lithium battery products should be charged at least once every three months during storage
4. The product should be stored in a cool and dry place, avoid direct sunlight, and the storage temperature should be -17°C-43°C (0°F-110°F)

WARRANTY

As the manufacturer, we provide a one-year warranty for this product from the date of purchase. During the warranty period, we will take remedial measures and bear the corresponding costs for any defects caused by poor materials or manufacturing, and we will decide to repair or replace the device on our own. The following are not included in the warranty: Damage caused by improper use; normal wear and tear that has little effect on the value or usability of the device. If the device has been modified by an unauthorized organization, or uses other independent parts not originally produced by Unigear, this warranty will become completely invalid.

FCC Warning

This device complies with Part 15 of the FCC Rules. Operation is subject to the following 2 conditions: (1) This device may not cause harmful interference, and (2) this device must accept any interference received, including interference that may cause undesired operation.

*Note 1: This equipment has been tested and found to comply with the limits for a Class B digital device, pursuant to part 15 of the FCC Rules. These limits are designed to provide reasonable protection against harmful interference in a residential installation.

This equipment generates, uses and can radiate radio frequency energy and, if not installed and used in accordance with the instructions, may cause harmful interference to radio communications. However, there is no guarantee that interference will not occur in a particular installation. If this equipment does cause harmful interference to radio or television reception, which can be determined by turning the equipment off and on, the user is encouraged to try to correct the interference by one or more of the following measures:

- Reorient or relocate the receiving antenna.
- Increase the separation between the equipment and receiver.
- Connect the equipment into an outlet on a circuit different from that to which the receiver is connected.
- Consult the dealer or an experienced radio/TV technician for help.

*Note 2: Any changes or modifications to this unit not expressly approved by the party responsible for compliance could void the user's authority to operate the equipment. The device has been evaluated to meet general RF exposure requirement. The device can be used in portable exposure condition without restriction.

IC Warning

This device complies with Industry Canada's license-exempt RSSs. Operation is subject to the following two conditions:

(1) This device may not cause interference; and (2) This device must accept any interference, including interference that may cause undesired operation of the device.

« Le présent appareil est conforme aux CNR d'Industrie Canada applicables aux appareils radio exempts de licence.

L'exploitation est autorisée aux deux conditions suivantes:

- (1) l'appareil ne doit pas produire de brouillage, et
- (2) l'utilisateur de l'appareil doit accepter tout brouillage radioélectrique subi, même si le brouillage est susceptible d'en compromettre le fonctionnement. »

The device has been evaluated to meet general RF exposure requirement. The device can be used in portable exposure condition without restriction.

L'appareil a été évalué pour répondre aux exigences générales en matière d'exposition aux RF. L'appareil peut être utilisé en condition d'exposition portable sans restriction.

EC Declaration of Conformity

<https://xinqianchao.com/doc/LTN0123FS.pdf>