

GIRAFFE GO CAM

Safety Manual and QuickStart Guide

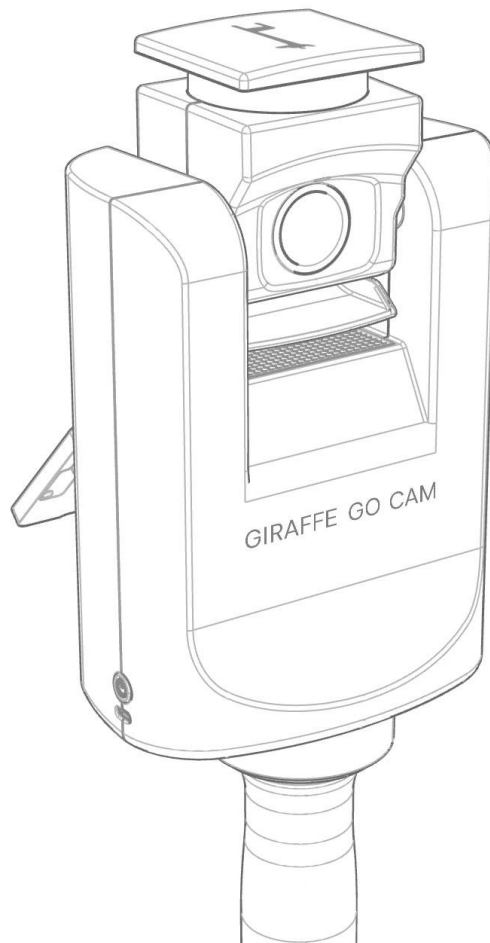

Version 0.1
English

Table of content

1.	Introduction.....	3
2.	Safety Directions.....	3
3.	What is included	4
4.	Parts and Controls.....	4
5.	Camera Setup.....	5
6.	Legal Statements.....	9
7.	Laser Classification.....	10
8.	Electromagnetic Compatibility (EMC).....	11
9.	Repair.....	11
10.	Information about the Manufacturer.....	11

1. Introduction

This Manual contains important safety directions as well as instructions for setting up and operating GIRAFFE GO CAM. User must carefully read this Manual before switching on the device.

For the users' safety, all safety instructions and safety messages shall be strictly observed and followed. The Manual must always be available to all persons performing any tasks described here.

Giraffe360 reserves the right to make any modification to this Manual or the information contained herein at any time without notice.

2. Safety Directions

2.1. Intended Use

This device is part of service provided by Giraffe360 or its group companies and is intended to be used in the real estate market. This device is intended to capture still photos of properties as well as to measure distance of surrounding area, by scanning the property. Device provides data for uploading to Giraffe360 or third-party software that makes the end-product available to the user in its dashboard or by other means.

2.2. Hazard Warnings

Distraction or loss of attention

During dynamic applications, there is a danger of accidents occurring if the user does not pay attention to surrounding environmental conditions, for example obstacles, excavations or traffic.

Dropping, misusing, storing the product for long periods or transporting the product

Watch out for erroneous measurement results. Periodically carry out test measurements, particularly after the product has been subjected to abnormal use.

Limits of use This device is suitable for use in an atmosphere appropriate for permanent human habitation and it is not suitable for use in aggressive or explosive environments.

Moving parts of the product during operation

Risk of squeezing extremities or entanglement of hair and/or clothes. Keep a safe distance from the moving parts.

Handling device containing batteries.

Exposure of batteries to high mechanical stress, high ambient temperatures or immersion into fluids can cause leakage, fire or explosion of the batteries. Protect the batteries from mechanical influences and high ambient temperatures. Do not drop or immerse the device into fluids.

Improperly repaired equipment

Risk of injuries to users and equipment destruction due to lack of repair knowledge. Only the representatives of Giraffe360 or its authorised service centres are entitled to repair the product. Use of damaged or repaired equipment is prohibited.

Radiation exposure

Use of controls or adjustments or performance of procedures other than those specified herein may result in hazardous radiation exposure.

Laser exposure

This product has one Class1 laser. Do not point laser or allow laser light to be directed or reflected toward other people or reflective objects. Use other than as described in the User Manual could result in hazardous exposure and cause potential hazard to eyes or skin. Do not look intentionally from close distance in laser scanner optical window.

Unauthorised opening of the product

Either of the following actions may cause the user to receive an electric shock:

1. Touching electronic components or boards.
2. Using the product after attempts were made to carry out repairs.

Do not open the product! Only the representatives of Giraffe360 or its authorised service centres are entitled to repair the device.

Electric shock due to use under wet and severe conditions

If unit becomes wet it may cause the user to receive an electric shock.

If the device becomes humid, it must not be used.

Use the device only in dry environments, for example in buildings or outdoors when it is not raining. Protect the device against humidity.

3. What is included

- | | |
|------------|------------------------------|
| 1. Camera | 5. USB-C charging cable |
| 2. Tripod | 6. USB-C to USB dongle |
| 3. Bag | 7. Pin tool for reset button |
| 4. Charger | 8. Microfiber cloth |

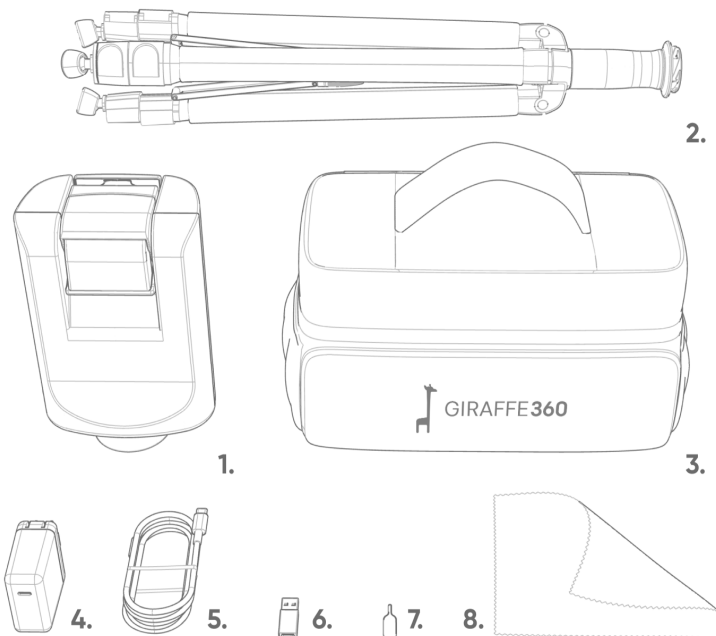

4. Parts and Controls

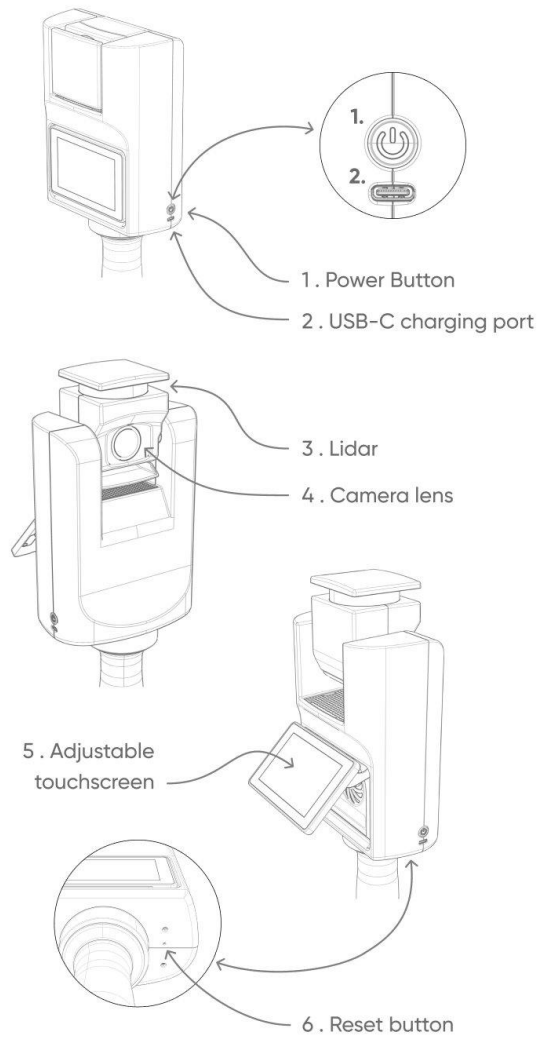

5. Camera Setup

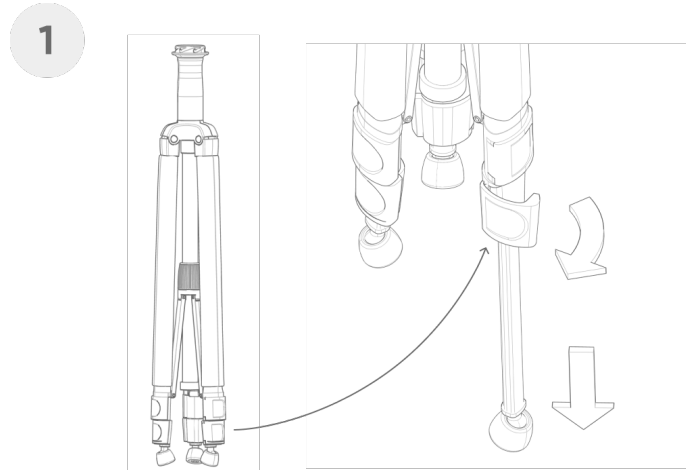

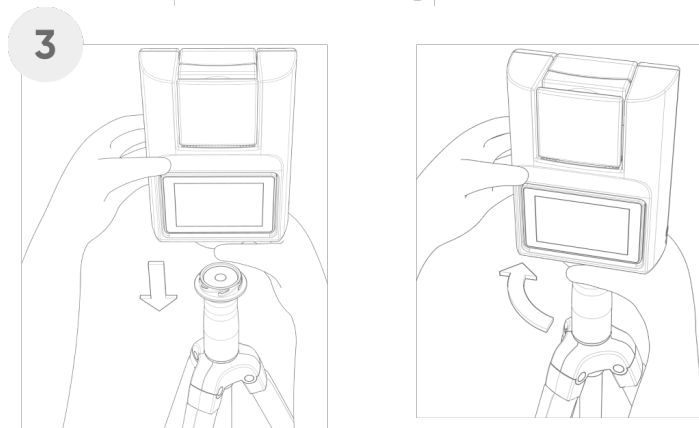
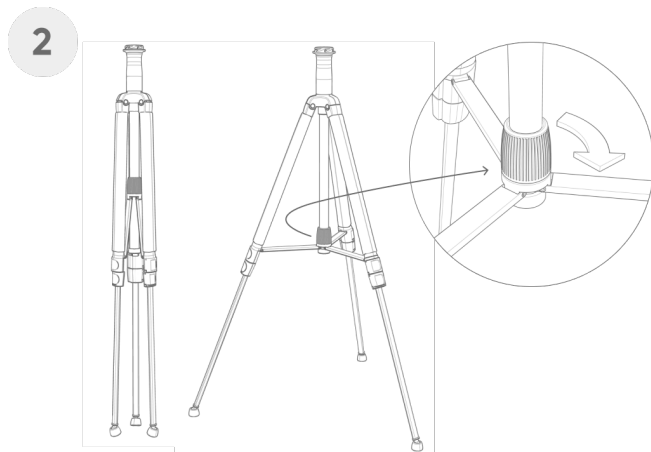

Place the camera on the tripod and secure it.

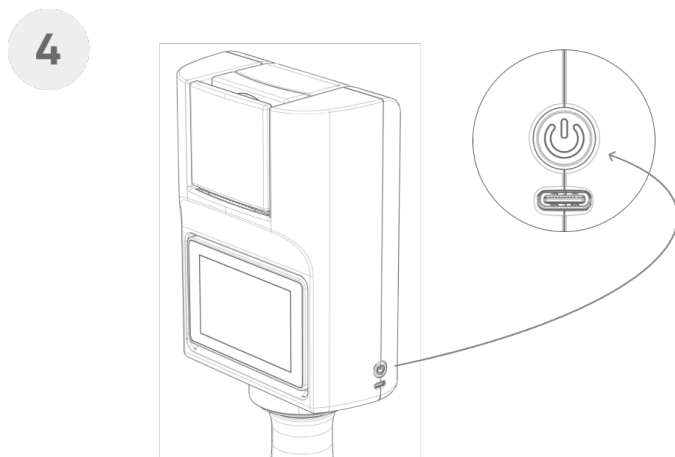

Hold power button to turn the camera ON.

5

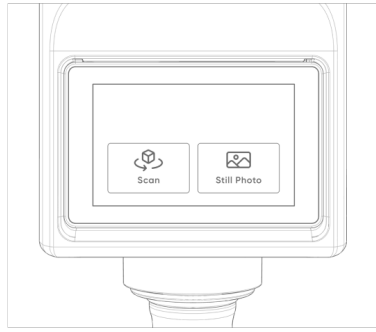

Scans – create panoramas, virtual tours, and floor plans.

Still photos – create HDR property photography.

6

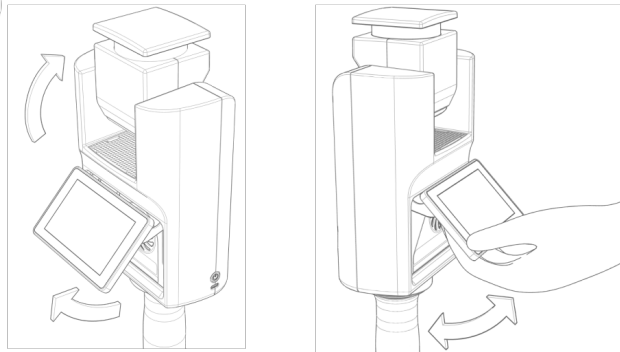

On first capture the screen and lens will open.

You can also adjust the screen manually.

7

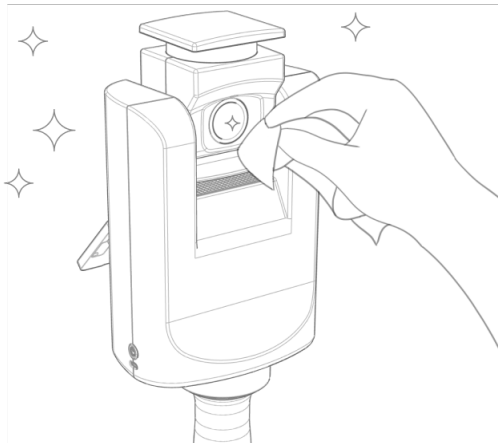

For better image quality make sure the lens is clean.

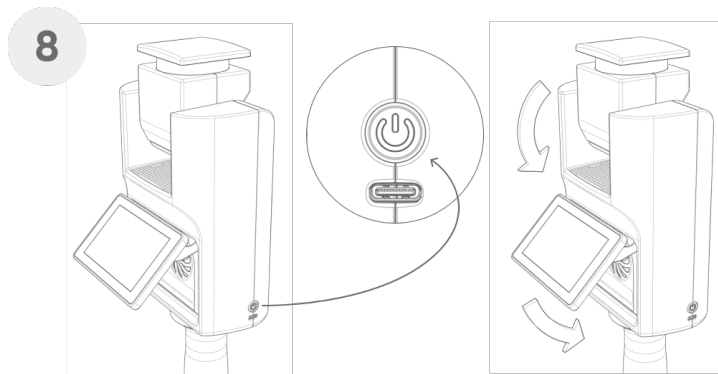

Hold power button to turn the camera OFF.
The screen and lens will close after that.

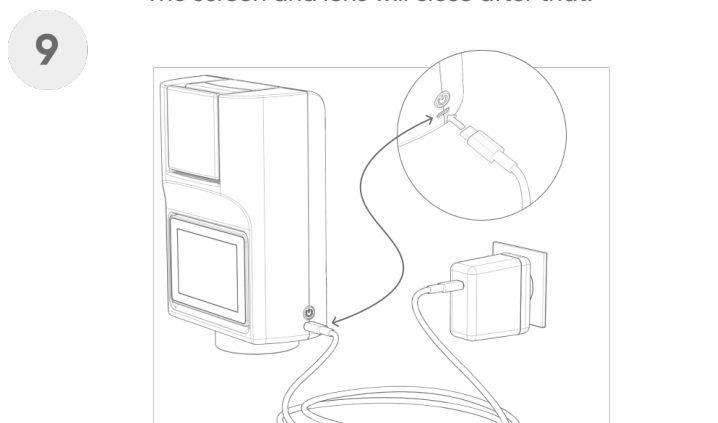

To charge the camera, plug the AC adapter into the
AC outlet and the USB-C port into the camera.

Power Supply Requirements

EU	GEV192-9 230 V~
US	GEV192-9 120 V~
CN	GEV192-9 230 V~
UK	GEV192-9 230 V~

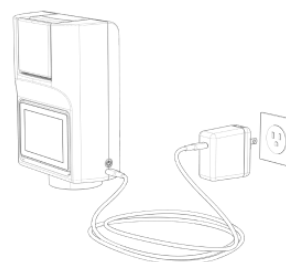

6. Legal Statements

6.1. Federal Communications Commission (FCC) compliance statement, applicable in U.S.

This device complies with Part 15 of the FCC Rules. Operation is subject to the following two conditions:

1. this device may not cause harmful interference, and
2. this device must accept any interference received, including interference that may cause undesired operation.

This equipment has been tested and found to comply with the limits for a Class A digital device, pursuant to part 15 of the FCC Rules. These limits are designed to provide reasonable protection against harmful interference when the equipment is operated in a commercial environment. This equipment generates, uses, and can radiate radio frequency energy and, if not installed and used in accordance with the instruction manual, may cause harmful interference to radio communications. Operation of this equipment in a residential area is likely to cause harmful interference in which case the user will be required to correct the interference at his own expense.

This equipment complies with FCC / ISSED radiation exposure limits set forth for an uncontrolled environment. This equipment should be installed and operated with minimum distance of 10cm between the radiator and your body. This transmitter must not be co-located or operating in conjunction with any other antenna or transmitter.

Changes or modifications not expressly approved by Giraffe360 for compliance could void the user's authority to operate the equipment.

6.2. Food and Drug Administration (FDA) compliance statement, applicable in US

The equipment is Class 1 laser product. This equipment complies with FDA performance standards for laser products except for conformance with IEC 60825-1 Ed. 3., as described in Laser Notice No.56, dated May 8, 2019.

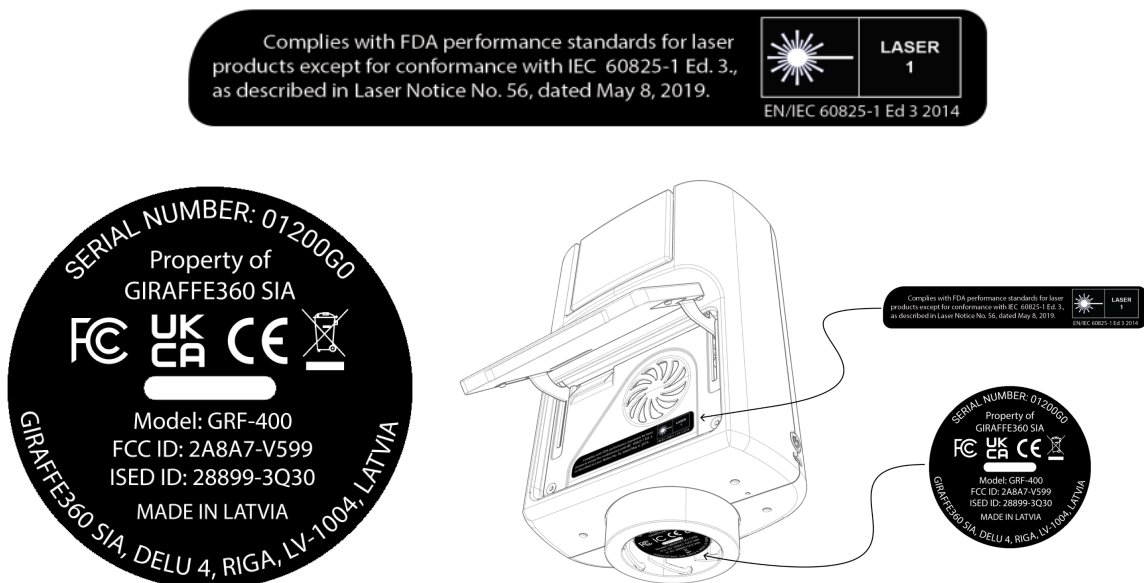

6.3. ISED Canada compliance statement, applicable in Canada

This device contains license-exempt transmitter(s)/receiver(s) that comply with Innovation, Science and Economic Development Canada's licence-exempt RSS standard(s). Operation is subject to the following two conditions:

1. this device may not cause harmful interference, and
2. this device must accept any interference received, including interference that may cause undesired operation.

L'émetteur/récepteur exempt de licence contenu dans le présent appareil est conforme aux CNR d'Innovation, Sciences et Développement économique Canada applicables aux appareils radio exempts de licence. L'exploitation est autorisée aux deux conditions suivantes:

1. l'appareil ne doit pas produire de brouillage, et
2. l'appareil doit accepter tout brouillage radioélectrique subi, même si le brouillage est susceptible d'en compromettre le fonctionnement.

7. Laser Classification

The laser incorporated in the camera produces an invisible beam which emerges from the rotating laser source. The laser described in this section is classified as laser Class 1 under IEC 60825-1 ed 3 2014.

CLASS 1 LASER PRODUCT

This device contains one or more lasers. Use other than as described in the User Manual, repair, or disassembly may cause damage, which could result in hazardous exposure to infrared laser emissions that are not visible. This equipment should be serviced by Giraffe360 or an authorized service provider.

Embedded laser parameters:

Description	Value
Wavelength	905 nm
Laser Power for classification	780 uW
Mode of operation	Pulse

8. Electromagnetic Compatibility (EMC)

The term Electromagnetic Compatibility is taken to mean the capability of the product to function smoothly in an environment where electromagnetic radiation and electrostatic discharges are present, and without causing electromagnetic disturbances to other equipment.

Electromagnetic radiation

Electromagnetic radiation can cause disturbances in other equipment.

Although the product meets the strict regulations and standards which are in force in this respect, Giraffe360 cannot completely exclude the possibility that other equipment may be disturbed.

Use of the product with accessories from other manufacturers.

For example non-standard cables or external batteries. This may cause disturbances in other equipment. Use only the equipment and accessories provided by Giraffe360.

When using computers, two-way radios or other electronic equipment, pay attention to the information about electromagnetic compatibility provided by the manufacturer.

Use of product with radio or digital cellular phone devices.

Electromagnetic fields can cause disturbances in other equipment, in installations, in medical devices, for example pacemakers or hearing aids and in aircrafts. Electromagnetic fields can also affect humans and animals.

Although the product meets the strict regulations and standards which are in force in this respect, Giraffe360 cannot completely exclude the possibility that other equipment can be disturbed or that humans or animals can be affected.

- Do not operate the product with radio or digital cellular phone devices in the vicinity of filling stations or chemical installations, or in other areas where an explosion hazard exists.
- Do not operate the product with radio or digital cellular phone devices near to medical equipment.
- Do not operate the product with radio or digital cellular phone devices in aircrafts.
- Do not operate the product with radio or digital cellular phone devices for long periods with the product immediately next to your body.

9. Repair

There is no scheduled maintenance necessary to keep the product working. If the user notices that the product is damaged or is not working, the user must stop using the product immediately and contact Giraffe360 for further instructions.

The user is strictly forbidden to modify the product or remove its protective covers. The user should not try to repair the product. Doing so can expose the user to risk of injuries and equipment destruction. Only the representatives of Giraffe360 or its authorised service centres are entitled to repair the product. No service or “service related” adjustments are to be performed by a third party other than Giraffe360.

10. Information about the Manufacturer

The camera is manufactured by Giraffe360 SIA, company number: 40203020393, legal address: Dēļu iela 4, Rīga, LV-1004, e-mail address: enquiries@giraffe360.com (“Giraffe360”).