

Trend Makers™

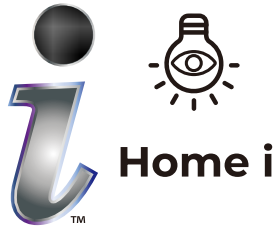

Intelligent Panoramic Security Camera



WiFi



View



Mobile
Alert



Remote
Viewing



Color
Night Vision



2-Way
Speaker



Motion
Detection



Full HD
3MP



Secure
App



Supports
TF Card



For instructional videos and FAQ's please visit
sightbulbcustomerservice.com to learn more.

Distributed by Trend Makers, LLC • Fort Walton Beach, FL 32547

©2024 Trend Makers, LLC

Made in China

All Rights Reserved.



WARNING: Cancer and Reproductive Harm - www.P65Warnings.ca.gov

By purchasing this product, you accept Trend Makers' terms and conditions including arbitration agreement.

See inside for arbitration agreement. See trendmakersinc.com/arbitration-agreement for details.

Trend Makers™



Intelligent Panoramic Security Camera





3 Simple Steps to Set-Up and Protect

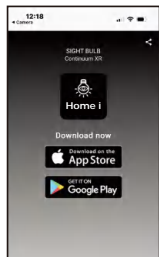

Download
the
Sight Bulb®
App



Install
Sight Bulb®



Connect your
Sight Bulb® to
the App by
scanning QR code

NOTE: To ensure proper use of your Sight Bulb®, please follow the instructions detailed in this set-up guide.



This device complies with Part 15 of the FCC Rules. Operation is subject to the following two conditions:

- (1) this device may not cause harmful interference, and
- (2) this device must accept any interference received, including interference that may cause undesired operation.

FCC RF Radiation Exposure Statement Caution:

To maintain compliance with the FCC's RF exposure guidelines, place the product at least 20cm from nearby persons.

FCC ID: 2A88H-0033052279

Setting-Up Your Home i

Warning: Changes or modifications to this unit not expressly approved by the party responsible for compliance could void the user's authority to operate the equipment.

NOTE: This equipment has been tested and found to comply with the limits for a Class B digital device, pursuant to Part 15 of the FCC Rules. These limits are designed to provide reasonable protection against harmful interference in a residential installation. This equipment generates, uses and can radiate radio frequency energy and, if not installed and used in accordance with the instructions, may cause harmful interference to radio communications.

However, there is no guarantee that interference will not occur in a particular installation. If this equipment does cause harmful interference to radio or television reception, which can be determined by turning the equipment off and on, the user is encouraged to try to correct the interference by one or more of the following measures:

- Reorient or relocate the receiving antenna.
- Increase the separation between the equipment and receiver.
- Connect the equipment into an outlet on a circuit different from that to which the receiver is connected.
- Consult the dealer or an experienced radio/TV technician for help.

Setting-Up Your Home i

Step 1: Download the Sight Bulb App

Download the **Sight Bulb** app in the Apple® App Store, Google® Play Store, or use your phone camera to scan the QR code below to open the app store of your mobile phone.

**Apple® App Store or
Google® Play Store**

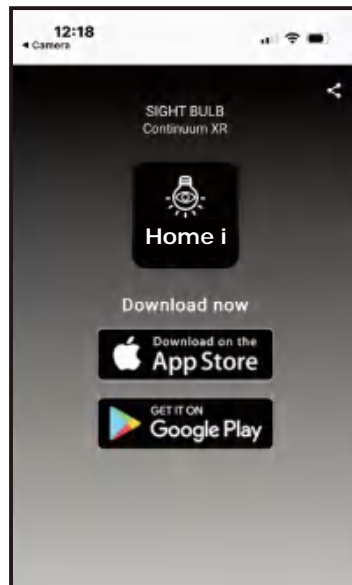

Scan Code

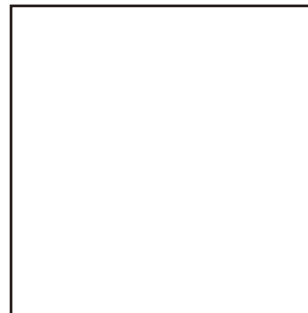

Setting-Up Your Home i

Step 1: Download the Sight Bulb App

2. In order for your Sight Bulb Pro to work properly, select **Allow** if you see the prompt: "Sight Bulb" would like to find and connect to devices on your local network.
3. Create your account and select **Continue**.
4. Follow the App prompts to set up your password and register your . Then **Log In** to your Sight Bulb App.

Passwords must contain numbers and letters, be no less than six digits, and cannot contain special characters.

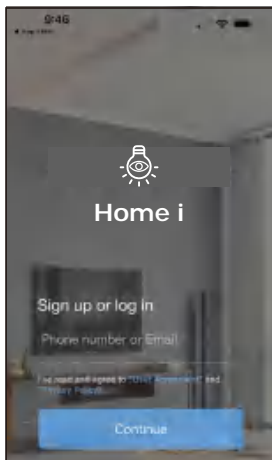

Setting-Up Your Home i

How to Use your Intelligent Panoramic Security Camera

To get started, open your **Sight Bulb** app and follow these easy steps:

1. Choose the camera you want to control.
2. Tap the image.
3. Tap the **Light** icon.
4. Toggle **ON** the light.
5. Select your desired setting:

- Automatic Switching
- Night Vision Mode | LED Light

If you choose the LED Light option, you'll have two choices:

- LED Always On
- LED Timing (which lets you schedule the day of the week, start time, and duration).

6.Tag"Zoom" icon

The magnification value appears at the bottom of the screen. According to the demand, use your finger to gently slide left and right to select the variable magnification value, the image on the upper screen will change with the variable magnification value, and the distant scene will get closer and closer.

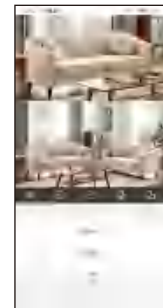
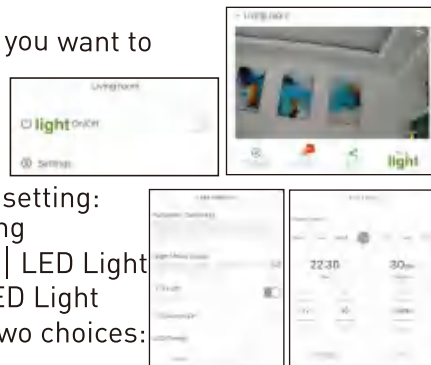

Step 4: Use Your Camera Lens to Scan the Mobile QR Code

5. Enter a name for your camera or select a name from the options provided. Then press **Next Step** on your mobile phone.
6. In order for your Camera to work properly, select **Allow** if you see a prompt: **"Sight Bulb"** would like to access your microphone.
7. Now, you are ready to start using your Camera!

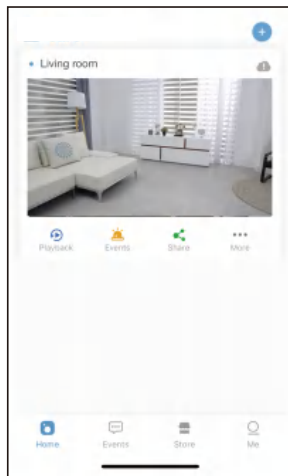
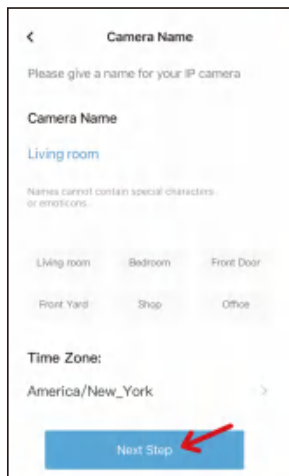

Step 2: Put the Camera&Light on the desktop

- 1.
- 2.
- 3.
4. Wait 30 seconds for the camera to go through its set-up mode. When the set-up mode is complete, you will hear the "Welcome to use" command.

Setting-Up Your Home i



Step 3: Connect Your Camera & Light to the App

- Press the  **sign** in the App and then select **Add Device**.
- Select **WiFi Camera** from the device options.
- In order for your to work properly, select **Allow** if you see a prompt: **"Allow Sight Bulb"** to use your location.
- Press the **reset button** on the bottom of your for about 5 seconds until you hear a **"ding"** sound.
- Confirm that your device indicator flashes or that you hear a tone sound.
- Then press **Next Step** in the App.
- Select or enter your location's **WiFi name**, enter the **WiFi password**. Then press **Next Step** in the App.

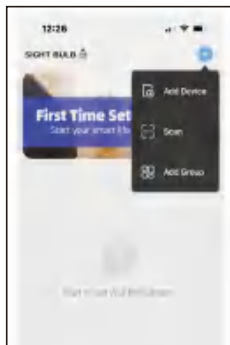

Setting-Up Your Home i



Step 4: Use Your Camera Lens to Scan the Mobile QR Code

- You will find your QR Code in the Sight Bulb mobile App.
- Hold your phone with the QR code displayed directly in front of the lens until you hear a musical prompt. **Tip:** Hold your mobile 4-8 inches away from the lens for best results.
- Click the **I Heard a Prompt** button
- The App will countdown until your and mobile device are connected to your WiFi network.

