

Wayfinding solution Condition monitoring

L01 Location Anchor

The L01 Location Anchor, a BLE technology based and impressive battery life beacon, is ideal for wayfinding solution, proximity marketing and asset tracking in hospital, shopping mall and warehouse.

Not only providing location-based infrastructure, it can be also integrated with temperature, humidity and barometer sensor through its hardware compatible design, to realize condition monitoring and offer comprehensive application scenarios.

What Impressed



Rotating replaceable battery

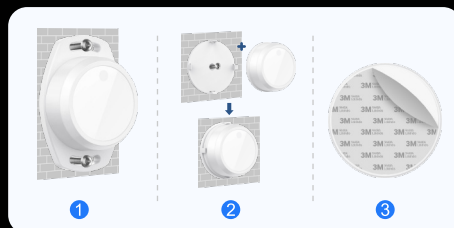

Multiple adaptive installation



With T&H Sensor

Without T&H Sensor



With T&H Sensor

Without T&H Sensor



IP67 waterproof



High accuracy
sensing



Historical data
storage



Rotating replaceable
battery



All-in-one sensor
integration

General Specs

Connectivity:	BLE 5.0
Dimensions:	76.2*53.6*24.0mm (L01) Φ54.5*24.0mm (L01A)
Color:	Gray
Material:	PC
IP rating:	IP67
Sensor:	Temperature&Humidity sensor Hall effect sensor Accelerometer sensor Barometric pressure sensor

Battery capacity:	2M Bytes
Flash memory:	2400mAh replaceable battery
Battery lifespan:	8+ years - 5s reporting
Operating temperature:	-20°C to 60°C (Can be extended to -40°C~85°C)
Transmission range:	Up to 150m (Without any obstacles)
Installation:	Sticker Screw Zip Tie
Certification:	FCC CE RoHS REACH Bluetooth

Sensor Specs

Temperature & Humidity sensor	
Accuracy tolerance:	±0.2°C(condition: 0°C - 60°C) ±1.8% RH(condition: 20% - 80% RH)
Resolution:	0.1°C 0.1% RH
Operating temperature:	-40°C - 125°C 0 - 100 %RH
History storage:	50000 groups

Barometric Pressure Sensor

Pressure measurement range	30kPa - 125kPa
Relative pressure accuracy	±6Pa

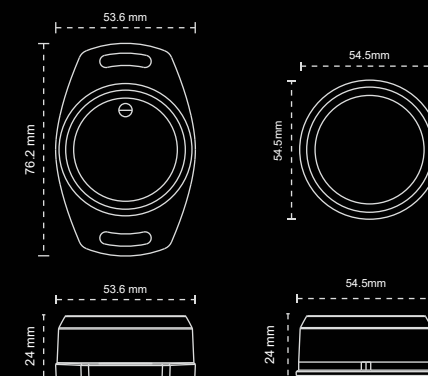

This device complies with part 15 of the FCC Rules. Operation is subject to the following two conditions: (1) this device may not cause harmful interference, and (2) this device must accept any interference received, including interference that may cause undesired operation.

Any changes or modifications not expressly approved by the party responsible for compliance could void the user's authority to operate the equipment.

NOTE: This equipment has been tested and found to comply with the limits for a Class B digital device, pursuant to Part 15 of the FCC Rules. These limits are designed to provide reasonable protection against harmful interference in a residential installation. This equipment generates, uses and can radiate radio frequency energy and, if not installed and used in accordance with the instructions, may cause harmful interference to radio communications. However, there is no guarantee that interference will not occur in a particular installation.

If this equipment does cause harmful interference to radio or television reception, which can be determined by turning the equipment off and on, the user is encouraged to try to correct the interference by one or more of the following measures:

- Reorient or relocate the receiving antenna.
- Increase the separation between the equipment and receiver.
- Connect the equipment into an outlet on a circuit different from that to which the receiver is connected.
- Consult the dealer or an experienced radio/TV technician for help.

The device has been evaluated to meet general RF exposure requirement. The device can be used in portable exposure condition without restriction.