

User Manual



1.Descriptions:

It is a new AHD/TVI/CVI Wireless Video TX & RX Kit, adopting the newest HD 2.4G digital wireless video transmission technology, can be widely used on vehicle backup cameras, cctv cameras and medical cameras industry etc. By using it, you can upgrade your existing wired AHD/TVI/CVI camera system to wireless version easily.

2. Wiring

a. RCA/BNC Version Wire Connection

BNC version



RCA Version



b.4 PIN Version Wire Connection

transmitter

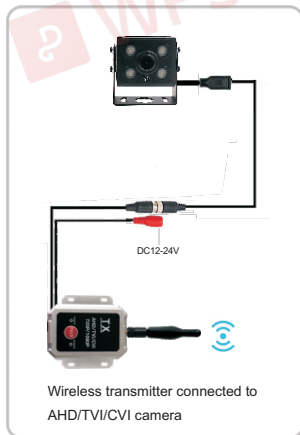

receiver

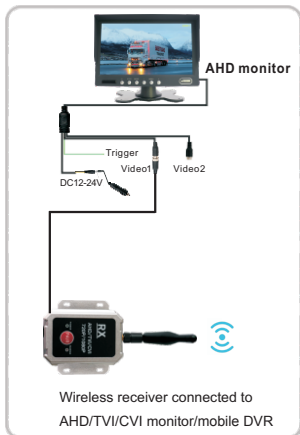

3.How to pair?



Remark: The KIT were paired already and ready for using.

Step 1: Connect the transmitter with AHD camera and connect the receiver with AHD monitor

Step 2: Power on both the transmitter and receiver by using DC12V-DC24V power supply

Step 3: Hold pressing both "PAIR" buttons at the same time until the image displayed on monitor, the green PAIRING indicator light will turn on constantly, then release it.

4.Specification

Power Supply	DC12-24V
TX Current Consumption	Type:200Ma,Max:250Ma
RX Current Consumption	200Ma
Operation Frequency	2400~2483.5MHz
Output Power	20dBm With Power Control
Receiving Sensitivity	-86dBm@ QPSK
Operating Temperature	-20~+80° C
Operating Humidity	85%RH
Resolution	720P@30f/s ; 1080P@30f/s
RF Band Width	6 Mbps
Modulation	QPSK/16QAM
Line of sight range	500M
Hopping Rate	1200/S
Latency	130ms Min
Video Codec	H.264
TX Video in System	720P/1080P AHD/TVI/CVI
RX Video out System	720P or 1080P AHD/TVI

FCC WARNING

This device complies with part 15 of the FCC Rules. Operation is subject to the following two conditions: (1) this device may not cause harmful interference, and (2) this device must accept any interference received, including interference that may cause undesired operation.

Any changes or modifications not expressly approved by the party responsible for compliance could void the user's authority to operate the equipment.

NOTE: This equipment has been tested and found to comply with the limits for a

Class B digital device, pursuant to Part 15 of the FCC Rules. These limits are designed to provide reasonable protection against harmful interference in a residential installation. This equipment generates, uses and can radiate radio frequency energy and, if not installed and used in accordance with the instructions, may cause harmful interference to radio communications.

However, there is no guarantee that interference will not occur in a particular installation. If this equipment does cause harmful interference to radio or television reception,

which can be determined by turning the equipment off and on, the user is encouraged to try to correct the interference by one or more of the following measures:

- Reorient or relocate the receiving antenna.
- Increase the separation between the equipment and receiver.
- Connect the equipment into an outlet on a circuit different from that to which the receiver is connected.
- Consult the dealer or an experienced radio/TV technician for help.

To maintain compliance with FCC's RF Exposure guidelines, This equipment should be installed and operated with minimum 20cm distance between the radiator and your body: Use only the supplied antenna.