

CAR AI BOX

Overview

The CarPlay AI Box adds an Android system to the original multimedia center through the USB interface of the original car.

Specifications:

Navigation	GPS/GLONASS/BEIDOU
Operation System	Android
WIFI	802.11 a/ac/b/g/n20/n40, 2.4G/5G
Bluetooth	5.0 BLE+4.2 BLE
Power Input	5V/1A
Operation temperature	-20°C -70°C/-4°F ~158°F

Note: This product only fit for car with wired carplay function, and should connect by original car OTG USB connector.

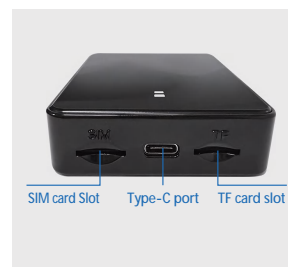
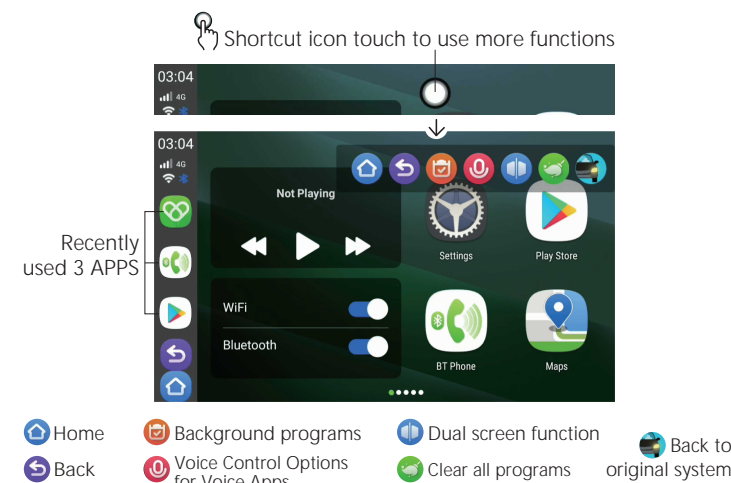

Function

- (1). Android system supporting google play store apps installation
- (2). SIM Card Solt with 2G/3G/4G LTE Network
- (3). TF Card Solt up to 128GB with storage
- (4). Bluetooth
- (5). WI-FI
- (6). Wireless CarPlay
- (7). Wireless Android AUTO

Instructions

- Connect the carplay AI Box to the car carplay usb port
- Touch or Choose carplay Icon after 5 seconds.After the smart car system appears on the display, you can use the system to install and uninstall apps, navigation and listen to music, etc.

1. Wireless CARPLAY/Wireless Android auto

- (1). After entering the operating system of the CarPlay AI Box, pair Iphone/ android phone bluetooth with Ai box bluetooth by "BT phone" app.
- (2). Go to "Link us" app, it will pop up a message from phone ask for permission, press ok
- (3). CarPlay/Android Auto will automatically connect successfully

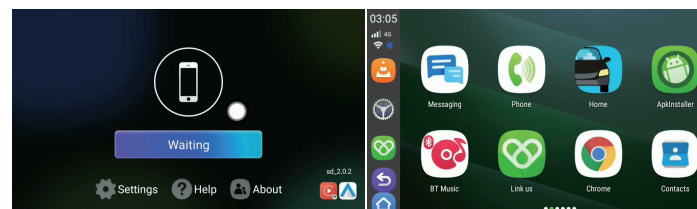

2. Two Launcher for choice

Go setting - Smart Link Box Settings - Launcher Style type, can choose Launcher 1 or Launcher 2 as you like.

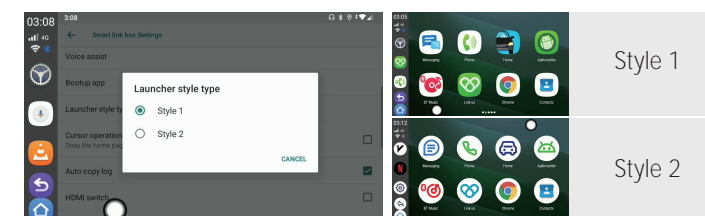

3. Voice Command Function

With google voice APP installed, it allows the use of voice command for user interaction with the multimedia center

FCC Warning

This device complies with part 15 of the FCC Rules. Operation is subject to the following two conditions: (1) This device may not cause harmful interference, and (2) this device must accept any interference received, including interference that may cause undesired operation.

Any Changes or modifications not expressly approved by the party responsible for compliance could void the user's authority to operate the equipment.

Note: This equipment has been tested and found to comply with the limits for a Class B digital device, pursuant to part 15 of the FCC Rules. These limits are designed to provide reasonable protection against harmful interference in a residential installation. This equipment generates uses and can radiate radio frequency energy and, if not installed and used in accordance with the instructions, may cause harmful interference to radio communications. However, there is no guarantee that interference will not occur in a particular installation. If this equipment does cause harmful interference to radio or television reception, which can be determined by turning the equipment off and on, the user is encouraged to try to correct the interference by one or more of the following measures:

- Reorient or relocate the receiving antenna.
- Increase the separation between the equipment and receiver.
- Connect the equipment into an outlet on a circuit different from that to which the receiver is connected.
- Consult the dealer or an experienced radio/TV technician for help.

This equipment complies with FCC radiation exposure limits set forth for an uncontrolled environment. This equipment should be installed and operated with minimum distance 20cm between the radiator & your body.