

DOUBLE OF ARMOUR

NO.DC098A

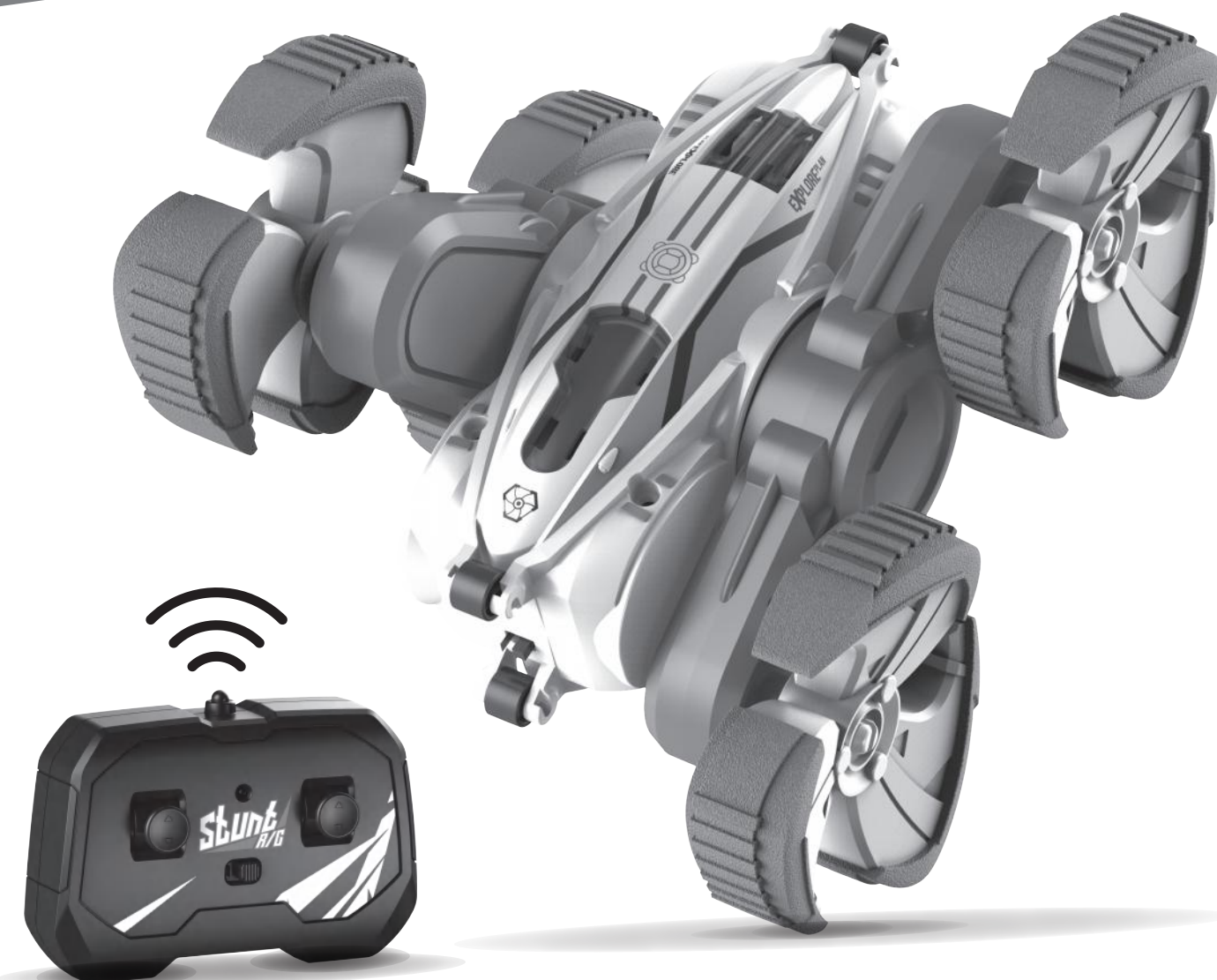

STORM STUNT

360° SPINNING



Insert batteries (to be done by an adult)

Insert battery (to be done by an adult)
3.7V lithium battery for the car (Included)
Open the battery compartment with a screwdriver (not included) and connect the wire with battery's plug
Close the compartment lid and screw it tight

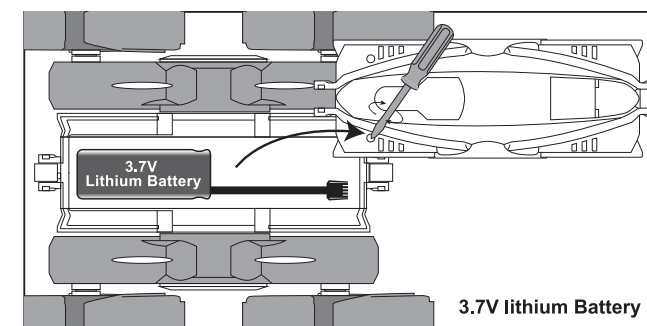

Operation

- Turn on the vehicle by switching the button under the car to "ON".
 - Turn on the remote controller by switching the button to "ON".
 - The red light will be on when the remote control is turned on.
 - Steer the control stick to control the vehicle to go left or right.
 - Use the control stick to control the vehicle to go forwards or backwards.
 - After usage, turn off both devices by switching the buttons to "OFF".
 - Rechargeable batteries must be removed from the transmitter prior to recharging.
 - Non-rechargeable batteries may not be charged.
 - Rechargeable batteries may only be charged under the supervision of an adult.
 - The combination of different types of batteries as well as new and used batteries must be avoided.
 - Only recommended batteries or those of an equivalent type may be
 - Batteries must be inserted according to the correct polarity (+ and -).
 - Depleted batteries must be removed from the transmitter.
 - The connection terminals may not be short-circuited.
 - Remove the batteries from the transmitter if they are not to be used for an extended period of time.
- Technical Information**
Radio frequency: 2400~2483.5 MHz
Max transmitted: 10dBm
Working temperature: -10 °C ~ +55 °C
- **Frequency: 2.4G. Adult supervision is recommended.**
 - **Age recommendation: 6+**
 - **Not suitable for children below the age of 3, as there is a choking hazard from swallowable small parts.**

- **2 x AA battery for the remote control (included)**
- **Install the batteries in the remote control:**
Open the battery compartment with a screwdriver and insert 2 batteries of type AA battery according to the indicated polarity. Close the compartment lid and tightly screw it tight.

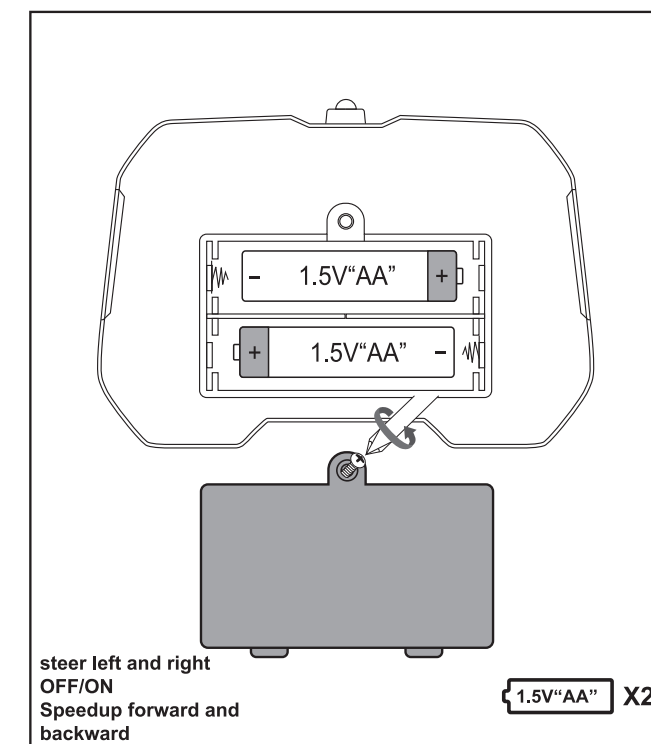

Use 3.7V USB charger (Included) for charging the battery
Charging time: 100-120 minutes
Play time: 25-30 Mins

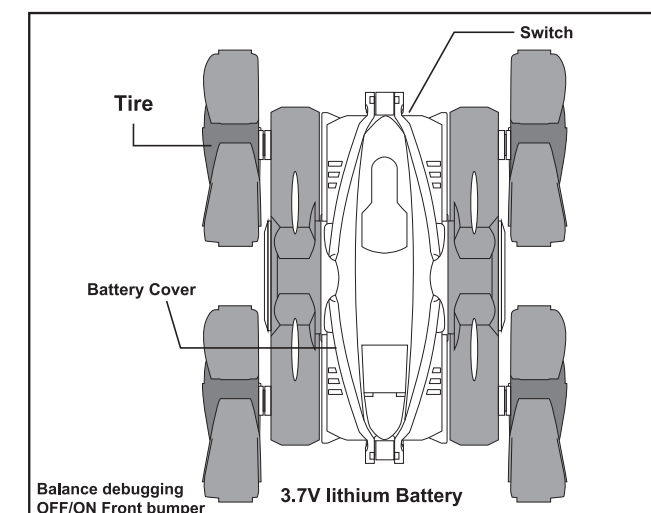

This device complies with Part 15 of the FCC Rules. Operation is subject to the following two conditions: (1) this device may not cause harmful interference, and (2) this device must accept any interference received, including interference that may cause undesired operation

NOTE: This equipment has been tested and found to comply with the limits for a Class B digital device, pursuant to Part 15 of the FCC Rules. These limits are designed to provide reasonable protection against harmful interference in a residential installation. This equipment generates, uses and can radiate radio frequency energy and, if not installed and used in accordance with the instructions, may cause harmful interference to radio communications. However, there is no guarantee that interference will not occur in a particular installation.

If this equipment does cause harmful interference to radio or television reception, which can be determined by turning the equipment off and on, the user is encouraged to try to correct the interference by one or more of the following measures:

- Reorient or relocate the receiving antenna.
- Increase the separation between the equipment and receiver.
- Connect the equipment into an outlet on a circuit different from that to which the receiver is connected.
- Consult the dealer or an experienced radio/TV technician for help.

Warning: changes or modifications not expressly approved by the party responsible for compliance could void the user's authority to operate the equipment