



| STRIKERV.R.COM

| SUPPORT@STRIKERV.R.COM

# MAVRIK

STRIKERV.R MAVRIK-PRO // PRODUCT MANUAL



With the **StrikerVR Mavrik-Pro**, players will experience virtual reality like never before—the future of VR gaming starts now. Its innovative recoil and haptic technologies unlock incredible force effects that can simulate limitless tools and environments. **You need to feel it to believe it.**

For the latest product information, requirements, warranty, and anything else please visit [support.strikervr.com](https://support.strikervr.com)

# StrikerVR™

MAVRIK-PRO / PRODUCT MANUAL

5	MAVRIK-PRO OVERVIEW
6	ACTIVE TOUCH
7	QUICK START
8	DEVICE MODES
10	CHARGING YOUR MAVRIK-PRO
13	SETUP & INTEGRATION
14	CARE & MAINTENANCE
15	ELECTRICAL SPECIFICATIONS

TOP

LEFT VIEW

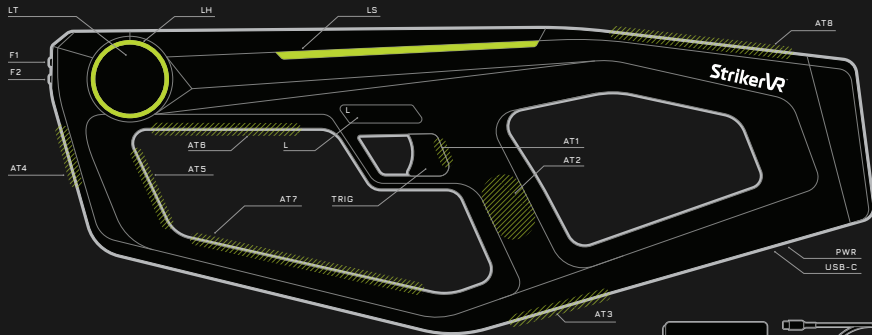

FRONT

BACK

# STRIKERV VR MAVRIK-PRO VR GAMING CONTROLLER

20.5 in x 2.6 in x 7.6 in	3.3 LBS
520 mm x 66 mm x 193 mm	1.5 KG

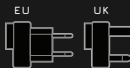

BOTTOM



# MAVRIK-PRO OVERVIEW

## ACTIVE TOUCH AREAS

**AT1:** Trigger Sense  
**AT2:** Trigger Grip  
**AT3:** Reload  
**AT4:** Front Hand Grip Face  
**AT5:** Front Hand Grip  
**AT6:** Under Touchpad Grip  
**AT7:** Forward Bar Grip  
**AT8:** Slide

## USER BUTTONS

**F1:** Front Top Button  
**F2:** Front Bottom Button  
--  
**LT/RT:** Left/Right Touchpad  
**L/R:** Left/Right Side Button  
--  
**TRIG:** Trigger  
**PWR:** Power Button

## ACCESSORIES

Power Adapter  
USB-C Charging Cable  
UK Power Adapter Plug  
EU Power Adapter Plug

## OTHER

**LH/RH:** LED Halo  
**LS/RS:** LED Strip  
**USB-C:** Charging Port



**GET THIS:** Our USB-C powers both ways. Wanna charge your cell phone? Plug it into the Mavrik!



Active Touch 8. Slide

## ACTIVE TOUCH

---

Get in the game with Active Touch! The Mavrik-Pro's Active Touch technology unlocks a new world of possibilities through unique gameplay and user interaction.

Located strategically on the Mavrik-Pro at the areas of optimal interaction, the Active Touch enables innovative swipe and gesture functions. It also allows for left/right-hand recognition and alternative grip placements.

# QUICK START

First, ensure that nothing has been damaged during shipping and that all items are in the box.

1. To start-up the device push & hold the **Power** button which is located on the back underside of the Mavrik-Pro (see "Mavrik-Pro Overview" section).
2. The device will then begin its startup sequence and you will hear / feel the movement of the haptic engines. The startup sequence ends when the **LED Halo/Strip** are softly glowing and the haptic engines have ceased motion.
3. The Mavrik-Pro's initial state is preprogrammed with various demo blaster profiles. Cycle through these modes by utilizing the **L / R Side** buttons. The haptic modes can be initialized by squeezing the **Trigger** or interacting with **Active Touch** areas.
4. See "Demo Blaster Profiles" section (pg 8) for additional information on individual profiles.



**GET THIS:** Your Mavrik-Pro's battery should be at 30-50% charge so you can test the goods immediately.

# DEVICE MODES

## DEMO MODE

By default, device is set to demo mode for initial startup. If no buttons have been pressed for 15 seconds, blaster will blink blue, meaning it is advertising for connection.

## CALIBRATION

**To Enter Calibration Mode:** With the device ON, hold both **Front** buttons (**F1** & **F2**) and both **Side** buttons (**L** & **R**) for 5 seconds. Device will restart following calibration.

## UNPAIRING

**To Clear Current Pairing:** with the device OFF, hold both **Side** buttons (**L** & **R**) and press **Power** button. Device will blink blue 3 times then continue normal operation.

## DEMO BLASTER PROFILES

Your Mavrik-Pro is package with preprogrammed blaster profiles which are available at initial startup in "Demo Mode." Scan QR for a walk-through of each blaster.



## FIRMWARE UPDATE

**To Enter Firmware Update Mode:** With the device OFF, depress both **Touchpads** (**LT** & **RT**) then press and hold the **Power** button for 5 seconds. Device will restart following firmware update.





GET THIS: What are MetaSports? The next evolution of Esports, where the metaverse is your arena!

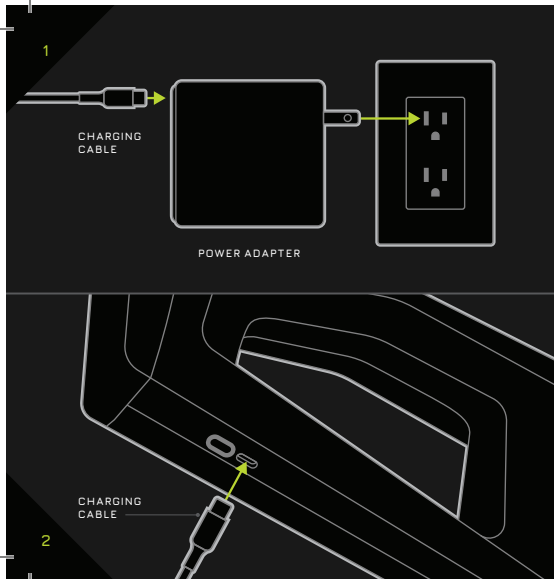

## CHARGING YOUR MAVRIK-PRO ⚡

Ok, so you've used all your blaster juice; time to recharge.\* Here's how:

1. Unpack all the accessories, and then plug the **USB-C charging cable** into the **power adapter** and an available outlet. Make sure you are utilizing the appropriate converter adapter.
2. Plug the other end of the **charging cable** into the **USB-C charging port** located next to the **Power** button.

MAVRIK-PRO / PRODUCT MANUAL



**GET THIS:** To display current power level, momentarily (<1 sec) press and release **Power** button

3. You should see an illuminated **LED Halo** and a front to back filling movement on the **LED Strip**, which means the batteries are charging. There are 6 charging stages ranging from red to green.
4. When the charging motion ends, you should see solid green flashing to white on the **LED Halo** and **Strip**. This means the battery is fully charged. Time to get your game on!

*\* Battery life is variable, depending on gameplay*

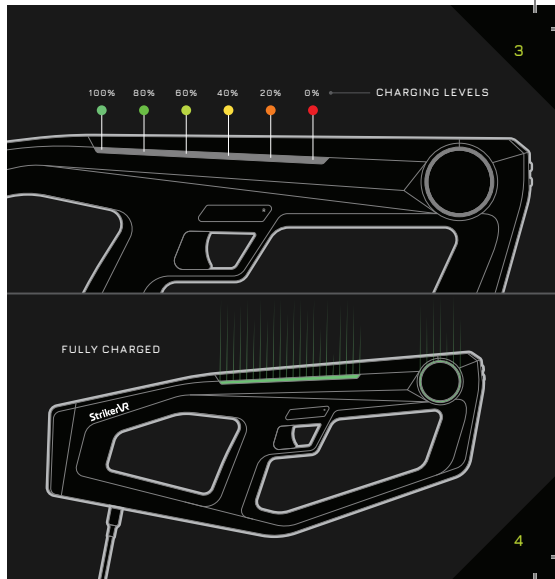

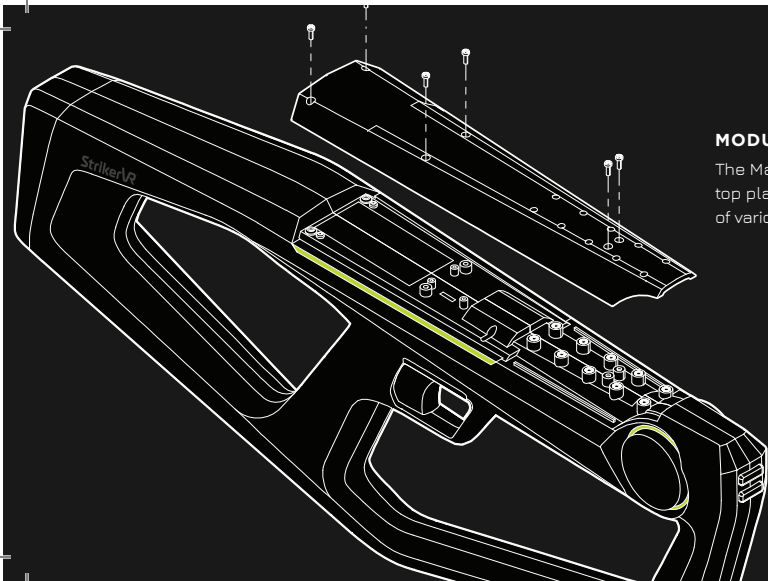

## **MODULAR TRACKING**

The Mavrik-Pro features a removable top plate which allows for installation of various tracking mounts & modules.

# SETUP & INTEGRATION

---



## TRACKING MOUNTS & MODULES

See individual Tracking Mount/Module manuals for setup instructions. For complete listing of compatible HMD systems and Tracking Mounts/Modules, visit [StrikerVR.com](https://StrikerVR.com).

## STRIKERV R SUPPORT CENTER

Scan QR or visit [support.strikervr.com](https://support.strikervr.com) for all your setup & integration needs, including:

- Developers Setup
- Blaster to HMD Pairing
- Tracking System Setup
- Device Manager
- Demo Experience Download
- Digital Asset Download
- Haptic Editor

# CARE & MAINTENANCE

Unplug product from its power source before cleaning. Please only use clean and dry microfiber cloths for cleaning the Mavrik-Pro Blaster & Accessories. Do not clean the device with any liquid or chemical cleansers. Do not clean the surface of the device with alcohol or any other abrasive cleaning solution. Only use non-abrasive, alcohol free anti-bacterial wipes and wipe gently.

- Do not leave the Mavrik-Pro Blaster & Accessories in direct sunlight. Exposure to direct sunlight can damage the plastics over time by discoloring them
- As with any electronic devices, avoid exposure to water or fluids
- Operating Environment Temperature: 10-40°C / 50-104°F, min. humidity 5%, max humidity 95% RH (non-condensing)
- Non-Operating (Shipping / Storage):  
-30-65°C / -22 149°F, 85% RH
- Store components in a safe, climate-controlled environment when not in use to minimize unintentional damage or environmental exposure

# ELECTRICAL SPECIFICATIONS

COMPONENT	RATING	CONTINUOUS OUTPUT POWER
Mavrik-Pro Blaster	100W	60W
Charging	100W	100W



 Designed In New Orleans  
 ©2022 All Rights Reserved StrikerVR, Inc.

FCC warning:

Any Changes or modifications not expressly approved by the party responsible for compliance could void the user's authority to operate the equipment.

**Note:** This equipment has been tested and found to comply with the limits for a Class B digital device, pursuant to part 15 of the FCC Rules. These limits are designed to provide reasonable protection against harmful interference in a residential installation. This equipment generates uses and can radiate radio frequency energy and, if not installed and used in accordance with the instructions, may cause harmful interference to radio communications. However, there is no guarantee that interference will not occur in a particular installation. If this equipment does cause harmful interference to radio or television reception, which can be determined by turning the equipment off and on, the user is encouraged to try to correct the interference by one or more of the following measures:

- Reorient or relocate the receiving antenna.
- Increase the separation between the equipment and receiver.
- Connect the equipment into an outlet on a circuit different from that to which the receiver is connected.
- Consult the dealer or an experienced radio/TV technician for help.

This device complies with part 15 of the FCC Rules. Operation is subject to the following two conditions:  
(1) This device may not cause harmful interference, and (2) this device must accept any interference received, including interference that may cause undesired operation.

The device has been evaluated to meet general RF exposure requirement. The device can be used in portable exposure condition without restriction.



# StrikerVR™

STRIKERVV MAVRIK-PRO  
// PRODUCT MANUAL



READY  
for the  
METAVERSE



STRIKERVIRTUALRECOIL   
STRIKERVV    



| STRIKERVV.COM

| SUPPORT@STRIKERVV.COM