

# Floor Mood Light



Bluetooth APP



Remote control

## 1.How to install APP

1.1 IOS and Android or Apple system mobile phone can download the APP by scanning the QR code.Open a browser or other apps with the "Scan QR Code" function and scanfollowing QR code to download the APP.

APP name: **HappyLighting**



With cell phone  
Scan QR code



HappyLighting

1.2 IOS system need IOS8.0 or higher; Android system need Android 4.3 or higher.

1.3 Please note that Bluetooth and WIFI must be turned on when connecting to the APP, Otherwise the connection will fail

## 2.Connect APP

### Adjust color mode



### Music mode



### Microphone mode



### Dynamic mode



### Timing mode

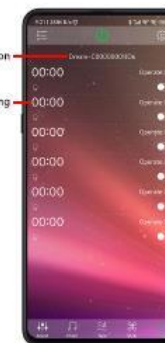

### 3. Bracket installation method

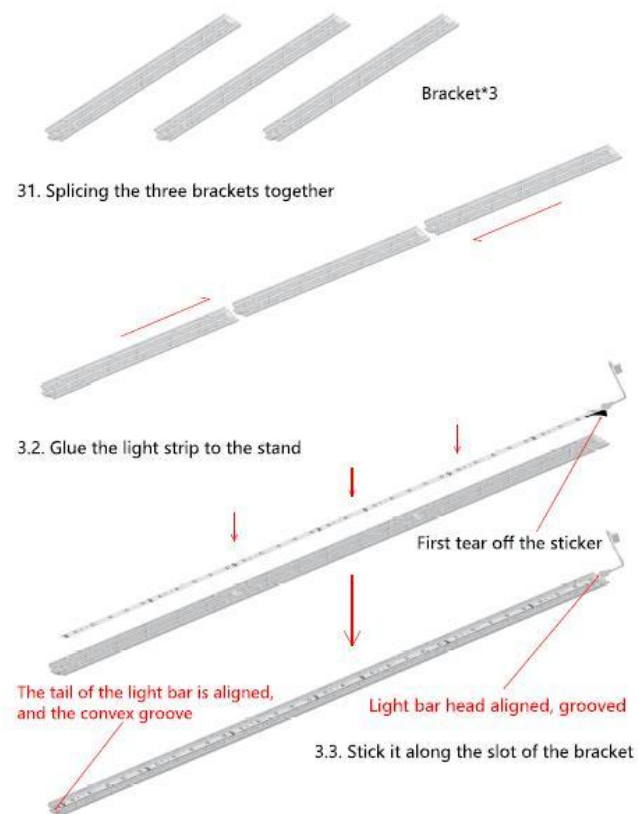

### 4. Install the lampshade

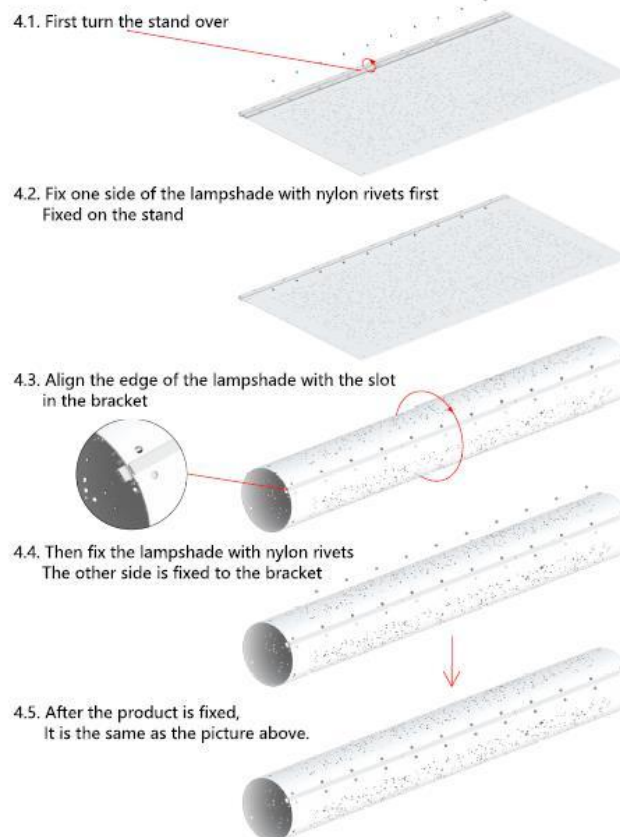

### 5. Product assembly

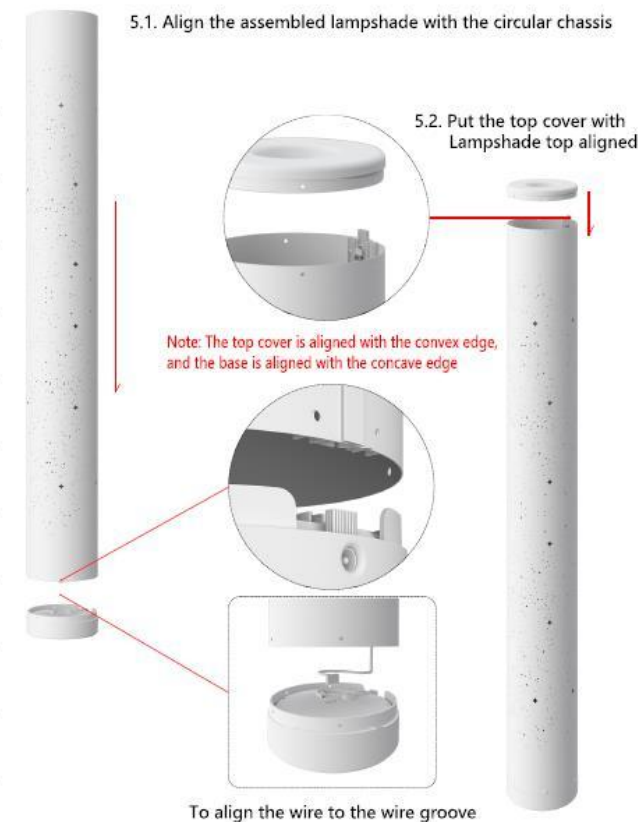



5.3. Fasten nylon rivets into small holes



5.4. Assembly is complete



## 6. Remote control

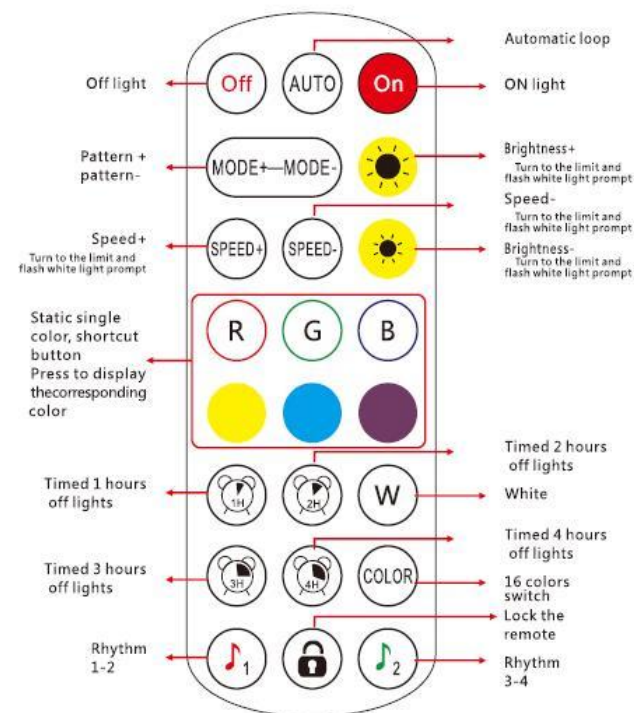

Rhythm 1-2: Single click to switch to 1-2 rhythm mode  
 Rhythm 3-4: Click to cycle through the 3-4 rhythm mode  
 Remote control lock: After pressing, the remote control is locked, pressing the switch is available, other keys are invalid. After pressing once, the unlock button can be used. After the remote control is locked, press the switch to unlock the remote control.

This equipment has been tested and found to comply with the limits for a Class B digital device, pursuant to part 15 of the FCC Rules. These limits are designed to provide reasonable protection against harmful interference in a residential installation. This equipment generates, uses and can radiate radio frequency energy and, if not installed and used in accordance with the instructions, may cause harmful interference to radio communications. However, there is no guarantee that interference will not occur in a particular installation. If this equipment does cause harmful interference to radio or television reception, which can be determined by turning the equipment off and on, the user is encouraged to try to correct the interference by one or more of the following measures:

- Reorient or relocate the receiving antenna.
- Increase the separation between the equipment and receiver.
- Connect the equipment into an outlet on a circuit different from that to which the receiver is connected.
- Consult the dealer or an experienced radio/TV technician for help.

### RF exposure compliance statement:

This device complies with FCC RF radiation exposure requirement set forth for an uncontrolled environment. This transmitter must not be co-located or operating in conjunction with any other antenna or transmitter.

This device must operate with a minimum distance of 20 cm between the radiator and user body.