



GarageDoorMinder™

Installation Instruction

Stop

Read First

Stop



Transmitter



Receiver

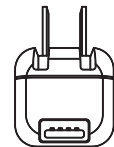

Wall Plug

Garage Door Minder Auto Pairing Instructions

1. Remove from packing, start with transmitter first. Pull battery tabs and now put transmitter in transmit Mode (see figure-1) setting down with Velcro facing up. You should be able to see the battery door.

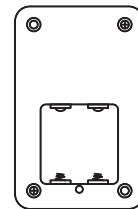
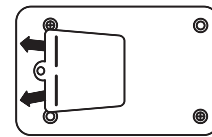

Fig. -1

2. Plug light stick receiver into provided wall plug adapter and into wall outlet. (see figure-2) Now light stick is in auto pair for 30 seconds, do not interrupt. Leave transmitter in Transmit mode and light stick in auto pair. After 30 seconds it will finish. If you see solid lights or hear solid beep it will stop and go back to blinking and beep when finished. To test after pairing flip transmitter over with label facing up, light stick will stop, then flip back over and they will start beeping and blinking again, pairing is finished.

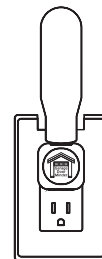
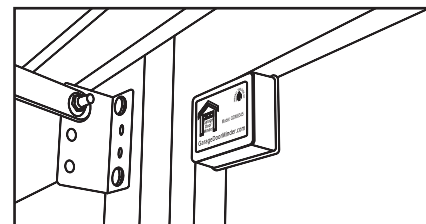

Fig. -2

3. Now take alcohol swab pad provided and wipe a clean smooth surface at the highest point of your garage door. Let alcohol dry for 30 seconds. Then peel Velcro and stick to the cleaned highest point of your garage door. (See figure-3)



Transmitter and light stick must be within 5 feet of each other during pairing process. For multiple light sticks or transmitter pairing follow step 1 & 2. For video instruction go here: www.garagedoorminder.com

Replacement batteries are: ER14250. Available on our website.



GarageDoorMinder™

Notification Light Stick

Garage Door Minder Light Stick Features and Auto Programming.

Features included:

- Beeper function off on.
- Beeper 50% volume.
- Beeper delay for 45 seconds.

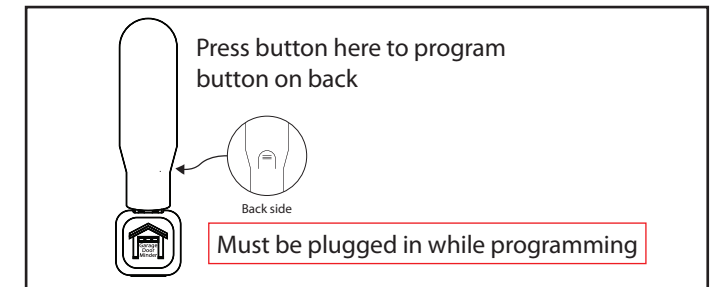

1. Beeper OFF =

Press program button until 1 LED light up then release. Beeper is now off.

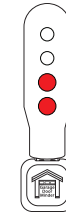

2. Beeper ON =

Press program button until 2 LED lights up then release. Beeper is now on 100% volume.



3. Beeper 50% volume =

Press program button until 3 LED light up then release. Beeper is now set at 50% volume. To return to 100% volume follow step 2.

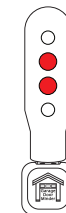

4. Beeper Delay for 45 seconds =

Press program button until you see 2 center LED light up then release. Beeper is now delayed for 45 seconds.

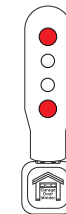

5. Reset and delete = This function will erase all auto paired devices

Then immediately return to auto pairing. If no transmitter is within range it will not be paired up. If the 30 seconds pairing sequence has passed you can just unplug out of wall and plug back in. Unit will beep and blink twice and is now in auto pair for 30 seconds.

Transmitter must be within 5 feet and in transmit mode (Velcro facing up battery door visible). For video instruction please visit Garagedoorminder.com



www.GarageDoorMinder.com
(916) 640-3960 • info@garagedoorminder.com