

# LED SMART LIGHT User Manual

## Specification

Input Voltage: AC120V 60Hz Max load : 100W Input max current:

1A Standby Consumption: 0.1mA

Wireless type: Wi-Fi 2.4GHz

## FCC Warning Statement

Changes or modifications not expressly approved by the party responsible for compliance could void the user's authority to operate the equipment. This equipment has been tested and found to comply with the limits for a Class B digital device, pursuant to Part 15 of the FCC Rules. These limits are designed to provide reasonable protection against harmful interference in a residential installation. This equipment generates uses and can radiate radio frequency energy and, if not installed and used in accordance with the instructions, may cause harmful interference to radio communications. However, there is no guarantee that interference will not occur in a particular installation. If this equipment does cause harmful interference to radio or television reception, which can be determined by turning the equipment off and on, the user is encouraged to try to correct the interference by one or more of the following measures:

- - Reorient or relocate the receiving antenna.
- - Increase the separation between the equipment and receiver.
- - Connect the equipment into an outlet on a circuit different from that to which the receiver is connected.
- - Consult the dealer or an experienced radio/TV technician for help.

FCC Radiation Exposure Statement

The antennas used for this transmitter must be installed to provide a separation distance of at least 20 cm from all persons and must not be co-located for operating in conjunction with any other antenna or transmitter.

## How to connect device by App

Step 1: Use your mobile phone to scan the QR code below or search "Smart Life" from Apple store or Google play to download the App



Input account name and password to log in.

If you don't have an account, please register an account first. System will auto identify your country. You can also select country by yourself. You can use mobile phone number or Email address as your account name.

-1-

-2-

Tap on "Next" to get a verification code via SMS on your mobile phone. Enter a desired password. Tap on 'Confirm' to finish your registration.

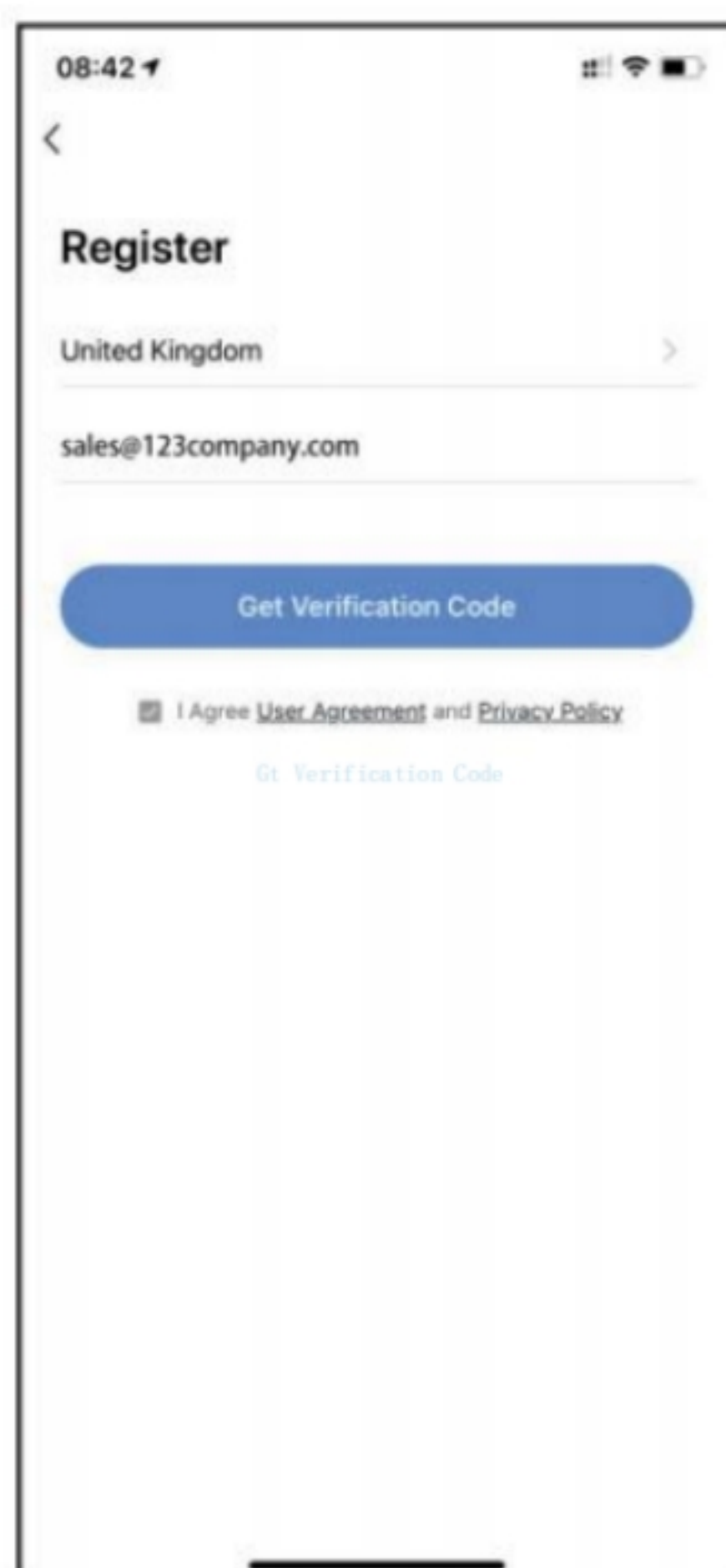

- 3 -

Make sure your mobile phone is connected to Wi-Fi of your home. Tap on "Add Device" or tap '+' on the upper right corner of the homepage. And select "Auto Scan" or select "swicth (Wi-Fi)" form the device type list.

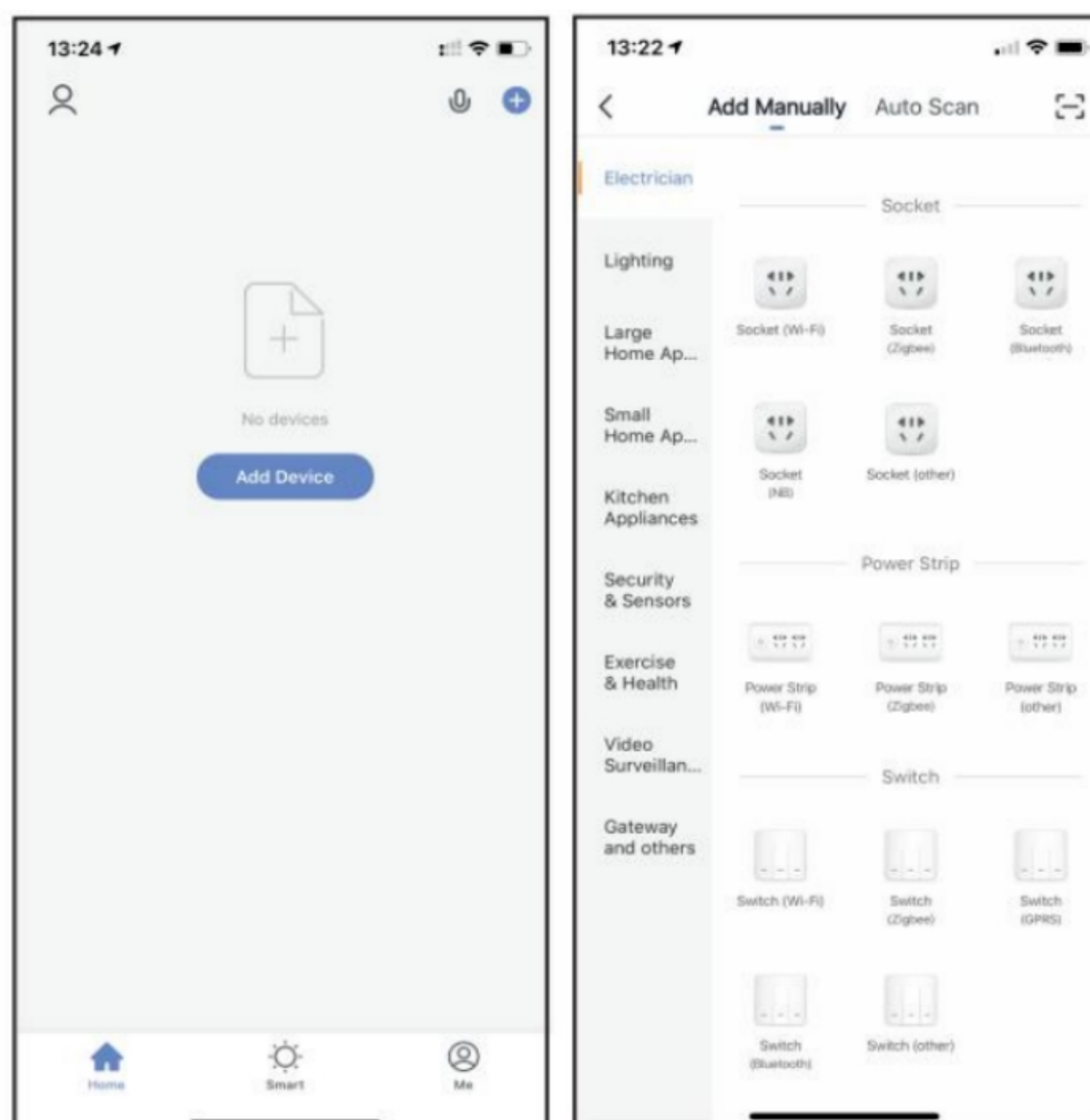

- 4 -



**Step 2:** Switch on power supply. The indicator light on the Wi-Fi dimmer switch will blink rapidly. If it does not blink, press the paring key for around 10 seconds. The indicator will flash from slow - fast - stay still. Then release when the indicator light is still. After 3 seconds, the indicator will blink rapidly (twice per second). Tap on “Confirm light rapidly blink” to continue.

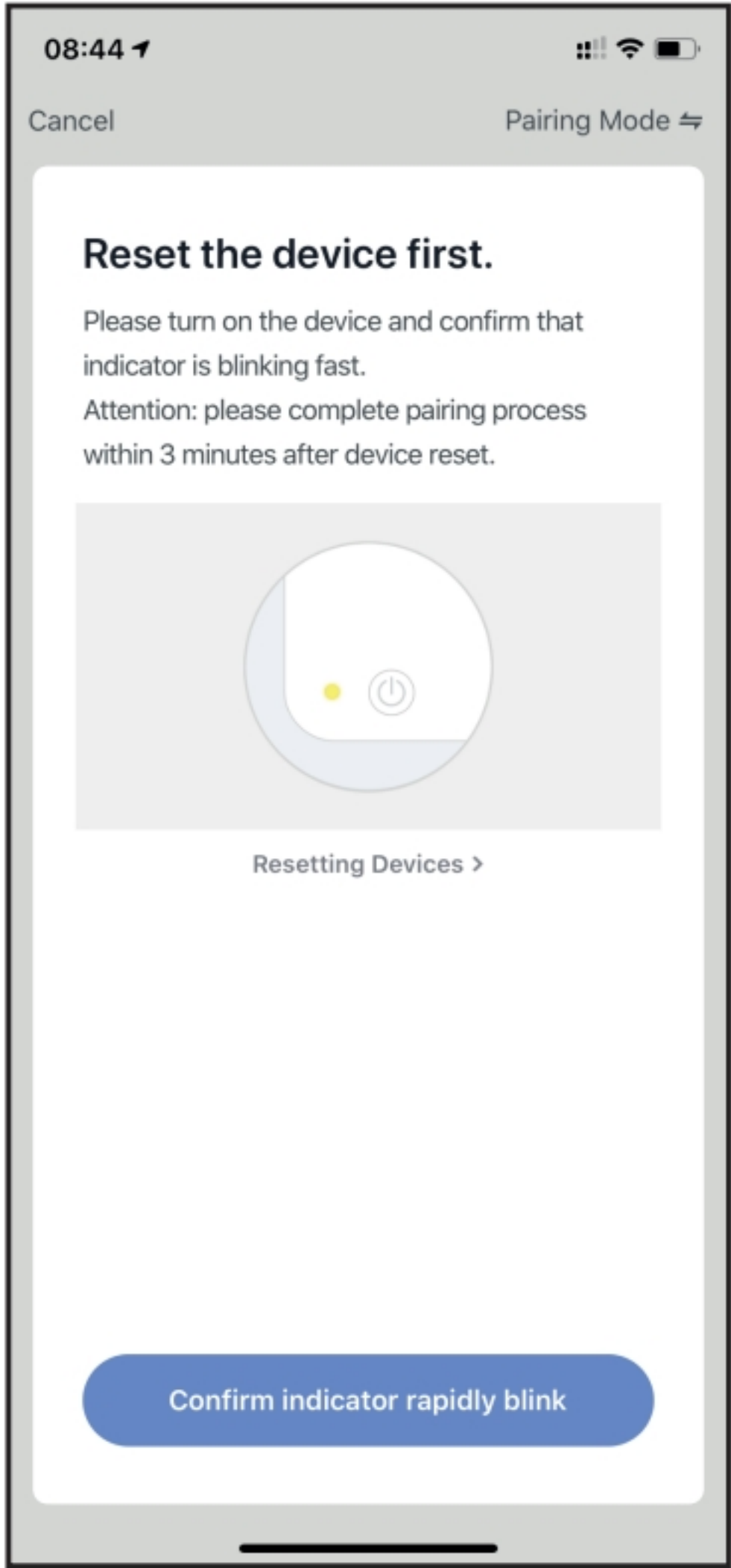

- 5 -

**Step 3:** Select a network for your Wi-Fi dimmer switch and tap on “Confirm” to connect device.

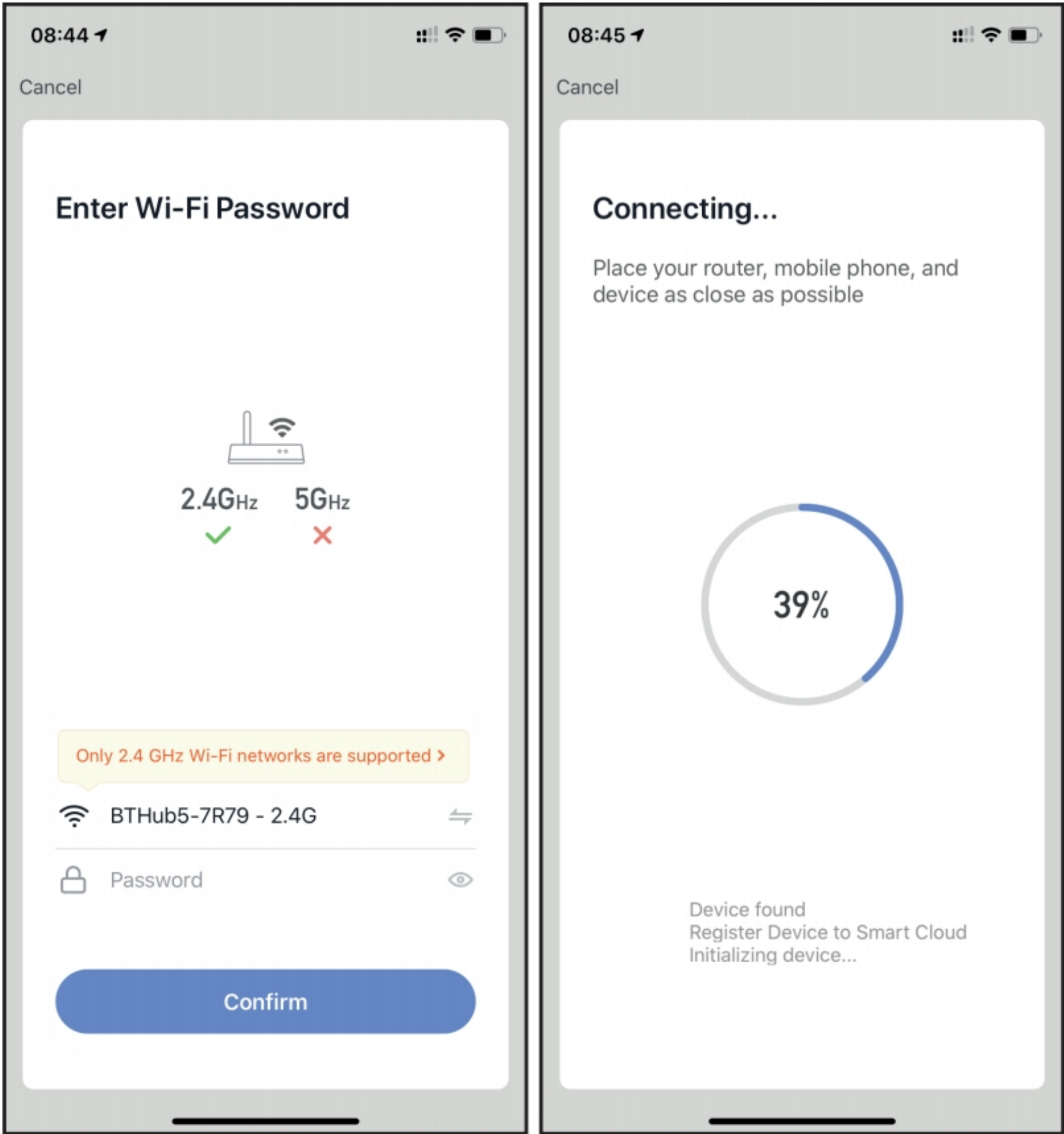

- 6 -

**Step 4:** After Smart Life added device successfully, you can rename the Wi-Fi dimmer swich. And you can share the device with a family member

**How to set device**

Switch On/Off: Tap on the device name on the homepage (here is “Wi-Fi dimmer switch”) to enter device setting. You can switch On/Off and dim the light.

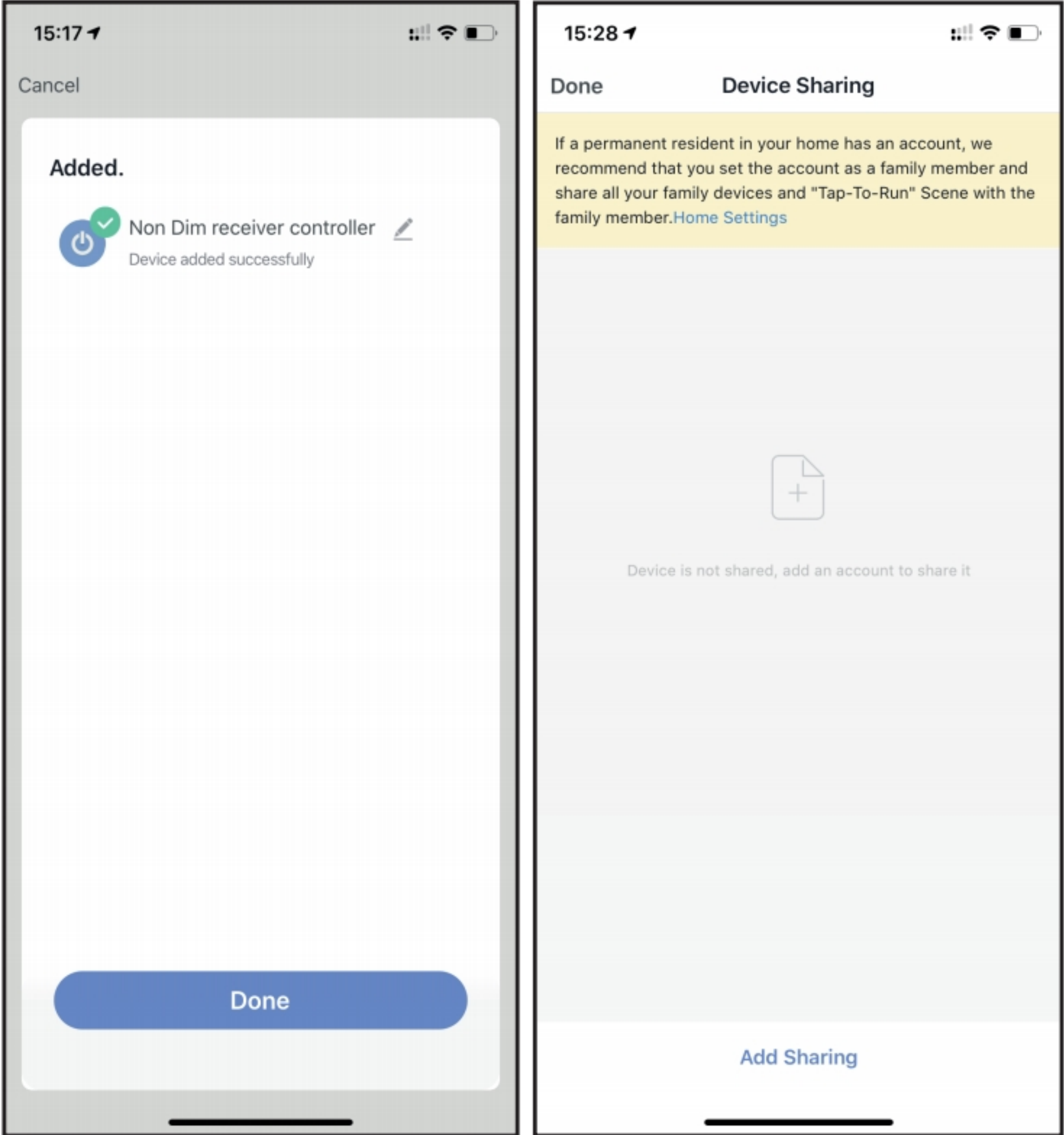

- 7 -

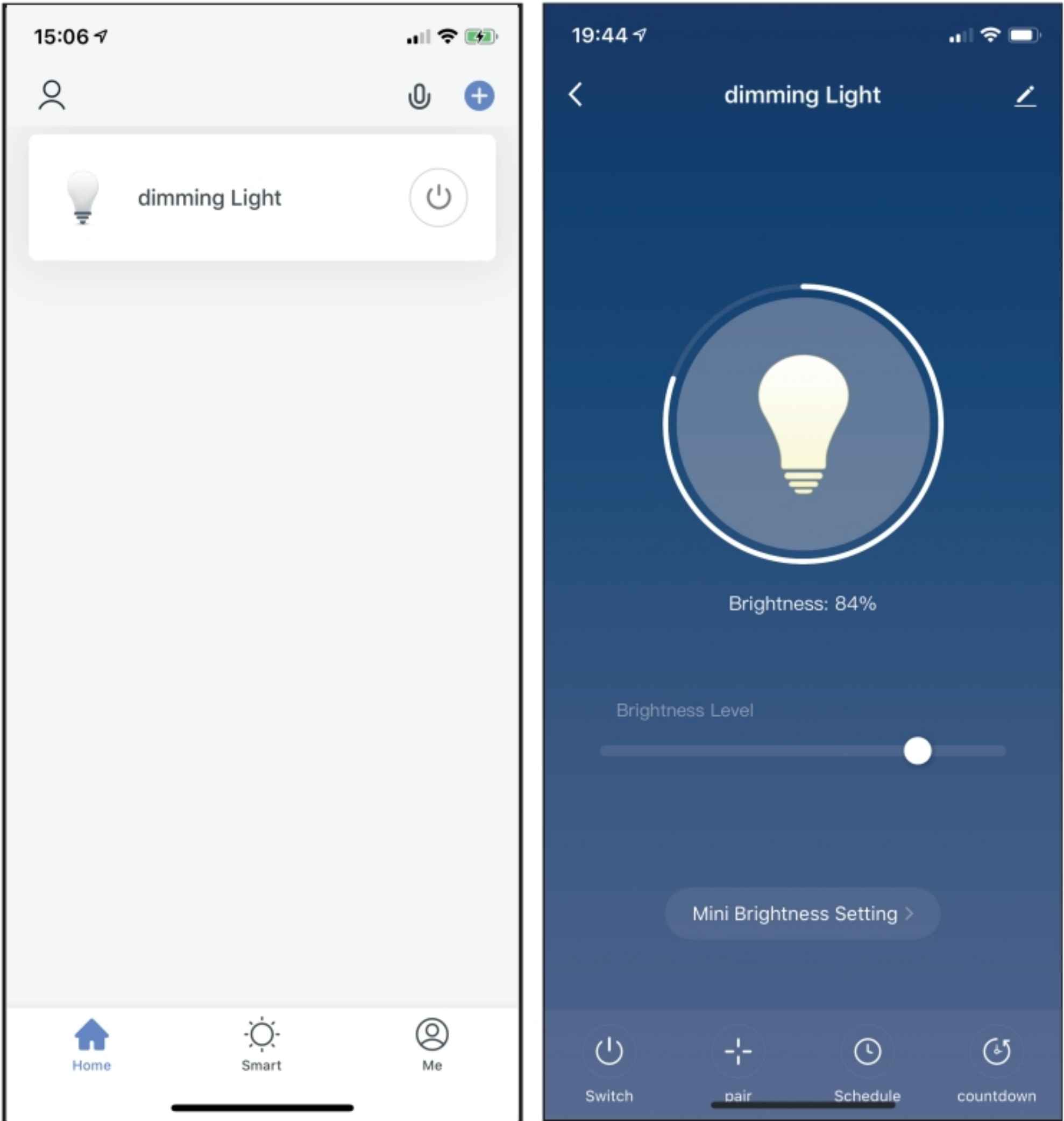

- 8 -



**Set timer:** You can set a countdown or set a schedule to switch On/Off your smart device.

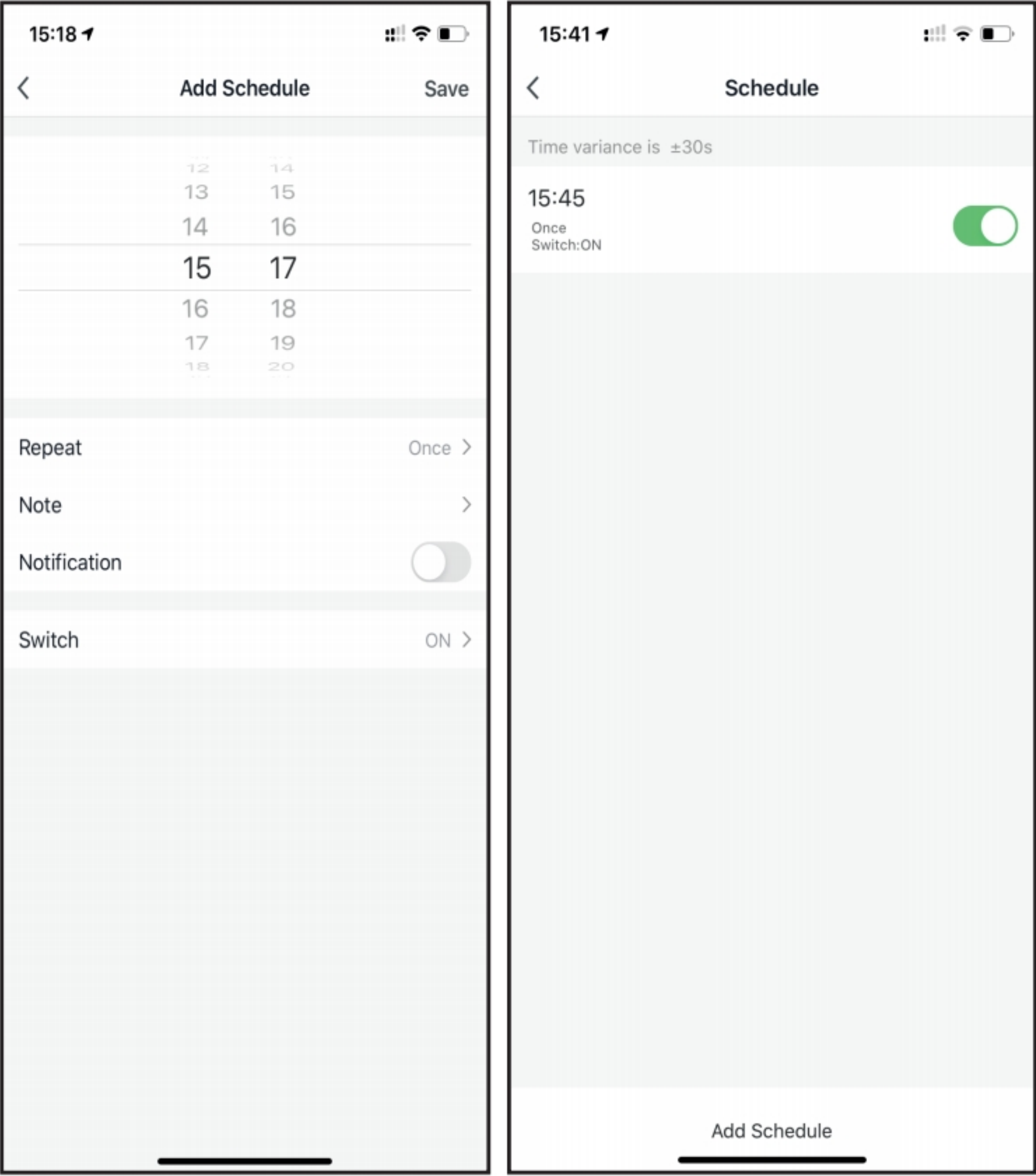

## How to control device by Amazon Alexa

**Step 1:** Open the Amazon Alexa App. Go to Home and select Skills. Input Smart Life in the search bar. Tap on Enable to add the skill.

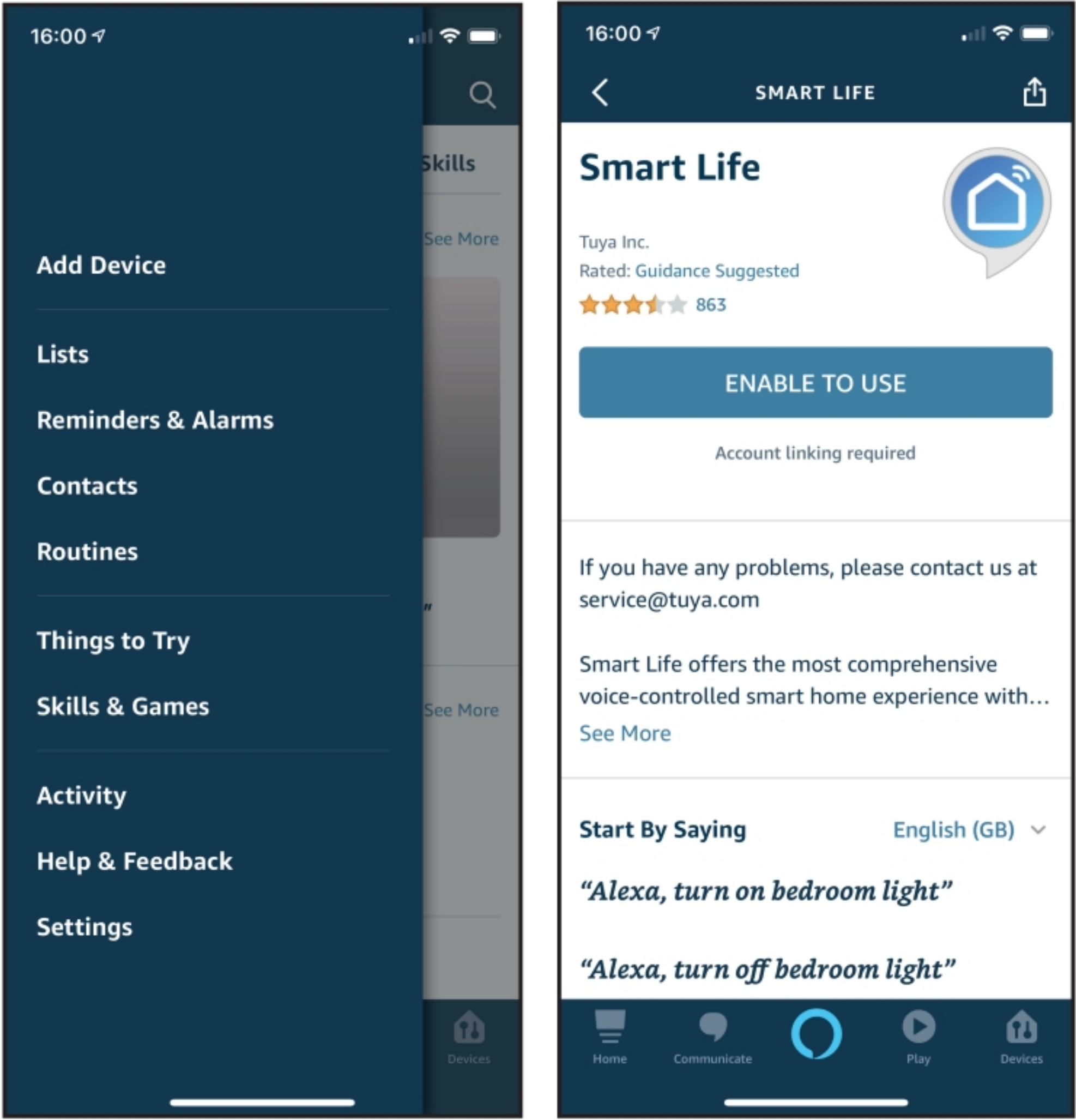

**Step 2:** Select your country code. Enter our Smart Life App account name and password. Then tap on Link Now to continue. After the link succeeds, close the window and go back on the Alexa App.

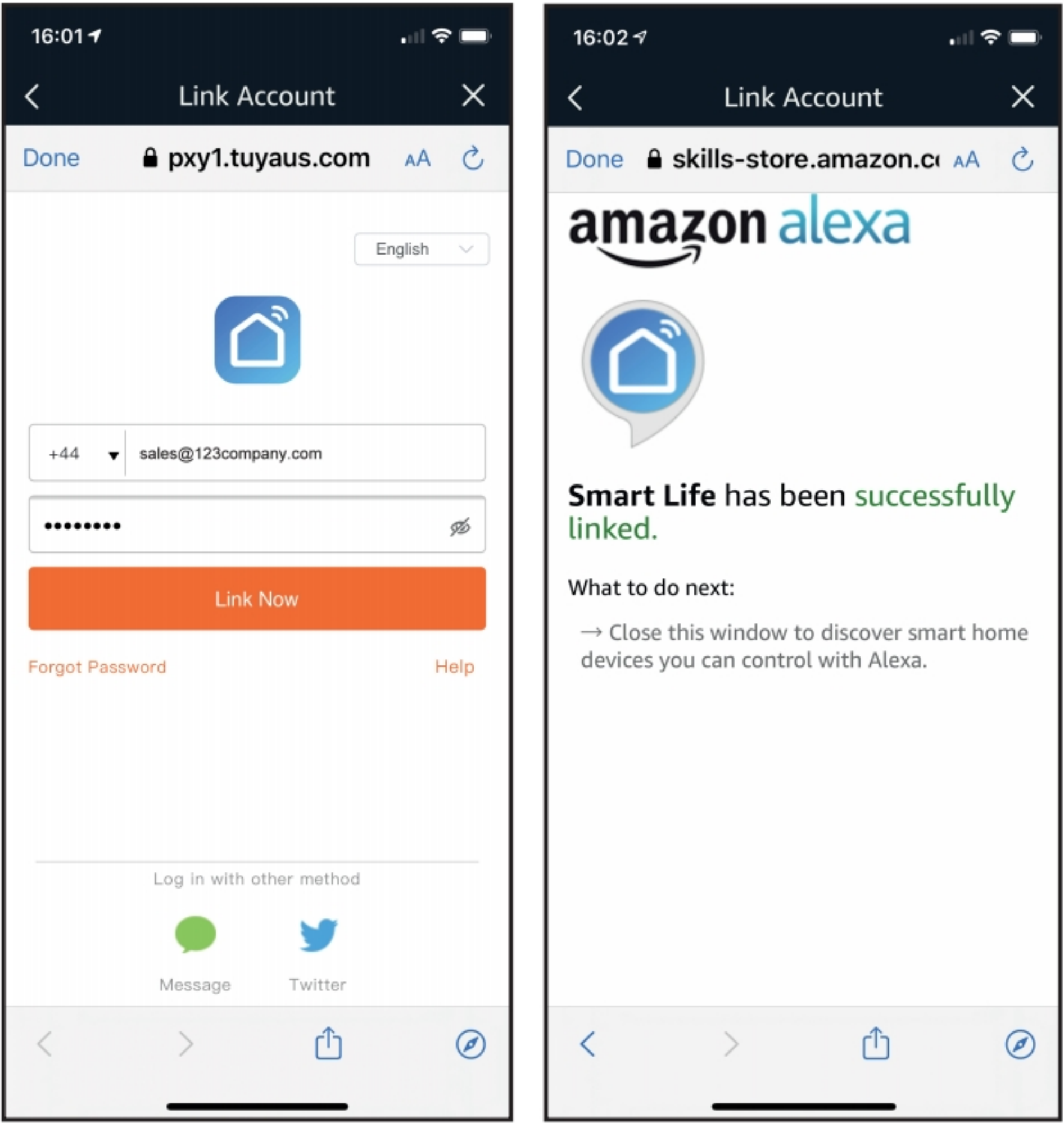

**Step 3:** Tap on Smart Home, Select Devices and then tap on Discover.

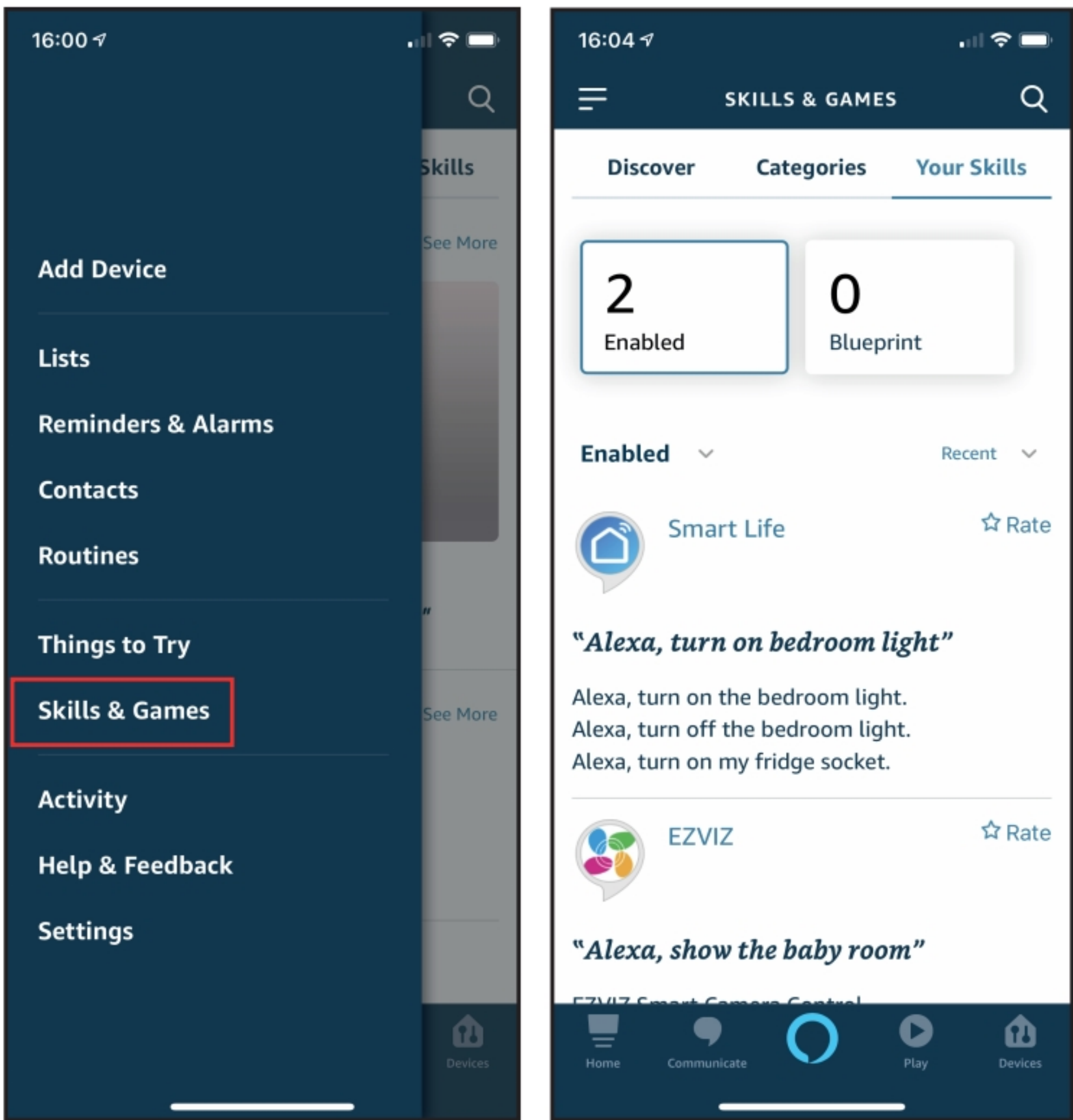



Alexa will discover device, After about 20 seconds, the devices will show in the list.

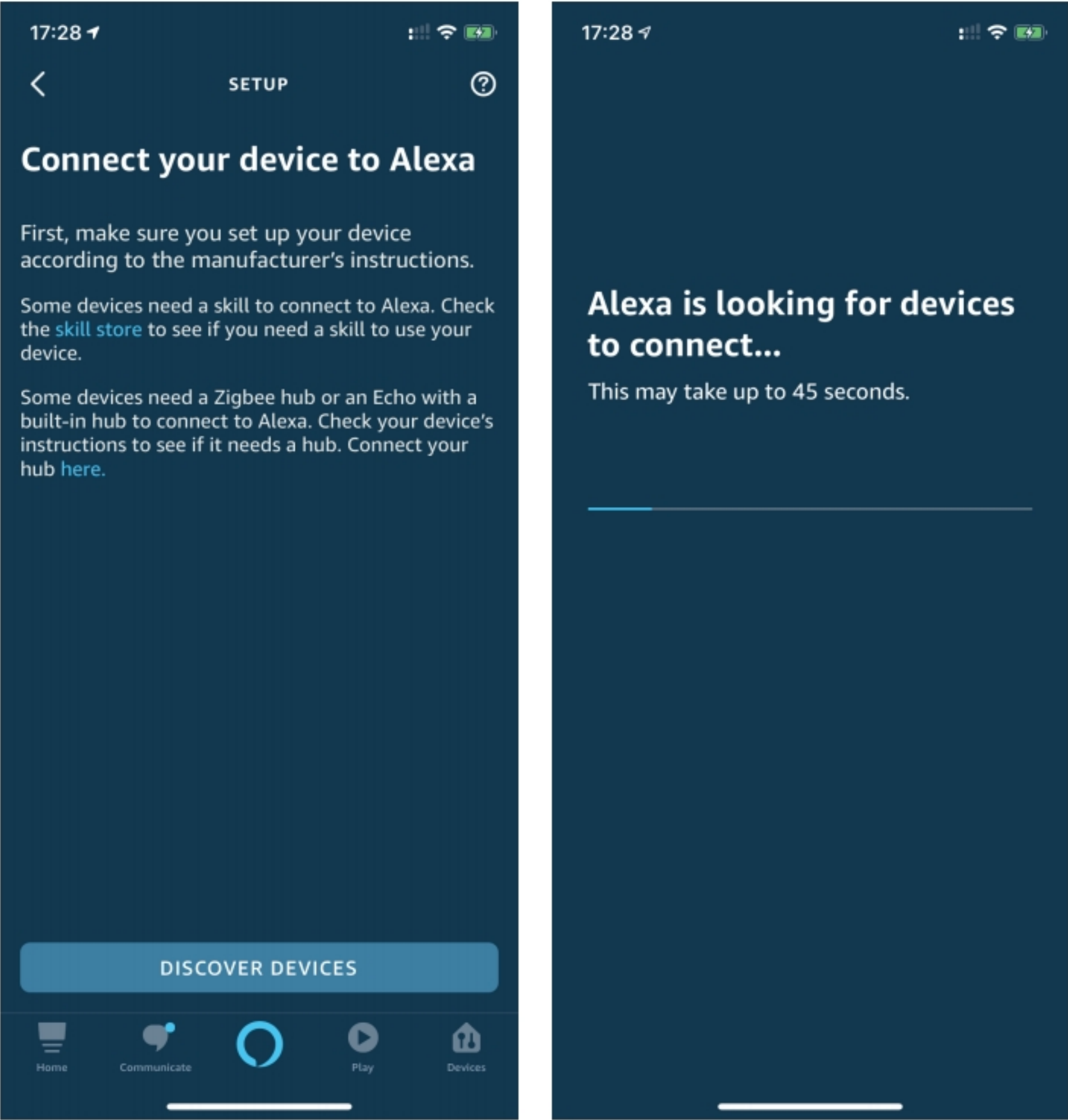

Now you can use Alexa to voice control your Smart devices.

“OK, Alexa, turn On/Off xxx”  
“OK, Alexa, set XXX to 35%”

## How to control device by Google Home

**Step 1:** Open the Google Home or Google Assistant App. Go to Home and select Home Control. Tap on ‘+’ on the lower right corner to add skill. You can find ‘Smart Life’ in ‘Add device’ list.

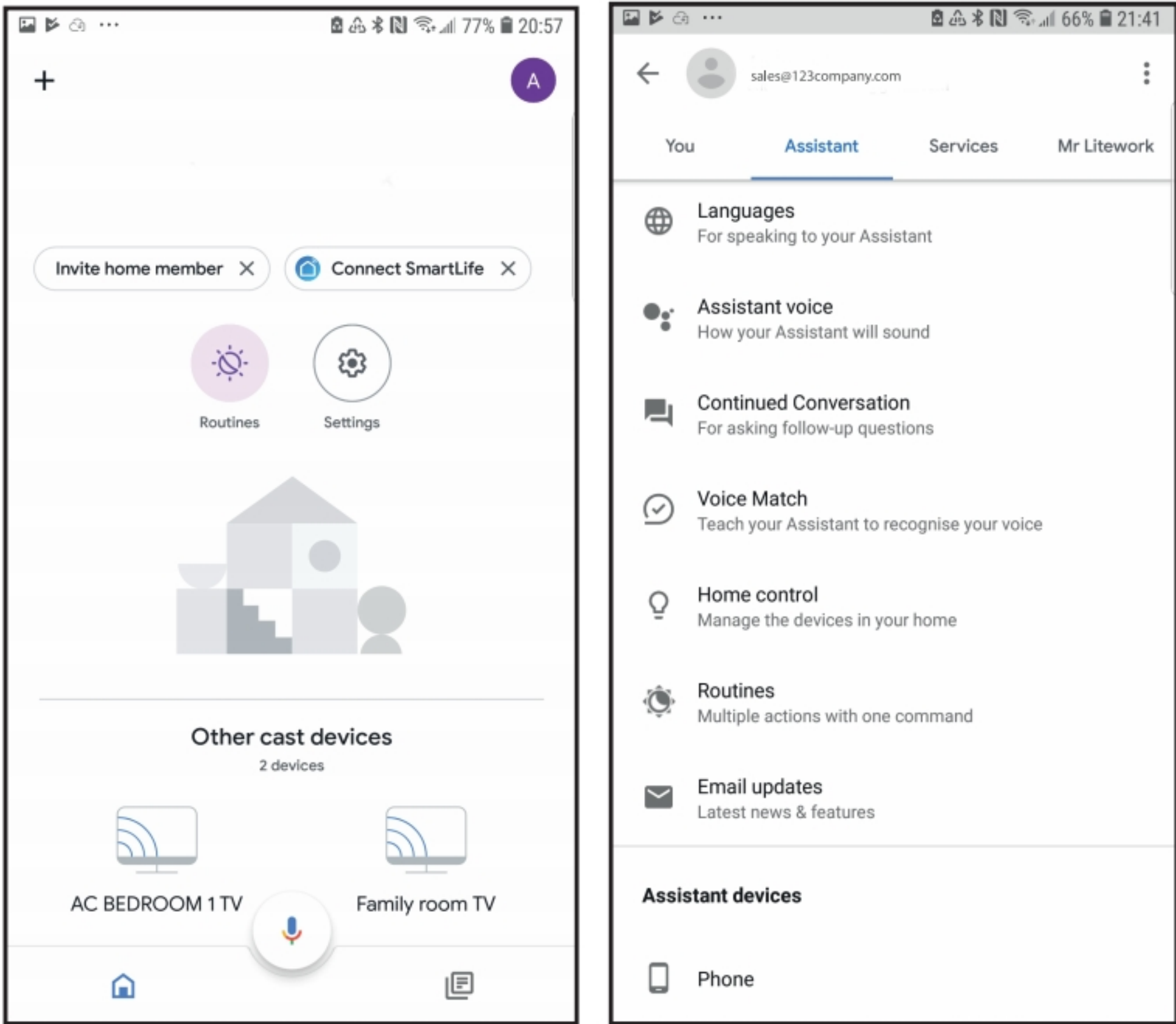

**Step 2:** Select your country code. Enter your Smart Life App account name and password. Then tap on Link Now to continue.

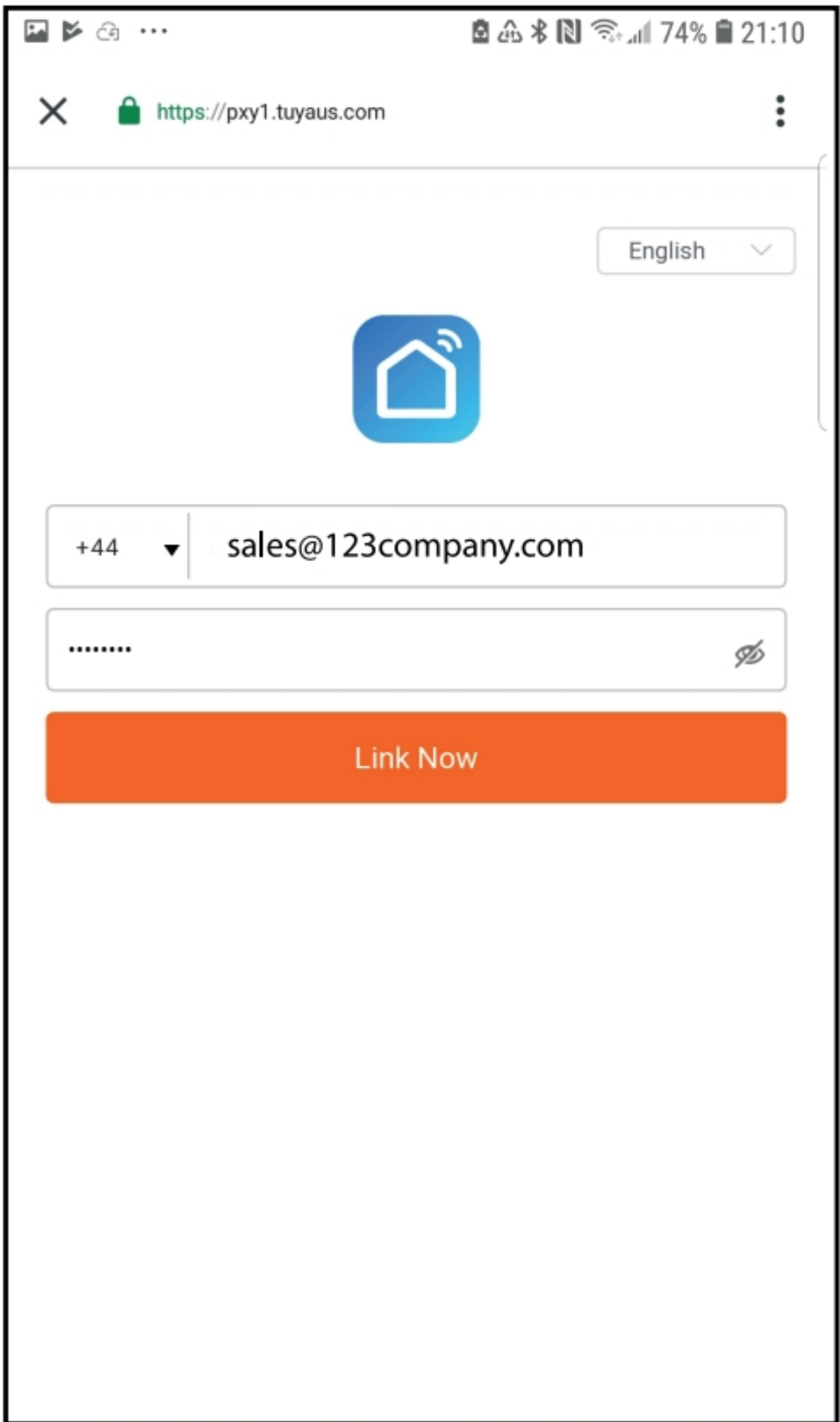

**Step 3:** After the link succeeds, ou can assign rooms for your smart devices. Later you can find the Smart devices in the Home Control list.

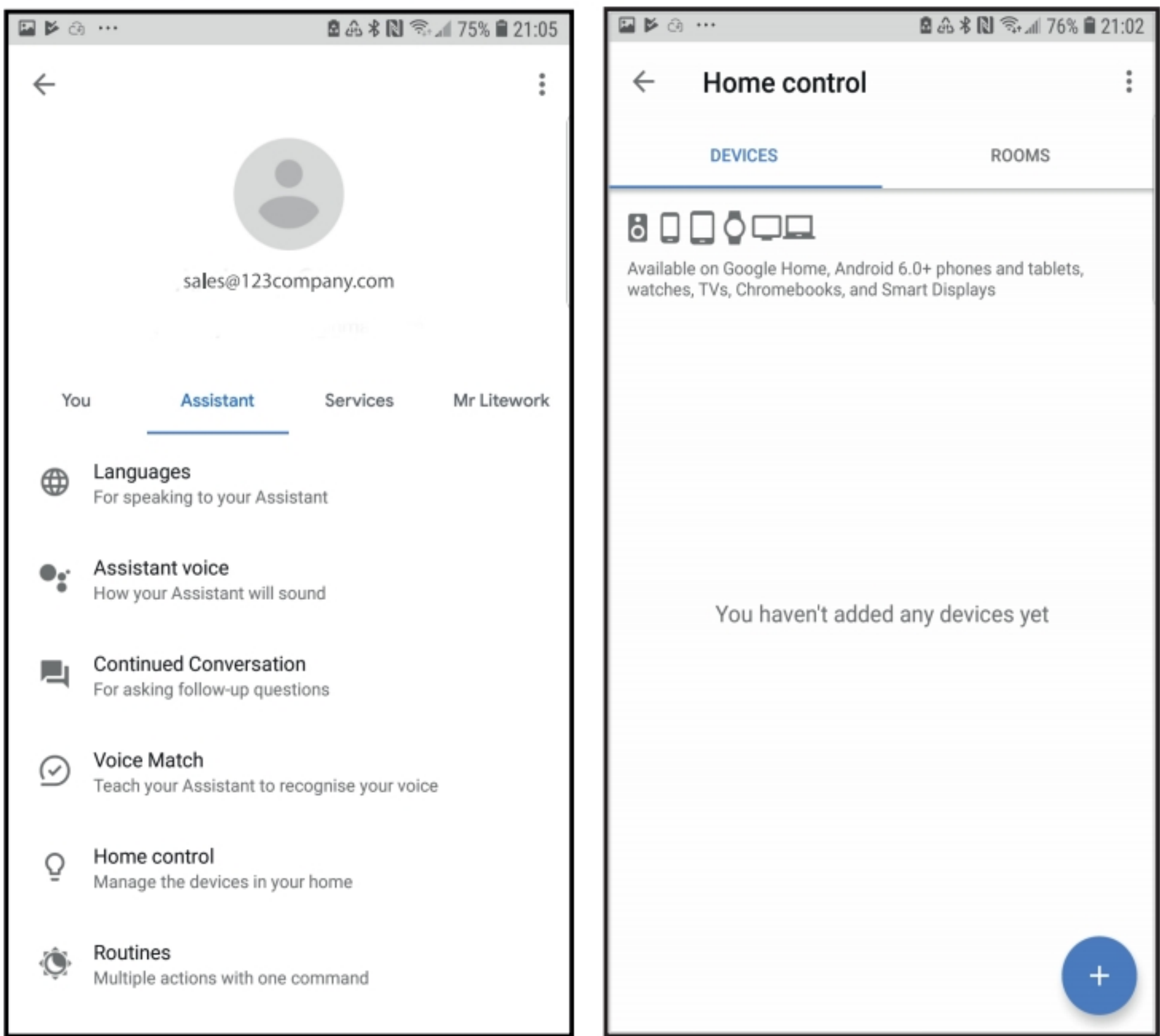

Now you can use our Google Home to voice control your Smart devices.  
“OK, Google, turn On/Off xxx”  
“Ok, Google, Set xxx to 35%”