

# USER MANUAL

AGE 8+

## 1.0 ABOUT THE RC CAR

The RC car adopts 2.4G variable speed control technology to control functions such for forward, backward, left and right turning and multiplayer competition without interference. Pull the Trigger to control the speed. The harder, the faster, and the slighter, the slower. The design such as powerful motor and antiskid tyres makes stable driving of the car possible, bringing you an ultimate experience full of speed and thrill!

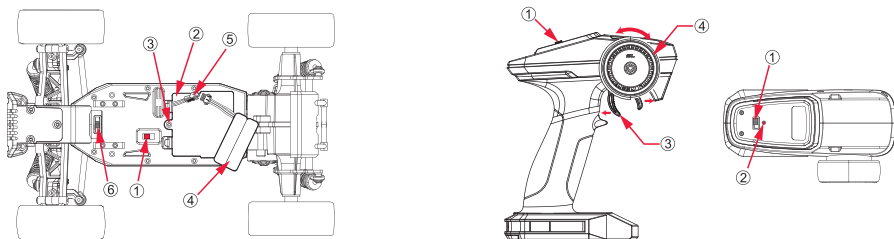

- ① ON/OFF Switch  
② Battery Compartment  
③ Battery Compartment Screw  
④ Rechargeable Battery  
⑤ Battery Connector  
⑥ Direction Fine-tuning

## 2.0 ACCESSORIES

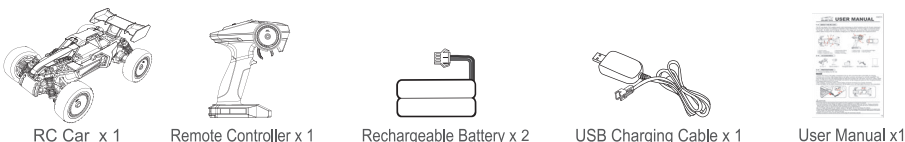

## 3.0 PREPARATIONS

### 3.1 Charge the Battery for RC Car

#### STEPS

1. Unscrew the screws on the battery compartment in the car with a screwdriver, take out the battery for charging.
2. Connect one end of the USB charging cable to the battery connector and ensure it is correctly connected. Then insert the other end of the USB charging cable into safe power supplies with USB socket, such as PC, laptop, mobile power, or USB power socket etc. The red light turns solid on during charging and goes out when charging completes. Full charging takes around 2 to 3 hours.
3. After charging, connect the battery with the battery connector and ensure it is correctly connected.
4. Insert the battery into the battery compartment, refit the battery cover, and finally tighten the screws with a screwdriver.

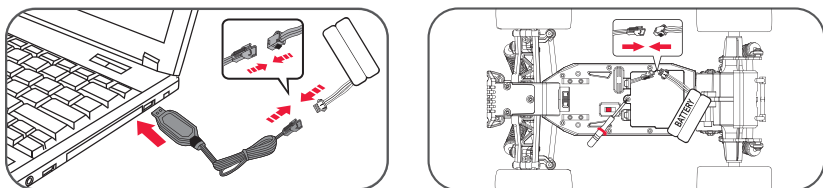

#### ⚠ NOTICE:

- Juveniles shall be accompanied and guided by their guardians to charge the product.
- It is recommended to fully charge the battery to ensure sufficient power before the first use. Please understand that the running time will be relatively shortened without prior charging for the first use due to insufficient power of the battery, which is caused by the auto discharge during transportation.
- Do not charge batteries that are inflated, leaked or damaged. Do not overcharge the battery.
- Please use the original USB charging cable from the factory. Do not use charging cables that are damaged or non-original ones.
- Keep it away from flammable materials and do not put it on the surface of conductive objects (such as carpet, wooden floor or furniture, etc.) during charging.
- Please be careful to avoid electric shock while using the electrical products.

### 3.2 Install the Battery for Remote Controller

#### STEPS

1. Use a screwdriver to unscrew the screws on the battery compartment of the remote controller and open the battery cover.
2. Install three new 1.5V AA batteries (not included) into the battery compartment and make sure the "+" and "-" of the batteries match with those indicated inside the compartment.
3. Refit the battery cover and tighten the screws.

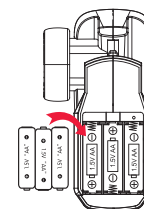

USE 3X1.5V "AA" BATTERIES (NOT INCLUDED)

#### ⚠ NOTICE:

- Please ensure the "+" and "-" electrodes have been correctly aligned.
- Do not mix old and new batteries.
- Do not mix different types of batteries.

### 3.3 Drive in Suitable Environment.

#### Suitable Driving Environment



#### Unsuitable Driving Environment



## 4.0 DRIVE VIA REMOTE CONTROL

#### STEPS

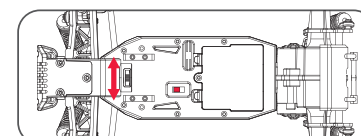
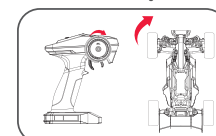
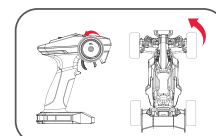
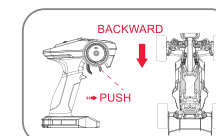
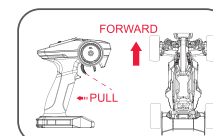
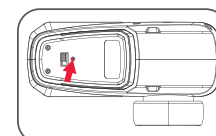
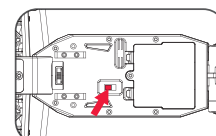

## 5.0 MAINTENANCE

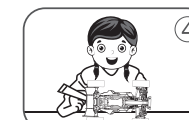
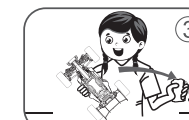
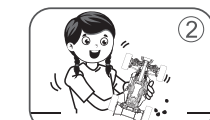
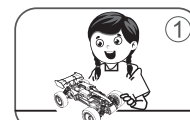

## 6.0 TROUBLE SHOOTING

Problems	Causes	Solutions
RC car/ remote controller out of control/ not responsive	1. Switch not turned on.	1. Turn on the switch.
	2. Batteries improperly installed.	2. Ensure the positive and negative terminals are correctly aligned.
	3. Low battery voltage.	3. Replace the batteries of the remote controller/ Recharge the batteries for the RC car.
	4. Out of control range.	4. Control it with in 45 meters.
Close control range.	5. RC car not pair with the remote controller.	5. Power off the RC car and the remote controller and then turn on again and pair again.
	1. Signal interference around.	1. Try to drive in another place.
RC car fails to drive in a straight line.	2. Low battery voltage for RC car/ remote controller.	2. Replace the batteries of the remote controller/ Recharge the batteries for the RC car.
	1. Excessive surface friction or extremely smooth surface.	1. Try to drive in another place.
	2. Fail to activate fine-tuning function.	2. Toggle fine-tuning switch to trim the directions.

## FCC Warning

This device complies with part 15 of the FCC Rules. Operation is subject to the following two conditions: (1) This device may not cause harmful interference, and (2) this device must accept any interference received, including interference that may cause undesired operation.

Any Changes or modifications not expressly approved by the party responsible for compliance could void the user's authority to operate the equipment.

**Note:** This equipment has been tested and found to comply with the limits for a Class B digital device, pursuant to part 15 of the FCC Rules. These limits are designed to provide reasonable protection against harmful interference in a residential installation. This equipment generates uses and can radiate radio frequency energy and, if not installed and used in accordance with the instructions, may cause harmful interference to radio communications. However, there is no guarantee that interference will not occur in a particular installation. If this equipment does cause harmful interference to radio or television reception, which can be determined by turning the equipment off and on, the user is encouraged to try to correct the interference by one or more of the following measures:

- Reorient or relocate the receiving antenna.
- Increase the separation between the equipment and receiver.
- Connect the equipment into an outlet on a circuit different from that to which the receiver is connected.
- Consult the dealer or an experienced radio/TV technician for help.

The device has been evaluated to meet general RF exposure requirement. The device can be used in portable exposure condition without restriction.