

 sbs

FAST SKIN

SMARTPHONE PROTECTION

Operation manual

Index

Introduction	4
Turning on and off	12
Machine calibration	15
Cutting a Fast Skin film	23
Film application	33
Maintenance	44
Troubleshooting	50

□ sbs

FAST SKIN

SMARTPHONE PROTECTION

Introduction

Introduction

- ✓ This operation manual is made for people that are using the Fast Skin system in a store and is meant to help in day-to-day operations of the machine as well as a reminder of the correct film-application techniques.

In case of issues that are not foreseen in this manual, do not hesitate to contact our

- ✓ support at support@fastsk.in.

Don't panic: Fast Skin machine will always guide you with detailed and easy to

- ✓ understand on-screen instructions.

Before starting: The correct use of Fast Skin requires that the machine is positioned on a

- ✓ stable and levelled surface such as a table or a workbench with enough room around it to be able to insert cutting materials and operate the machine normally.

Fast Skin Machine Parts

- 1 - Fast Skin machine
- 2 - Blade holder
- 3 - Cutting strip
- 4 - Main screen
- 5 - Power button
- 6 - Film locking lever
- 7- SIM card slot

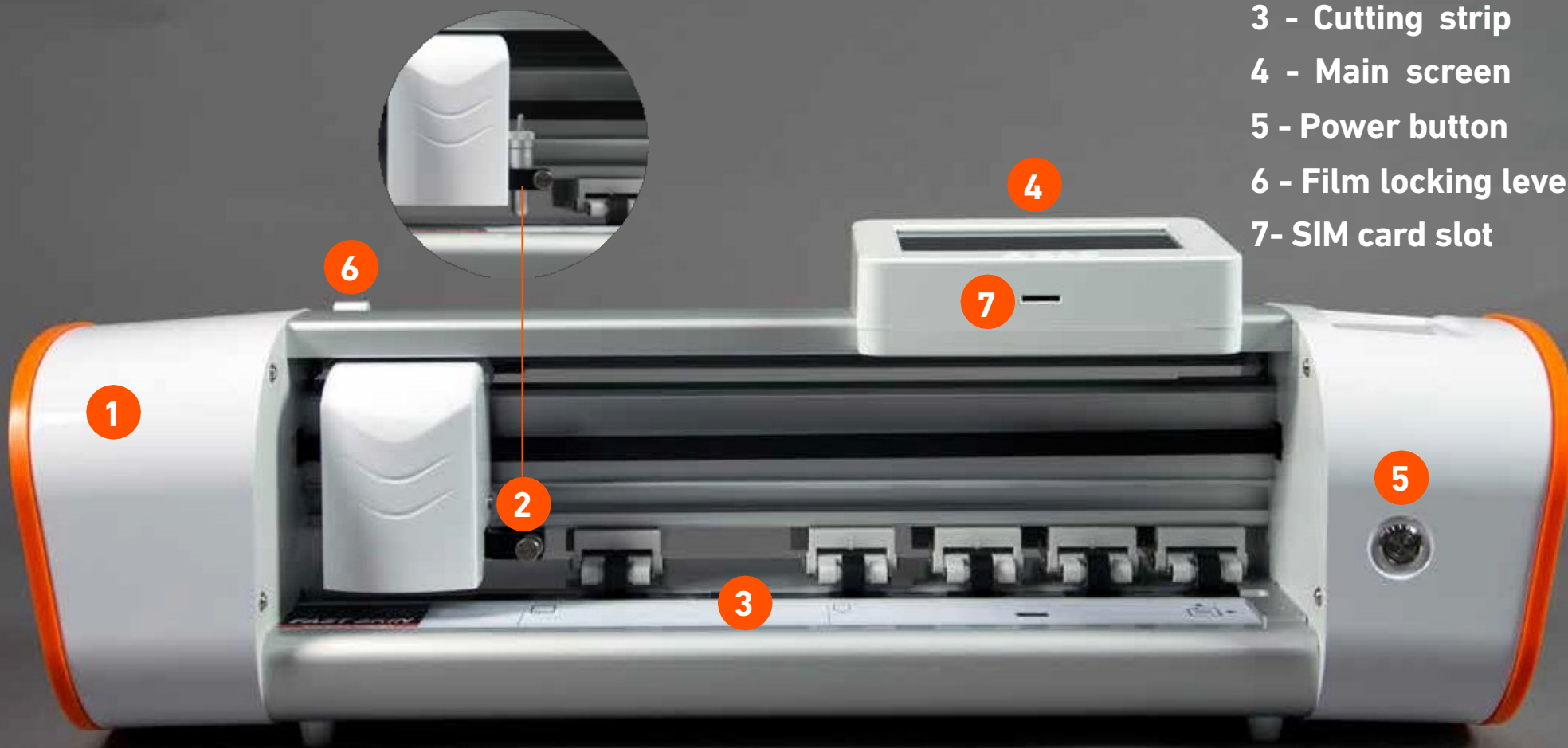

Fast Skin Machine Parts

7- Film locking lever

8 Power input

9 Ethernet port



Fast Skin Starter Kit



- 1 - Skidproof application mat
- 2 - Spatula L
- 3 - Spatula XL
- 4- Tablet spatula
- 5 - Cleaning cloth
- 6 - Cleaning liquid
- 7 - Hot air gun
- 8- Standard sheet
- 9- Tweezers
- 10 - Tool
- 11- Power cord and power supply
- 12 - Blade Holder
- 13 - Spare blades
- 14 - Screwdriver

Fast Skin film composition

- 1 Protection layer:** this layer protects the film layer during installation. Optional, used for transparent film only.
- 2 Film layer:** this is the part that remains on the device after the installation.
- 3 Installation layer:** this layer adheres to the installation site and holds the film in place during the application. This layer has a cut in the middle that is used to first install one half of the film and then the other.
- 4 Bottom layer:** this layer holds the film together while cutting it in the machine. It should remain mostly intact during cutting.

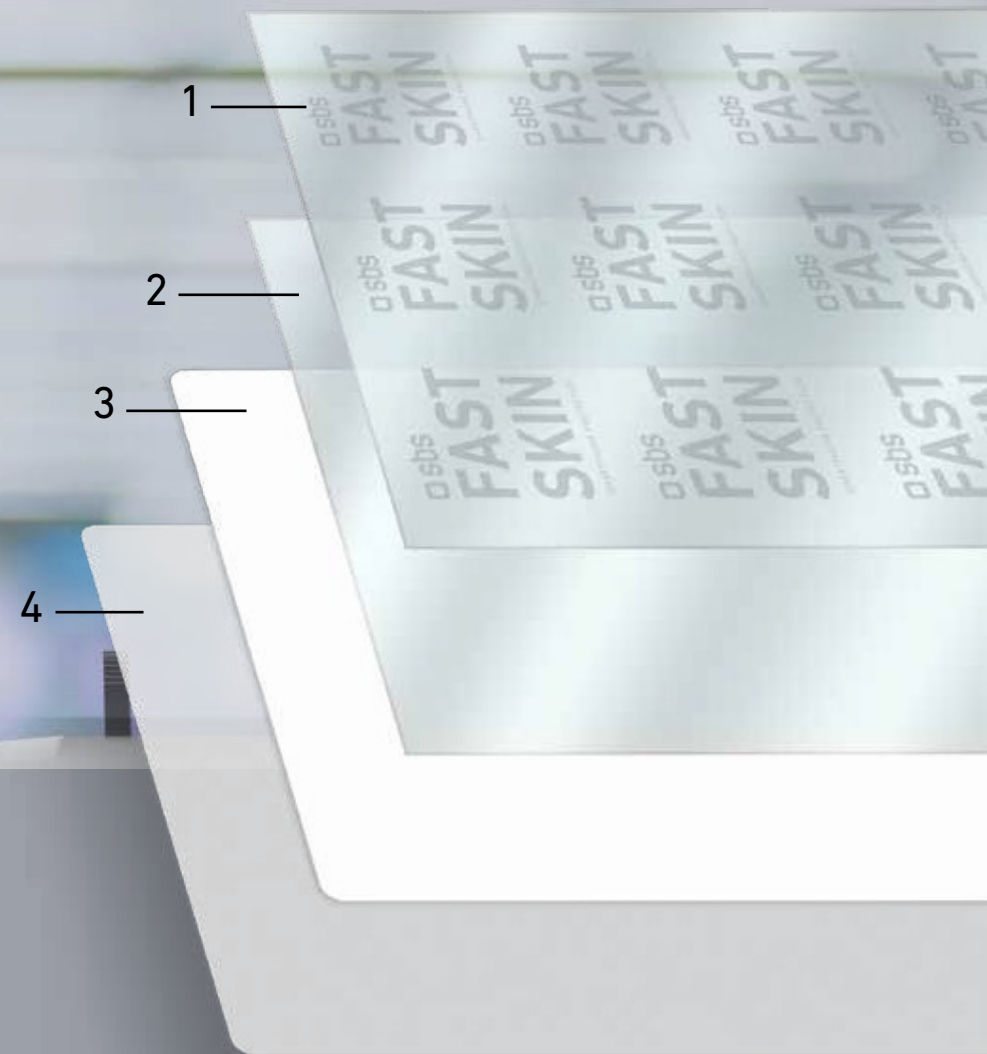

On-screen commands

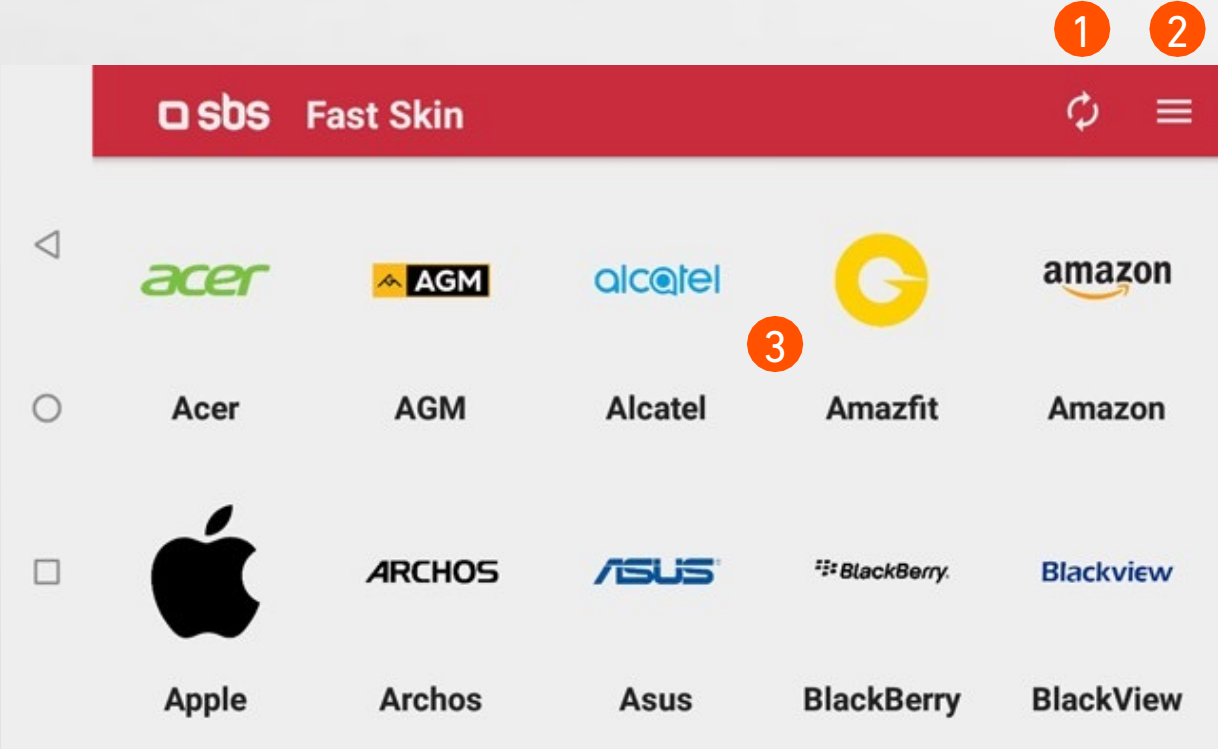

1 **Refresh button:** reloads all available cuts at once

2 **Menu button:** opens the menu

3 **List of device brands**

On-screen commands

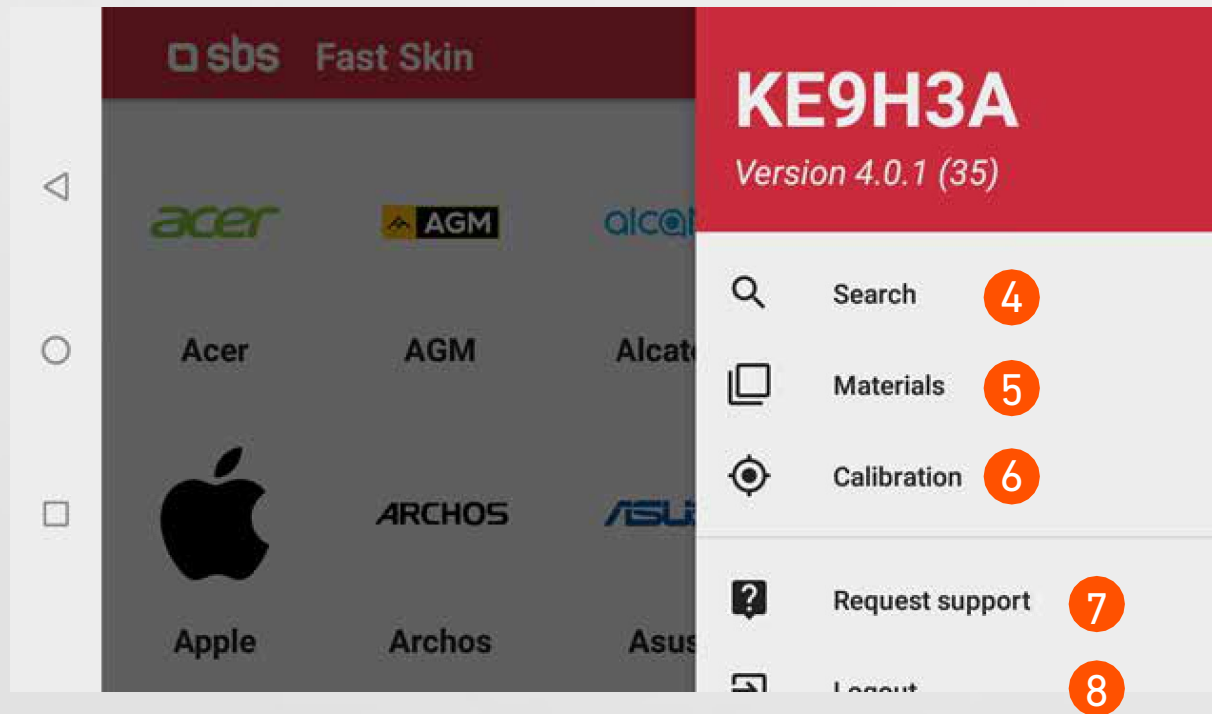

- 4 **Search:** lets you search for a device
- 5 **Materials:** configures the machine to use different Fast Skin materials
- 6 **Calibration:** starts machine calibration procedure
- 7 **Send a new support request**
- 8 **Disconnect the machine.** You will have to log-in again to use the machine after this

 sbs

FAST SKIN

SMARTPHONE PROTECTION

Turning on and off

Turning **on and off**

Before turning Fast Skin on, make sure to:

- 1 Insert the power connector into the appropriate port on the Fast Skin machine.
- 2 Connect the power cable to the power supplier.
- 3 Insert the power cable into the mains.

Turning on and off

Turning on



Press the power button and hold it until you see SBS logo appear on the screen

Turning off



Press the power button and hold it until «Reboot» and «Power off» menu appears on the screen. Choose «Power off».

 sbs

FAST SKIN

SMARTPHONE PROTECTION

Machine calibration

Machine calibration

Fast Skin machine needs to be calibrated

- ✓ **Upon first use** the calibration is required before starting normal operation
- ✓ **After a long period of** inactivity
- ✓ **After each blade change**

Calibration is also suggested when **issues during machine operation** are encountered.

The calibration is guided by the machine and requires carefully following the on-screen instructions. The calibration may also be manually started up through the menu.

Machine calibration

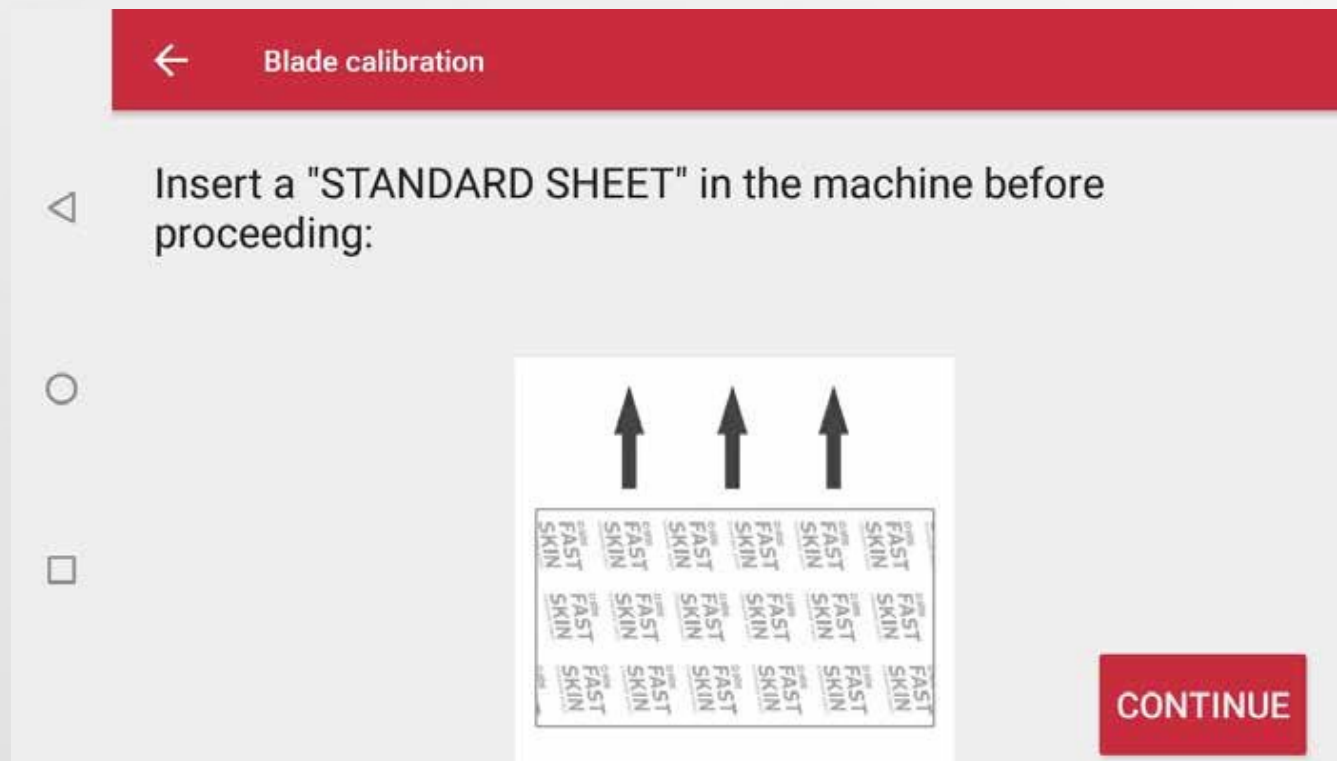

- 1 Insert a sheet of standard material and lock it in place.

Machine calibration

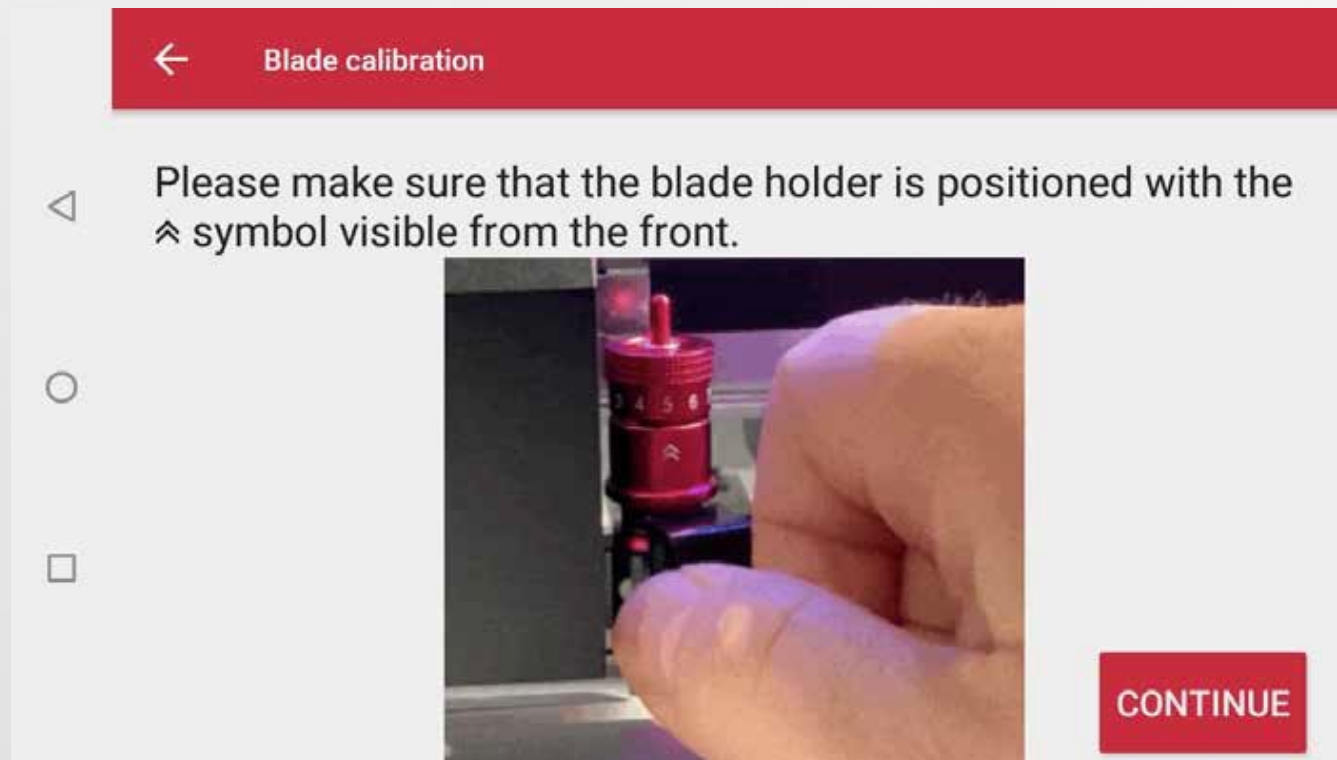

- 2 You're asked to position the bladeholder in such a way that you can change its setting easily without having to unmount it

Machine calibration

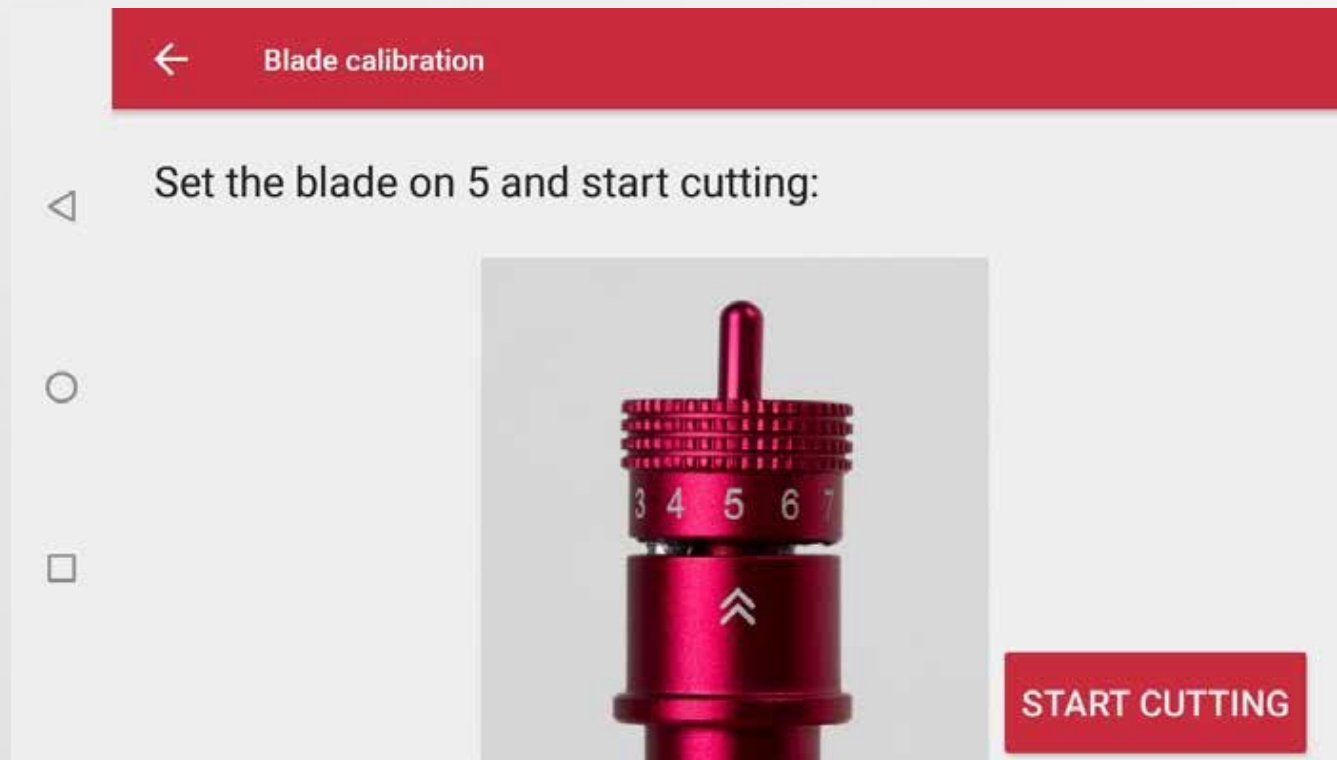

- 3 The on-screen instructions ask you to set the blade to 5 by turning the blade holder cup.

Machine calibration

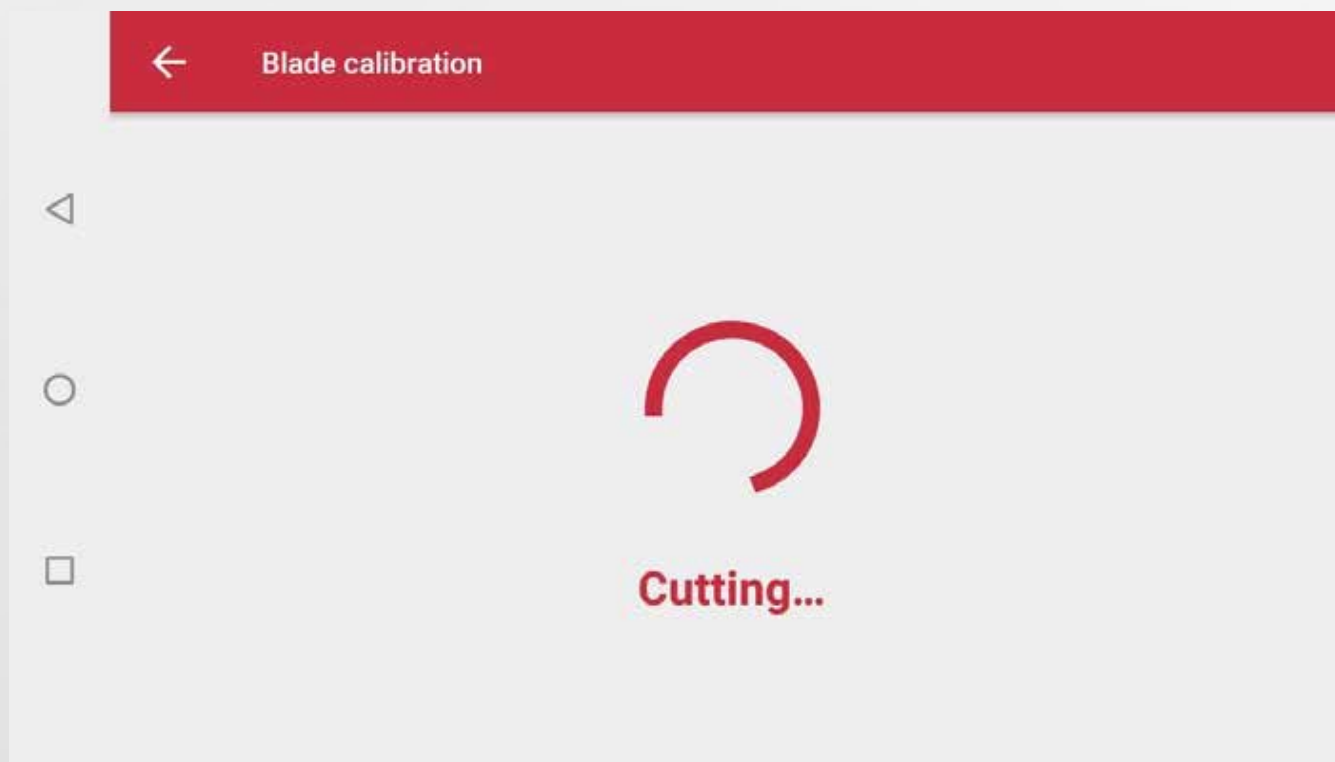

4 Start a calibration cut.

Machine calibration

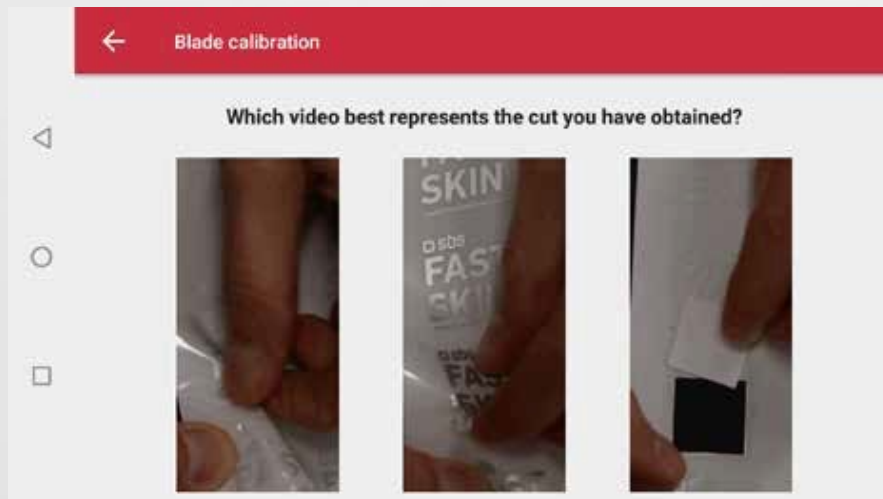

- 5 At this point you're asked to inspect the calibration cut performed by the machine

You have to evaluate the cut the machine has performed and choose one of the three video representations of the result that best resembles the result.

The appropriate result is **when you can easily take out the square cut, leaving the bottom layer of the film intact**. If that's what you have obtained you have to choose the **central video**.

In case the cut is **too shallow**, choose the **top video**.

In case the cut is **too deep** and all four layers of the film are being pierced, choose the **bottom video**.

Machine calibration

- ✓ Based on your response at step 5, you will either have to go through an additional calibration cycle (from step 2 on), or the calibration is going to be completed.
- ✓ When performing additional calibration cuts, **use the same sheet of film** as the machine instructs you to do: a new cut will be added on the same film for each new evaluation step.
- ✓ If the calibration fails, **please contact support** for additional assistance.

 sbs

FAST SKIN

SMARTPHONE PROTECTION

Cutting a Fast Skin film

Cutting a Fast Skin film: choose a phone model

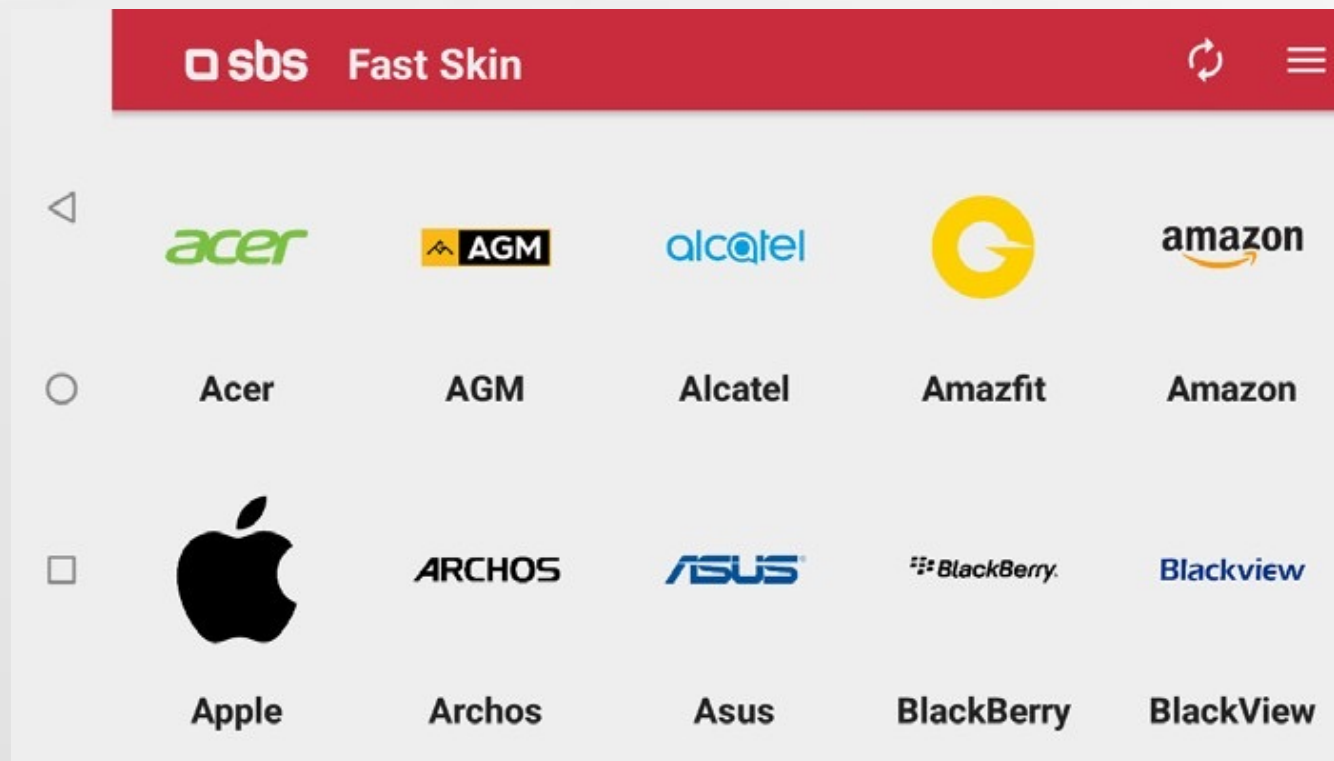

1 Choose device brand

Cutting a Fast Skin film: choose a phone model



2 Choose model family

Cutting a Fast Skin film: choose a phone model



3 Choose the exact model

Cutting a Fast Skin film: choose a cut type



> **Front:**
full cover cut, covers the device's entire screen.



> **Front (Case Friendly):**
covers most of the device's screen, but leaving enough space on the sides, it's compatible with rugged or heavy phone case.



> **Back:**
covers the back of the device and is compatible with both transparent and coloured materials.

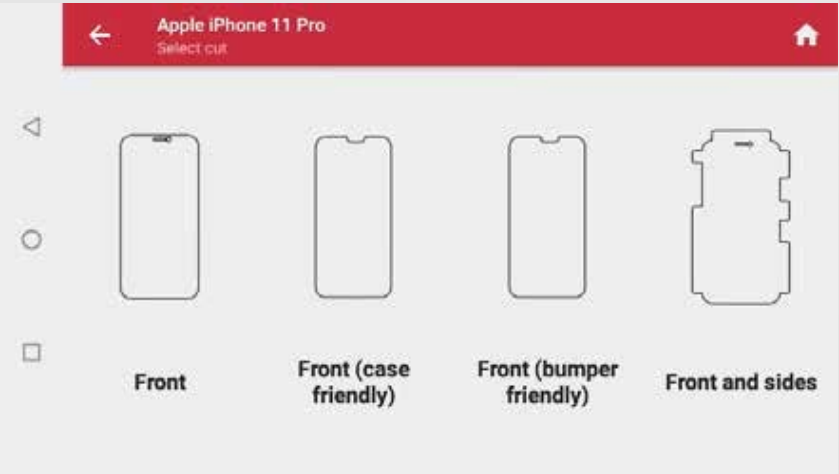

4 Choose a cut type

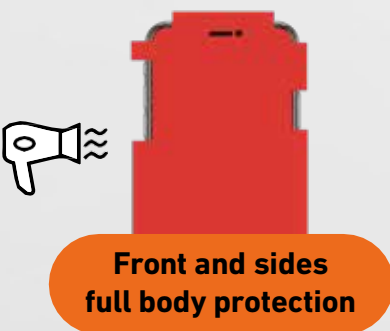

> **Front and sides:**
maximum protection, covers the entire screen and three sides of the device. Applying this cut requires the use of a hot air gun.



> **Back and sides:**
covers the back of the device and is compatible with both transparent and coloured materials. Applying this cut requires the use of a hot air gun.

Cutting a Fast Skin film: **choose the material**

You may choose one of the materials compatible with the cut you are trying to perform.

It is **important to choose the exact same material** you're going to place in the machine because cutting settings and technique vary from one material to another.

Some material will appear disabled as you haven't enabled them for the machine. Please refer to **«Maintenance: managing available materials»** section for more information.



- 5 Choose the material

Cutting a Fast Skin film: preparing to cut

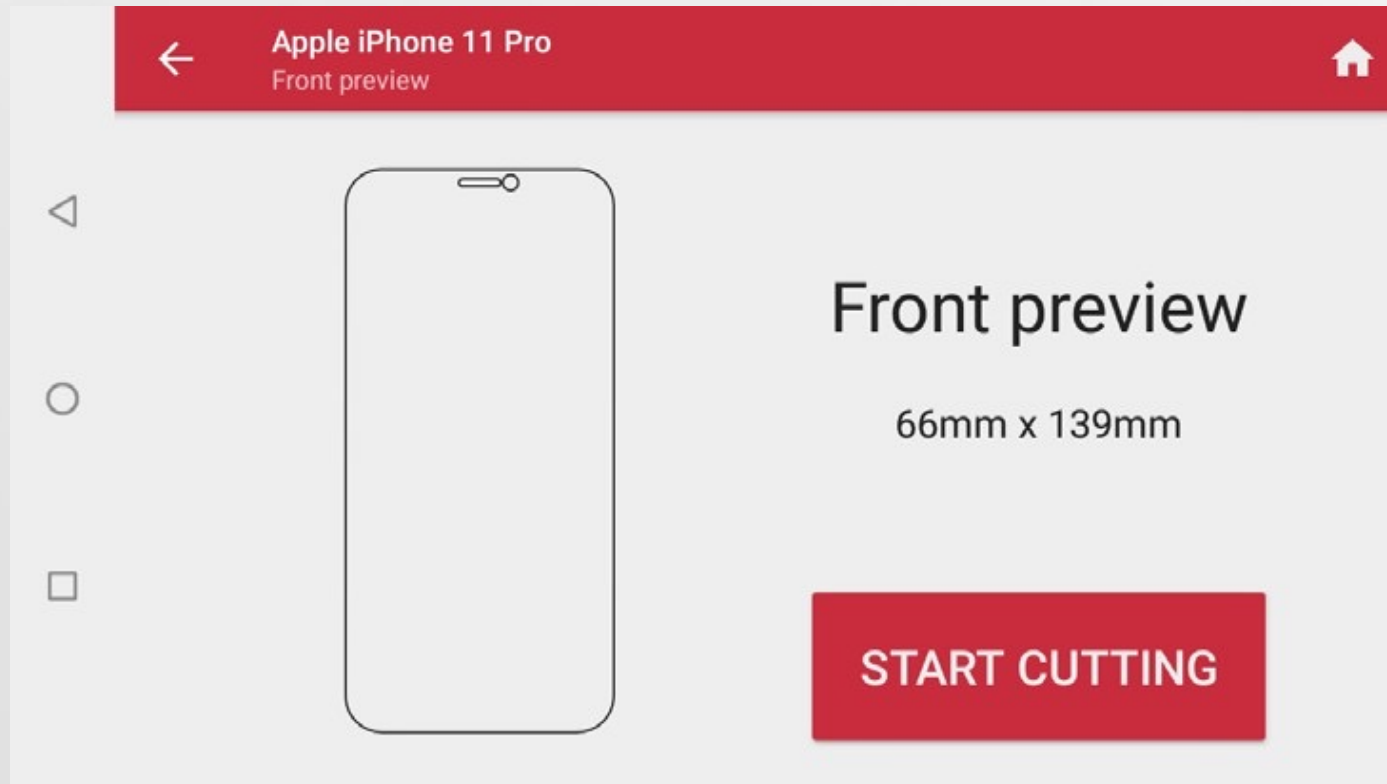

- 6 Examine the cut preview and compare it with the device.
- 7 Touch the «Start cutting» button.

Cutting a Fast Skin film: choose a phone model

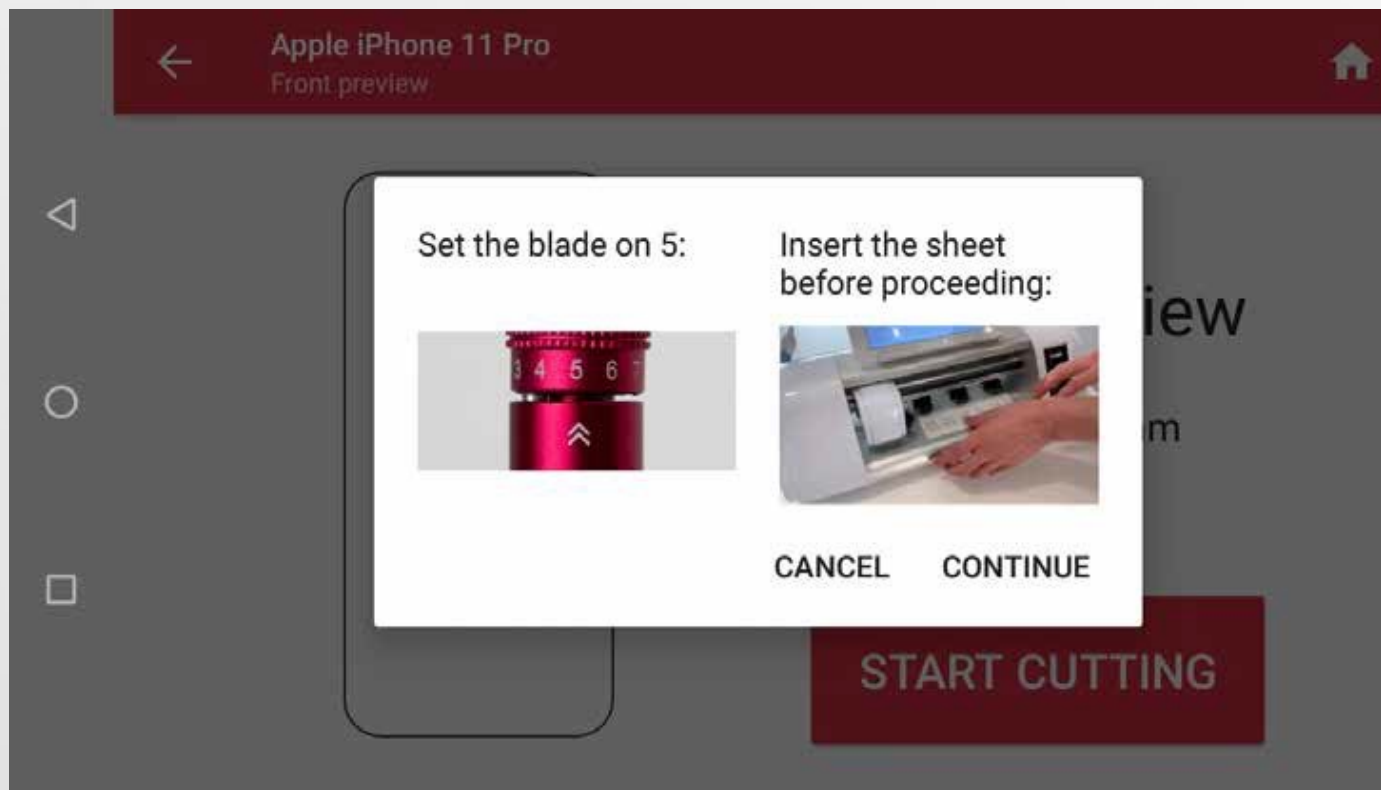

- 8 Set the blade to the setting suggested by the on-screen instructions

Cutting a Fast Skin film: **preparing to cut**

9



10



Place the sheet against the right-side guide so that it is aligned to it. When the rollers start turning, push the film gently so that machine loads and positions it automatically

Cutting a Fast Skin film: **cutting the film**

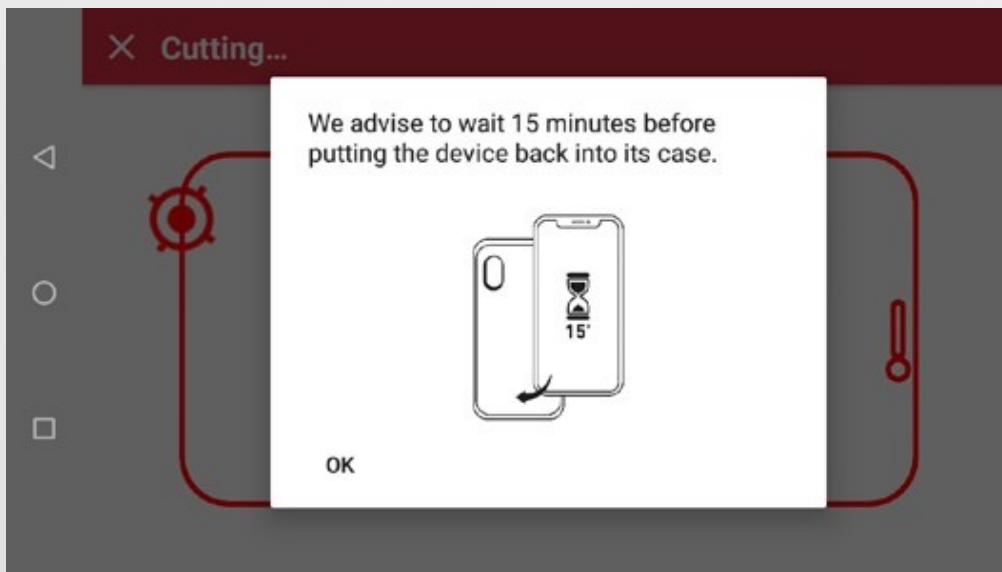

- 11** Once the cutting is over, follow the additional instructions

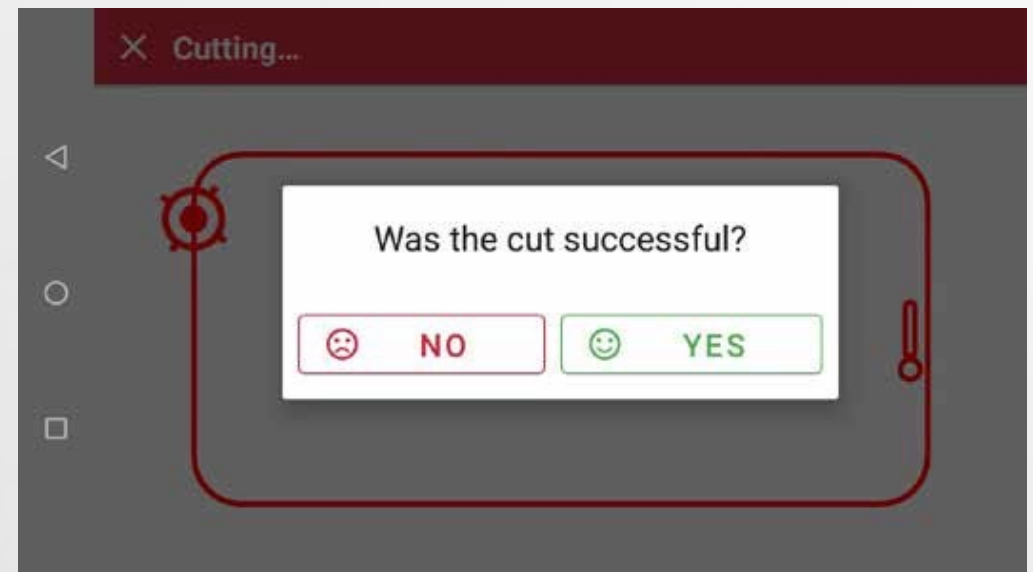

- 12** Finally provide feedback about the cut

sbs

FAST SKIN

SMARTPHONE PROTECTION

Film application

Fast Skin film application: **cleaning the device**



- 1 Use the cleaning materials to prepare the device for Fast Skin application

Always use the anti-skid mat to make sure the smartphone is firmly held in place.

Remove all protective casing from the device. In case there is already film or glass applied, carefully remove it.

Thoroughly **clean the installation site** using the cleaning liquid and cloth.

In case there are traces of glue from a previous screen guard, remove these completely. Use alcohol based glue removing liquid if needed.

In case a lot of visible dust sticks to the screen, use Fast Skin **dust removal stickers** and repeat cleaning with cleaning liquid and cloth.

The installation site should appear **clean and dry** before beginning the installation.

Fast Skin film application: **extracting the cut**

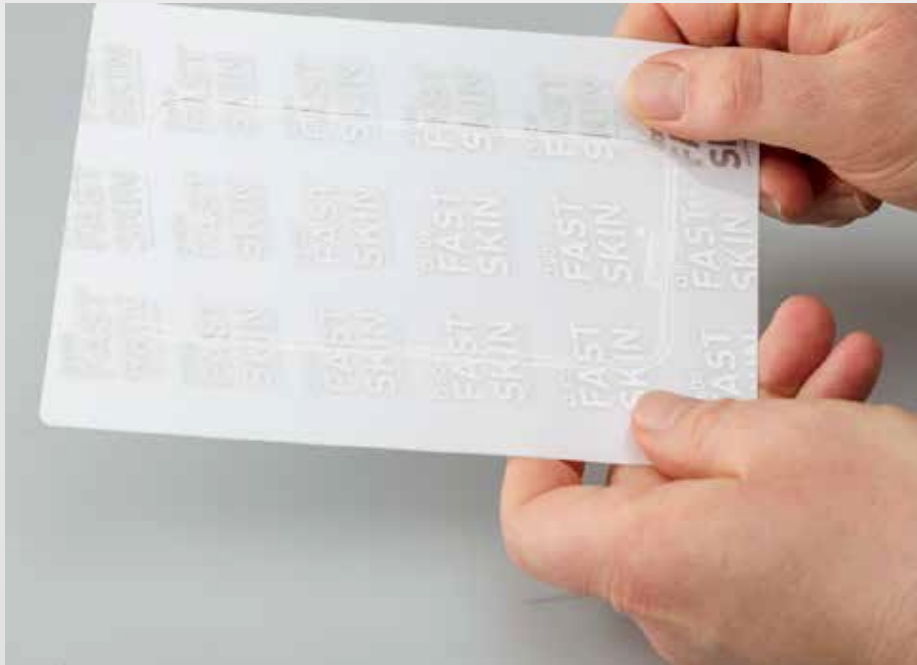

- 2** Carefully extract the cut from the film sheet.
Avoid touching the application layer.



- 3** Fold the previously cut film downwards along one of the longitudinal lines of the cut in such a way that the the top layers detach slightly from the Bottom layer.

Fast Skin film application: **extracting the cut**



- 4** Peel off the top layers, nudging them on the side with the tip of a finger near the middle cutting line.



- 5** Hold the extracted film by the sides with the tips of your fingers and use tweezers to clear any openings, such as camera holes or buttons.

Fast Skin film application: **positioning the film**



- 6** Place the cut on the device with the Installation layer facing the device and making it fit the form of the device.



- 7** Carefully peel all the layers together and reposition to reach the ideal fit.

Fast Skin film application: **installation**



- 8 Carefully peel off the Installation layer up to the cut in the middle of the Installation layer.



- 9 Use the spatula to start gluing the first half of the film, by pushing it firmly outwards over the top of the film.

Fast Skin film application: **installation**



- 10 Carefully peel off the Installation layer up to the cut in the middle of the Installation layer.



- 11 Use the spatula to glue the second half of the film starting, again, from the middle. Be careful around the edges and holes.

Fast Skin film application: **installation**



- 12 Use the spatula to firmly glue the film to the device.

Always move the spatula **outwards**, helping the air escape from beneath the film.

Gently, but firmly, press with spatula the sides of the film so that **the edges adhere well**.

If you notice any bubbles, apply additional pressure **on top of the bubbles** with the spatula and move it outwards so that additional surface tension makes the air escape immediately or gradually drain in a few hours.

Always move the spatula **in one direction at a time**, avoid back-and-forth movements.

Fast Skin film application: **protective layer removal** (only for transparent film)

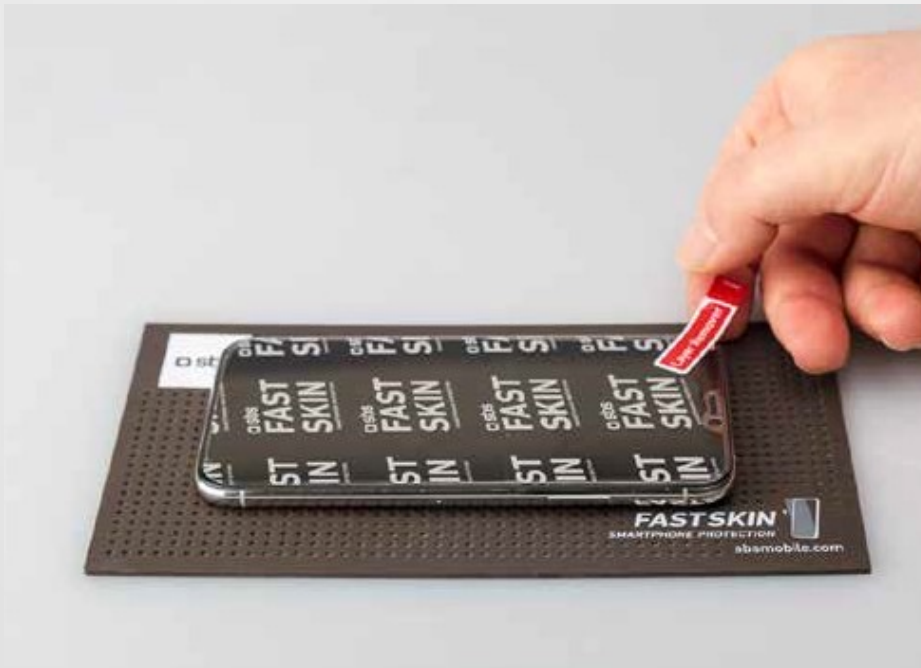

- 13 Place a layer-removal sticker in one of the angles leaving the tip of the sticker on the outside.



- 14 Pull the loose end of the layer-removal sticker upwards with a single gesture, so that the Protective layer is removed.

Fast Skin film application: **fine tuning**



- 15** Examine the film and adjust any remaining details with cloth or wrapping the spatula in cloth.

Rub the edges of the phone **gently with the cloth** to help the sides of the film cure well.

Always **wrap the spatula in cloth** when fine-tuning transparent film: this prevents scratching the film.

Some tiny bubbles may still remain under the film, but applying pressure on these bubbles will result in their **dissipating through the film** within a day.

Non-circular and pointy bubbles are specs of dust trapped underneath the film. In case of these defects a new film has to be installed.

That's why **cleaning the phone before installation is extremely important.**

Fast Skin film application: using hot air gun

(only transparent film cuts with sides)



- 16** Turn on the hot air gun, set it to 100C° and use it at 1-2cm distance to warm-up the edges of the applied film for 30 seconds.



- 17** Put down the hot air gun and use the cloth to rub the sides gently in place.

□ sbs

FAST SKIN

SMARTPHONE PROTECTION

Maintenance

Maintenance: **changing the blade**



- 1 Remove the blade holder from the machine.



- 2 Push the lever in the blade holder cup pushing the blade out.

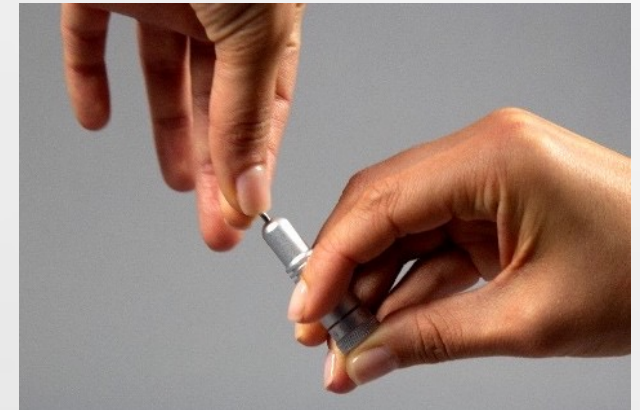

- 3 Take the old blade carefully and remove it from the blade holder.

Maintenance: **changing the blade**

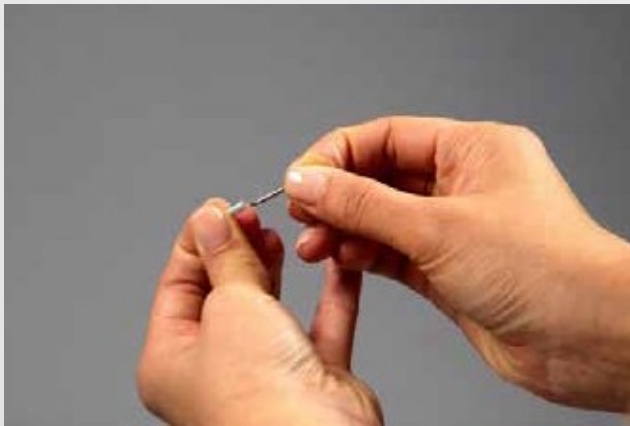

- 4** Remove the protective cap from the new blade



- 5** Slide the new blade into the blade holder holding it upside down



- 6** Fix the blade holder in place

Maintenance: **cleaning the bladeholder**



The tip of the blade holder may get cluttered with fragments of film. Remove these debris if needed.

Inspect the blade holder closely, without removing it from the machine.

If you notice that the **tip of the blade holder has some material stuck to it**, first try blowing some air on the tip of the blade holder to remove any dirt or debris.

If blowing the air is not enough, remove the blade holder and use a **cloth to remove any dirt** from the tip of the blade holder.

Avoid cutting yourself with the tip of the blade or damaging the blade while cleaning.

Maintenance: **managing available materials**

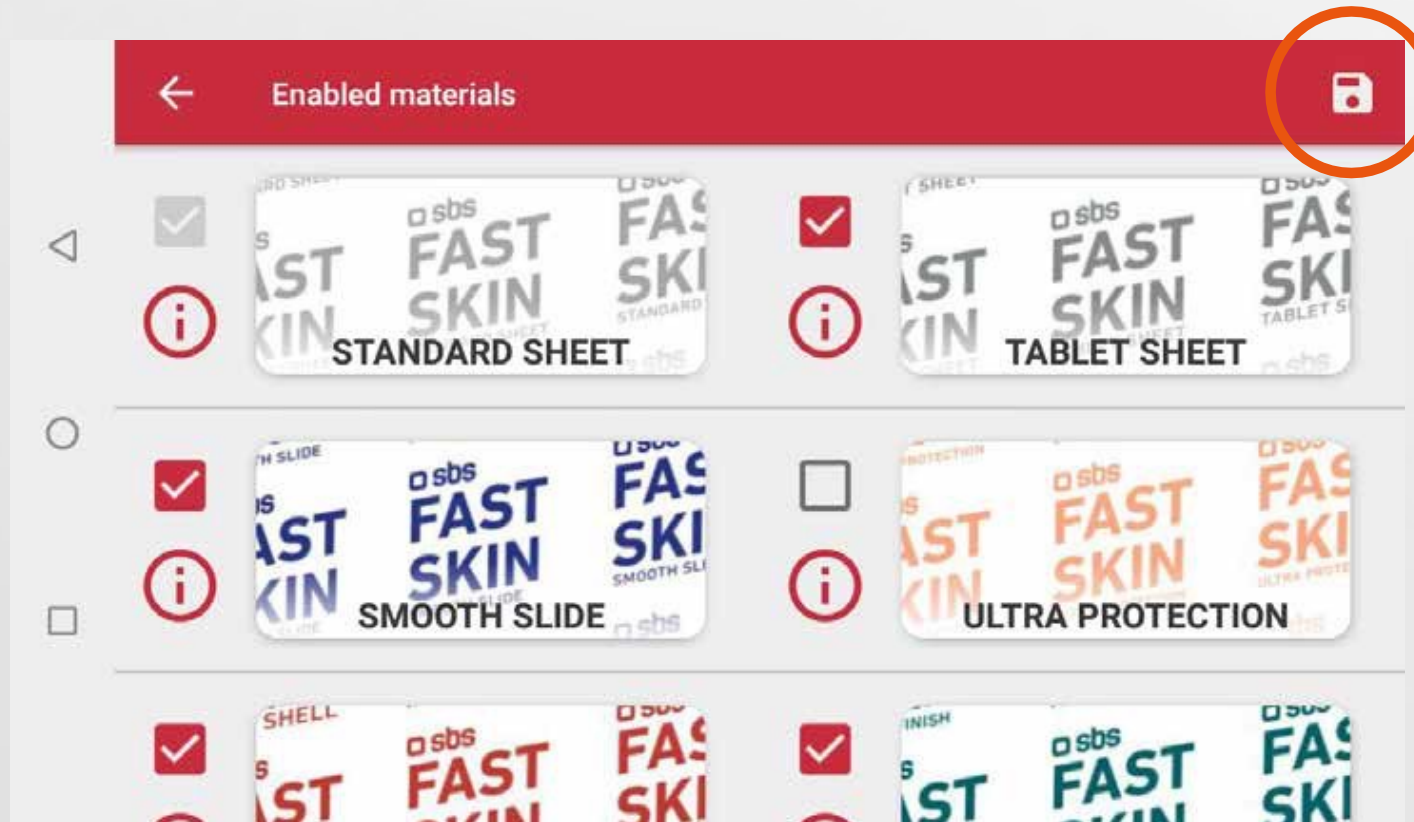

- 1 Open the menu and choose «Materials»
- 2 Scroll through the list and switch the desired materials on
- 3 Press on the «Save» button in the upper right corner

Maintenance: **contacting support**

The screenshot shows a mobile application interface for requesting support. At the top, there is a red header bar with a white back arrow and the text 'Request support'. Below the header, there are three input fields on the left, each with a corresponding icon: a triangle for the name field, a circle for the email field, and a square for the phone number field. The name field contains 'John Doe', the email field contains 'john@acme.com', and the phone number field contains '+39123456789'. To the right of these fields is a larger text area for the 'Problem description'. At the bottom right of the form is a red button with the white text 'SEND REQUEST'.

- 1 Open the menu and choose «Request support»
- 2 Fill-in your details and describe the issue at hand.
- 3 Press «Send» to send the support request. We will get back to you ASAP.

 sbs

FAST SKIN

SMARTPHONE PROTECTION

Troubleshooting

Troubleshooting

“The machine says it is missing an internet connection.”

- ✓ Make sure WiFi configuration is correct, that WiFi signal is strong enough and that your network setup isn't blocking access to sbs-fast-skin.appspot.com – Fast Skin cloud server.
- ✓ If you are using a SIM card, make sure the signal is strong enough and that your data plan is valid.

Troubleshooting

“When I turn the machine on, the screen lights up and starts up the system, but the light inside the machine (above the cutting area) doesn’t turn on and I don’t hear the machine making any sounds starting up.”

- ✓ Turn the machine off. Unplug it from the mains and disconnect the Power Supply from the machine. Wait for two minutes, then reconnect everything and try turning the machine on again.

Troubleshooting

“I’ve been doing some cuts with the machine and everything was fine, but now it doesn’t cut enough and I can not extract the cut from the film.”

- ✓ Please try checking the tip of the blade holder and remove any debris that might prevent it from cutting the film correctly. Retry cutting after this.
- ✓ Try calibrating the machine. Perhaps the blade has been consumed a bit over time and cutting settings need adjustment.
- ✓ Check the tip of the blade – it should be sharp and pointy. If the tip is bent or doesn’t have an expressly triangular shape, replace it with a new blade and calibrate the machine.

Troubleshooting

“I’ve made a cut, but it doesn’t fit the device”

- ✓ Check the exact device model, including any additional letters, punctuation or year of production and make sure it coincides with the model you’ve made the cut for.
- ✓ If you are absolutely sure the model is the same, take a picture of the inconsistency and email it to fastskinservice@sbsmobile.com together with the exact model of the phone and the serial number of the machine.

Compliance

FCC Warning

This device complies with part 15 of the FCC Rules. Operation is subject to the following two conditions:(1) This device may not cause harmful interference, and (2) this device must accept any interference received, including interference that may cause undesired operation.

Any Changes or modifications not expressly approved by the party responsible for compliance could void the user's authority to operate the equipment.

This equipment has been tested and found to comply with the limits for a Class B digital device, pursuant to part 15 of the FCC Rules. These limits are designed to provide reasonable protection against harmful interference in a residential installation. This equipment generates uses and can radiate radio frequency energy and, if not installed and used in accordance with the instructions, may cause harmful interference to radio communications. However, there is no guarantee that interference will not occur in a particular installation. If this equipment does cause harmful interference to radio or television reception, which can be determined by turning the equipment off and on, the user is encouraged to try to correct the interference by one or more of the following measures:

- Reorient or relocate the receiving antenna.
- Increase the separation between the equipment and receiver.
- Connect the equipment into an outlet on a circuit different from that to which the receiver is connected.
- Consult the dealer or an experienced radio/TV technician for help.

This equipment complies with FCC radiation exposure limits set forth for an uncontrolled environment. This equipment should be installed and operated with minimum distance 20cm between the radiator & your body.



FAST SKIN

SMARTPHONE PROTECTION

Via Circonvallazione s/n, Miasino (NO) Italy

+39 0322 980909

info@sbsmobile.com

sbsmobile.com

Copyright © 2021 SBS S.p.A. All rights reserved.